

A (2:1)

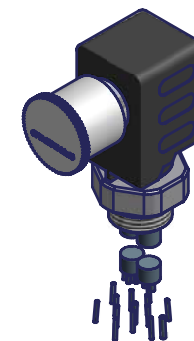
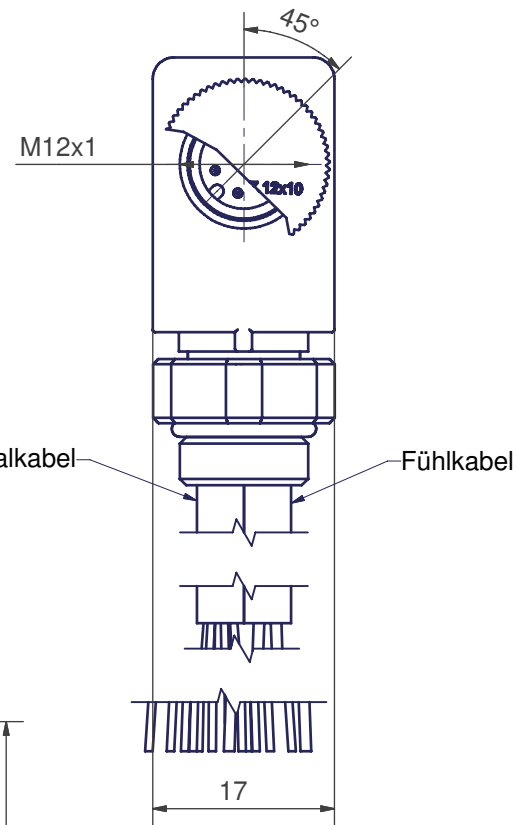
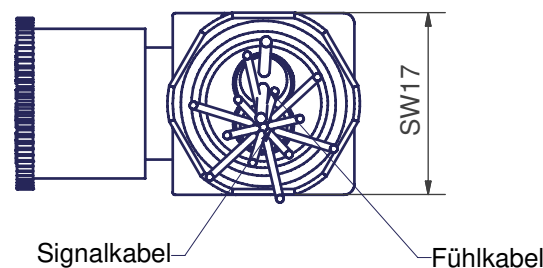

Technical Data:

M12 8 pole 90° Angle connector with 2 Cables.
 The Connector can be screwed in into a motor baseplate.
 The orientation is 360° free. The connector can be fixed with the counter nut.
 The connector is 360° shielded.

poles: 8
 coding: Type A
 nominal voltage: 30VAC / 36VDC
 max current: 1A
 contact resistance: <5m Ohms
 test voltage: 1,4KV / 60 sec.
 insulation withstand: > 1 GOhm

IP degree of protection: IP67 in connection area
 Temperature range: -40 to 125°C

**Customer Drawing
 Kundenzeichnung**

This drawing and its contents are the proprietary and confidential property of Woodhead Industries Inc. and/or its subsidiaries and may not be used or disclosed to others without the express prior written consent of Woodhead Industries Inc. and/or its subsidiaries.

		UNLESS OTHERWISE SPECIFIED x = ±1 X.X = ±0,1 X.XX = ±0,05 Winkel = 1°	Scale 2:1 Dimensions mm
PROJECTION 1 : GER			Material Finish
		Date	Name
		PROC 13.09.2005	NS
		CHK 13.09.2005	US
		Norm. 12.03.2008	FP
05	BRE2004-01111	12.03.08	NS
04	BRE 2004-00743	16.10.06	NS
03	BRE 2004-00688	19.08.06	NS
02	BRE 2004-00590	14.03.06	NS
01	INITIAL RELEASE	13.09.05	NS
Rev.	Change	Date	Name
Woodhead Connectivity GmbH Gewerbestraße 60 75015 Bretten-Gölshausen Tel.: 07252/9496-0 Fax: 07252/9496-199			Winkelstecker SPR 040160
0880 082KM 9690A			Sheet 1 A3
Filename 0880 082KM 9690A.idw			