

SEMS SCREW TERMINALS

SEMS SCREW TERMINALS

15 AMP



**SNAP-IN
PC MOUNT**

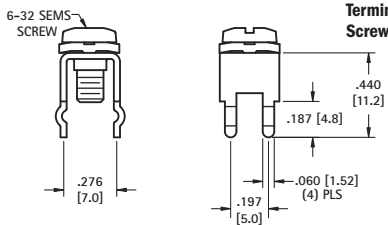

SPECIFICATIONS

Terminal: .032 (.81) Brass, Matte Tin Plate
Screw & Washer: Steel, Nickel Plate

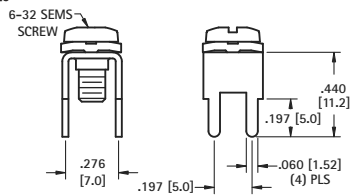

PC MOUNT

CAT. NO. 7691-SEMS (Screw Supplied Unassembled)

CAT. NO. 7693-SEMS (Screw Installed & Captivated)

CAT. NO. 8191-SEMS (Screw Supplied Unassembled)

CAT. NO. 7701-SEMS (Screw Installed & Captivated)



**SNAP-IN
PC MOUNT**

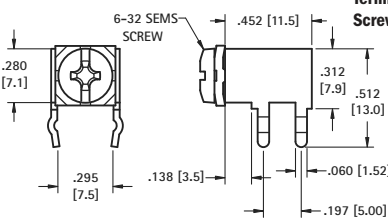

SPECIFICATIONS

Terminal: .032 (.81) Brass, Matte Tin Plate
Screw & Washer: Steel, Nickel Plate

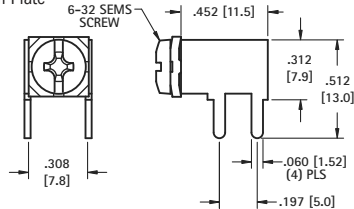

PC MOUNT

CAT. NO. 7690-SEMS (Screw Supplied Unassembled)

CAT. NO. 7692-SEMS (Screw Installed & Captivated)

CAT. NO. 8190-SEMS (Screw Supplied Unassembled)

CAT. NO. 7700-SEMS (Screw Installed & Captivated)



**SNAP-IN
PC MOUNT**

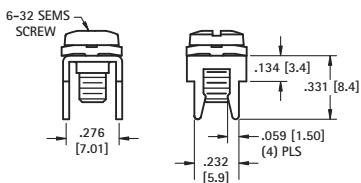

SPECIFICATIONS

Terminal: .032 (.81) Brass, Matte Tin Plate
Screw & Washer: Steel, Nickel Plate

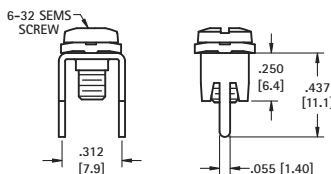

PC MOUNT

CAT. NO. 8195-SEMS (Screw Supplied Unassembled)

CAT. NO. 7775-SEMS (Screw Installed & Captivated)

CAT. NO. 8198-SEMS (Screw Supplied Unassembled)

CAT. NO. 7778-SEMS (Screw Installed & Captivated)



PC MOUNT

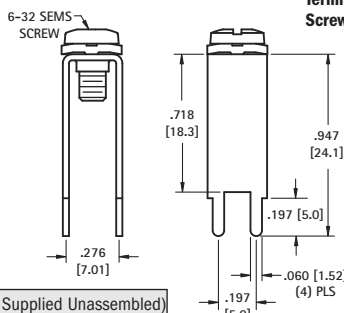

SPECIFICATIONS

Terminal: .032 (.81) Brass, Matte Tin Plate
Screw & Washer: Steel, Nickel Plate

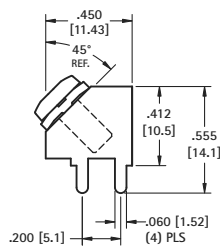

PC MOUNT

CAT. NO. 7697-SEMS (Screw Supplied Unassembled)

CAT. NO. 7699-SEMS (Screw Installed & Captivated)

CAT. NO. 8189-SEMS (Screw Supplied Unassembled)

CAT. NO. 7702-SEMS (Screw Installed & Captivated)



**SNAP-IN
PC MOUNT**

SPECIFICATIONS

Terminal: .032 (.81) Brass, Matte Tin Plate
Screw & Washer: Steel, Nickel Plate

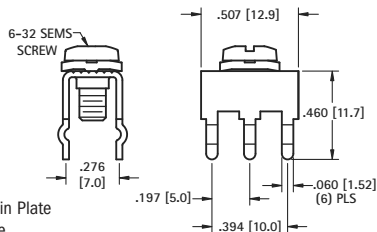

30 AMP

CAT. NO. 8197-SEMS (Screw Supplied Unassembled)

CAT. NO. 8199-SEMS (Screw Installed & Captivated)

SEMS Screw Terminals provide quick and secure attachment of wire leads. SEMS screw has captivated, free spinning lock washer, eliminated twisting of wire when tightening lead to terminal. Washer will rise with head of screw when unscrewed.

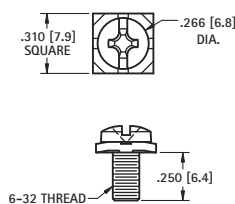

SPECIFICATIONS

Screw & Washer: Steel, Nickel Plate

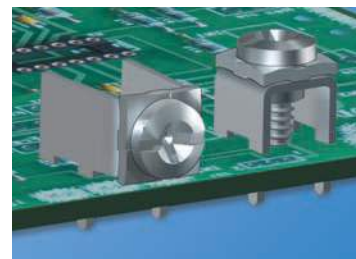

CAT. NO. 9920 (SEMS Screw Only)