

Verwendung mit Grundkörper:

225724, 225727

Tolerances

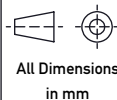

Scale **5:1**

CuZn39Pb3
Sn über Cu - Kontaktstelle von Galvanik sichtbar

All rights reserved.
Only for Information.
To ensure that this is the latest version of this drawing, please contact one of the ERNI companies before using.

Subject to modification without prior notice.
Drawing will not be updated.

Designation

BCS Powerelement zweiteilig
Stift M6, \varnothing 7,45



www.ERNI.com

225736

I
A4

A	20.11.12
Index	Date

Class BCS