

THIS DRAWING IS A CONTROLLED DOCUMENT.

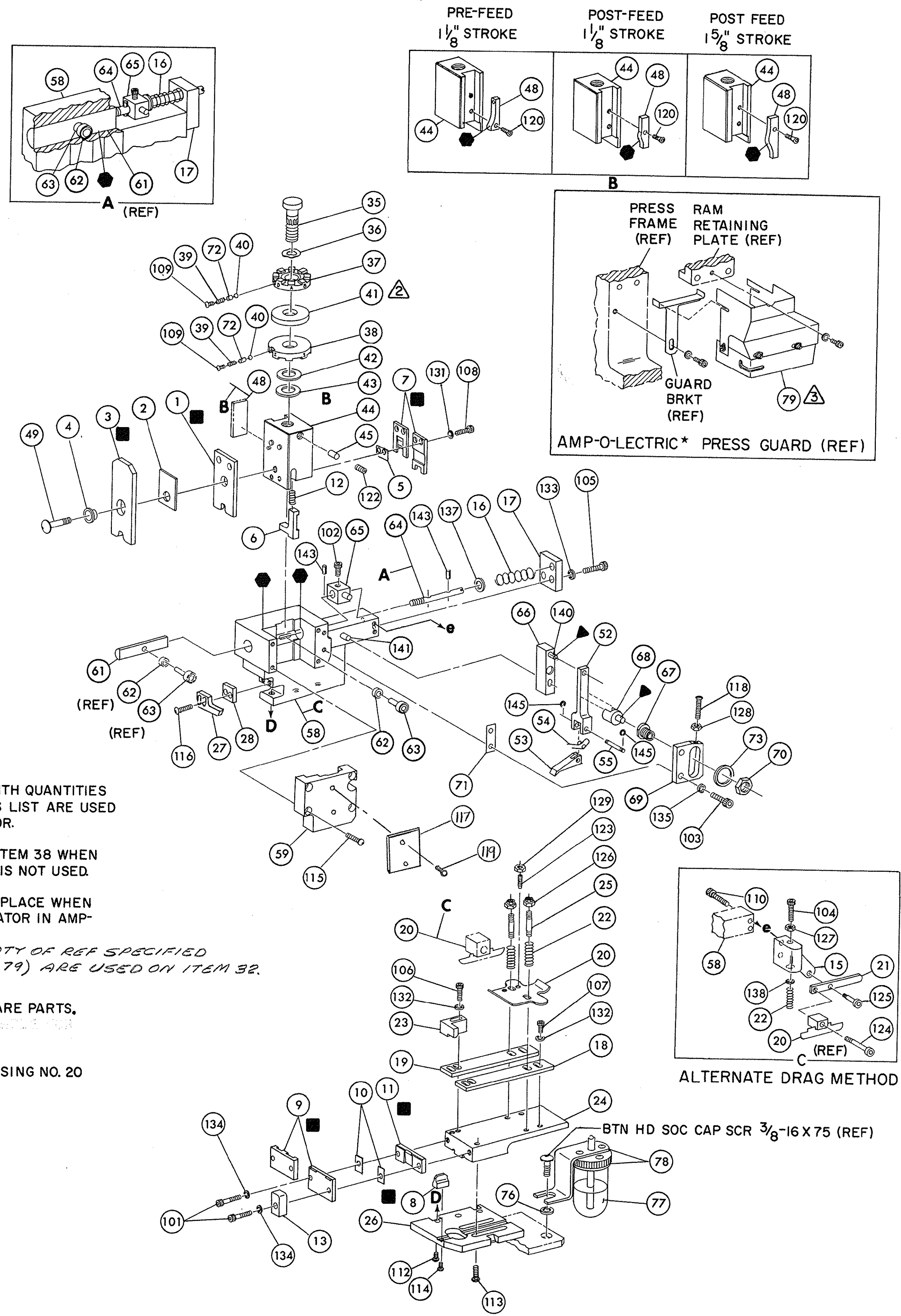

NOTES:

1. ONLY THE ITEMS WITH QUANTITIES SPECIFIED ON PARTS LIST ARE USED ON THIS APPLICATOR.
- △ USED IN PLACE OF ITEM 38 WHEN INSULATION CRIMP IS NOT USED.
- ▲ GUARD MUST BE IN PLACE WHEN OPERATING APPLICATOR IN AMP-O-LECTRIC PRESS.
4. PARTS WITH QTY OF REF SPECIFIED (EXCEPT ITEM 79) ARE USED ON ITEM 32.

- KEY:**
- RECOMMENDED SPARE PARTS.
 - ▲ LUBRICATE DAILY USING NO. 20 MACHINE OIL.
 - GREASE LIGHTLY.

AMP 3076-2 (8-73)

REF	QTY	PART NO	DESCRIPTION	ITEM NO
REF		21045-3	RING, RETAINING 'C' (.187 DIA) FEED PIN	145
REF		5-21028-1	PIN, SLOT SPG (.12 DIA X .50) FD ADJ ROD	144
REF		1-21030-7	PIN, DOWEL (.187 DIA X 1.50) HOUSING	143
REF		1-21030-1	PIN, DOWEL (.187 DIA X .50) LEVER	142
		22260-5	WASHER, FLAT (NO 6) DRAG SPRING	141
REF		21899-4	WASHER, FLAT (5/16 DIA) SCR ADJ	140
REF		21024-5	WASHER, LOCK (NO 10) FEED ADJ PLATE	139
2	1	21024-5	WASHER, LOCK (NO 10) SHEAR PLATES	138
REF		21024-5	WASHER, LOCK (NO 10) FEED ROD GUIDE	137
5		21024-4	WASHER, LOCK (NO 8) STRIP GUIDE	136
2		21024-4	WASHER, LOCK (NO 8) SHEAR BLADE	135
2		21018-4	NUT, HEX MACH (4-40) DRAG	134
REF		21068-5	NUT, HEX MACH (6-32) FD ADJ PLATE	133
		21018-7	NUT, HEX MACH (10-32) DRAG SPRING	132
2		21022-2	NUT, HEX SELF-LKG (8-32) DRAG STUD	131
		5-21004-7	SCR, SKT HD SHLD (250 DIA X .25) DRAG ARM	130
		21004-5	SCR, SKT HD SHLD (250 DIA X 1.00) DRAG	129
2		4-21078-8	SCR, SKT SET OVAL POINT (4-40 X .75) DRAG	128
1		21009-2	SCR, SKT SET (1/4-20 X 25) (LOC-WEL) RAM	127
1		2-21003-0	SCR, FLAT HD SKT CAP (6-32 X .50) CAM	126
2		21017-2	SCR, DRIVE (#2 X .19) I.D. PLATE	125
REF		3-21064-2	SCR, RD HD MACH (6-32 X 1.50) FEED ADJ	124
1		461264-1	PLATE, IDENTIFICATION	123
2		2-21002-2	SCR, BTN HD SKT CAP (8-32 X .50) STRIPPER	122
REF		2-21002-9	SCR, BTN HD SKT CAP (10-32 X .75) HSG CAP	121
1		22733-8	SCR, BTN HD SKT CAP (8-32 X .38) (LOC-WEL) ANVIL	120
4		3-21002-3	SCR, BTN HD SKT CAP (1/4-20 X .50) STR GDE PL	119
REF		1-24073-9	SCR, BTN HD SKT CAP (1/4-20 X .75) BASE PL	118
		2-21000-4	SCR, SKT HD CAP (6-32 X 1.00) DRAG ADAPTOR	117
2		23030-1	SCR, SKT HD CAP (6-32 X .25) (LOC-WEL) CP DISC	116
2		2-21000-6	SCR, SKT HD CAP (8-32 X .38) SHEAR BLADE	115
3		7-21000-4	SCR, SKT HD CAP (8-32 X .31) STRIP GUIDE	114
2		2-21000-9	SCR, SKT HD CAP (8-32 X .75) STRIP GUIDE	113
REF		3-21000-7	SCR, SKT HD CAP (10-32 X .75) FD ROD GUIDE	112
		3-21000-9	SCR, SKT HD CAP (10-32 X 1.00) DRAG SPRING	111
REF		3-21000-6	SCR, SKT HD CAP (10-32 X .62) FD ADJ PLATE	110
REF		3-21000-4	SCR, SKT HD CAP (10-32 X .38) PIVOT BLK	109
2		3-21000-8	SCR, SKT HD CAP (10-32 X .88) SHEAR PLATE	108
REF		455745-1	GUARD, WINDOW	107
		465184-9	LUBRICATOR ASSY	106
		455985-1	OIL, LUBRICATING	105
		454406-1	SPACER, LUB BRACKET	104
		458109-1	WASHER, FLAT (SPECIAL)	103
2		690603-1	SPRING, ASSIST	102
REF		690517-1	SPACER	101
		22594-8	NUT, HEX	100
		240628-1	PLATE, ADJ	99
		240626-1	SHAFT, PIVOT	98
		240633-1	BUSHING	97
		455680-1	LEVER, INTERMEDIATE	96
		240629-1	BLOCK, PIVOT	95
		240632-2	SCREW, ADJ	94
		240659-3	PIN, CAM ROLLER	93
		240658-1	CAM, ROLLER	92
REF		454398-1	ROD, FEED	91
REF		454220-1	CAP, RAM	90
REF		453736-1	HOUSING	89
		240624-1	PIN, FEED FINGER	88
REF		691499-1	SPRING, FEED FINGER	87
REF		240635-1	FINGER, FEED	86
REF		240634-1	LEVER, TERMINAL	85
		7-21002-9	BOLT, CRIMPER	84
1		690602-5	CAM, PRE FEED 1/8 STROKE	83
		690191-1	PLUG, NYLON	82
1		455674-1	RAM	81
1		690125-1	WASHER, LAMINATED	80
1		690124-9	WASHER, RAM	79
		23241-6	SPACER, DISC	78
2		690170-1	BALL, STEEL	77
1		690142-1	SPRING, COMPRESSION	76
1		3-692155-3	DISC, INSULATION	75
1		22480-5	DISC, WIRE	74
1		690212-1	WASHER, SPRING	73
		458980-1	POST, RAM	72
		455678-3	SCR, DRIVE (#2 X .19) I.D. PLATE	71
		455676-1	SCR, RD HD MACH (6-32 X 1.50) FEED ADJ	70
		22354-8	PLATE, IDENTIFICATION	69
		455678-3	SCR, BTN HD SKT CAP (8-32 X .50) STRIPPER	68
		240639-1	SCR, BTN HD SKT CAP (10-32 X .75) HSG CAP	67
		3-690451-2	SCR, BTN HD SKT CAP (8-32 X .38) (LOC-WEL) ANVIL	66
		240636-1	SCR, BTN HD SKT CAP (1/4-20 X .50) STR GDE PL	65
		22354-8	SCR, BTN HD SKT CAP (1/4-20 X .75) BASE PL	64
		455678-3	SCR, SKT HD CAP (6-32 X 1.00) DRAG ADAPTOR	63
		240825-1	SCR, SKT HD CAP (6-32 X .25) (LOC-WEL) CP DISC	62
		4-22281-1	SCR, SKT HD CAP (8-32 X .38) SHEAR BLADE	61
		240636-1	SCR, SKT HD CAP (8-32 X .31) STRIP GUIDE	60
		454177-1	SCR, SKT HD CAP (8-32 X .75) STRIP GUIDE	59
		454204-1	SCR, SKT HD CAP (10-32 X .75) FD ROD GUIDE	58
		454204-1	SCR, SKT HD CAP (10-32 X 1.00) DRAG SPRING	57
		454178-1	SCR, SKT HD CAP (10-32 X .62) FD ADJ PLATE	56
		4-22284-9	SCR, SKT HD CAP (10-32 X .38) PIVOT BLK	55
		454178-1	SCR, SKT HD CAP (10-32 X .88) SHEAR PLATE	54
		1-690481-3	GUARD, WINDOW	53
		23846-1	LUBRICATOR ASSY	52
		240644-5	OIL, LUBRICATING	51
		1-690482-8	SPACER, LUB BRACKET	50
		5-240655-4	WASHER, FLAT (SPECIAL)	49
		690474-5	SPRING, ASSIST	48
		2-455892-0	SPACER	47
		3-240641-3	NUT, HEX	46
		238009-1	PLATE, ADJ	45
		2-456134-1	SHAFT, PIVOT	44
		455888-8	BUSHING	43
		1-456404-8	LEVER, INTERMEDIATE	42
		1-690481-3	BLOCK, PIVOT	41
		1-690481-3	SCREW, ADJ	40
		1-690481-3	PIN, CAM ROLLER	39
		1-690481-3	CAM, ROLLER	38
		1-690481-3	ROD, FEED	37
		1-690481-3	WASHER, FLAT (SPECIAL)	36
		1-690481-3	SPRING, ASSIST	35
		1-690481-3	SPACER	34
		1-690481-3	NUT, HEX	33
		1-690481-3	PLATE, ADJ	32
		1-690481-3	SHAFT, PIVOT	31
		1-690481-3	BUSHING	30
		1-690481-3	LEVER, INTERMEDIATE	29
		1-690481-3	BLOCK, PIVOT	28
		1-690481-3	SCREW, ADJ	27
		1-690481-3	PIN, CAM ROLLER	26
		1-690481-3	CAM, ROLLER	25
		1-690481-3	ROD, FEED	24
		1-690481-3	WASHER, FLAT (SPECIAL)	23
		1-690481-3	SPRING, ASSIST	22
		1-690481-3	SPACER	21
		1-690481-3	NUT, HEX	20
		1-690481-3	PLATE, ADJ	19
		1-690481-3	SHAFT, PIVOT	18
		1-690481-3	BUSHING	17
		1-690481-3	LEVER, INTERMEDIATE	16
		1-690481-3	BLOCK, PIVOT	15
		1-690481-3	SCREW, ADJ	14
		1-690481-3	PIN, CAM ROLLER	13
		1-690481-3	CAM, ROLLER	12
		1-690481-3	ROD, FEED	11
		1-690481-3	WASHER, FLAT (SPECIAL)	10
		1-690481-3	SPRING, ASSIST	9
		1-690481-3	SPACER	8
		1-690481-3	NUT, HEX	7
		1-690481-3	PLATE, ADJ	6
		1-690481-3	SHAFT, PIVOT	5
		1-690481-3	BUSHING	4
		1-690481-3	LEVER, INTERMEDIATE	3
		1-690481-3	BLOCK, PIVOT	2
		1-690481-3	SCREW, ADJ	1

CRIMPING DATA				APPLICATOR WILL APPLY	
PAD LTR	CRIMP HEIGHT	WIRE SIZE	WIRE STRIP LENGTH		
A	.058	16			61408
B	.048	18			62968
C	.044	20			
D	NOT USED				
CRIMP	SIZE	TYPE	FEED	APPL INST	
WIRE	.070	F			
INSUL	.090	F	.705	A18039	
WIRE RANGE	20-16	INSULATION RANGE	.060-.100	PRESS NO	565435-5
REMARKS					
AMP-O-LECTRIC PRE FEED					

REVISION RECORD	APP DATE	REV	REVISION RECORD	APP DATE	REV

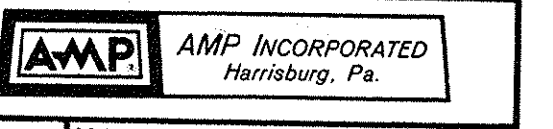

AMP 3076-2 (8-73)