

LOC	QTY	REV	DATE	BY	CHK	APPV
CM	53					

REVISIONS						
REV	DESCRIPTION	DATE	BY	CHK	APPV	REASON
C	REV & REDWN PER EC 0L30-0270-97	12-11-97	KW	RS		

AMP LOGO AND CAVITY NUMBER LOCATED THIS SURFACE.

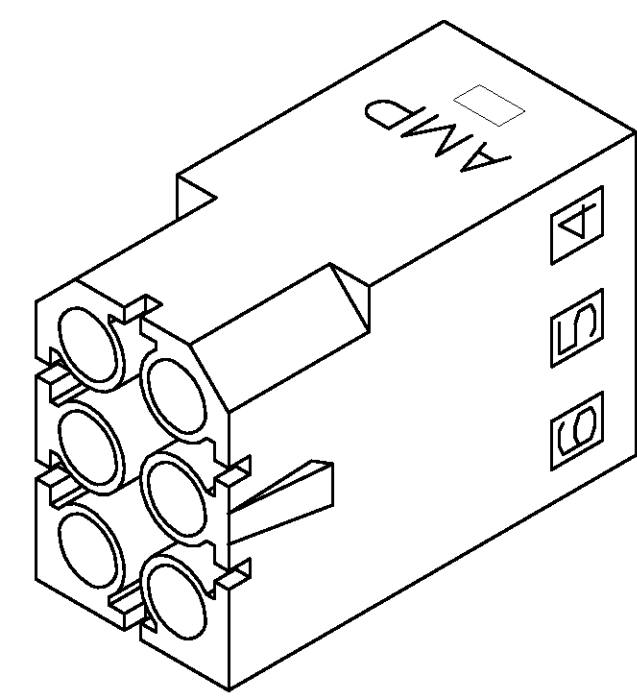
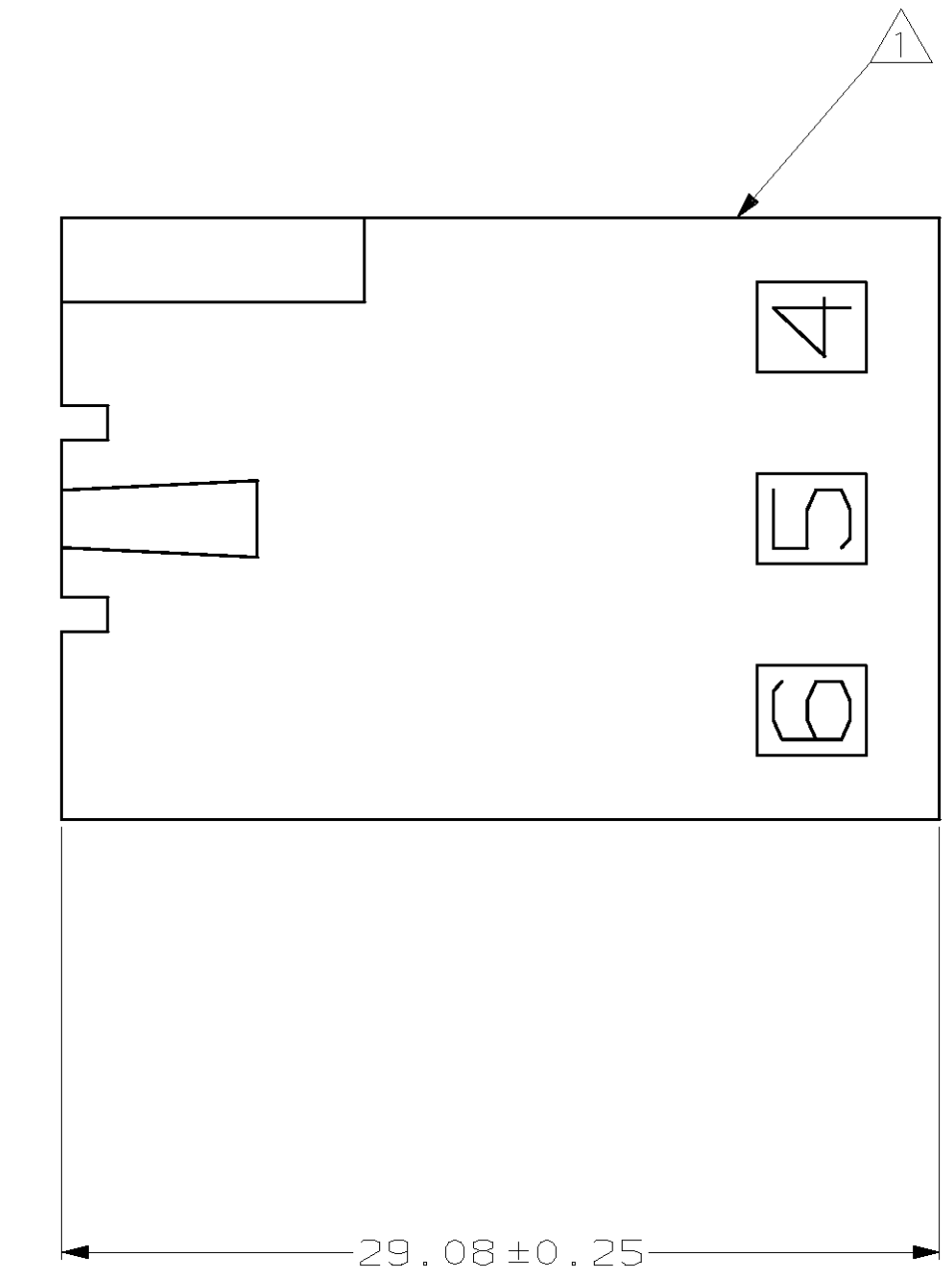
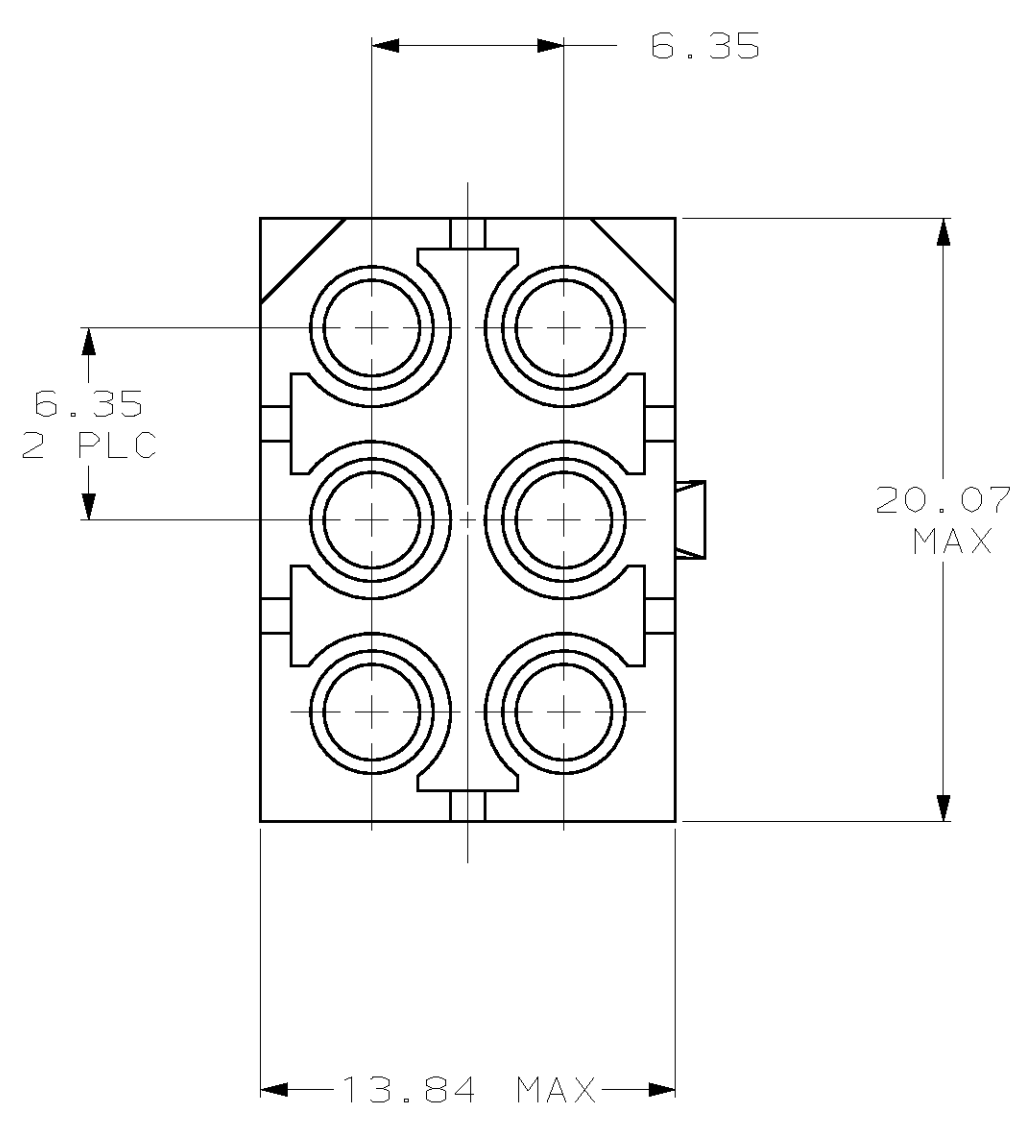
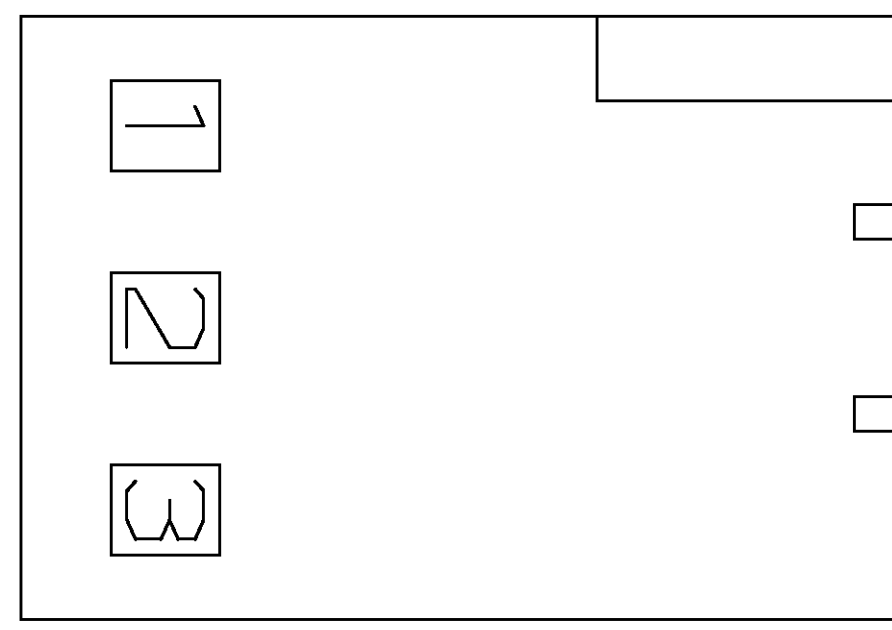

3-DIMENSIONAL MODEL
NTS

MM	IN
29.08	1.145
20.07	.790
13.84	.545
6.35	.250
0.25	.010
0.13	.005

CONVERSION TABLE

770360-1
PART NUMBER

METRIC

THIS DRAWING IS A CONTROLLED DOCUMENT.		OWN: K. WHITAKER 12-11-97	AMP AMP Incorporated Harrisburg, PA 17105-3608
DIMENSIONS: mm		CHK: R. SWING 12-11-97	
TOLERANCES UNLESS OTHERWISE SPECIFIED:		APVD: K. CORLE 12-11-97	NAME: RECEPTACLE, 6 CIRCUIT, .250 PIN AND SOCKET
9 PLC ±-		PRODUCT SPEC: -	SIZE: A1
3 PLC ±-		APPLICATION SPEC: -	SCALE: 4:1
2 PLC ±0.13		HEIGHT: -	SHEET: 1 OF 1
3 PLC ±-		MATERIAL: NYLON, UL 94V-2, NATURAL	REV: C
FINISH: -		FINISH: -	REVISIONS: -
CUSTOMER DRAWING		DRAWING NO: 770360	RESTRICTED TO: -