

- △ X 面から2mmの範囲で測定
- 2. 嵌合相手ハウジング型: 174516, 174515, 174514, 174913, 917992, 917989, 917981, 917975
- 3. 推奨取付ねじ: JIS B1115, B1122 タッピングねじ, なべ2種 呼び径3, 長さ6mm以下 (締付けトルク: 0.4N・cm以下)
- 4. 適用製品規格番号: 108-5280, 108-5342
- △ 回路番号: 右図参照のこと
- △ パワー回路 ① ~ ⑩
- △ シグナル回路 ⑪ ~ ⑮
- △ 適用製品規格のプリフィックス及びIDマークをカマートマークにて表示

- △ MUST BE KEPT BETWEEN X AND 2
- 2 THE MATING PLUG HSG. PART NUMBER; 174516, 174515, 174514, 174913, 917992, 917989, 917981, 917975
- 3 RECOMMENDED MOUNTING SCREW; 3mmDIA, 6mmLENGTH MAX.)
- PAN HEAD, CLASS 2 TAPPING SCREW SPECIFIED IN JIS B1115, B1122
- < TIGHTENING TORQUE; 0.4N・m MAX. >
- 4 APPLICABLE PRODUCT SPEC NO. 108-5280, 108-5342
- △ CIRCUIT NUMBER
- POWER CIRCUIT NO. ① ~ ⑩
- SIGNAL CIRCUIT NO. ⑪ ~ ⑮
- △ INDICATED PREFIX AND ID MARK OF PRODUCT P/N BY HOT MARK

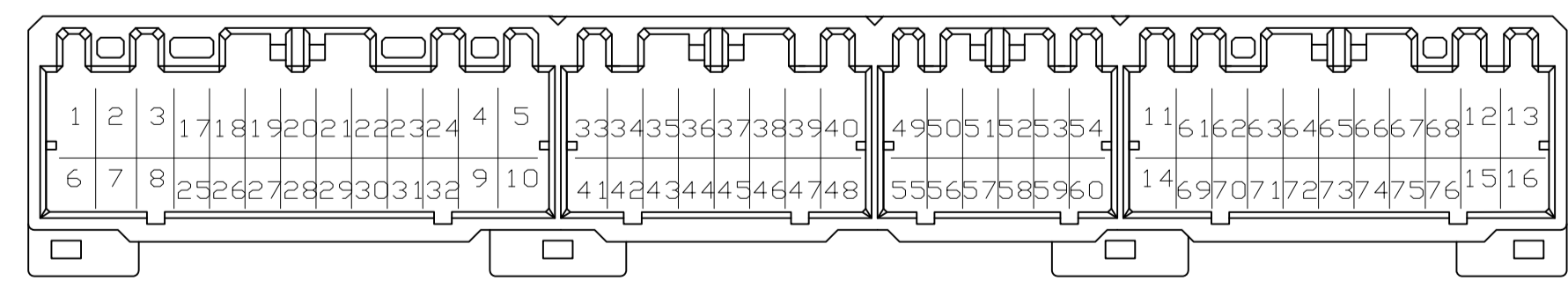
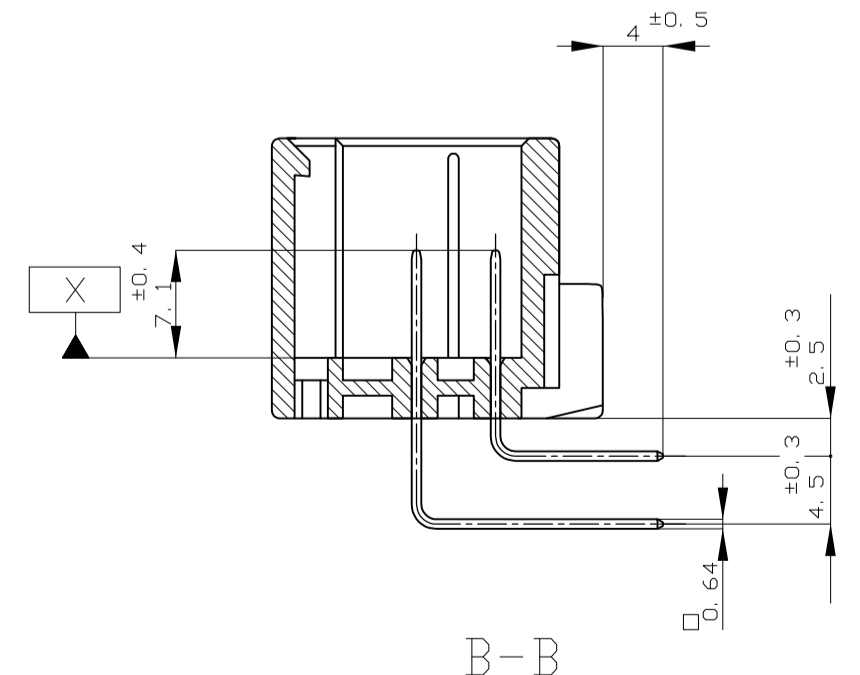
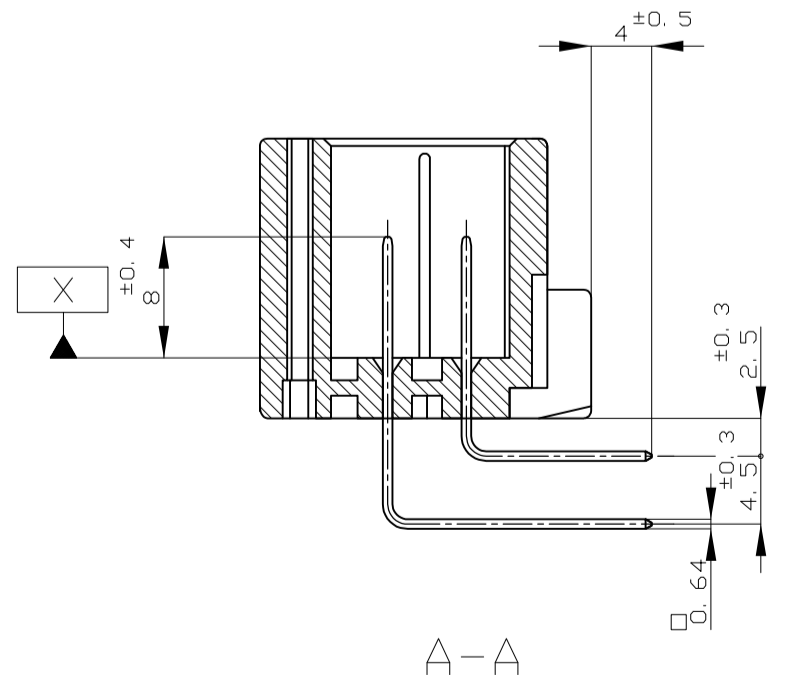

MARKING	MARKING	MARKING	MARKING	MARKING	MARKING	MARKING
△ 56	SELECTIE-TIN (MATTE)	SELECTIVE GOLD × 14	-	24, 31, 39, 40	GRAY	6-5178780-6
△ 55	SELECTIE-TIN (MATTE)	SELECTIVE GOLD × 28	-	25~32, 35~40	BLACK	5-5178780-2
△ 55	SELECTIE-TIN (MATTE)	SELECTIVE GOLD × 28	-	43~52, 55~58	NATURAL	5-5178780-1
△ 54	SELECTIE-TIN (MATTE)	SELECTIVE GOLD × 28	-	25~32, 35~40	YELLOW	4-5178780-7
△ 54	SELECTIE-TIN (MATTE)	SELECTIVE GOLD × 8	-	23, 24, 31~51	GRAY	4-5178780-6
△ 53	SELECTIE-TIN (MATTE)	SELECTIVE GOLD × 12	-	55~57, 63, 64	YELLOW	3-5178780-7
△ 53	SELECTIE-TIN (MATTE)	SELECTIVE GOLD × 60	-	49, 50, 52, 53, 68	GRAY	3-5178780-6
△ 52	SELECTIE-TIN (MATTE)	SELECTIVE GOLD × 24	9	26~32, 40, 49~52	YELLOW	3-5178780-7
△ 52	SELECTIE-TIN (MATTE)	SELECTIVE GOLD × 19	-	17~76	GRAY	3-178780-6
△ 52	SELECTIE-TIN (MATTE)	SELECTIVE GOLD × 19	-	23, 24, 31, 33~49	YELLOW	2-5178780-7
△ 52	SELECTIE-TIN (MATTE)	SELECTIVE GOLD × 19	-	55, 63, 64	GRAY	2-5178780-6
△ 9	SELECTIVE-TIN	PRE-TIN × 76	-	22, 24, 31, 34, 39~40	GRAY	2-5178780-6
△ 8	TIN-LEAD	SELECTIVE GOLD × 7	-	42~48, 49, 50, 55, 56, 63, 64	NATURAL	9-178780-1
△ 7	TIN-LEAD	SELECTIVE GOLD × 10	-	49, 50, 52, 53, 68	GRAY	8-178780-6
△ 7	TIN-LEAD	SELECTIVE GOLD × 10	-	70, 74	GRAY	7-178780-6
△ 6	TIN-LEAD	SELECTIVE GOLD × 14	-	24, 31, 39, 44~47	GRAY	7-178780-6
△ 6	TIN-LEAD	SELECTIVE GOLD × 14	-	49, 55, 64	GRAY	6-178780-6
△ 5	TIN-LEAD	SELECTIVE GOLD × 28	-	24, 31, 39, 40	GRAY	6-178780-6
△ 5	TIN-LEAD	SELECTIVE GOLD × 28	-	42~50, 55	GRAY	6-178780-6
△ 5	TIN-LEAD	SELECTIVE GOLD × 28	-	25~32, 35~40	YELLOW	5-178780-7
△ 5	TIN-LEAD	SELECTIVE GOLD × 28	-	43~52, 55~58	YELLOW	5-178780-7
△ 5	TIN-LEAD	SELECTIVE GOLD × 28	-	25~32, 35~40	GRAY	5-178780-6
△ 5	TIN-LEAD	SELECTIVE GOLD × 28	-	43~52, 55~58	GRAY	5-178780-6
△ 5	TIN-LEAD	SELECTIVE GOLD × 28	-	25~32, 35~40	BLACK	5-178780-2
△ 5	TIN-LEAD	SELECTIVE GOLD × 28	-	43~52, 55~58	NATURAL	5-178780-1
△ 4	TIN-LEAD	SELECTIVE GOLD × 28	-	23, 24, 31~51	YELLOW	4-178780-7
△ 4	TIN-LEAD	SELECTIVE GOLD × 8	-	55~57, 63, 64	GRAY	4-178780-6
△ 4	TIN-LEAD	SELECTIVE GOLD × 8	-	49, 50, 52, 53, 68	GRAY	4-178780-6
△ 4	TIN-LEAD	SELECTIVE GOLD × 12	-	70, 71, 74	YELLOW	3-178780-7
△ 3	TIN-LEAD	SELECTIVE GOLD × 12	-	26~32, 40, 49~52	YELLOW	3-178780-7
△ 3	TIN-LEAD	SELECTIVE GOLD × 60	-	17~76	GRAY	3-178780-6
△ 2	TIN-LEAD	SELECTIVE GOLD × 24	9	23, 24, 31, 33~49	YELLOW	2-178780-7
△ 2	TIN-LEAD	SELECTIVE GOLD × 19	-	55, 63, 64	GRAY	2-178780-6
△ 2	TIN-LEAD	SELECTIVE GOLD × 19	-	22, 24, 31, 34, 39~40	GRAY	2-178780-6
△ 2	TIN-LEAD	SELECTIVE GOLD × 19	-	42~48, 49, 50, 55, 56, 63, 64	GRAY	2-178780-6
△ 0	SELECTIVE-TIN (MATTE)	SELECTIVE-TIN (BRIGHT) × 76	-	-	LIGHT GRAY	178780-9
△ 1	SELECTIVE-TIN (MATTE)	SELECTIVE-TIN (BRIGHT) × 76	-	-	NATURAL	178780-3
△ 0	SELECTIVE-TIN (MATTE)	SELECTIVE-TIN (BRIGHT) × 76	-	-	NATURAL	178780-1

THIS DRAWING IS A CONTROLLED DOCUMENT.

DIMENSIONS: 単位: 寸 mm

TOLERANCES UNLESS OTHERWISE SPECIFIED

GENERAL TOLERANCE

MATERIAL: HOUSING: PBT CONTACT: BRASS

FINISH: 仕上 見 TABLE

APPROVED: M. KADOSAKI, T. SHINOHARA, K. BETSUJI

PRODUCT SPEC: 製品規格

APPLICATION SPEC: 取付適用規格

76POS CAP HOUSING ASSY .040/.070 SERIES HYBRID I/O CONN. (NON FLANGE)

SIZE: A1 00779 178780

CUSTOMER DRAWING

SCALE: 2:1 SHEET: 1 of 1 REV: P7