

Recommended PCB Layout  
(Top View)

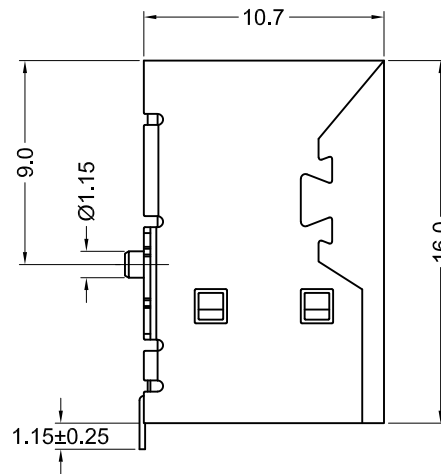
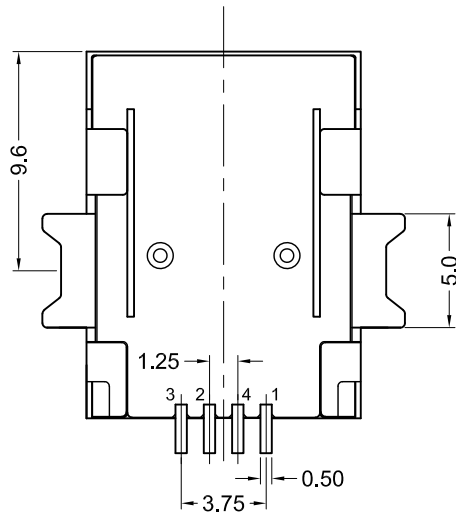

**Materials and Finish**

Insulator:  
High Temp. UL94V-0-Rated

Contact Material:  
Phosphor Bronze

Contact Plating Options:  
Standard: gold flash on contact area,  
Tin on soldertails, all over  
Nickel underplate

30 Option: 30u" gold on contact area,  
Tin on soldertails, all over  
Nickel underplate

Shell: Brass, nickel plated

**Electrical Specifications**

Contact Current Rating:  
1.0A AC/DC

Voltage Rating:  
30V AC/DC

Contact Resistance:  
20 mohm max.

Insulation Resistance:  
1000 Mohm min.

Dielectric Withstanding Voltage:  
750V AC for 1 Min.

Operating Temperature:  
-40°C to +105°C

Part Number	Insulator Color	Contact Area Plating Finish	Packaging
KUSBEX-SMT-BS1N-WTR	White	Gold Flash (standard)	Tape & Reel
KUSBEX-SMT-BS1N-W30TR	White	30u" Gold (30 option)	Tape & Reel
KUSBEX-SMT-BS1N-BTR	Black	Gold Flash (standard)	Tape & Reel
KUSBEX-SMT-BS1N-B30TR	Black	30u" Gold (30 option)	Tape & Reel



Tolerances
X.X ± 0.25
X.XX ± 0.15
Unless Stated Otherwise

REV.	DATE	DESCRIPTION	REV. BY	CHK. BY	DRAWN BY	DATE
A3	06/24/08	ECO# 08-059	S. Vien	H. MA	WILL H.	11/15/07
A4	01/09/09	ECO# 09-003	S. Vien	H. MA		
A5	05/14/09	Add Pin #	S. Vien	H. MA		
A6	02/10/11	ECO #11-009	S. Vien	H. MA		
A7	05/08/13	ECO #13-020	W. Cook	P. DalCanto		UNITS
A8	08/09/18	Update Address & RoHS	C. Kelleher	C. Furumasa		mm

KUSBEX-SMT-BS1N-xxx

Right Angle USB B-Type Receptacle

SMT, RoHS Compliant

