

H
G
F
E
D
C
B
A

LOOSE PIECE		SPECIFICATIONS				
MATERIAL NUMBER	ENGINEERING NUMBER	STUD SIZE	"S" ±.005 [0.13]	"W" ±.010 [0.25]	"C" MIN.	"L" MAX.
191960075	C-541-06	6	.146 [3.71]	.375 [9.53]	.301 [7.65]	1.232 [31.29]
191960077	C-541-08	8	.173 [4.39]			
191960068	C-541-10	10	.198 [5.03]			

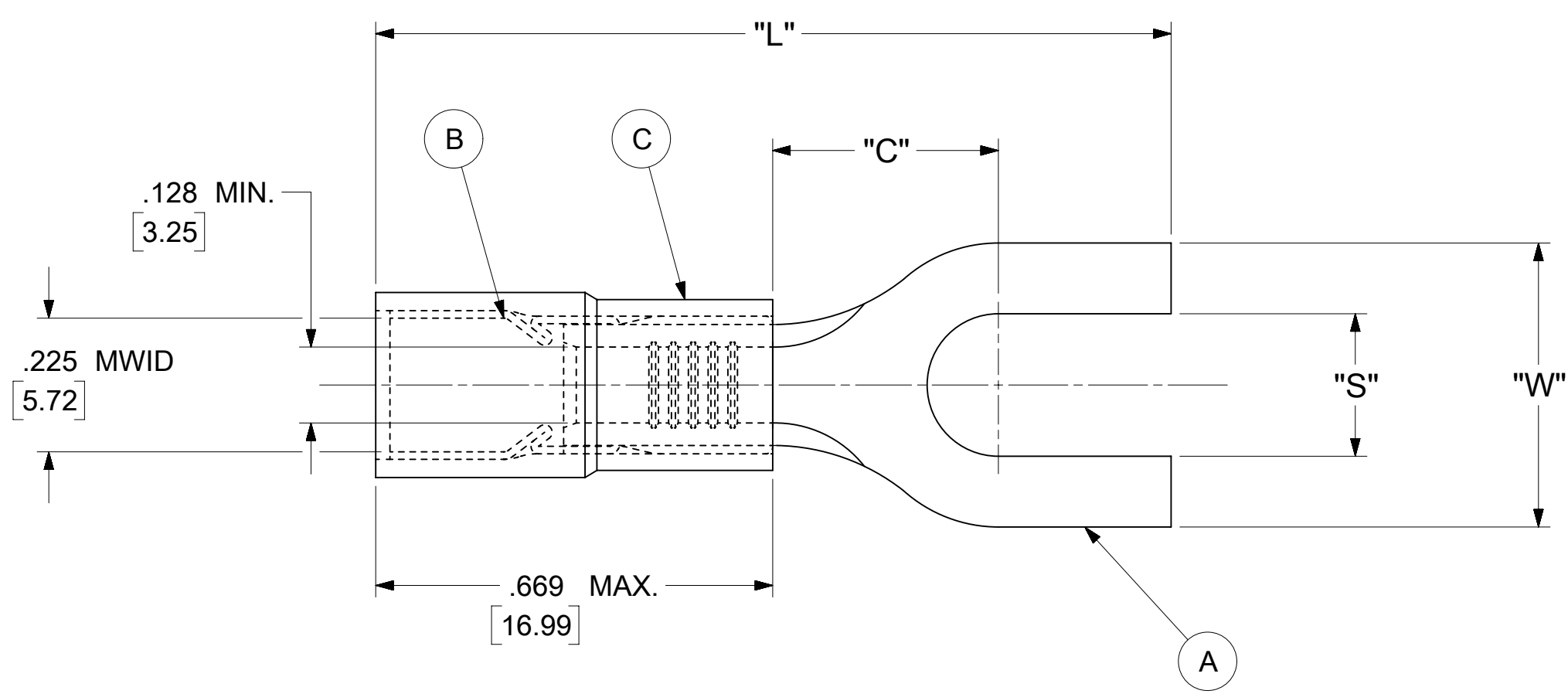

NOTES:

- MATERIAL:
 - (A). TERMINAL: COPPER (STOCK THICKNESS .040±.001 [1.02])
PLATING: ELECTRO-TIN (.0003 MIN.)
 - (B). TIN-PLATED BRASS FUNNEL FERRULE
 - (C). INSULATION: NYLON (COLOR CODED YELLOW)
- MWID: MAXIMUM WIRE INSULATION DIAMETER
- WIRE SIZE: 12 -10 AWG
4.0 -6.0 MM²
- "UL" LISTING #E32244
"CSA" LISTING #18689
- ALL DIMENSIONS IN INCHES/[MM].
- PARTS ARE ROHS COMPLIANT.
- DIMS. SHOWN ARE FOR REFERENCE ONLY.

SYMBOLS	THIS DRAWING CONTAINS INFORMATION THAT IS PROPRIETARY TO MOLEX ELECTRONIC TECHNOLOGIES, LLC AND SHOULD NOT BE USED WITHOUT WRITTEN PERMISSION					
	DIMENSION UNITS	SCALE		CURRENT REV DESC: MIGRATION TO ECTR/NX		
▽ = 0	INCH/MM	NTS		EC NO: 621658 DRWN: ABENJAMINLW 2019/07/29 CHK'D: GROJAS01 2019/07/31 APPR: JMACNEIL 2019/08/05		
▽ = 0	GENERAL TOLERANCES (UNLESS SPECIFIED)		INITIAL REVISION:			
▽ = 0		MM	INCH			DRWN: JJ 1984/11/15
▽ = 0	4 PLACES	± ---	± ---	APPR: JMACNEIL 2019/08/05	DOCUMENT NUMBER: 191960075 DOC TYPE: PSD DOC PART: 000 REVISION: A	
▽ = 0	3 PLACES	± ---	± .005	DRWN: JJ 1984/11/15		
▽ = 0	2 PLACES	± 0.13	± .01	APPR: JMACNEIL 2019/08/05	MATERIAL NUMBER: SEE TABLE CUSTOMER: GENERAL MARKET SHEET NUMBER: 1 OF 1	
▽ = 0	1 PLACE	± 0.25	± ---	THIRD ANGLE PROJECTION		
▽ = 0	0 PLACES	± ---	± ---	DRAFT WHERE APPLICABLE MUST REMAIN WITHIN DIMENSIONS		
▽ = 0		ANGULAR TOL ± 0.5 °		DRAWING: C-SIZE	SERIES: 19196	



SPADE TONGUE TERMINAL
AVIKRIMP - 500 SERIES

PRODUCT CUSTOMER DRAWING