

| REV. | ECD | DESCRIPTION | DATE | BY |
|------|------|---------------------------------------|------------|-----|
| A | 644 | INITIAL RELEASE | 6/15/2005 | TT |
| B | 879 | ADDED .60mm TO 'B' DIM | 12/28/2005 | TT |
| C | 1046 | CLARIFY TOP/BOTTOM ENTRY AS SAME PART | 12/28/2005 | MNH |

| No. of Positions | DIMENSIONS | | |
|------------------|------------|-------|-------|
| | A | B | C |
| 5 | 8.00 | 10.60 | 6.00 |
| 6 | 10.00 | 12.60 | 8.00 |
| 7 | 12.00 | 14.60 | 10.00 |
| 8 | 14.00 | 16.60 | 12.00 |
| 9 | 16.00 | 18.60 | 14.00 |
| 10 | 18.00 | 20.60 | 16.00 |
| 11 | 20.00 | 22.60 | 18.00 |
| 12 | 22.00 | 24.60 | 20.00 |
| 13 | 24.00 | 26.60 | 22.00 |
| 14 | 26.00 | 28.60 | 24.00 |
| 15 | 28.00 | 30.60 | 26.00 |
| 16 | 30.00 | 32.60 | 28.00 |
| 17 | 32.00 | 34.60 | 30.00 |
| 18 | 34.00 | 36.60 | 32.00 |
| 19 | 36.00 | 38.60 | 34.00 |
| 20 | 38.00 | 40.60 | 36.00 |
| 21 | 40.00 | 42.60 | 38.00 |
| 22 | 42.00 | 44.60 | 40.00 |
| 23 | 44.00 | 46.60 | 42.00 |
| 24 | 46.00 | 48.60 | 44.00 |
| 25 | 48.00 | 50.60 | 46.00 |
| 26 | 50.00 | 52.60 | 48.00 |
| 27 | 52.00 | 54.60 | 50.00 |
| 28 | 54.00 | 56.60 | 52.00 |
| 29 | 56.00 | 58.60 | 54.00 |
| 30 | 58.00 | 60.60 | 56.00 |
| 31 | 60.00 | 62.60 | 58.00 |
| 32 | 62.00 | 64.60 | 60.00 |
| 33 | 64.00 | 66.60 | 62.00 |
| 34 | 66.00 | 68.60 | 64.00 |
| 35 | 68.00 | 70.60 | 66.00 |
| 36 | 70.00 | 72.60 | 68.00 |
| 37 | 72.00 | 74.60 | 70.00 |
| 38 | 74.00 | 76.60 | 72.00 |
| 39 | 76.00 | 78.60 | 74.00 |
| 40 | 78.00 | 80.60 | 76.00 |

NOTE: Number of contacts (pins) is not the same as the number of positions. For this dual row connector, each position has 2 contacts (pins).

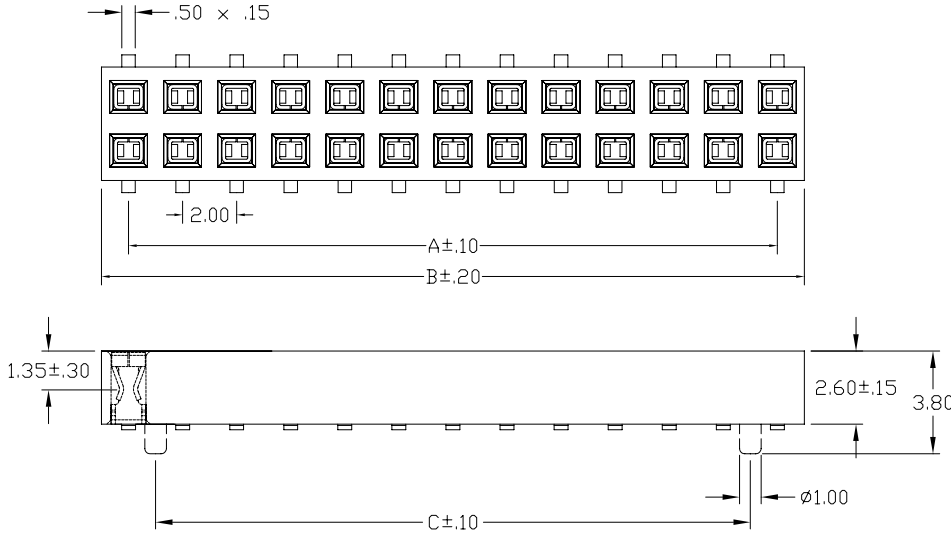

SPECIFICATIONS

Current Rating: 1 Amp
 Insulator resistance: 5000 Megohms min.
 Contact resistance: 20 m ohms max.
 Dielectric withstanding: AC 500 V
 Operating Temperature: -40° to +105°C
 Max Processing Temp: 230°C for 30-60 seconds (260°C for 10 seconds)
 Contact Material: Phosphor Bronze.
 Insulator Material: Nylon-6T
 Contacts Plating: Gold flash overall

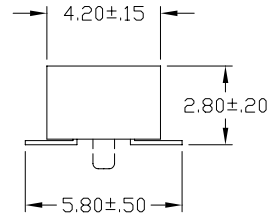

RECOMMENDED P.C. BOARD SMT LAYOUT

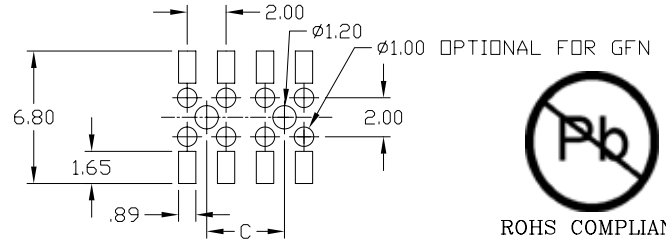

PART NUMBER CODING
 NPPNxx2GxNx-RC

MOUNTING STYLE
 P - SURFACE MOUNT W/ GUIDE PINS
 S - SURFACE MOUNT W/O GUIDE PINS

ENTRY TYPE
 F - TOP
 H - BOTTOM

NUMBER OF POSITIONS
 (5 - 40)

NOTE: TOP AND BOTTOM ENTRY PARTS ARE IDENTICAL AND INTERCHANGABLE

| | | | | | | | | |
|---|--------------------------|--------|------------------|------------------|-----------------------|-----------------------------|---|------------------|
| Sullins Electronics 801 E. Mission Rd. San Marcos, CA 92069 | GENERAL TOLERANCE | | SCALE NTS | DRAWN TT | DATE 6/15/2005 | DWG. NO. 10496 | TITLE 2.00mm FEMALE HEADER TOP/BOTTOM ENTRY, SMT 2.80mm INSULATOR | REV. C |
| | XX. ± | XXX. ± | UNIT MM | CHECK MNH | DATE 6/15/2005 | | | SHEET |
| | X. ± 0.20 | .XXX ± | SIZE | APPROVE | DATE | PARTS NO. NPPNxx2GxNx-RC | | |
| | .X ± 0.10 | X.* ± | | | | | | |
| .XX ± 0.05 | .X.* ± | | | | | | | |