

- 1
- 2
- 3
- 4
- 5
- 6
- 7
- 8
- 9
- 10
- 11
- 12
- 13
- 14
- 15

**MATERIAL**

Glass-fibre reinforced polyamide based (PA) technopolymer, black colour, matte finish.

**CLOSING CAP**

Polypropylene based (PP) technopolymer, orange or black colour, glossy finish with matte central surface, snap-in mounting.

**STANDARD EXECUTIONS**

- **VTL-B:** brass boss, threaded blind hole.
- **VTL-p:** zinc-plated steel threaded stud, chamfered flat end according to UNI 947: ISO 4753 (see Technical data on page A-11).

**FEATURES AND APPLICATIONS**

The long cone-shaped body of this knob is especially designed to clamp elements placed at a distance from the operator or in difficult to access places.

**SPECIAL EXECUTIONS ON REQUEST**

On the surface of the closing cap words, marks, graphic symbols, etc... can be tampprinted in colours.



FMdesign

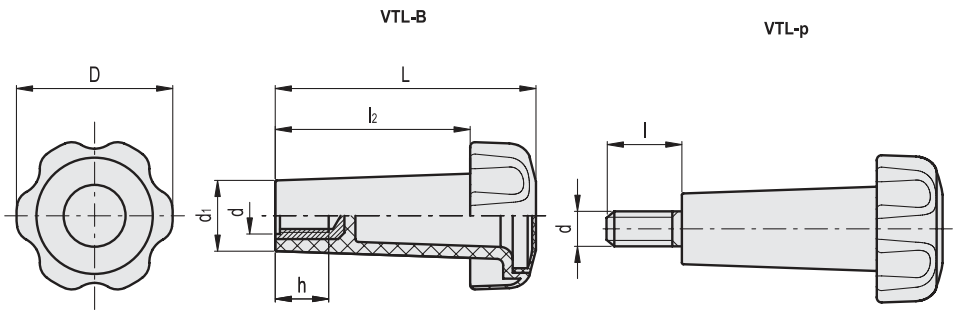

| Conversion Table<br>1 mm = 0.039 inch |      |    |      |
|---------------------------------------|------|----|------|
| D                                     |      | L  |      |
| mm                                    | inch | mm | inch |
| 50                                    | 1.97 | 82 | 3.23 |

**C2** RAL2004    **C9** RAL9005

**METRIC**

**VTL-B**

| Code   | Description        | D  | d6H | L  | d1   | l2 | h  | △△ |
|--------|--------------------|----|-----|----|------|----|----|----|
| 182222 | VTL.50/80 B-M10-C2 | 50 | M10 | 82 | 22.5 | 62 | 17 | 48 |
| 182223 | VTL.50/80 B-M10-C9 | 50 | M10 | 82 | 22.5 | 62 | 17 | 48 |

**VTL-p**

| Code   | Description           | D  | d6g | L  | d1   | l  | l2 | △△ |
|--------|-----------------------|----|-----|----|------|----|----|----|
| 182232 | VTL.50/80 p-M10x20-C2 | 50 | M10 | 82 | 22.5 | 20 | 62 | 60 |
| 182233 | VTL.50/80 p-M10x20-C9 | 50 | M10 | 82 | 22.5 | 20 | 62 | 60 |
| 182238 | VTL.50/80 p-M10x50-C2 | 50 | M10 | 82 | 22.5 | 50 | 62 | 75 |
| 182239 | VTL.50/80 p-M10x50-C9 | 50 | M10 | 82 | 22.5 | 50 | 62 | 75 |

Clamping knobs