

LOC		DIST		REVISIONS			
P	LTR	DESCRIPTION	DATE	DNW	APVD		
A		RELEASED	11-2-11	CT	KH		

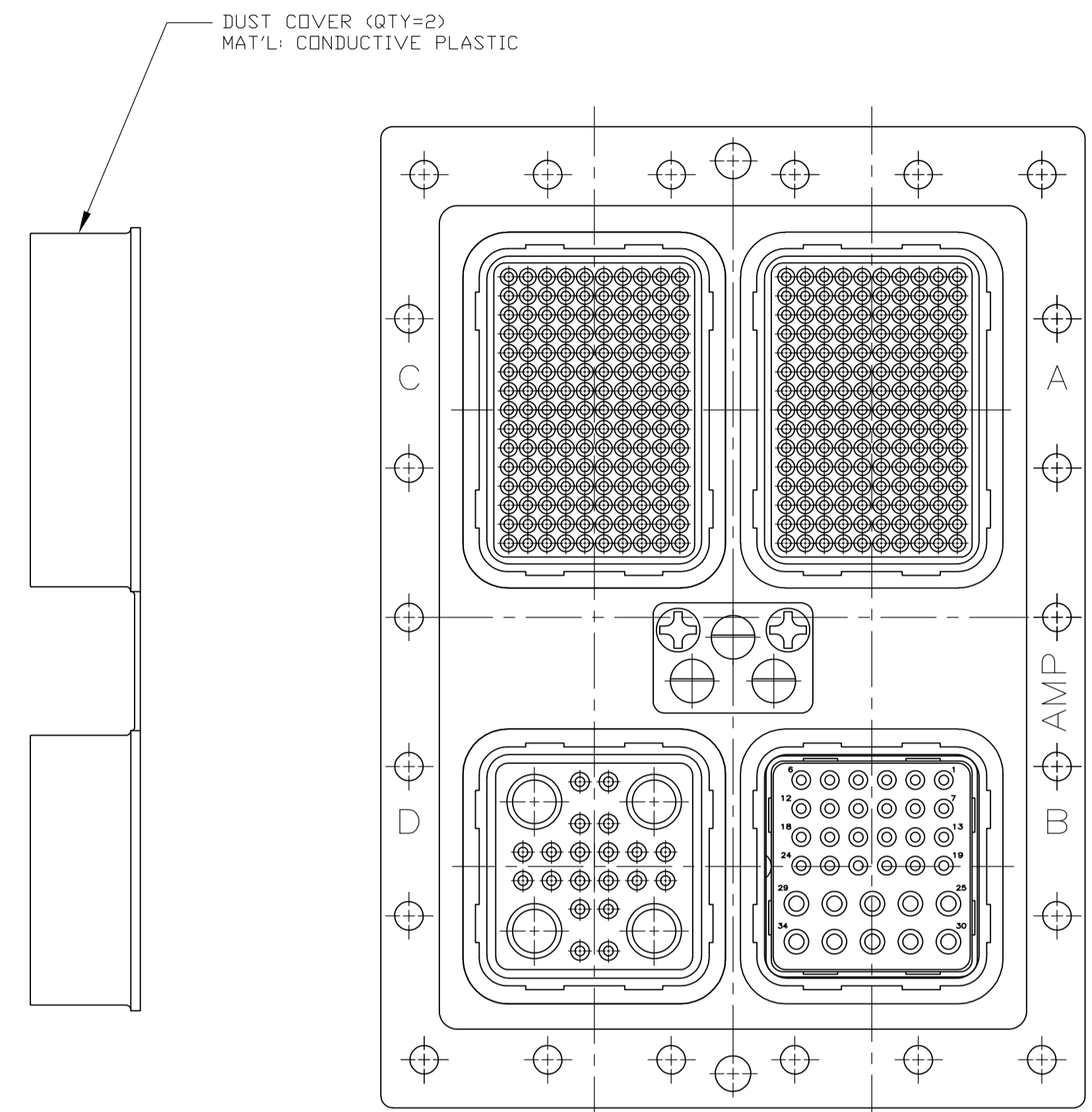
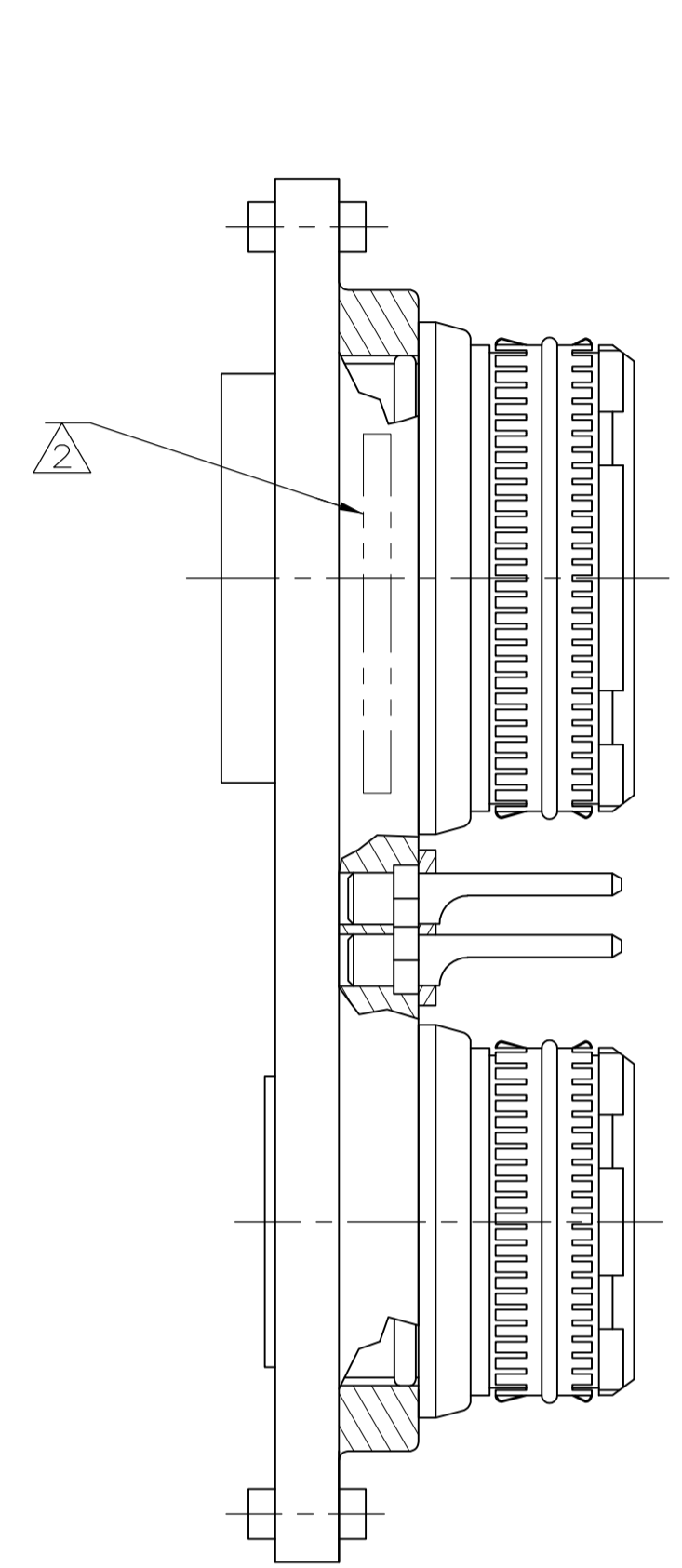
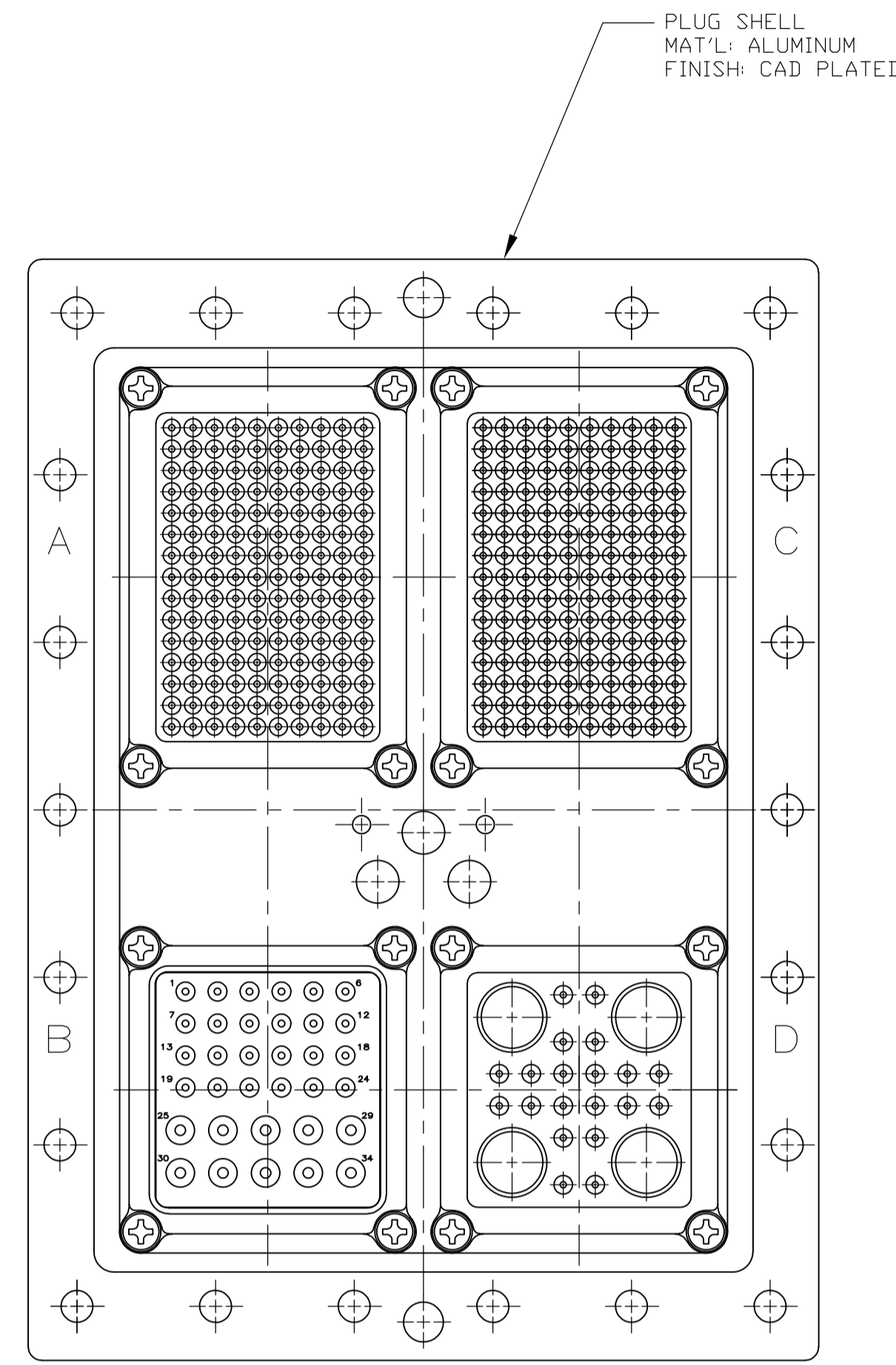

- KEYING SHOWN IN POSITION "01" FOR REFERENCE ONLY. SEE TABLE FOR KEYING POSITION. FOR POSITION "00" KEYING SHIPPED UNASSEMBLED.
- TE PART NO., CUSTOMER PART NO. (PER TABLE) & DATE CODE WITH MARKED WITH .047 MIN. HIGH CHARS. IN THIS AREA.
- CONTACT ARE INCLUDED BUT NOT INSTALLED:  
 SIZE 22 CRIMP PIN CONTACT; TE P/N 211901-5; QTY=300  
 SIZE 20 CRIMP SOCKET CONTACT; TE P/N 208267-4; QTY=44  
 SIZE 16 CRIMP SOCKET CONTACT; TE P/N 208270-4; QTY=10  
 SIZE 8 TRIAX SOCKET CONTACT; TE P/N 222191-1; QTY=4
- DUST COVERS INSTALLED BEFORE SHIPPING.

600069W301A87 05A069W301A87	"87"	2-213017-3
600069W301A69 05A069W301A69	"69"	2-213017-2
600069W301A56 05A069W301A56	"56"	2-213017-1
600069W301A68 05A069W301A68	"68"	2-213017-0
600069W301A85 05A069W301A85	"85"	1-213017-9
600069W301A78 05A069W301A78	"78"	1-213017-8
600069W301A74 05A069W301A74	"74"	1-213017-7
600069W301A84 05A069W301A84	"84"	1-213017-6
600069W301A83 05A069W301A83	"83"	1-213017-5
600069W301A82 05A069W301A82	"82"	1-213017-4
600069W301A81 05A069W301A81	"81"	1-213017-3
600069W301A80 05A069W301A80	"80"	1-213017-2
600069W301A77 05A069W301A77	"77"	1-213017-1
600069W301A75 05A069W301A75	"75"	1-213017-0
600069W301A73 05A069W301A73	"73"	213017-9
600069W301A70 05A069W301A70	"70"	213017-8
600069W301A67 05A069W301A67	"67"	213017-7
600069W301A66 05A069W301A66	"66"	213017-6
600069W301A55 05A069W301A55	"55"	213017-5
600069W301A51 05A069W301A51	"51"	213017-4
600069W301A31 05A069W301A31	"31"	213017-3
600069W301A17 05A069W301A17	"17"	213017-2
600069W301A07 05A069W301A07	"07"	213017-1
CUSTOMER PART NO.	KEYING POSITION	TE PART NO.

THIS DRAWING IS A CONTROLLED DOCUMENT.

DIMENSIONS: INCHES	TOLERANCES UNLESS OTHERWISE SPECIFIED:	0 PLC ± .005	1 PLC ± .005	2 PLC ± .005	3 PLC ± .005	4 PLC ± .005	ANGLES ± .005				
MATERIAL SEE CALLOUTS	FINISH SEE CALLOUTS	WEIGHT	—	SIZE	A1	CAGE CODE	00779	DRAWING NO.	213017	RESTRICTED TO	—
CUSTOMER DRAWING		SCALE		3:2	SHEET		1 OF 1	REV		A	

APPROVED: K. HOGAN  
DATE: 11-2-11

TE Connectivity  
PLUG ASSY, MIL 600, SIZE 3A (150/34/150/24C4)