

WIRING DIAGRAM

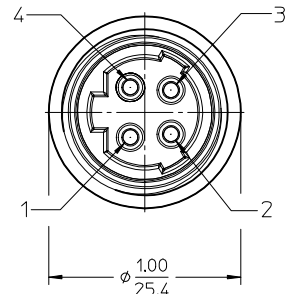
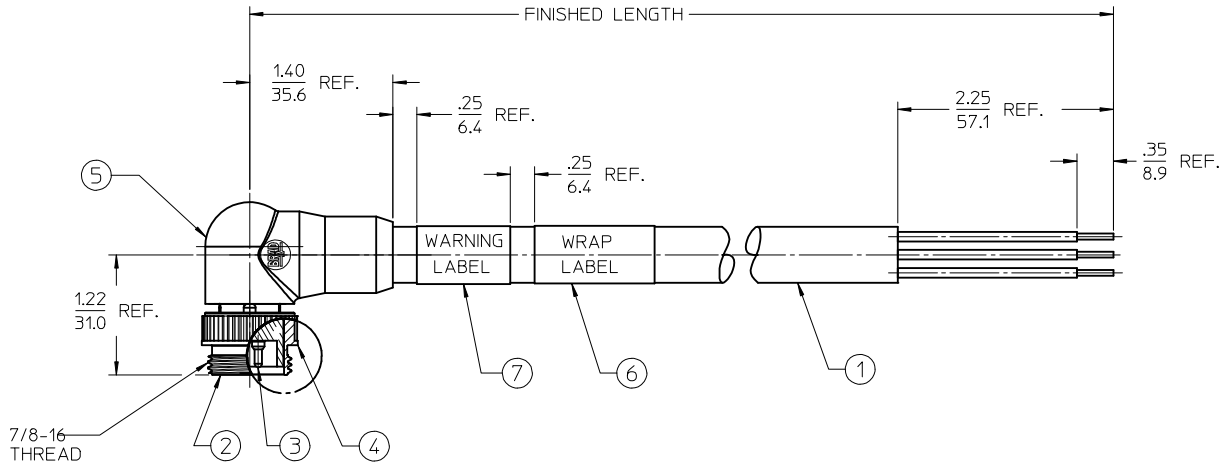

MALE FACE VIEW
SCALE: 2X

- NOTES:
- 1) MATERIAL: SEE TABLE
 - 2) FINISHES: SEE TABLE
 - 3) WRAP LABEL IS MARKED WITH P/N, DATE CODE VOLTAGE & AMPERAGE
 - 4) MATES WITH: MINI CHANGE 4 POLE RECEPTACLE (ALT KEY)
 - 5) ELECTRICAL DATA:
14AWG UL TYPE: TC-ER STRANDED CABLE
MAX VOLTAGE: 600V
MAX CURRENT: 15A
PROTECTION IP67 (WHEN MATED)
TEMPERATURE RANGE: -20°C TO 90°C
 - 6) PACKAGING:
CABLE ASSEMBLIES ARE BAGGED SEPERATLY IN POLY BAGS WITH BAR CODE LABEL ATTACHED TO OUTSIDE OF BAG.

PART NUMBER LEGEND

104107K21MXXX

MC 4P SINGLE END, MALE 90 DEG. ALT KEY
CABLE TYPE: 14 AWG TC ER, BLACK
FINISHED LENGTH:
M001= .1M
M010= 1.0M
M100= 10.0M

7	1	WARNING LABEL	VINYL	ORANGE/BLACK
6	1	WRAP LABEL	VINYL	BLACK/YELLOW
5	1	OVERMOLD	PVC	BLACK
4	1	MALE COUPLING NUT	ZINC ALLOY	BLACK
3	4	CONTACT PIN	Cu ALLOY	GOLD PLATE
2	1	MALE INSERT	PVC	BLACK
1	SEE NOTE 5	CABLE	TPE	BLACK
ITEM	QTY	DESCRIPTION	MATERIAL	FINISH

RELEASED	EC NO: IPG2016-0734	2015/11/13
DRWRSTONE	2015/12/09	
CHKD:KJOZWIK	2016/02/29	
APPR: BWOODMAN		
DESCRIPTION		

QUALITY SYMBOLS	GENERAL TOLERANCES (UNLESS SPECIFIED)
▽=0	
▽=0	
	ANGULAR ± 1°
	DRAFT WHERE APPLICABLE MUST REMAIN WITHIN DIMENSIONS

DIMENSION STYLE		SCALE	DESIGN UNITS
IN/MM		1:1	INCH
DRAWN BY	DATE	TITLE	
RSTONE	2015/11/13	MINI CHANGE CABLE ASSY	
CHECKED BY	DATE	MALE, S/E, ALT KEY	
KJOZWIK	2015/12/09	90 DEG, EXTERNAL THREAD	
APPROVED BY	DATE	molex	
BWOODMAN	2016/02/29	DOCUMENT NO. SD-130061-037	
MATERIAL NO.		SHEET NO. 1 OF 1	

THIRD ANGLE PROJECTION	
THIS DRAWING CONTAINS INFORMATION THAT IS PROPRIETARY TO MOLEX INCORPORATED AND SHOULD NOT BE USED WITHOUT WRITTEN PERMISSION	