

Recommended P.C. Board Layout
SCALE 4:1

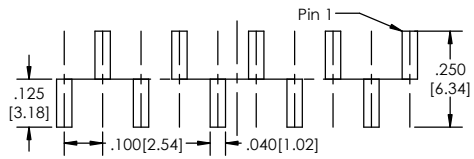

SINGLE (M) ROW

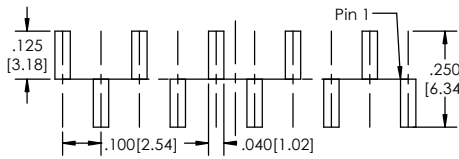

SINGLE (S) ROW

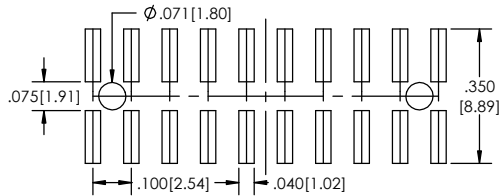

DOUBLE ROW

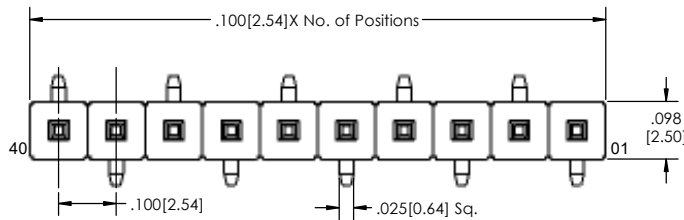

SINGLE (S) ROW

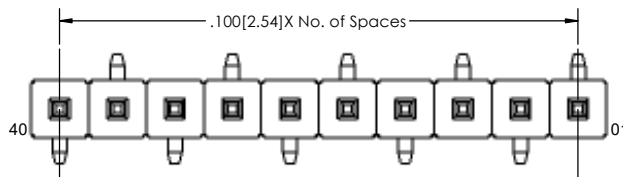

SINGLE (M) ROW

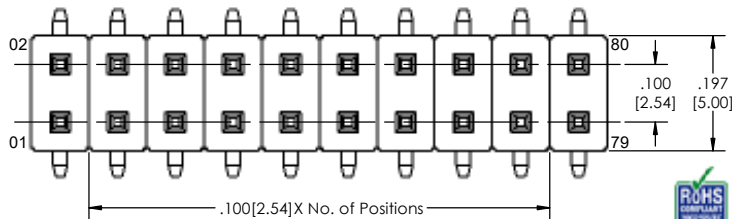

DOUBLE ROW

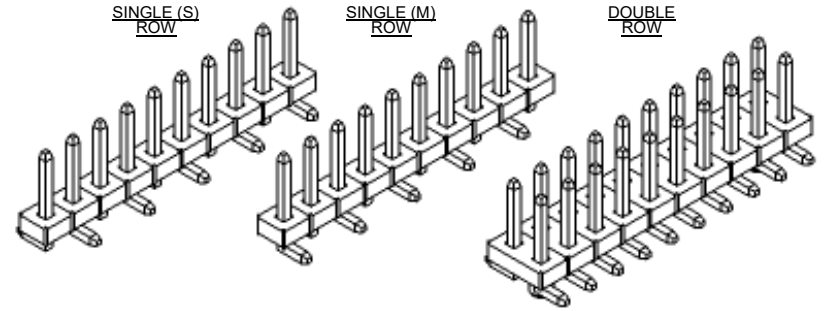
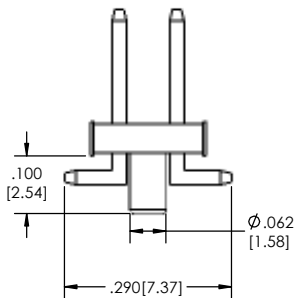
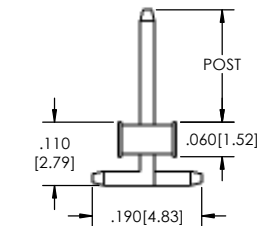

ULTSHSM-1 [XX] - [X] - [XX] - [XX] - [X] - [XXX] - [X] - [XX] - [X] - [XX] - [LF]
(A) (B) (C) (D) (E) (F) (G) (H) (I) (J) (K)

- A. Pins Per Row
- 1 through 40
- B. Row Specification
- S= Single
- D= Double
- C. Pin Options
- See Pin Options below
- D. Plating Options
- See Plating Options below
- E. Direction
- V= Vertical
- F. Polarized Position
- Leave blank if not needed
- If required, specify empty pin position
- e.g. 012 for Pin 12
- G. Footprint
- S= pin 1 left
- M= pin 1 right
- H. Packing Information
- TR= Tape and Reel
- TB= Tube
- I. Pad
- P= Plastic
- O= No Pad
- If left blank, packaging at MLE's discretion
Pad may be metal, mylar or plastic
- J. Alignment Pin Option
- Leave blank if not needed
- AP= With
- K. Lead Free

Mates with:
BCSS.
BSSH.
BSSH.C.
BSSQ.
BSSQ.C.
BSSQ.M.
LBCSS.
LSMBC.
LSWSS.
SMBC.
SSHQ.
SSHQ.R.
SSHR.
SSHS.
SSHSM.

Plating options	
G	-10µ Gold on Contact Area/ Flash on Tail
T	-Matte Tin all Over
GT	-10µ Gold on Contact Area/ Matte Tin on Tail
H	-30µ Gold on Contact Area/ Matte Tin on Tail
F	-Gold Flash over Entire Pin
FT	- Gold Flash on Contact Area/ Matte Tin on Tail

Specifications:
Current Rating: 3.0 Ampere
Insulation Resistance: 1000M Ohms Min.
Dielectric Withstanding: 600V AC
Contact Resistance: 20M Ohms Max.
Operation Temperature: -40°C to +105°C
Max. Process Temperature
Peak: 260°C up to 20 secs.
Process: 230°C up to 60 secs.
Wave: 260°C up to 6 secs.
Reflow: 260°C up to 10 secs.
Manual Solder: 350°C up to 5 secs.

Pin Options		
Post Height		
.120	3.05mm	01
.140	3.56mm	02
.175	4.45mm	03
.270	6.86mm	06

Materials:
Contact Material: Phosphor Bronze
Insulator Material: Nylon 6T
Plating: Au or Sn over 50µ" (1.27) Ni
Tails may be clipped to achieve specific dimensions.
Products cut to specific sizes are uncancelable/ nonreturnable.
Parts are subject to change without notice.

ROHS COMPLIANT
PROPRIETARY AND CONFIDENTIAL
THE INFORMATION CONTAINED IN THIS DRAWING IS THE SOLE PROPERTY OF Major League Electronics. ANY REPRODUCTION IN PART OR AS A WHOLE WITHOUT THE WRITTEN PERMISSION OF Major League Electronics IS PROHIBITED.

UNLESS OTHERWISE SPECIFIED:		DRAWN		EOW		DATE		07/05/16	
DIMENSIONS ARE IN INCHES		CHECKED		GWE		DATE		07/05/16	
TOLERANCES:		ENG APPR.							
ONE DECIMALS ±.100		MFG APPR.							
TWO DECIMALS ±.010									
THREE DECIMALS ±.005									
FOUR DECIMAL ±.002									
NEXT ASSY		USED ON		FINISH		ADDRESS:		2533 Centennial Blvd. Jeffersonville, IN 47130 Phone: 812-670-4174 Fax: 812-670-4175 E-Mail: mle@mlelectronics.com	
APPLICATION		DO NOT SCALE DRAWING				TITLE:		ULTSHSM-1 SERIES	
						SIZE		DWG. NO.	
						C		REV	
						SCALE 6:1		C	
								SHEET 1 OF 1	