

NOTES

- △1 材料及び仕上げ(めっき仕様) : TABLE 1 参照
MATERIAL AND FINISHES : SEE TABLE 1
- △2 適合ハウジング, 嵌合相手, 関連ドキュメントについては SHEET 2 を御参照下さい。
PLEASE REFER TO SHEET 2 FOR APPLICABLE HOUSING, MATING PARTNER AND RELATED DOCUMENTS.
- △3 トレードマーク : MXプラス1文字の製造工場を示す
アルファベットにて表示。
但し"J"はJAPANを示す。
FORMED BY MX AND 1 MORE LETTER OF ALPHABET WHICH MEAN THE MANUFACTORY.
BUT "J" MEANS JAPAN. (TO TRADE MARK) (ex MXJ)

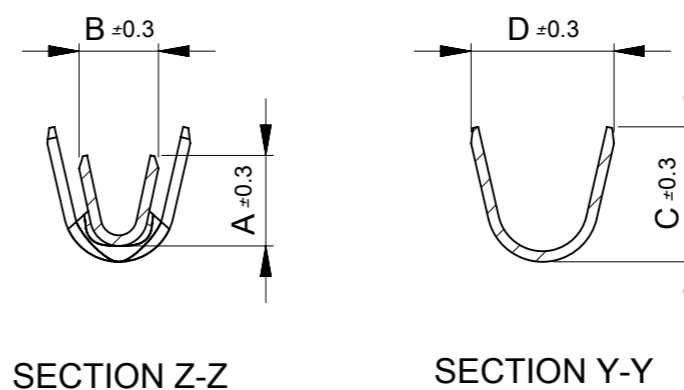
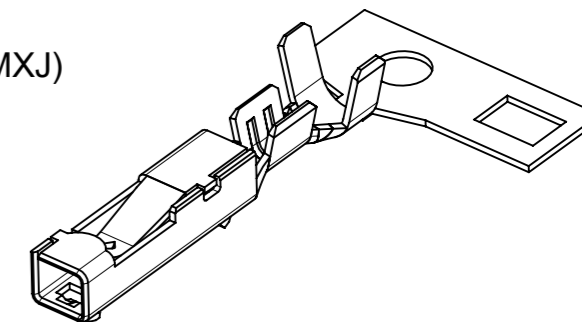

2.4	2.1	1.34	1.35	Φ1.15-1.4mm	AWG#26~28	ポリ袋 POLY BAG	503978102	バラ状 LOOSE
						リール REEL	503978002	連鎖状 CHAIN
2.7	2.55	1.5	1.71	Φ1.3-1.8mm	AWG#22~24	ポリ袋 POLY BAG	503978101	バラ状 LOOSE
						リール REEL	503978001	連鎖状 CHAIN
D	C	B	A	絶縁被覆外径範囲 INSULATION RANGE	適用電線範囲 WIRE RANGE	梱包形態 PACKAGING	発注番号 ORDER No.	端子形状 FORM

△1 TABLE 1

THIS DRAWING CONTAINS INFORMATION THAT IS PROPRIETARY TO MOLEX ELECTRONIC TECHNOLOGIES, LLC AND SHOULD NOT BE USED WITHOUT WRITTEN PERMISSION		CURRENT REV DESC:		molex		
DIMENSION UNITS	SCALE	EC NO: 649906				
mm	NTS	DRWN: HKOBAYASHI 2020/07/02		PRODUCT CUSTOMER DRAWING		
GENERAL TOLERANCES (UNLESS SPECIFIED)		CHK'D: AIDA 2020/11/25		DOCUMENT NUMBER		
ANGULAR TOL ± 3.0°		APPR: KOMURAKAMI 2020/11/25		503970001-SD		
4 PLACES ± 0.2	INITIAL REVISION:		DRWN: HKOBAYASHI 2020/07/02		DOC TYPE	DOC PART
3 PLACES ± 0.2	DRWN: HKOBAYASHI 2020/11/25		APPR: KOMURAKAMI 2020/11/25		PSD	000
2 PLACES ± 0.2	MATERIAL NUMBER		CUSTOMER		REVISION	
1 PLACE ± 0.2	SEE TABLE		GENERAL		A	
0 PLACES ± 0.2	SHEET NUMBER		1 OF 2			
DRAFT WHERE APPLICABLE MUST REMAIN WITHIN DIMENSIONS		THIRD ANGLE PROJECTION	DRAWING	SERIES	MATERIAL NUMBER	
			A3-SIZE	50397	SEE TABLE	

部品 PART		材質 MATERIAL	
ターミナル TERMINAL	MATERIAL	りん青銅 PHOSPHOR BRONZE	
	めっき PLATING	錫めっき : 0.9 MICRO METER MINIMUM MATTE TIN	リフロー処理(前めっき) REFLOW TREATMENT (PRE-PLATING)
DOCUMENT STATUS	P1	RELEASE DATE	2020/11/25 10:07:05

△ 適合製品及び各種仕様書
APPLICABLE PRODUCTS AND VARIOUS SPECIFICATIONS

圧着端子 梱包仕様書 PACKAGING SPECIFICATION OF CRIMP TERMINAL	PART NUMBER	SPECIFICATION NUMBER
	503978001 503978002	SPK-50397-001

適合ハウジング APPLICABLE HOUSING ----- シリーズ番号 SERIES No.	212209
適合リテーナー APPLICABLE RETAINER ----- シリーズ番号 SERIES No.	212213
適合嵌合相手 MATE WITH	THROUGH HOLE
	VERTICAL
シリーズ番号 SERIES No.	212210
製品仕様書 PRODUCT SPECIFICATION	2122090000-PS 000
取扱説明書 APPLICATION SPECIFICATION	2166940000-AS 000

製品嵌合図は各"適合嵌合相手"図面参照のこと
 MATING VIEW : REFER TO EACH "MATE WITH" PART DRAWING.

PRE-RELEASE
 REFERENCE
 USE ONLY

THIS DRAWING CONTAINS INFORMATION THAT IS PROPRIETARY TO MOLEX ELECTRONIC TECHNOLOGIES, LLC AND SHOULD NOT BE USED WITHOUT WRITTEN PERMISSION											
DIMENSION UNITS	SCALE	CURRENT REV DESC:									
mm	NTS										
GENERAL TOLERANCES (UNLESS SPECIFIED)		EC NO: 649906 DRWN: HKOBAYASHI 2020/07/02 CHK'D: AIDA 2020/11/25 APPR: KOMURAKAMI 2020/11/25 INITIAL REVISION: DRWN: HKOBAYASHI 2020/07/02 APPR: KOMURAKAMI 2020/11/25					CP-3.3 RECEPTACLE CRIMP TERMINAL				
ANGULAR TOL	± 3.0 °						PRODUCT CUSTOMER DRAWING				
4 PLACES	± 0.2						DOCUMENT NUMBER		DOC TYPE	DOC PART	REVISION
3 PLACES	± 0.2						503970001-SD		PSD	000	A
2 PLACES	± 0.2						MATERIAL NUMBER		CUSTOMER		SHEET NUMBER
1 PLACE	± 0.2						SEE TABLE		GENERAL		2 OF 2
0 PLACES	± 0.2										
DRAFT WHERE APPLICABLE MUST REMAIN WITHIN DIMENSIONS		THIRD ANGLE PROJECTION	DRAWING	SERIES							
			A3-SIZE	50397							