

NOTES:

- 1) MATERIALS:
HOUSING - LIQUID CRYSTAL POLYMER, UL94 V-0
WAFER DIELECTRIC - LIQUID CRYSTAL POLYMER, UL94 V-0
CONTACT - COPPER ALLOY
- 2) FINISHES: SEE SHEET 2
- 3) PRODUCT SPECIFICATION: THIS PART CONFORMS TO MOLEX SPECIFICATION PS-75018-001.
- 4) PACKAGING SPECIFICATION: THIS PART TO BE PACKAGED PER SPECIFICATION PK-75020-030.
- 5) APPLICATION SPECIFICATION: THIS PART TO BE APPLIED PER SPECIFICATION PS-75018-001. APPLICATION TOOL AND INSTRUCTIONS PER AS-75018-001.
- 6) MATING INFORMATION
THIS PART MATES WITH 75019-XXXX.
WILL MATE WITH MAXIMUM 1.27mm MIS-ALIGNMENT.
WILL MATE WITH MAXIMUM 0.5° MIS-ALIGNMENT.
- 7) FOR CIRCUIT DESIGNATION SEE SHEET 3
- 8) FOR PCB INFORMATION SEE SHEET 3
- 9) CIRCUITS IN THIS ZONE HAVE BEEN OMITTED TO SIMPLIFY THE MODEL. ACTUAL PRODUCT IS FULLY LOADED WITH TERMINALS.
- 10) APPLICATION TOOLING KEEP OUT AREA. NO COMPONENTS ALLOWED IN THIS AREA.
- 11) CONFORMS TO MOLEX COSMETIC SPECIFICATION PS-45499-002 & PS-45499-003, CLASS C.
- 12) MARKING: PART NUMBER, MOLEX LOGO, DATE CODE
- 13) RECOMMENDED DRILL SIZE 0.66±0.03 TO YIELD FINISHED PLATED THROUGH HOLE OF 0.55±0.05

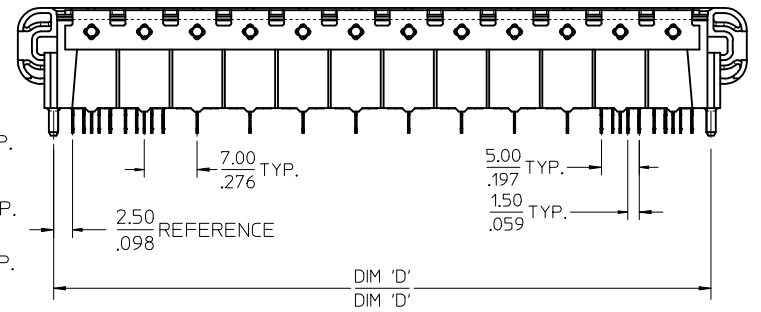
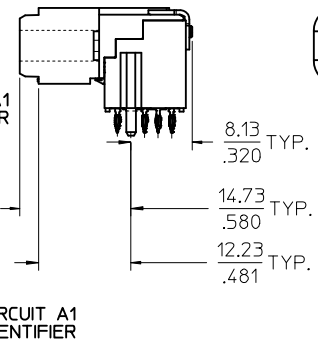
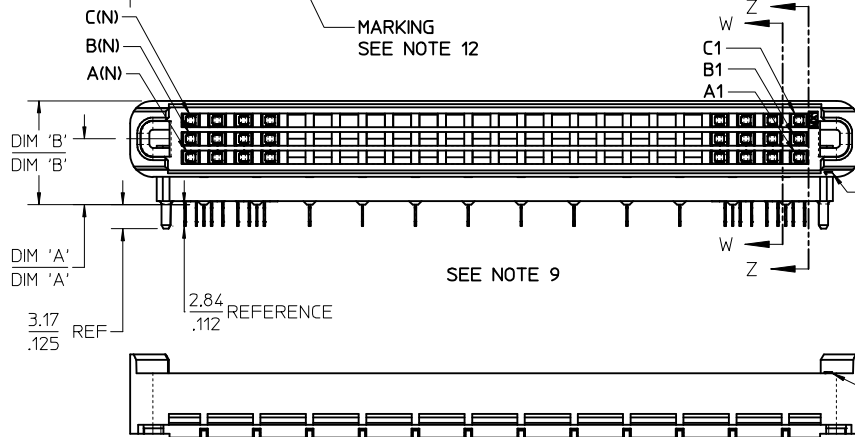
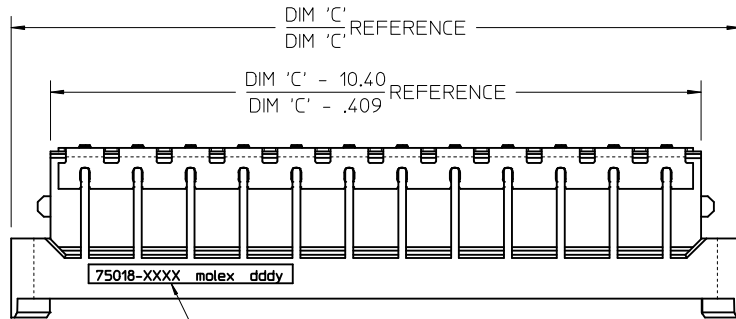

MOD PCB TAIL HOLE DIM EC NO: UCP2014-4737 DRWN: TIBARRA 2014/05/13 CHK: DMP/FF 2014/05/13 APPR: SMILLER 2014/05/12	DESCRIPTION REV:	QUALITY SYMBOLS	GENERAL TOLERANCES (UNLESS SPECIFIED)	DIMENSION STYLE	SCALE	DESIGN UNITS	THIRD ANGLE PROJECTION																		
		$\nabla = 0$ $\nabla = 0$ $\nabla = 0$	<table border="1"> <thead> <tr> <th></th> <th>mm</th> <th>INCH</th> </tr> </thead> <tbody> <tr> <td>4 PLACES</td> <td>± .005</td> <td>± .0005</td> </tr> <tr> <td>3 PLACES</td> <td>± .013</td> <td>± .01</td> </tr> <tr> <td>2 PLACES</td> <td>± 0.25</td> <td>± .01</td> </tr> <tr> <td>1 PLACE</td> <td>± .025</td> <td>± .01</td> </tr> <tr> <td>0 PLACE</td> <td>±</td> <td>±</td> </tr> </tbody> </table>		mm	INCH	4 PLACES	± .005	± .0005	3 PLACES	± .013	± .01	2 PLACES	± 0.25	± .01	1 PLACE	± .025	± .01	0 PLACE	±	±	MM/IN	2:1	METRIC	
			mm	INCH																					
		4 PLACES	± .005	± .0005																					
3 PLACES	± .013	± .01																							
2 PLACES	± 0.25	± .01																							
1 PLACE	± .025	± .01																							
0 PLACE	±	±																							
	<table border="1"> <thead> <tr> <th></th> <th>mm</th> <th>INCH</th> </tr> </thead> <tbody> <tr> <td>4 PLACES</td> <td>± .005</td> <td>± .0005</td> </tr> <tr> <td>3 PLACES</td> <td>± .013</td> <td>± .01</td> </tr> <tr> <td>2 PLACES</td> <td>± 0.25</td> <td>± .01</td> </tr> <tr> <td>1 PLACE</td> <td>± .025</td> <td>± .01</td> </tr> <tr> <td>0 PLACE</td> <td>±</td> <td>±</td> </tr> </tbody> </table>		mm	INCH	4 PLACES	± .005	± .0005	3 PLACES	± .013	± .01	2 PLACES	± 0.25	± .01	1 PLACE	± .025	± .01	0 PLACE	±	±	DRAWN BY: RWHIPPLE DATE: 2013/11/05 CHECKED BY: _____ DATE: _____ APPROVED BY: SMILLER DATE: 2013/11/19	TITLE	PLATEAU HS DOCK FIXED CONNECTOR NO GROUND FINGER molex	SHEET NO.		
	mm	INCH																							
4 PLACES	± .005	± .0005																							
3 PLACES	± .013	± .01																							
2 PLACES	± 0.25	± .01																							
1 PLACE	± .025	± .01																							
0 PLACE	±	±																							
		DRAFT WHERE APPLICABLE MUST REMAIN WITHIN DIMENSIONS	MATERIAL NO. SEE TABLE	DOCUMENT NO.	SD-75018-5000	1 OF 3																			

ITEM NUMBER	CIRCUIT SIZE	NO. OF COLUMNS 'N'	PLATING FINISH	CENTERLINE DIMENSION 'A' mm(in)	O/A HEIGHT DIMENSION 'B' mm(in)	O/A LENGTH DIMENSION 'C' mm(in)	PEG TO PEG DIMENSION 'D' mm(in)	FIRST-LAST DIMENSION 'E' mm(in)
75018-5021	144	24	FINISH 1	4.74 (.187)	9.78 (.385)	96.50 (3.799)	87.00 (3.425)	82.00 (3.228)
75018-5022	144	24	FINISH 1	5.74 (.226)	10.78 (.424)	96.50 (3.799)	87.00 (3.425)	82.00 (3.228)
75018-5023	144	24	FINISH 1	8.74 (.344)	13.78 (.543)	96.50 (3.799)	87.00 (3.425)	82.00 (3.228)
75018-5024	108	18	FINISH 1	4.74 (.187)	9.78 (.385)	75.50 (2.972)	66.00 (2.598)	61.00 (2.402)
75018-5025	108	18	FINISH 1	8.74 (.344)	13.78 (.543)	75.50 (2.972)	66.00 (2.598)	61.00 (2.402)
75018-5026	120	20	FINISH 1	4.74 (.187)	9.78 (.385)	82.50 (3.248)	73.00 (2.874)	68.00 (2.677)
75018-5027	108	18	FINISH 1	5.74 (.226)	10.78 (.424)	75.50 (2.972)	66.00 (2.598)	61.00 (2.402)
75018-5029	120	20	FINISH 1	5.74 (.226)	10.78 (.424)	82.50 (3.248)	73.00 (2.874)	68.00 (2.677)
75018-5221	144	24	FINISH 2	4.74 (.187)	9.78 (.385)	96.50 (3.799)	87.00 (3.425)	82.00 (3.228)
75018-5224	108	18	FINISH 2	4.74 (.187)	9.78 (.385)	75.50 (2.972)	66.00 (2.598)	61.00 (2.402)

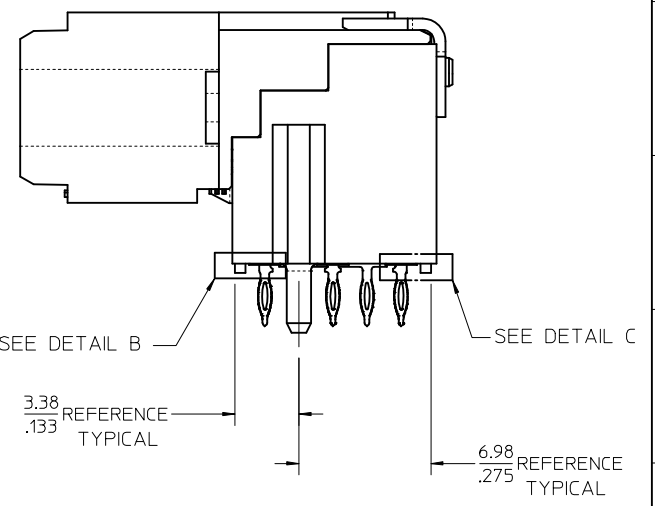
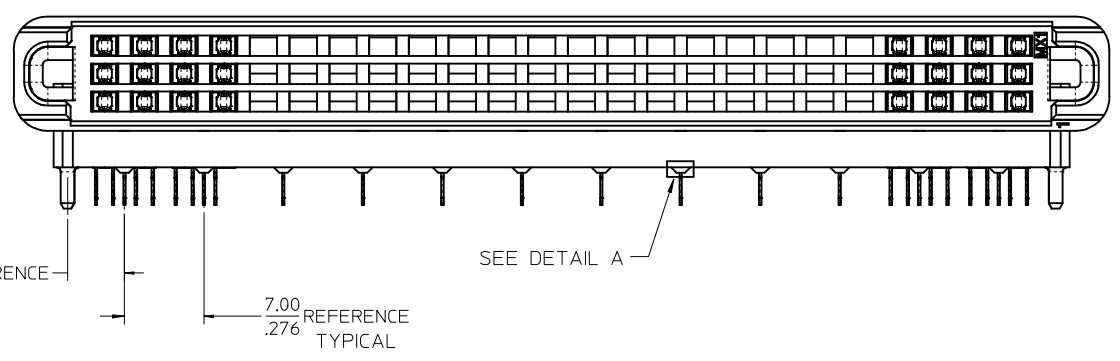

- 1) PLATING FINISHES:
- FINISH 1:
- CONTACT INTERFACE
 - 0.76 MICROMETERS/30 MICROINCHES MINIMUM SELECT GOLD
 - NICKEL UNDERPLATE OVERALL
 - COMPLIANT INTERFACE
 - 0.76 MICROMETERS/30 MICROINCHES MINIMUM SELECT MATTE-TIN OVER
 - NICKEL UNDERPLATE OVERALL
 - HOUSING
 - 3.81 MICROMETERS/150 MICROINCHES MINIMUM NICKEL OVER
 - COPPER UNDERPLATE OVERALL
- FINISH 2:
- CONTACT INTERFACE
 - 0.76 MICROMETERS/30 MICROINCHES MINIMUM SELECT GOLD
 - NICKEL UNDERPLATE OVERALL
 - COMPLIANT INTERFACE
 - 0.76 MICROMETERS/30 MICROINCHES MINIMUM SELECT MATTE-TIN OVER
 - NICKEL UNDERPLATE OVERALL
 - HOUSING
 - 0.10 MICROMETERS/4 MICROINCHES MAXIMUM GOLD OVER
 - 3.81 MICROMETERS/150 MICROINCHES MINIMUM NICKEL OVER
 - COPPER UNDERPLATE OVERALL

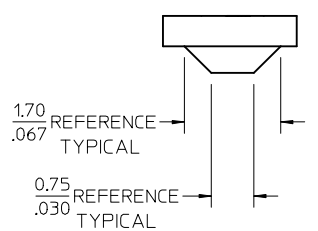

DETAIL A
SCALE 15:1

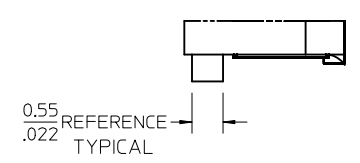

DETAIL B
SCALE 15:1

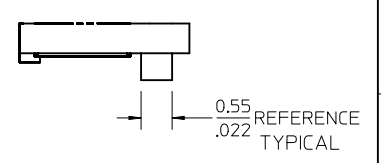

DETAIL C
SCALE 15:1

SEE SHEET 1 EC NO: UCP2014-4737 DRWNT:IBARRA 2014/05/13 CHKD:MPOFF 2014/05/13 APPR:SMILLER 2014/05/22	QUALITY SYMBOLS ▽=0 ▽=0 ▽=0	GENERAL TOLERANCES (UNLESS SPECIFIED)		DIMENSION STYLE	SCALE	DESIGN UNITS	THIRD ANGLE PROJECTION	
		mm	INCH	MM/IN	3:1	METRIC	☉	
		4 PLACES ± ---	± ---	DRAWN BY	DATE	PLATEAU HS DOCK FIXED CONNECTOR NO GROUND FINGER 		
		3 PLACES ± ---	± .005	RWHIPPLE	2013/11/05			
2 PLACES ± 0.13	± .01	CHECKED BY	DATE	DOCUMENT NO. SD-75018-5000 SHEET NO. 2 OF 3				
1 PLACE ± 0.25	± ---	APPROVED BY	DATE					
0 PLACE ±	±	SMILLER	2013/11/19	MATERIAL NO. SEE TABLE SIZE C				
ANGULAR ±1/2° DRAFT WHERE APPLICABLE MUST REMAIN WITHIN DIMENSIONS							THIS DRAWING CONTAINS INFORMATION THAT IS PROPRIETARY TO MOLEX INCORPORATED AND SHOULD NOT BE USED WITHOUT WRITTEN PERMISSION	

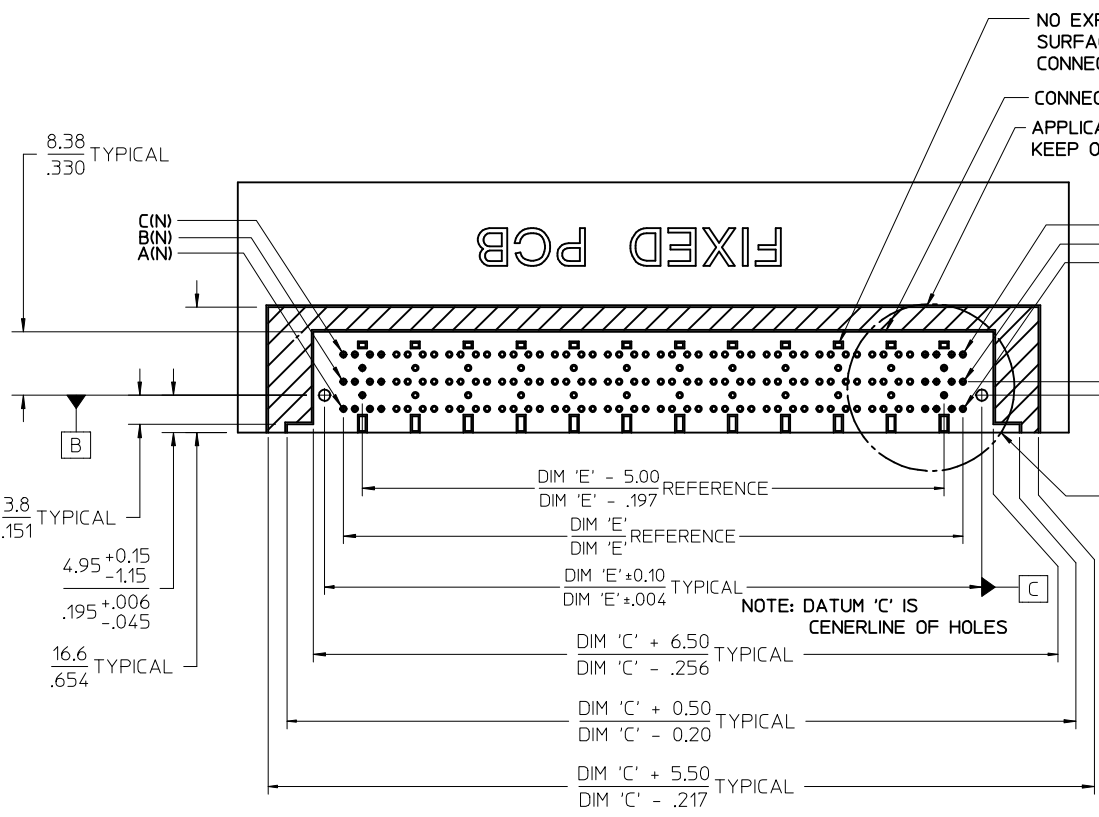

CIRCUIT DESIGNATION

FIRST MATE: HOUSING - SIGNAL GROUND
 SECOND MATE: A1, C1, A(N), C(N) (FOR POWER RETURN)
 THIRD MATE: A2, B2, C2, A(N-1), B(N-1), C(N-1) & ALL OTHERS (A2, C2, A(N-1) & C(N-1) FOR POWER) (ALL OTHERS SIGNAL)
 LAST MATE: B1, B(N) (FOR CARD DETECT)

ALL COLUMNS FROM 3 THROUGH (N-2) ARE SUITABLE FOR DIFFERENTIAL PAIRS
 EG: A3-A4, B3-B4, C3-C4, A(N-2)-A(N-3), B(N-2)-B(N-3)

SIGNAL GROUND: ROWS D & E

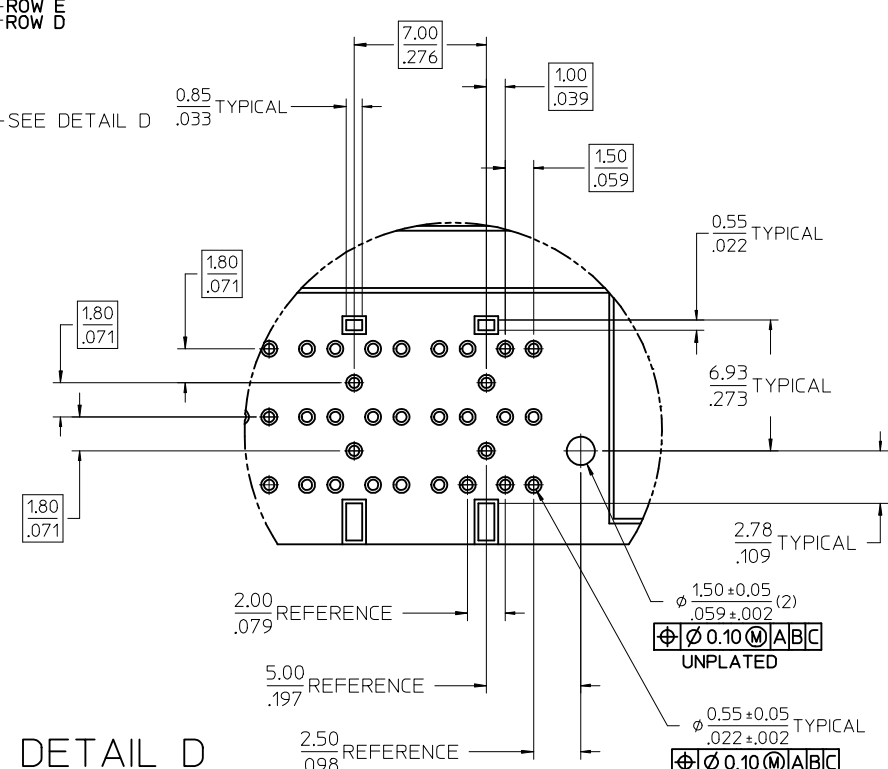

NOMINAL WIPE - FULL SEATED

FIRST MATE: 7.2mm
 SECOND MATE: 2.4mm
 THIRD MATE: 1.9mm
 LAST MATE: 1.4mm

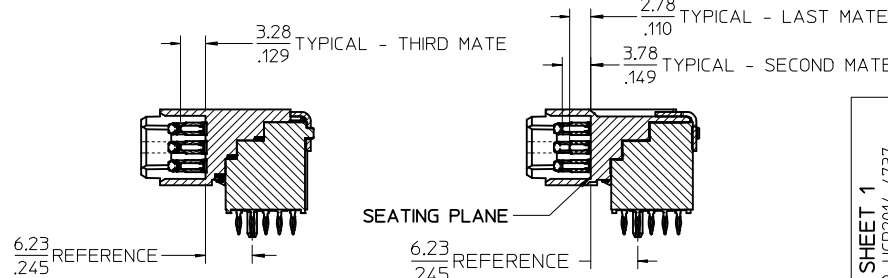

DETAIL D
 SCALE 5:1

SEE SHEET 1 EC NO: UCP2014-4737 DRWN: TIBARRA 2014/05/13 CHKD: MPOFF 2014/05/13 APPR: MILLER 2014/05/17	QUALITY SYMBOLS ▽=0 ▽=0 ▽=0	GENERAL TOLERANCES (UNLESS SPECIFIED)		DIMENSION STYLE MM/IN	SCALE 2:1	DESIGN UNITS METRIC	THIRD ANGLE PROJECTION
		4 PLACES ± --- ± ---	3 PLACES ± --- ± .005	DRAWN BY RWHIPPLE	DATE 2013/11/05	TITLE PLATEAU HS DOCK FIXED CONNECTOR NO GROUND FINGER	
D	DESCRIPTION REV	2 PLACES ± 0.13 ± .01	1 PLACE ± 0.25 ± ---	APPROVED BY SMILLER	DATE 2013/11/19	DOCUMENT NO. SD-75018-5000	
		0 PLACE ± ±	ANGULAR ±1/2°	MATERIAL NO. SEE TABLE		SHEET NO. 3 OF 3	
DRAFT WHERE APPLICABLE MUST REMAIN WITHIN DIMENSIONS		SIZE C		THIS DRAWING CONTAINS INFORMATION THAT IS PROPRIETARY TO MOLEX INCORPORATED AND SHOULD NOT BE USED WITHOUT WRITTEN PERMISSION			

SECTION W-W

SECTION Z-Z

molex