

## 3A, 400V ESD Capability Rectifier

### FEATURES

- High ESD capability
- Glass passivated chip junction
- Ideal for automated placement
- Low forward voltage drop
- High surge current capability
- Moisture sensitivity level: level 1, per J-STD-020
- RoHS Compliant
- Halogen-free according to IEC 61249-2-21

### APPLICATIONS

- Switching mode power supply (SMPS)
- Adapters
- Lighting application
- Converter

### MECHANICAL DATA

- Case: DO-214AB (SMC)
- Molding compound meets UL 94V-0 flammability rating
- Terminal: Matte tin plated leads, solderable per J-STD-002
- Meet JESD 201 class 2 whisker test
- Polarity: Indicated by cathode band
- Weight: 0.210g (approximately)

KEY PARAMETERS		
PARAMETER	VALUE	UNIT
$I_F$	3	A
$V_{RRM}$	400	V
$I_{FSM}$	100	A
$T_{J\ MAX}$	175	°C
Package	DO-214AB (SMC)	
Configuration	Single die	



**DO-214AB (SMC)**



SOLUTE MAXIMUM RATINGS ( $T_A = 25^\circ\text{C}$ unless otherwise noted)			
PARAMETER	SYMBOL	TSD3G	UNIT
Marking code on the device		TSD3G	
Repetitive peak reverse voltage	$V_{RRM}$	400	V
Reverse voltage, total rms value	$V_{R(RMS)}$	280	V
Forward current	$I_F$	3	A
Surge peak forward current, 8.3ms single half sine-wave superimposed on rated load	$I_{FSM}$	100	A
Junction temperature	$T_J$	- 55 to +175	°C
Storage temperature	$T_{STG}$	- 55 to +175	°C

<b>THERMAL PERFORMANCE</b>			
<b>PARAMETER</b>	<b>SYMBOL</b>	<b>TYP</b>	<b>UNIT</b>
Junction-to-lead thermal resistance	$R_{\theta JL}$	21	$^{\circ}C/W$
Junction-to-ambient thermal resistance	$R_{\theta JA}$	59	$^{\circ}C/W$
Junction-to-case thermal resistance	$R_{\theta JC}$	22	$^{\circ}C/W$

**Thermal Performance Note:** Units mounted on PCB (16mm x 16mm Cu pad test board)

<b>ELECTRICAL SPECIFICATIONS</b> ( $T_A = 25^{\circ}C$ unless otherwise noted)					
<b>PARAMETER</b>	<b>CONDITIONS</b>	<b>SYMBOL</b>	<b>TYP</b>	<b>MAX</b>	<b>UNIT</b>
Forward voltage <sup>(1)</sup>	$I_F = 1.5A, T_J = 25^{\circ}C$	$V_F$	0.85	0.95	V
	$I_F = 3.0A, T_J = 25^{\circ}C$		0.89	1.00	V
	$I_F = 1.5A, T_J = 125^{\circ}C$		0.72	0.90	V
	$I_F = 3.0A, T_J = 125^{\circ}C$		0.76	1.00	V
Reverse current @ rated $V_R$ <sup>(2)</sup>	$T_J = 25^{\circ}C$	$I_R$	-	1	$\mu A$
	$T_J = 125^{\circ}C$		-	50	$\mu A$
Junction capacitance	1MHz, $V_R = 4.0V$	$C_J$	45	-	pF

**Notes:**

1. Pulse test with PW = 0.3ms
2. Pulse test with PW = 30ms

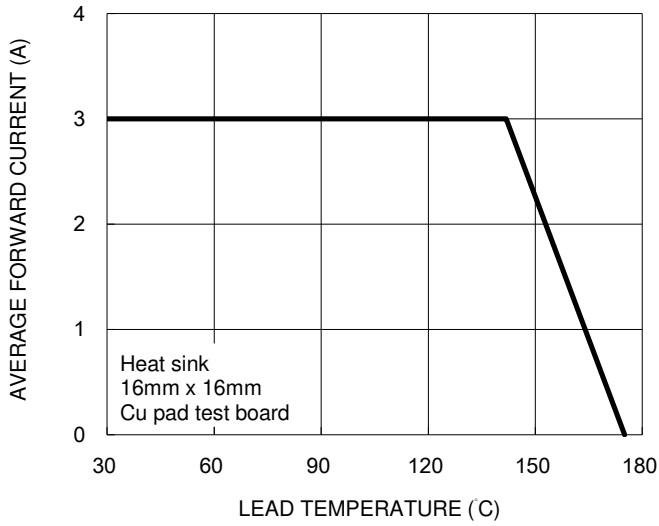
<b>IMMUNITY TO ELECTRICAL STATIC DISCHARGE TO THE FOLLOWING STANDARDS</b> ( $T_A = 25^{\circ}C$ unless otherwise noted)						
<b>Standard</b>	<b>Test Type</b>	<b>Test Conditions</b>	<b>Symbol</b>	<b>Class</b>	<b>Value</b>	<b>Typical</b>
AEC-Q101-001	Human body model(contact mode)	$C=100pF, R=1.5k\Omega$	$V_c$	H3B	$\geq 8kV$	N/A
IEC 61000-4-2	Contact mode	$C=150pF, R=330\Omega$		4	$\geq 8kV$	25kV
	Air-discharge mode	$C=150pF, R=330\Omega$		4	$\geq 15kV$	30kV
ISO 10605	Contact mode	$C=330pF, R=330\Omega$		L4	$\geq 15kV$	25kV
	Air-discharge mode	$C=330pF, R=330\Omega$		L4	$\geq 25kV$	30kV

<b>ORDERING INFORMATION</b>		
<b>ORDERING CODE</b>	<b>PACKAGE</b>	<b>PACKING</b>
TSD3G	DO-214AB (SMC)	3,000 / Tape & Reel

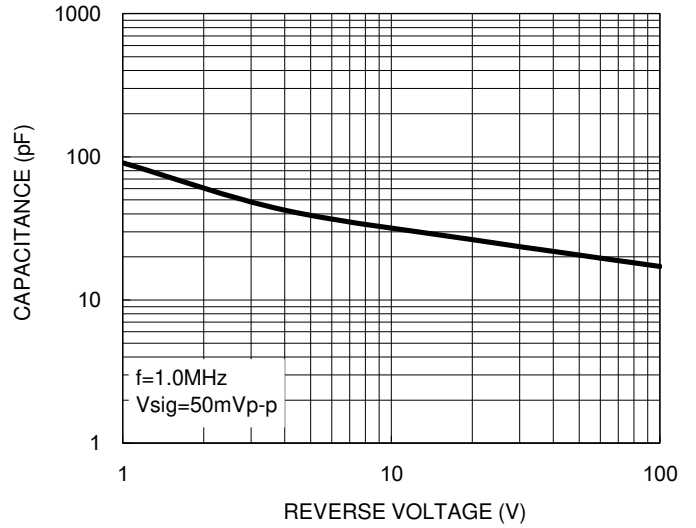
**CHARACTERISTICS CURVES**

( $T_A = 25^\circ\text{C}$  unless otherwise noted)

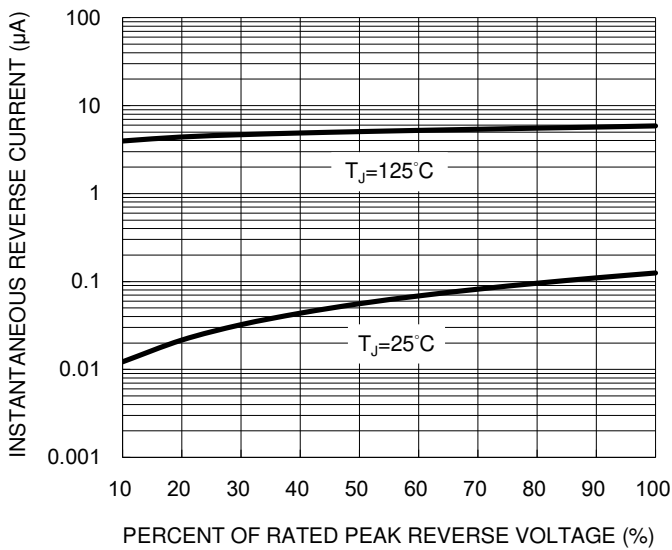
**Fig.1 Forward Current Derating Curve**



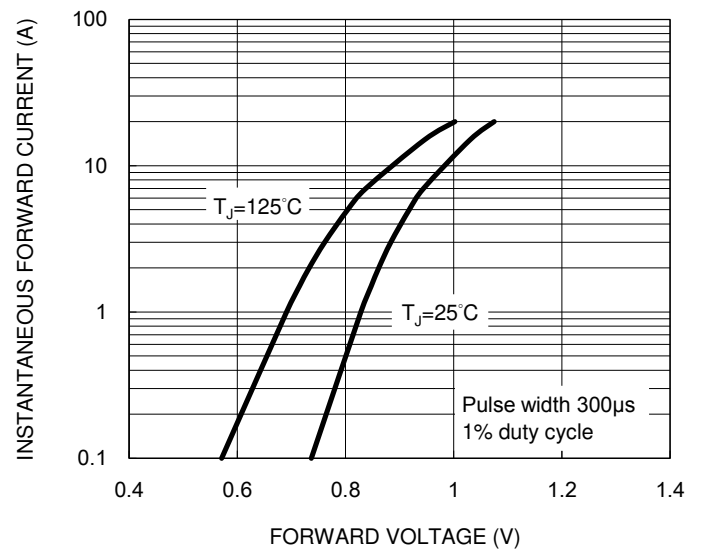
**Fig.2 Typical Junction Capacitance**



**Fig.3 Typical Reverse Characteristics**

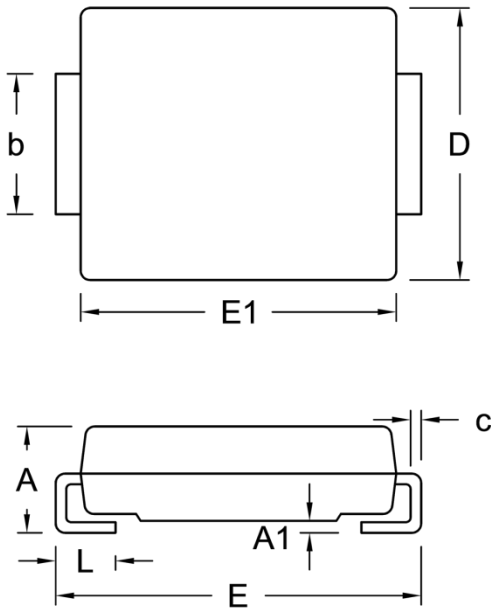


**Fig.4 Typical Forward Characteristics**



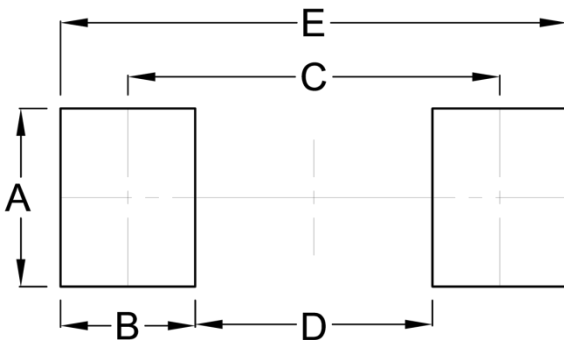
**PACKAGE OUTLINE DIMENSIONS**

DO-214AB (SMC)



DIM.	Unit (mm)		Unit (inch)	
	Min.	Max.	Min.	Max.
A	2.00	2.62	0.079	0.103
A1	0.10	0.20	0.004	0.008
b	2.90	3.20	0.114	0.126
c	0.15	0.31	0.006	0.012
D	5.59	6.22	0.220	0.245
E	7.75	8.13	0.305	0.320
E1	6.60	7.11	0.260	0.280
L	1.00	1.60	0.039	0.063

**SUGGESTED PAD LAYOUT**



Symbol	Unit (mm)	Unit (inch)
A	3.30	0.130
B	2.50	0.098
C	6.90	0.272
D	4.40	0.173
E	9.40	0.370

**MARKING DIAGRAM**



- P/N = Marking Code
- G = Green Compound
- YW = Date Code
- F = Factory Code

## **Notice**

Specifications of the products displayed herein are subject to change without notice. TSC or anyone on its behalf, assumes no responsibility or liability for any errors or inaccuracies.

Purchasers are solely responsible for the choice, selection, and use of TSC products and TSC assumes no liability for application assistance or the design of Purchasers' products.

Information contained herein is intended to provide a product description only. No license, express or implied, to any intellectual property rights is granted by this document. Except as provided in TSC's terms and conditions of sale for such products, TSC assumes no liability whatsoever, and disclaims any express or implied warranty, relating to sale and/or use of TSC products including liability or warranties relating to fitness for a particular purpose, merchantability, or infringement of any patent, copyright, or other intellectual property right.

The products shown herein are not designed for use in medical, life-saving, or life-sustaining applications. Customers using or selling these products for use in such applications do so at their own risk and agree to fully indemnify TSC for any damages resulting from such improper use or sale.