

注：  
NOTE

1. 材料 MATERIAL  
ピン : □0.635×14.2 黄銅、ニッケル下地金めっき  
PIN : □0.635×14.2 BRASS GOLD OVER NICKEL PLATING  
ウエハー : ポリアミド、UL94V-0  
WAFER: POLYAMIDE,UL94V-0
2. 6極以上に適応 TO BE APPLIED FOR 6 CKT. AND MORE THAN 6 CKT.
3. 5極以下はロック部スリットなし NO SLIT IS PROVIDED FOR 5 CKT. AND LESS THAN 5 CKT.
4. ELV 及び RoHS 適合品 ELV AND RoHS COMPLIANT

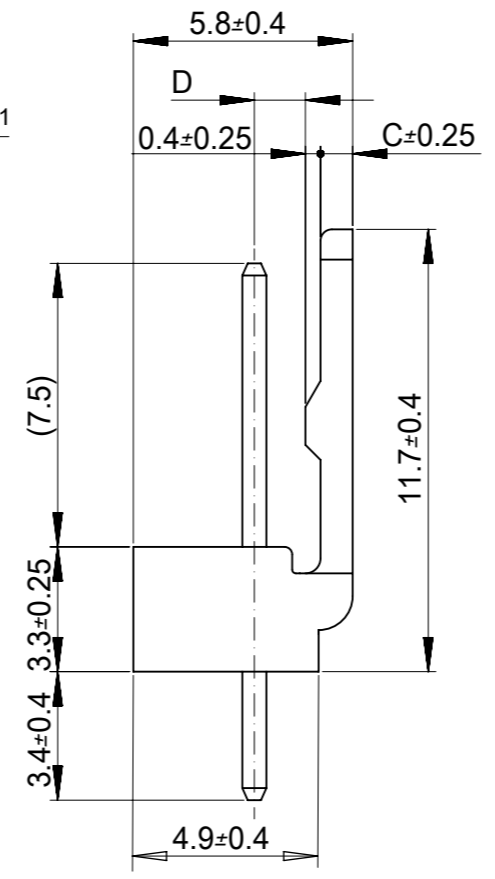
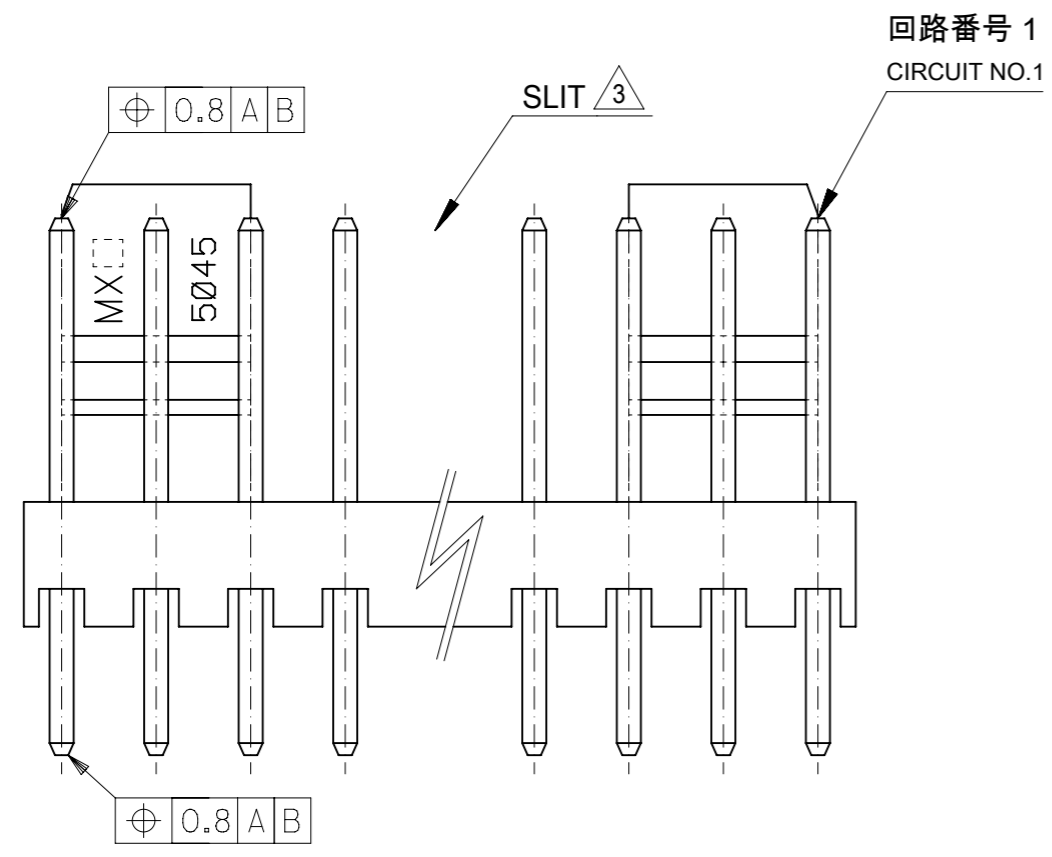

1.35	0.85	35	<sup>+0.3</sup> / <sub>-0.45</sub>	35	22 11 1151	15
↑	↑	32.5	<sup>+0.25</sup> / <sub>-0.45</sub>	32.5	↑ 1141	14
		30	<sup>+0.25</sup> / <sub>-0.4</sub>	30	↑ 1131	13
		27.5	<sup>+0.25</sup> / <sub>-0.4</sub>	27.5	↑ 1121	12
		25	<sup>+0.2</sup> / <sub>-0.4</sub>	25	↑ 1111	11
		22.5	<sup>+0.2</sup> / <sub>-0.4</sub>	22.5	↑ 1101	10
		20	<sup>+0.15</sup> / <sub>-0.35</sub>	20	↑ 1091	9
		17.5	<sup>+0.15</sup> / <sub>-0.35</sub>	17.5	↑ 1081	8
		15	<sup>+0.1</sup> / <sub>-0.3</sub>	15	↑ 1071	7
		12.5	<sup>+0.1</sup> / <sub>-0.3</sub>	12.5	↑ 1061	6
↓	↓	10	<sup>+0.15</sup> / <sub>-0.3</sub>	10	↑ 1051	5
1.35	0.85	7.5	<sup>+0.15</sup> / <sub>-0.3</sub>	7.5	↑ 1041	4
1.2	1	5	<sup>+0.15</sup> / <sub>-0.3</sub>	5	↓ 1031	3
1.2	1	2.5	<sup>+0.15</sup> / <sub>-0.3</sub>	2.5	22 11 1021	2
D	C	B	A	ORDER No.	極数	CKT.

MODEL No. : 5045-\*\*AG

THIS DRAWING CONTAINS INFORMATION THAT IS PROPRIETARY TO MOLEX ELECTRONIC TECHNOLOGIES, LLC AND SHOULD NOT BE USED WITHOUT WRITTEN PERMISSION

EC NO: 168849 DRWN: QHE31 CHK'D: SAKIYAMA APPR: TKANEKO	2017/11/28 2017/11/30 2017/12/26	GENERAL TOLERANCES (UNLESS SPECIFIED) ANGULAR TOL ± 3.0 ° 4 PLACES ± 0.2 3 PLACES ± 0.2 2 PLACES ± 0.2 1 PLACE ± 0.2 0 PLACES ± 0.2	DIMENSION UNITS: mm SCALE: 5:1				
	REVISED	DRAFT WHERE APPLICABLE MUST REMAIN WITHIN DIMENSIONS	DRWN BY: RHORI DATE: 2013/11/25		MINI-LATCH 2.5 HEADER ASS'Y ST WITH LOCK GOLD PLATING		
	EC NO: 168849 DRWN: QHE31 CHK'D: SAKIYAMA APPR: TKANEKO	DRAFT WHERE APPLICABLE MUST REMAIN WITHIN DIMENSIONS	CHK'D BY: KASAKAWA DATE: 2013/11/28			PRODUCT CUSTOMER DRAWING	
	EC NO: 168849 DRWN: QHE31 CHK'D: SAKIYAMA APPR: TKANEKO	DRAFT WHERE APPLICABLE MUST REMAIN WITHIN DIMENSIONS	APPR BY: NUKITA DATE: 2013/11/28				SERIES: 5045 MATERIAL NUMBER: SEE CHART CUSTOMER: GENERAL MARKET
	EC NO: 168849 DRWN: QHE31 CHK'D: SAKIYAMA APPR: TKANEKO	DRAFT WHERE APPLICABLE MUST REMAIN WITHIN DIMENSIONS	DRAWING SIZE: A3 THIRD ANGLE PROJECTION				DOCUMENT NUMBER: SD-5045-001 DOC TYPE: PSD DOC PART: 001 SHEET NUMBER: 1 OF 1