



**Electrical Specifications**

**Center Frequency:** 3500 MHz  
**Bandwidth:** 200 MHz  
**Pass Band:** 3400-3600 MHz  
**Pass Band Insertion Loss:** 1.8 dB Max  
**Pass Band Ripple:** 0.85 dB Max  
**Pass Band Return Loss:** 12 dB Min  
**Attenuation:** >65 dB @ 0.1-468 MHz  
                   >60 dB @ 469-768 MHz  
                   >50 dB @ 769-2664 MHz  
                   >34 dB @ 2664-3132 MHz  
                   >22 dB @ 3868-4068 MHz  
**Input Power:** 2 Watts Max

**Mechanical**

**Mounting Method:** SMT  
**Dimensions:** 10.20 x 4.5 x 4.10 mm

**Environmental**

**Operating Temperature:** -40 to +85° C  
**Storage Temperature:** -50 to +95° C  
**Shock:** 20 G. 11 ms  
**Vibration:** 20 G. 5 to 200 MHz

**Outline Drawing:**

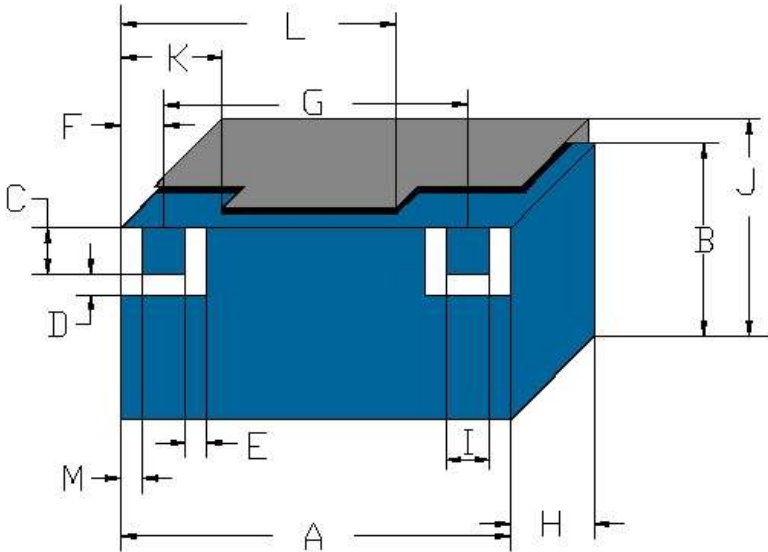

Dim	Nominal (mm)	Tolerance (mm) +/- or max
A	10.20	Max
B	4.50	Max
C	1.00	0.13
D	0.60	0.13
E	0.60	0.13
F	1.20	0.13
G	7.80	0.13
H	4.10	Max
I	1.00	0.13
J	5.60	Max
K	2.54	0.25
L	7.40	0.25
M	0.65	0.20



**ANATECH ELECTRONICS INC**  
RF & Microwave Filters & Products

# 3500 MHz Ceramic Band Pass Filter

**Part Number: AM3500B1699**



## Response Plot:

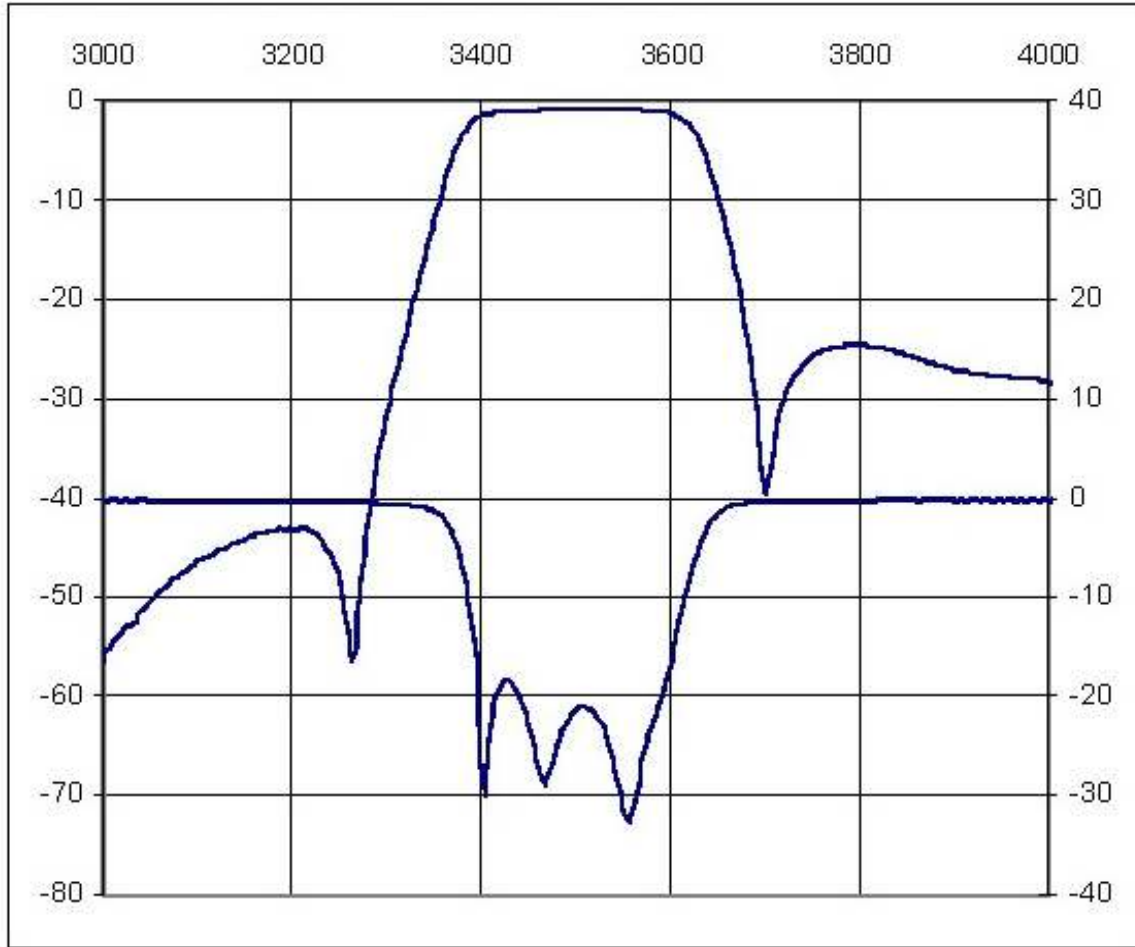



**PCB Layout:**

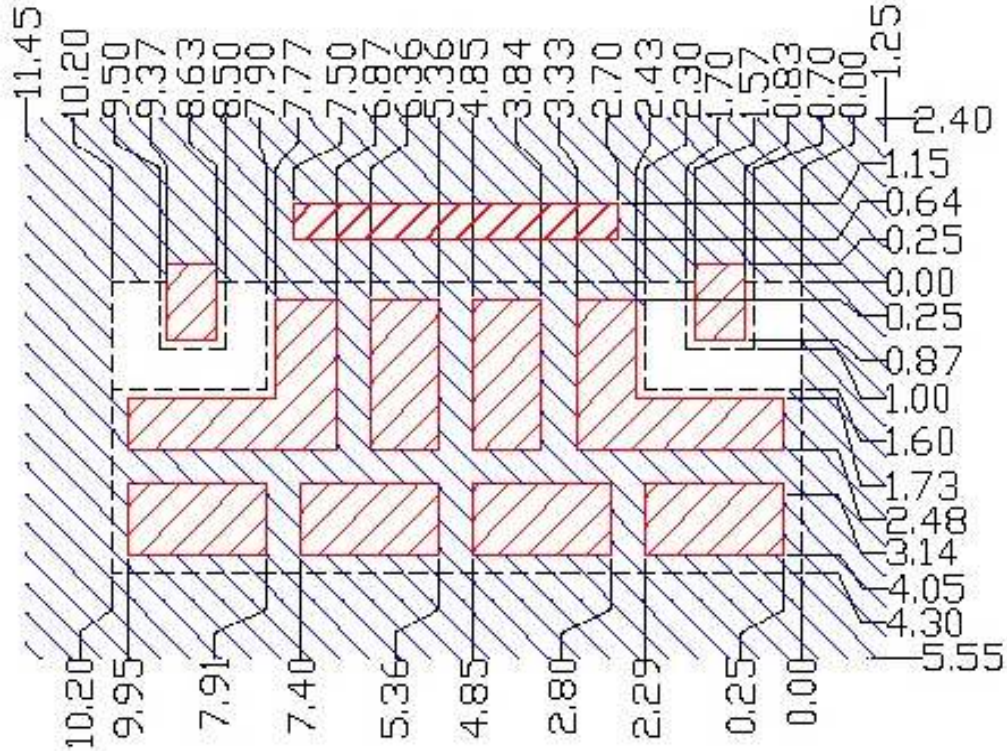

----- Filter Outline

 Solder Resist Over Dielectric

 Exposed Conductor

 Solder Resist Over Conductor