

PRODUCT NUMBER

71600-YXXXLF

- LEAD FREE, SEE NOTE 6
- COLOR OPTION, SEE NOTE 1
- TOTAL NB OF POSITION 04 TO 64 SEE SHEET 2
- OPTIONAL STRAIN RELIEF SEE SHEET 2

TRIANGLE INDICATES POSITION 1  
NOTE 5

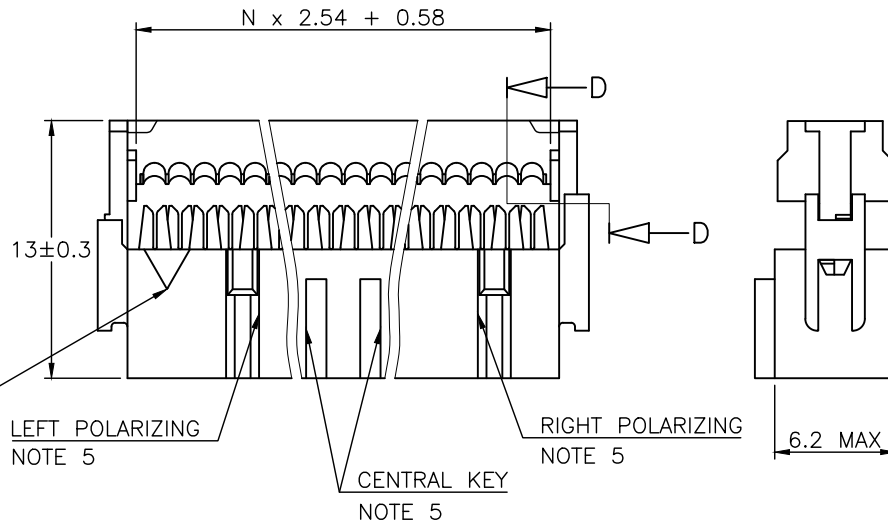

NOTES:

- 1 - HOUSING MATERIAL : GLASS FILLED THERMOPLASTIC. UL94V-0 COLOR: GREY  
 = STANDARD COLOR GREY  
 B = OPTION COLOR BLACK
- 2 - PIN MATERIAL : PHOSPHOR BRONZE
- 3 - PRODUCT PACKAGED IN TUBES.
- 4 - TO DETERMINE DIMENSIONS :  
 N = NUMBER OF POSITIONS PER ROW  
 EXAMPLE : 8 POS  $N \times 2.54 = 20.32\text{mm}$
- 5 - 2x5, 2x6, 2x7 HAVE NO LEFT POLARIZING SLOT.  
 - 2x2, 2x3 WITH CENTRAL KEY HAVE NO TRIANGLE, NO LEFT AND RIGHT POLARIZING SLOT.  
 - 2x2 WITHOUT CENTRAL KEY HAS NO LEFT AND RIGHT POLARIZING SLOT.  
 - 2x3, 2x4 WITHOUT CENTRAL KEY HAVE NO LEFT POLARIZING SLOT  
 - 2x4 WITH CENTRAL KEY HAVE NO LEFT AND RIGHT POLARIZING SLOT
- 6 - THIS PRODUCT MEETS EUROPEAN UNION DIRECTIVES AND OTHER COUNTRY REGULATIONS AS PER GS-22-008. PACKAGING SPECIFICATION AS PER GS-14-920.

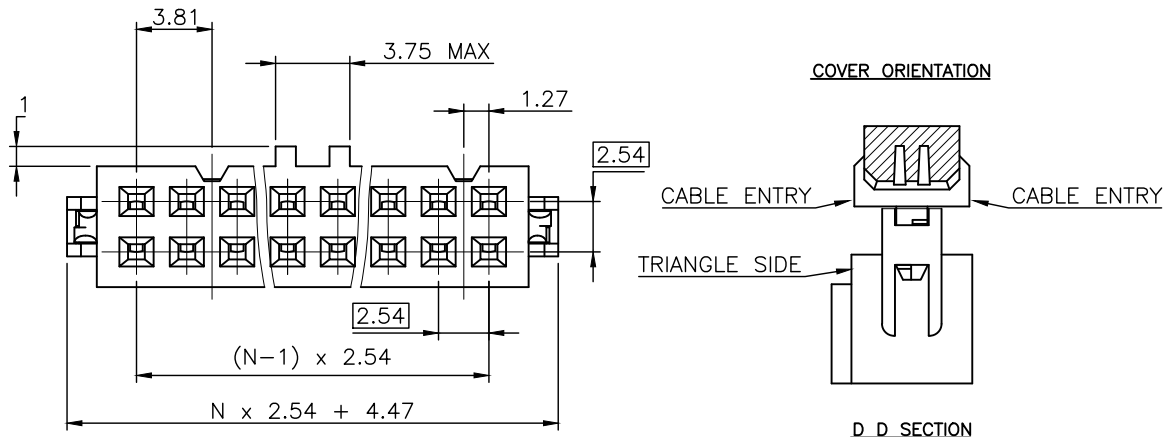

mat'l. code SEE NOTES		surface ISO 1302 ✓ ISO 406 ISO 1101		tolerance ISO 406 ISO 1101		projection mm		product family 2.54MM IDC	
lfr	ecn no	dr	date	tolerances unless otherwise specified		mm		title QUICKIE III FEM 0.76µm Au	
AP	F12-0046	LMU	12.04.25	angles	X.X ±0.3	scale 5:1		dwg no 71600	
AR	B-17851	LMU	14.06.05	linear	X.XX ±0.13	FCJ		sheet 1 of 2 size A3	
AS	F-26816	LMU	17.06.06		X.XXX ±0.05			type CUSTOMER Drawing	
		dr	D.LE		01.01.24				
		engr	P.NZ		01.01.24				
		chr	JF.N		01.01.24				
		appd	P.NZ		01.01.24				
sheet	revision	AS	AG						
index	sheet	1	2						

STRAIN RELIEF OPTION AVAILABILITY	Nbr OF POSITIONS
1/6	04
0/1/2/3/6	06
0/1/2/3/6	08
0/1/2/3/6	10
0/1/2/3/6	14
0/1/2/3/6	16
0/1/2/3/6	18
0/1/2/3/6	20
0/1/3	24
0/1/2/3/6	26
0/1/2/3/6	30
0/1/2/3/6	34
0/1/2/3/6	40
0/1/2/3/6	50
0/1/2/3/6	60
0/1/2/3/6	64

624
304
204 / 224
004

DASHES NOT AVAILABLE

PLATING  
 0.76µm GOLD ON CONTACT AREA  
 1.27 µm Ni REMAINDER OF PRODUCT

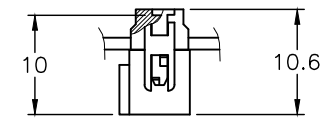

WITHOUT STRAIN RELIEF

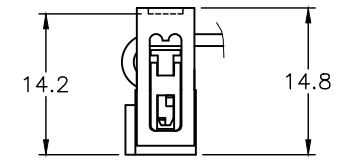

WITH LOW PROFILE STRAIN RELIEF

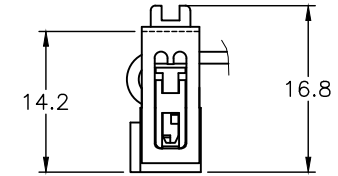

WITH STANDARD STRAIN RELIEF

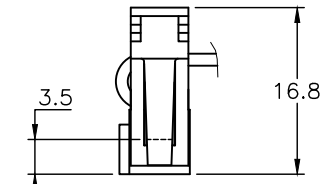

WITH LATCHING STRAIN RELIEF

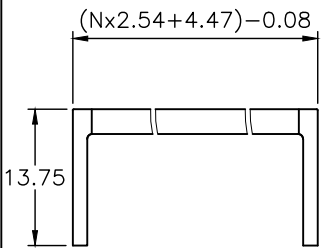

LOW PROFILE STRAIN RELIEF

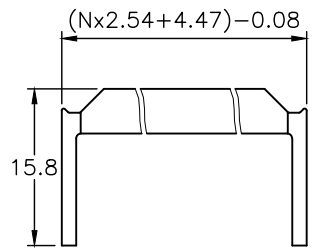

STANDARD STRAIN RELIEF

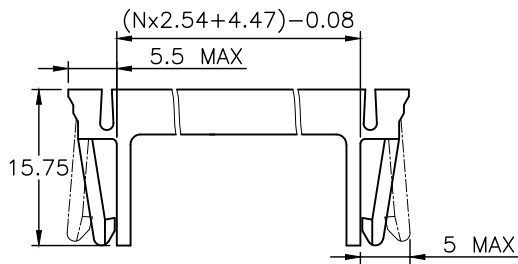

LATCHING STRAIN RELIEF FOR SLIM HEADER

71600-6YY(B)LF	●					●
71600-3YY(B)LF		●	●			
71600-2YY(B)LF	●			●		
71600-1YY(B)LF	●			●		
71600-0YY(B)LF	●		●			
PRODUCT NUMBER	WITH CENTRAL KEY	WITHOUT CENTRAL KEY	STANDARD STRAIN RELIEF	WITHOUT STRAIN RELIEF	LOW PROFILE STRAIN RELIEF	LATCHING STRAIN RELIEF

mat'l. code		surface		tolerance		projection		product family	
		ISO 1302		ISO 406 ISO 1101		mm		QUICKIE	
ltr ecn no dr date		tolerances unless otherwise specified		angles linear		scale N/A		title	
AF B-17851 LMU 14.06.05								IDC RECEPT DR	
AG F-26816 LMU 17.06.06								sheet 2 of - size	
AB F03019 DLE 03.01.23 dr D.LE 01.01.24								71600 A3	
AC F05-0180 LMU 05.04.22 engr P.NZ 01.01.24								CUSTOMER Drawing	
AD F06-0270 LMU 06.09.12 chr JF.N 01.01.24									
AE F06-0274 LMU 06.09.25 appd P.NZ 01.01.24									
sheet index		revision sheet							



Copyright FCI