

- TO BE USED WITH MATE-N-LOK(TM) DUAL LANCE PINS.
- TO BE USED WITH PLUG 480696.
- EFFECTIVE PANEL THICKNESS "E" IS 1.02 [.040] - 2.54 [.100] AND IS DEPENDENT ON "T" & "R".
- CAP MUST BE INSERTED IN A ROCKING MANNER.
- HOUSING MUST ENTER PANEL IN THE SAME DIRECTION AS THE PUNCH.
- PANEL MUST NOT HAVE ANY MATERIAL (PAINT, PORCELAIN, ETC.) APPLIED IN THE MOUNTING HOLE AREA THAT WOULD DECREASE RETENTION OF THE HOUSING IN THE PANEL.

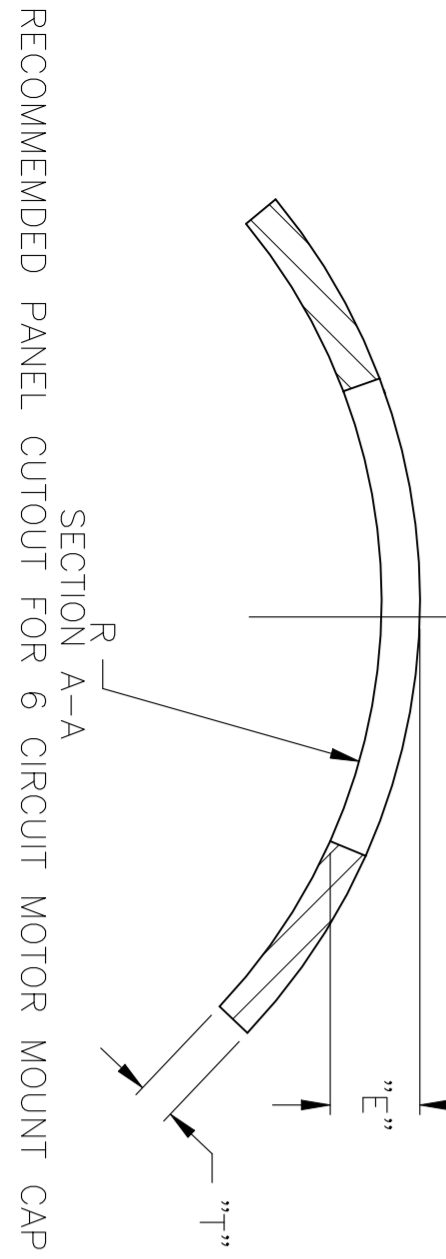
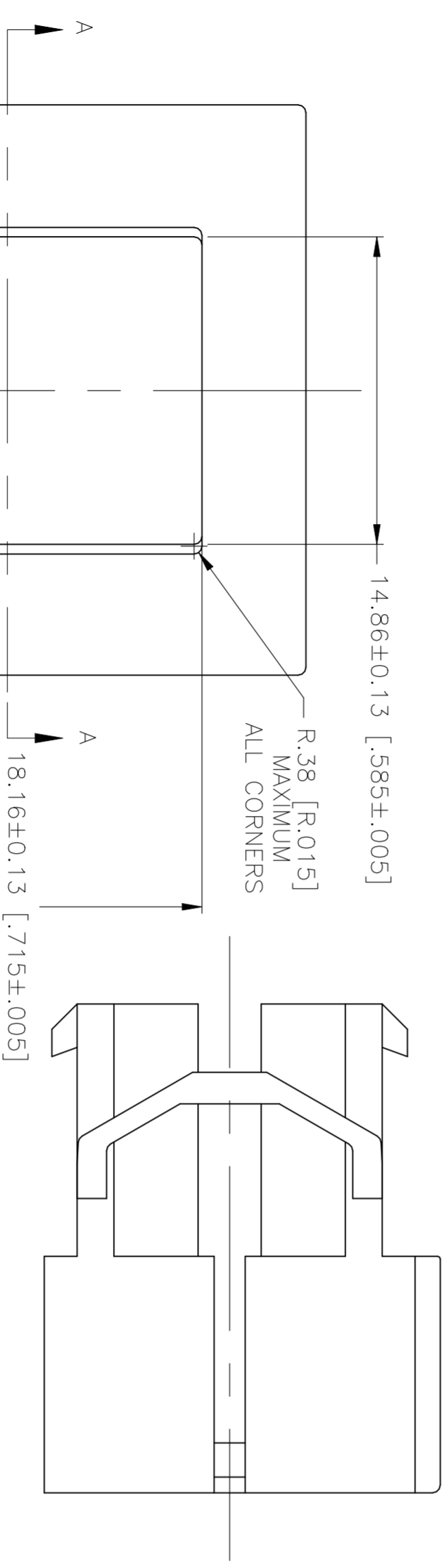

OBSOLETE	RED	NYLON	2-480697-2
OBSOLETE	NATURAL	NYLON	2-480697-0
OBSOLETE	BLACK	NYLON	1-480697-9
OBSOLETE	GRAY	NYLON	1-480697-8
OBSOLETE	VIOLET	NYLON	1-480697-7
OBSOLETE	BLUE	NYLON	1-480697-6
OBSOLETE	GREEN	NYLON	1-480697-5
OBSOLETE	YELLOW	NYLON	1-480697-4
OBSOLETE	ORANGE	NYLON	1-480697-3
OBSOLETE	RED	NYLON	1-480697-2
OBSOLETE	BROWN	NYLON	1-480697-1
OBSOLETE	NATURAL	NYLON	1-480697-0
	COLOR	MATERIAL	PART NO.

THIS DRAWING IS A CONTROLLED DOCUMENT.

DIMENSIONS:	TOLERANCES UNLESS OTHERWISE SPECIFIED:
mm [INCHES]	
0 PLG	±
1 PLG	± 0.13 [.005]
2 PLG	±
3 PLG	±
4 PLG	± 0.30
ANGLES	±
FINISH	

APPLICATOR: S. HOOVER (22-MAY-2003)
 CHK: D. COLEY (22-MAY-2003)
 APVD: D. COLEY (22-MAY-2003)
 PRODUCT SPEC

TYCO ELECTRONICS CORPORATION
 HARRISBURG, PA 17105-3608

CAP, MATE-N-LOK(TM), 6 CIRCUIT

SIZE: A2
 CASE CODE: 00779
 DRAWING NO: 480697

SCALE: 4:1
 SHEET: 1 of 1
 REV: N1