

REVISIONS					
REV	ECO	DESCRIPTION	DATE	BY	APPR
A1		RELEASE NEW DRAWING	05APR21	SULLEN	TOMMY

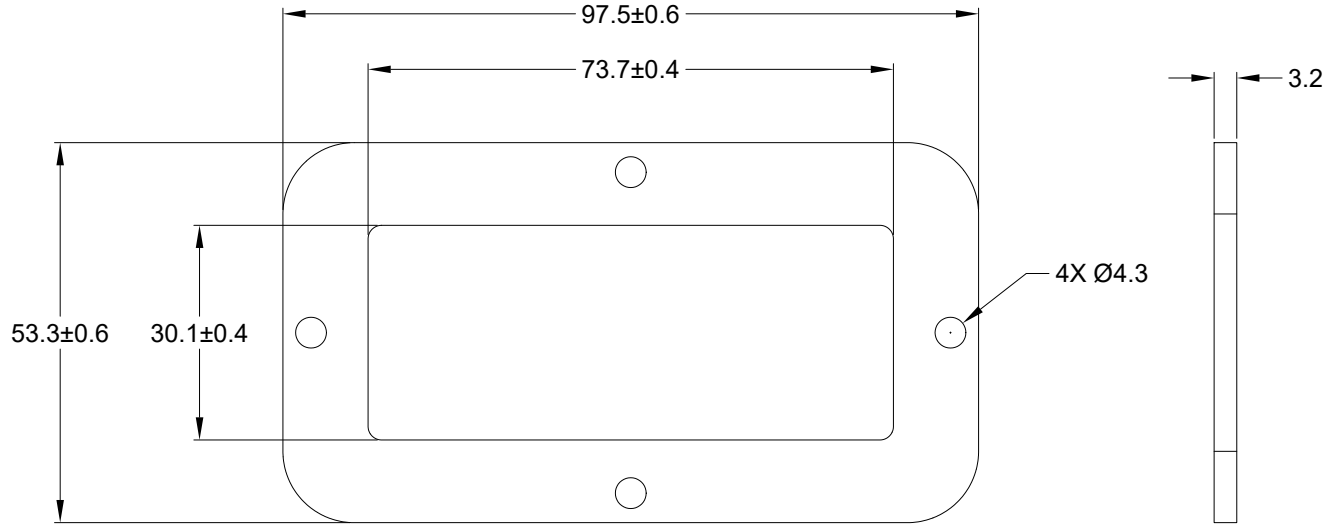

NOTES: UNLESS OTHERWISE SPECIFIED

1. MATERIAL: CLD CELL SPONGE
2. COLORS: BLACK
3. RoHS COMPLIANT
4. THIS PART IS UESD ON ARC12-40PX(R) RECEPTACLE WHERE X=A,B,C,D KEYS
5. TEMPERATURE RATING: -57°C TO +107°C [-70°F TO +225°F]
6. ALL DIMENSIONS ARE FOR REFERENCE USE ONLY.

	ARC40-GKT	REF DRC40-GKT									
	PART NUMBER	DESCRIPTION	ITEM								
QUANTITY	MATERIALS LIST										
UNLESS OTHERWISE SPECIFIED 1) All dimensions are in metric(mm). 2) Tolerances are as follows: 1 PL DEC ±0.30 2 PL DEC ±0.15 3 PL DEC ±0.08 Fractions ±1/64 Angles ±1° 3) Note reference =	SIGNATURES	DATE	<h1>Amphenol</h1> Sine Systems - www.amphenol-sine.com 44724 Morley Drive Clinton Township, MI 48036								
	DRAWN: SULLEN.ZHANG	05APR21									
CHECKED: ORION.LI	06APR21										
ENGINEER:											
MATERIAL SPECIFICATIONS:	APPROVAL: TOMMY.XIE	07APR21	GASKET, RECEPTACLE, 40PIN, ARC SERIES								
PROCESS SPECIFICATIONS:	CUSTOMER:										
NEXT ASSY:	THIS DRAWING IS SUPPLIED FOR INFORMATION ONLY. DESIGN FEATURES, SPECIFICATIONS AND PERFORMANCE DATA SHOWN HEREON ARE THE PROPERTY OF THE AMPHENOL CORPORATION. NO RIGHTS OF REPRODUCTION ARE IMPLIED. ALL DIMENSIONS ARE SUBJECT TO NORMAL MANUFACTURING VARIATIONS.		<table border="1"> <tr> <td>SIZE</td> <td>TYPE</td> <td>DWG NO:</td> <td>REVISION</td> </tr> <tr> <td>A</td> <td>C-</td> <td>ARC40-GKT</td> <td>A1</td> </tr> </table>	SIZE	TYPE	DWG NO:	REVISION	A	C-	ARC40-GKT	A1
SIZE	TYPE	DWG NO:	REVISION								
A	C-	ARC40-GKT	A1								
	SCALE: NONE		SHEET 1 OF 1								