

LOC	DIST	REVISIONS					
-	-	P	LTR	DESCRIPTION	DATE	DWN	APVD
		BA		NEW DRAWING	31JAN2013	KR	TN

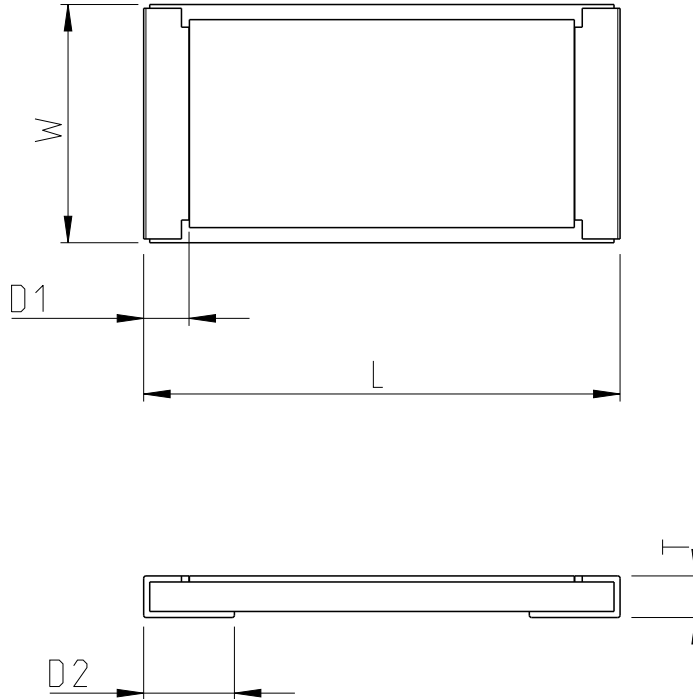

TYPE	SIZE (Inch)	RESISTANCE RANGE (mΩ)	L	W	T	D1	D2
CSM12	2512	10 - 29	6.30±0.20	3.15±0.20	0.58±0.15	0.60±0.30	1.80±0.30
		30 - 100	6.30±0.20	3.15±0.20	0.55±0.15	0.60±0.30	1.20±0.30

RoHS Compliant

FOR FURTHER INFORMATION SEE DATA SHEET FOR CURRENT SENSING METAL CHIP RESISTOR - TYPE TLM 2512

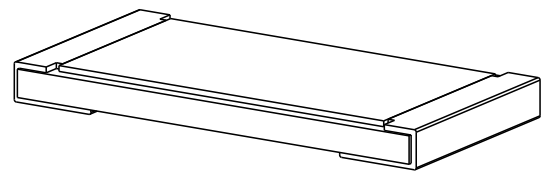

20

RELEASED FOR PUBLICATION

ALL RIGHTS RESERVED.

BY -

© COPYRIGHT 20

THIS DRAWING IS UNPUBLISHED.

DIMENSIONS: mm	DWN RAGHAVENDRA K 31JAN2013	MATERIAL	FINISH	
TOLERANCES UNLESS OTHERWISE SPECIFIED:	CHK ALLAN P 31JAN2013			
0 PLC ±	APVD TONY N 31JAN2013			
1 PLC ±	PRODUCT SPEC	NAME CURRENT SENSING METAL CHIP RESISTOR - TYPE		
2 PLC ±	APPLICATION SPEC	SIZE	CAGE CODE	DRAWING NO
3 PLC ±		A 4	00779	C=2176158
4 PLC ±	WEIGHT	RESTRICTED TO		
ANGLES ±	2.894 Gram			
	Customer Drawing	SCALE	SHEET	OF
		10:1	1	1
			REV	BA