

**SML-LX4014UWC-TR, 4.0x1.4mm Ultra Bright White SMT LED**

ITW ECS Lumex announces the release of the QuasarBrite 4.0X1.4mm ultra bright white surface mount LED. The combined feature of this LED which includes a unique rectangular surface mount package, wide viewing angle and very high intensity output makes it ideal for backlighting, sunlight visible indication and even small space lighting applications.

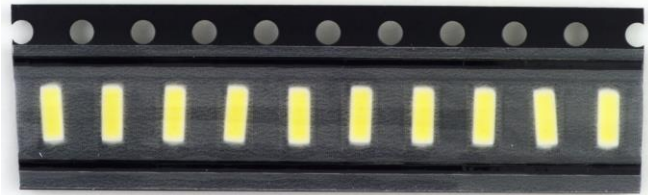

<b>Product Features</b>	<b>Benefits</b>
Rectangular package	Illuminates wider spread of light thus reducing multiple LEDs
Surface Mount	Offers assembly savings of up to 25%
Tape & Reel packaging	Easy mounting with pick and place process
Increased intensity of 50% compared to similar size LEDs	Greater visibility and clarity
Low current	Power saving

**SML-LX4014UWC-TR, 4.0x1.4mm Ultra Bright White SMT LED**

**Technical Information & Drawing**

PN	Emitted Color	Chip Material	Color Temperature (K)	Lens Type	Forward Voltage Vf		Typical Intensity (Lumens)	View Angle 2xTheta	If (mA)
					Min	Max			
SML-LX4014UWC-TR	White	InGaN	6500	Clear	2.9	3.4	21	120	60

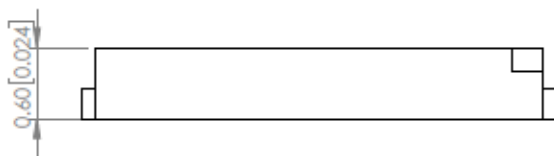
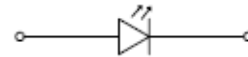
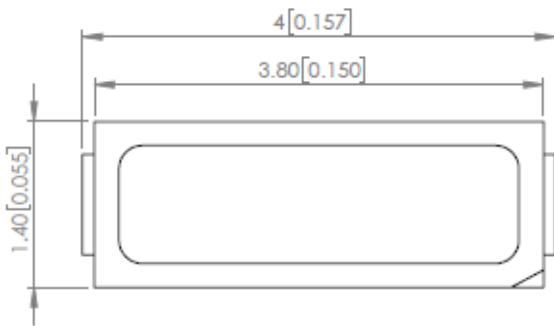

**RECOMMENDED PCB LAYOUT**

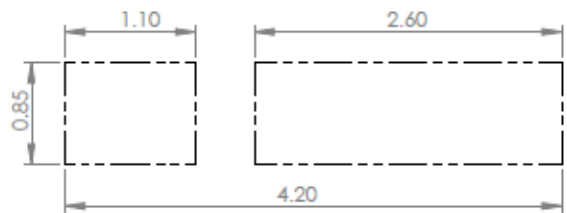
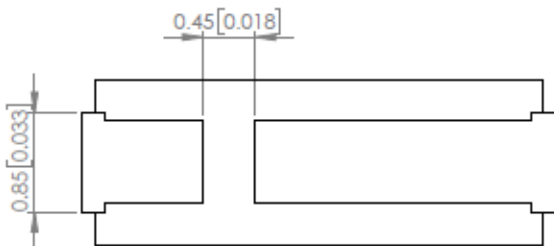

**SML-LX4014UWC-TR, 4.0x1.4mm Ultra Bright White SMT LED**

Markets	Applications
<ul style="list-style-type: none"> <li>▪ Medical</li> <li>▪ Telecommunications</li> <li>▪ Industrial Controls</li> <li>▪ Appliance</li> <li>▪ Security</li> <li>▪ Transportation</li> </ul>	<ul style="list-style-type: none"> <li>▪ Portable Medical Diagnostics</li> <li>▪ Routers, Switches, Indications</li> <li>▪ Indications, Controls &amp; Switches</li> <li>▪ Backlighting &amp; Illumination</li> <li>▪ Switches &amp; indications</li> <li>▪ Illumination, Switches, Indications, backlighting</li> </ul>

