

THIS DRAWING IS UNPUBLISHED. RELEASED FOR PUBLICATION, 19 .
 © COPYRIGHT 19 BY AMP INCORPORATED. ALL INTERNATIONAL RIGHTS RESERVED.

LOC: BD DIST: 95 P: F

REVISIONS				
ZONE	LTR	DESCRIPTION	DATE	APPD
	O	RELEASED PER NPR 2244, WAS 88-5870-28	11/30/88	-
	A	REVISED PER ECN#4221-437	04/12/89	JAR
	B	REVISED PER ECN 4221-0453	10/30/89	MAM
	C	REVISED PER ECN 4221-0586	7-5-90	-
	D	REV PER EC 0640-232-99	11 MAY 99	DR

CABLE SUPPLIED BY CUSTOMER 1
 STRAIN RELIEF STAPLE (1 SUPPLIED)
 MATERIAL: STEEL
 PLATING: BRIGHT TIN/LEAD OVER NICKEL

32.77
[1.290]

MACHINE SCREW (2 SUPPLIED)
 #2-56 UNC X 6.35 [.250]

SPRING LATCH (2 SUPPLIED)
 MATERIAL: STAINLESS STEEL

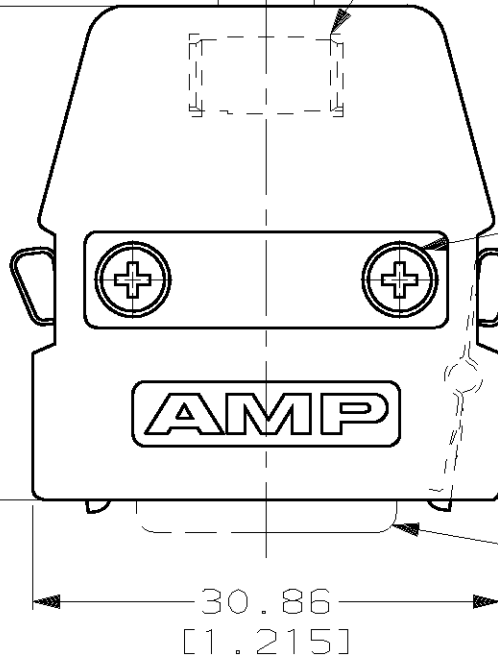

CONNECTOR (MUST BE PURCHASED SEPARATELY)

UPPER BACKSHELL (1 SUPPLIED)
 MATERIAL: ZINC
 PLATING: NICKEL OVER COPPER

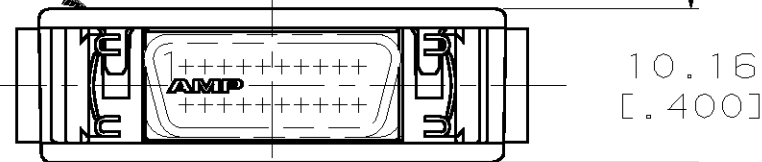

LOWER BACKSHELL (1 SUPPLIED)
 MATERIAL: ZINC
 PLATING: NICKEL OVER COPPER

1 6.86 [.270] MAX CABLE DIA

DO NOT SCALE PRINT.
 UNLESS SPECIFIED
 DIMENSIONS IN mm [INCHES]
 TOLERANCES ON:
 2 PLC DEC ± -
 3 PLC DEC ± 0.38 [.015]
 ANGLES ± -
 MATERIAL -
 FINISH -
 WEIGHT -

DR 12-20-88
 M.A.McCAFFREY
 CHK 12-20-88
 M.E.SHIRK
 APPD 12-20-88
 J.BROSCHARD
 APPD 12-20-88
 C.E.REYNOLDS
 PRODUCT SPEC -
 APPLICATION SPEC -
 WEIGHT -

AS SHOWN	749190-1
REMARKS	PART NO
AMP AMP INCORPORATED Harrisburg, Pa. 17105	
NAME INDIVIDUAL KIT, UNASSEMBLED, 20 POSITION, STRAIGHT EXIT, UNKEYED, AMPLIMITE .050 Series	
SIZE B	FSCM NO 00779
SCALE 2:1	DRAWING NO 749190
	SHEET 1 OF 1