

LOC		DIST		REVISIONS			
P	LTN	DESCRIPTION	DATE	DMN	APVD		
E		REV ECO-10-008894	28APR2010	LH	SA		
F		REV ECO-11-008739	27APR2011	LH	SA		
F1		REV: ECO-15-000709	20JAN2015	GG	LS		

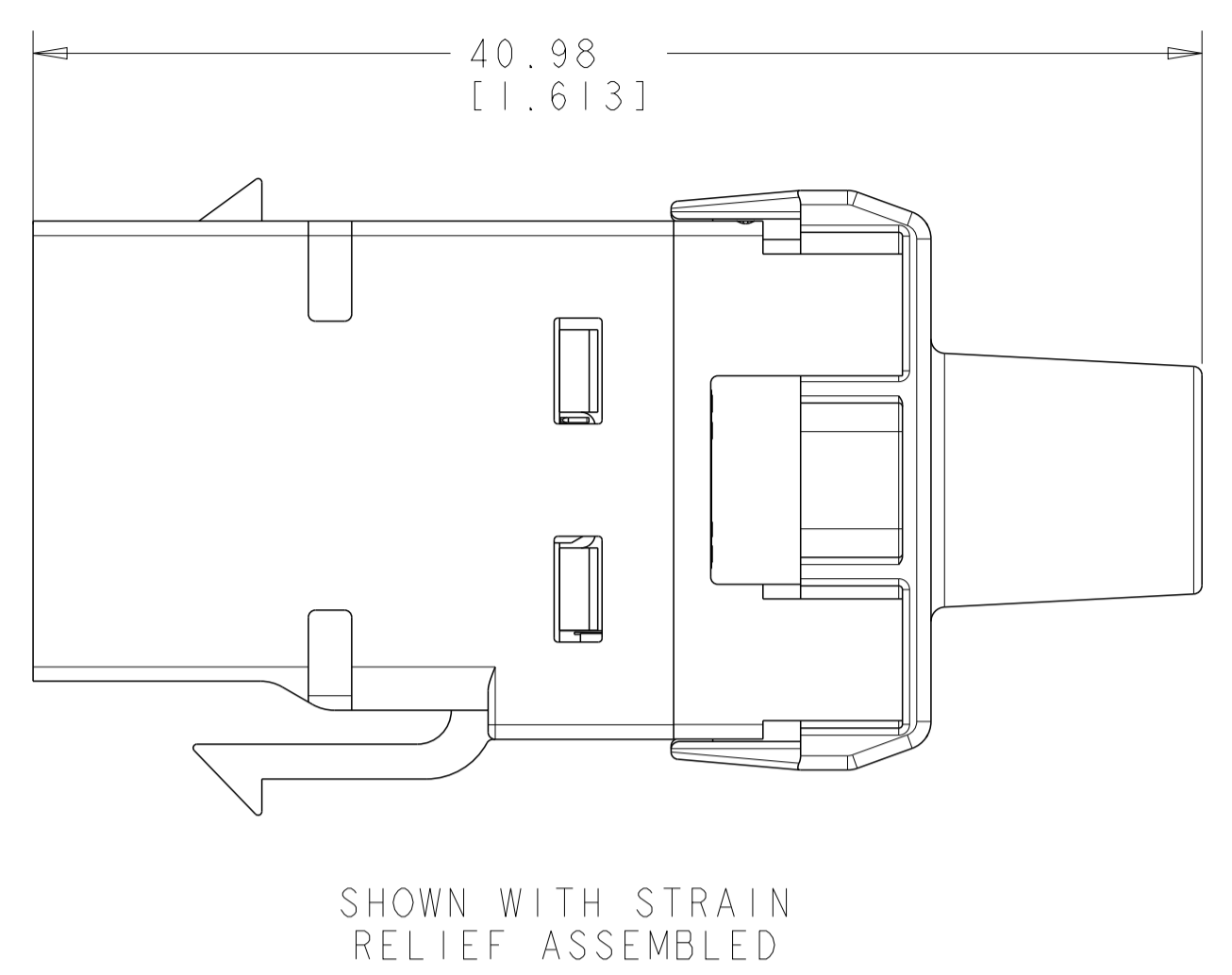

- △ MATERIAL: JACK HOUSING - POLYCARBONATE, 94V-0 RATED. 110 BLOCK AND STRAIN RELIEF - POLYCARBONATE. ARRAY TRAY - PBT POLYESTER. JACK CONTACTS ARRAY - BERYLLIUM COPPER, PLATED WITH 1.27µm [.000050] MINIMUM THICK GOLD IN LOCALIZED AREA AND 3.81µm [.000150] MINIMUM THICK MATTE TIN IN BOARD INTERFACE AREA OVER 1.27µm [.000050] MINIMUM THICK NICKEL UNDERPLATE.
- 2. KL 110 JACK WILL TERMINATE 22-24 AWG SOLID AND 24-26 AWG STRANDED CONDUCTORS, 1.27[.050] MAXIMUM INSULATION DIAMETER. JACK WILL ACCEPT CONDUCTORS UP TO 1.45 [.057] BUT REQUIRE THE USE OF A STRAIN RELIEF.
- △ CAVITY CONFORMS TO FCC RULES AND REGULATIONS) PART 68 SUBPART F REQUIREMENTS.
- 4. MOUNTING PANEL THICKNESS 1.22 - 1.55 [.048 - .061].
- △ THESE TWO SUGGESTED CUTOUT OPENINGS ARE USED IN TANDEM WITH DUAL FRONT AND BACK CUTOUTS.
- △ ONE MODULAR JACK ASSEMBLY AND ONE STRAIN RELIEF PER POLYBAG.
- △ USE OF STRAIN RELIEF IS OPTIONAL.
- △ REFER TO 408-8858 FOR TERMINATION INSTRUCTIONS USING SL SERIES TOOL TERMINATION. REFER TO 408-8417 FOR TERMINATION INSTRUCTIONS USING 110 PUNCH DOWN TOOL.

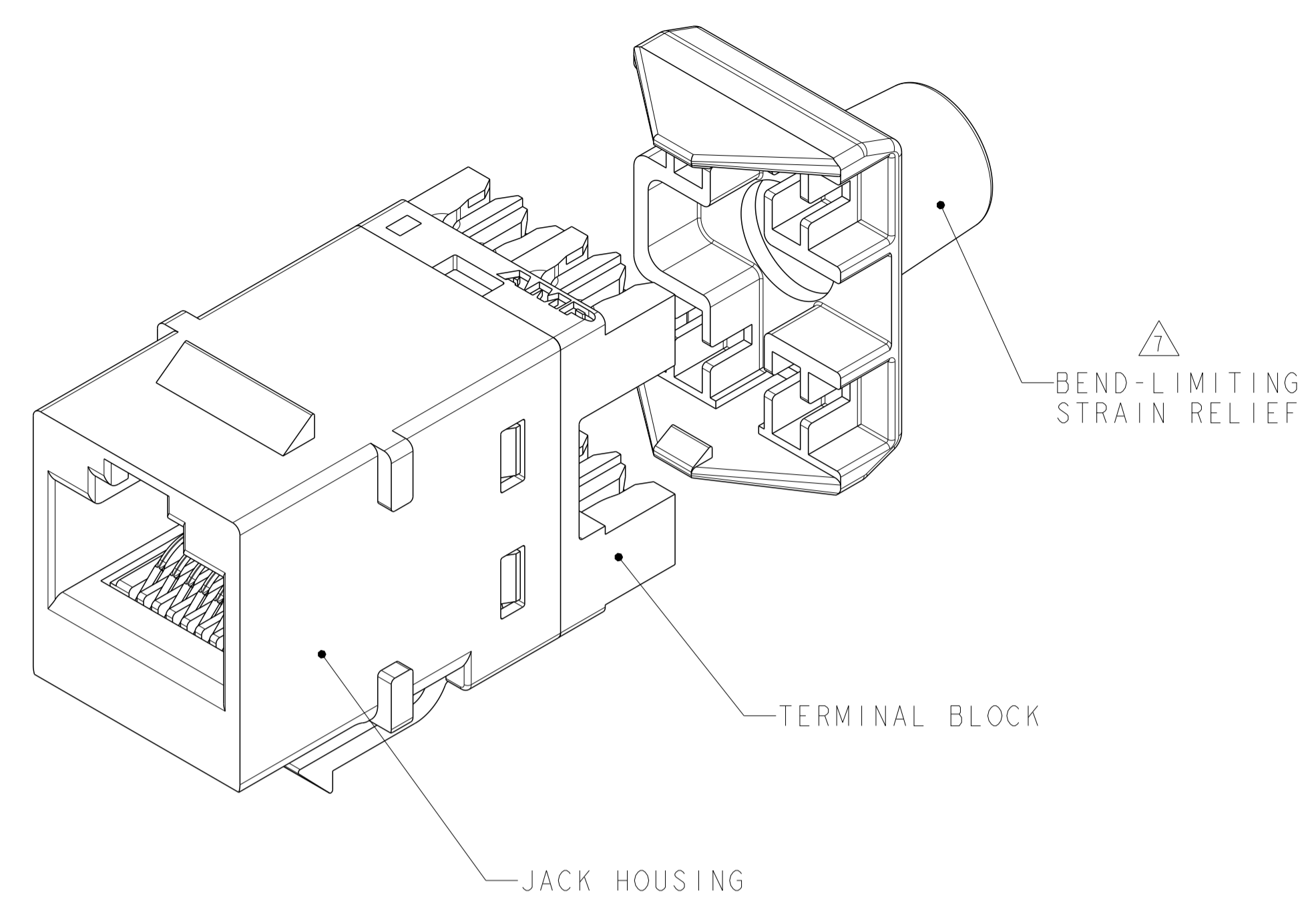
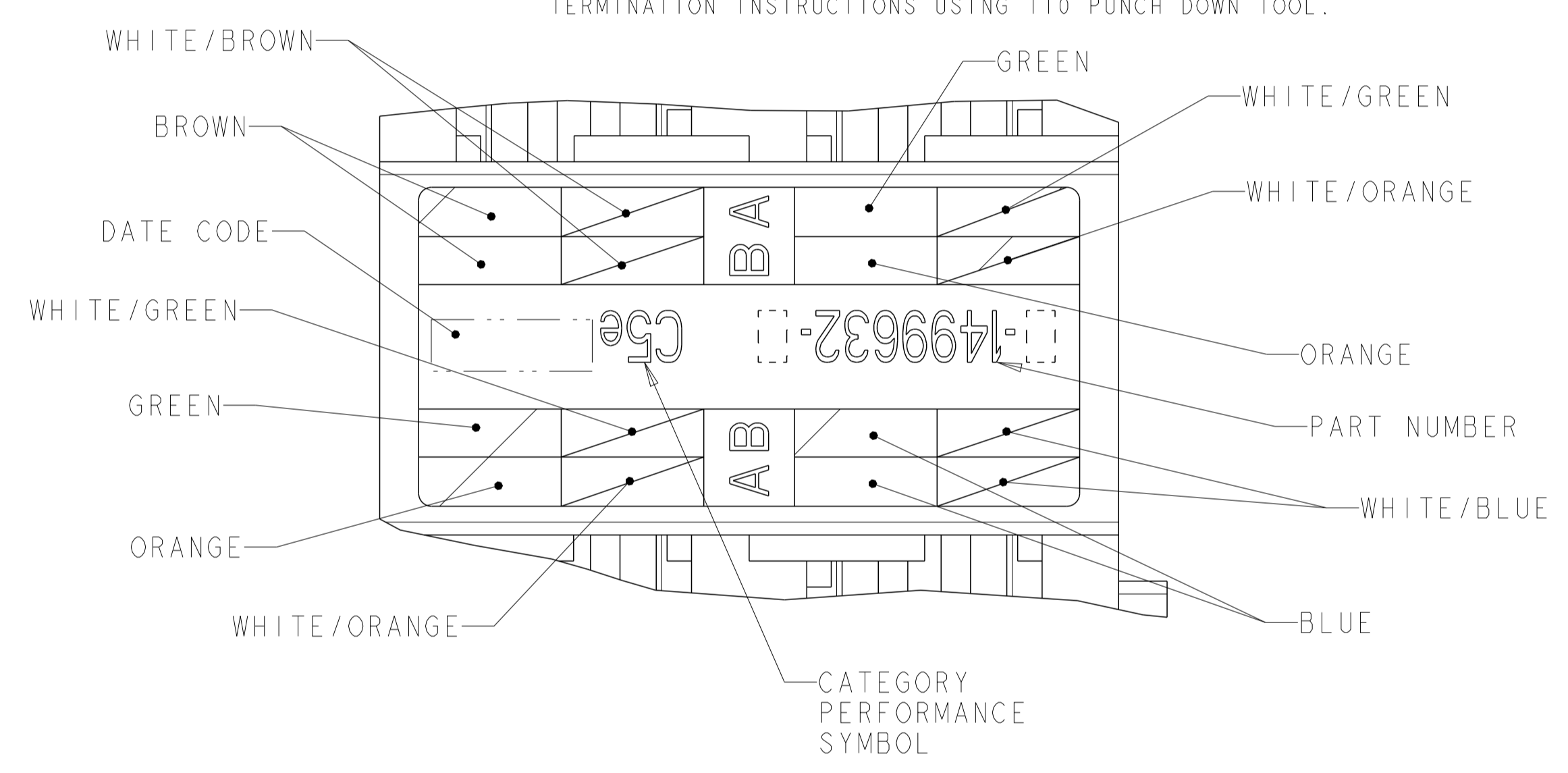
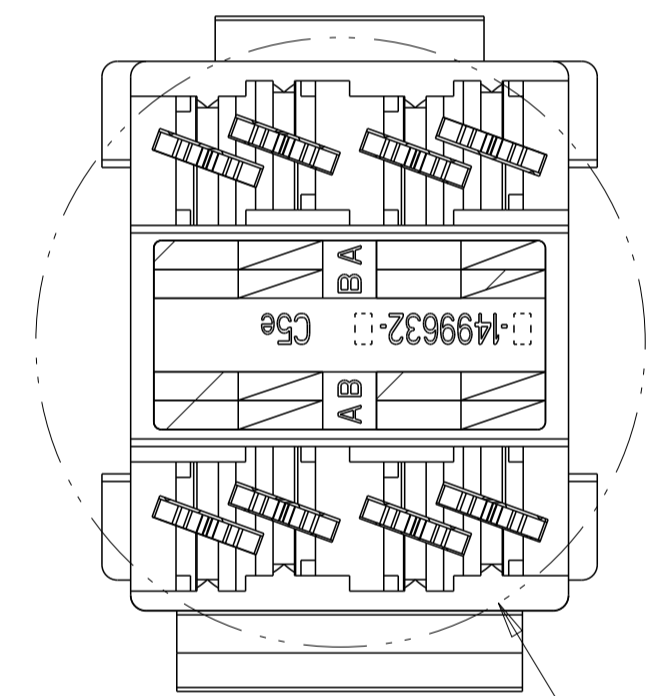
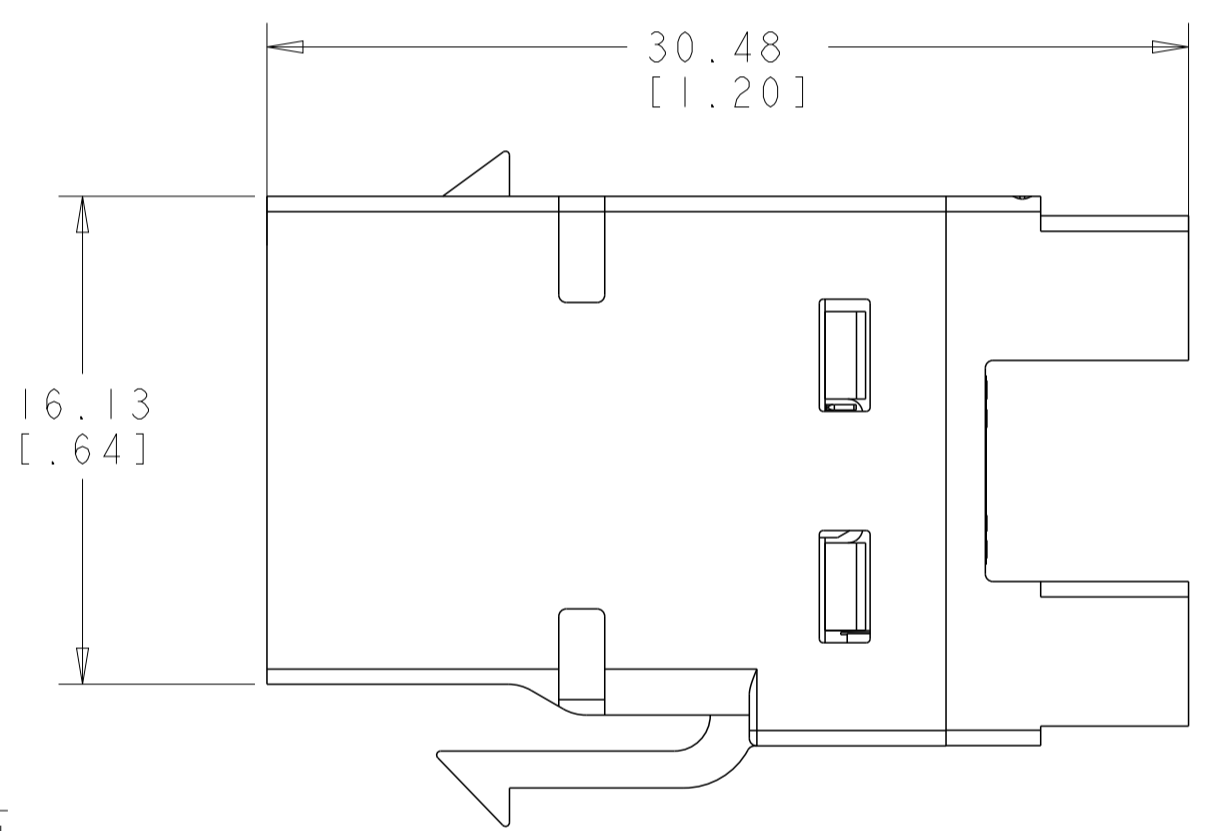
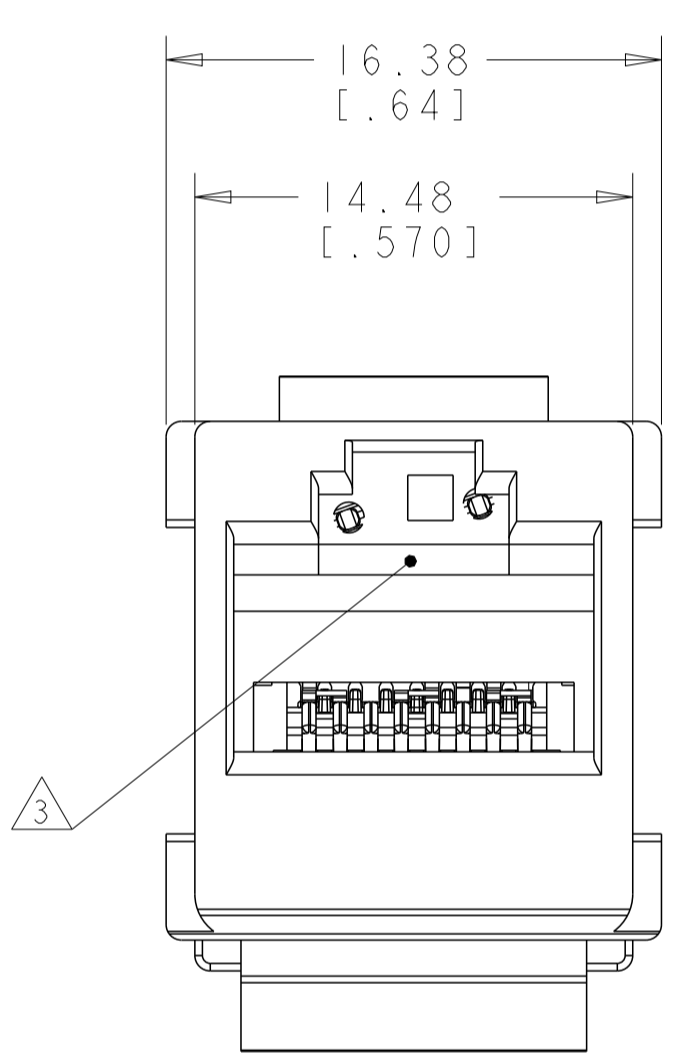

DETAIL A SCALE 10:1

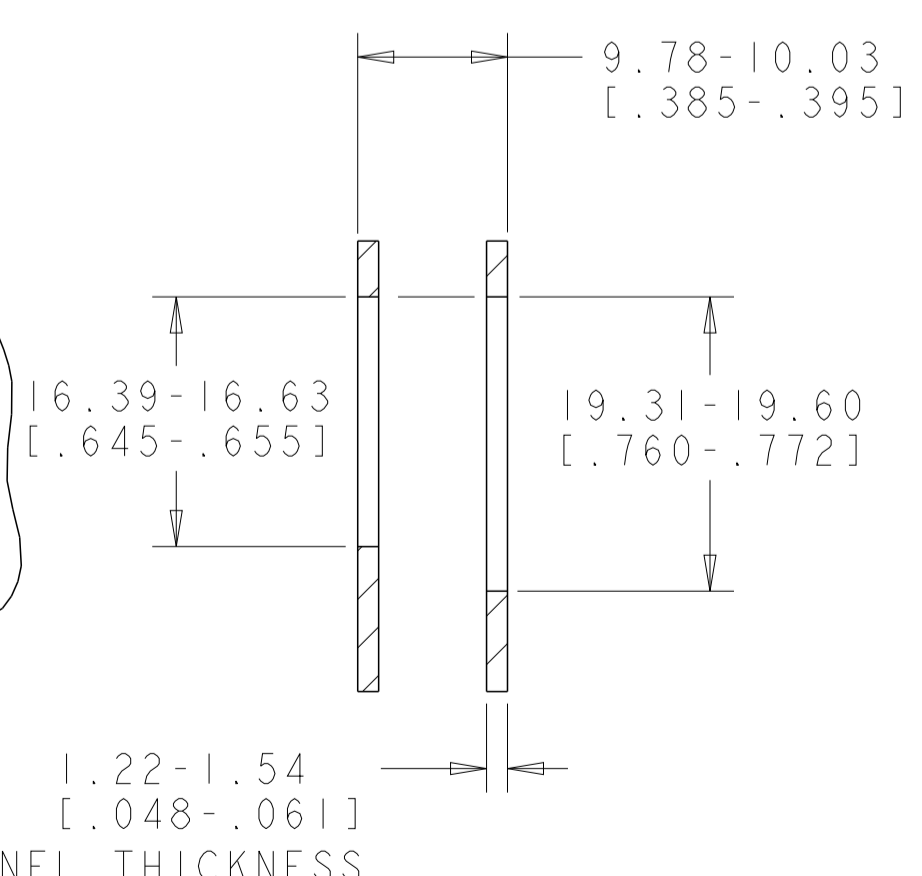
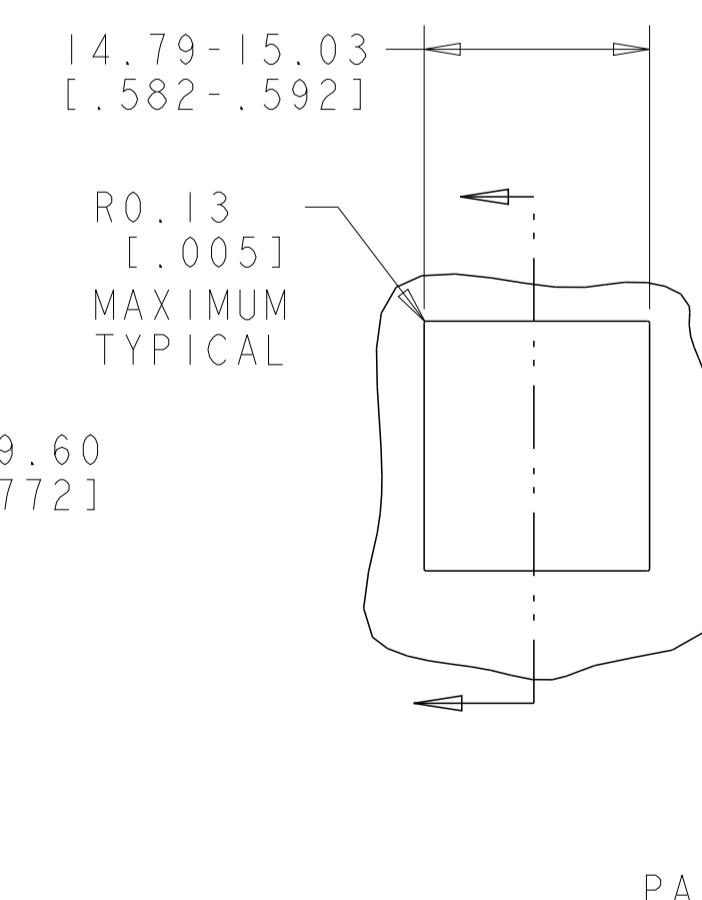
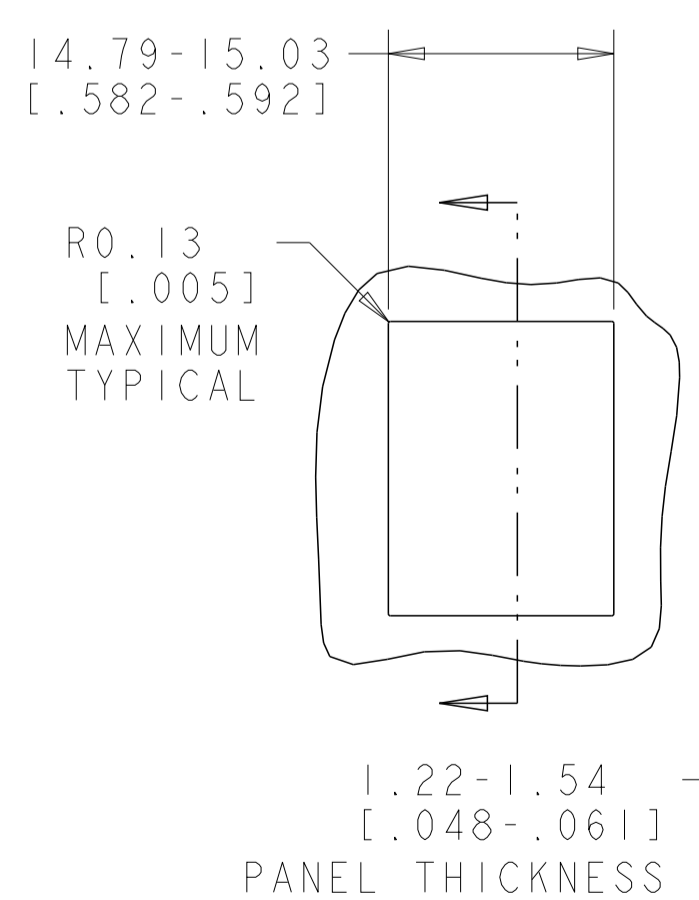
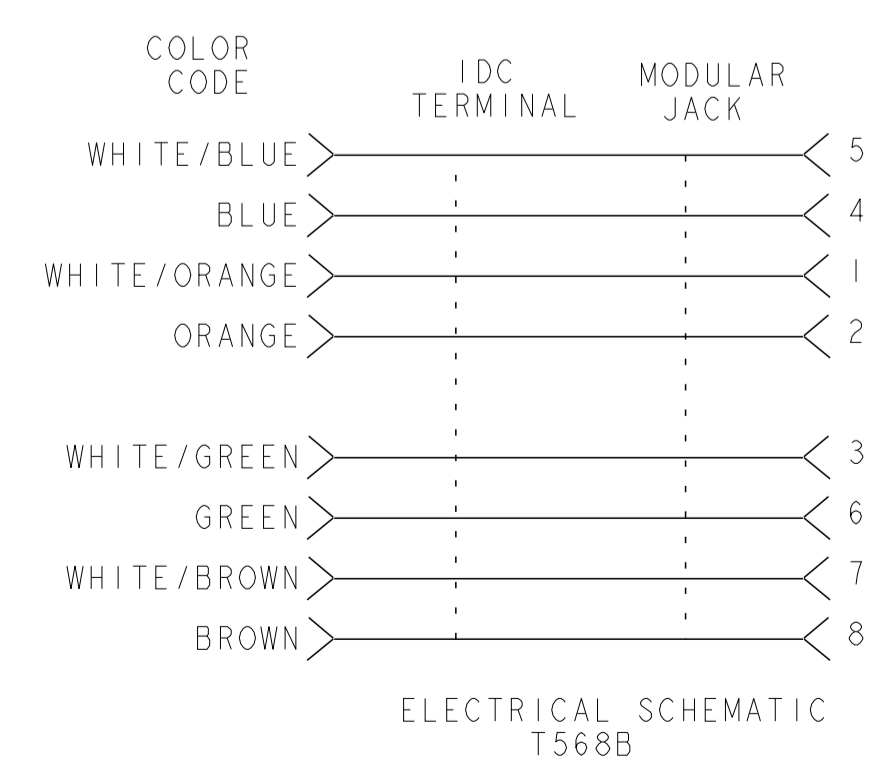
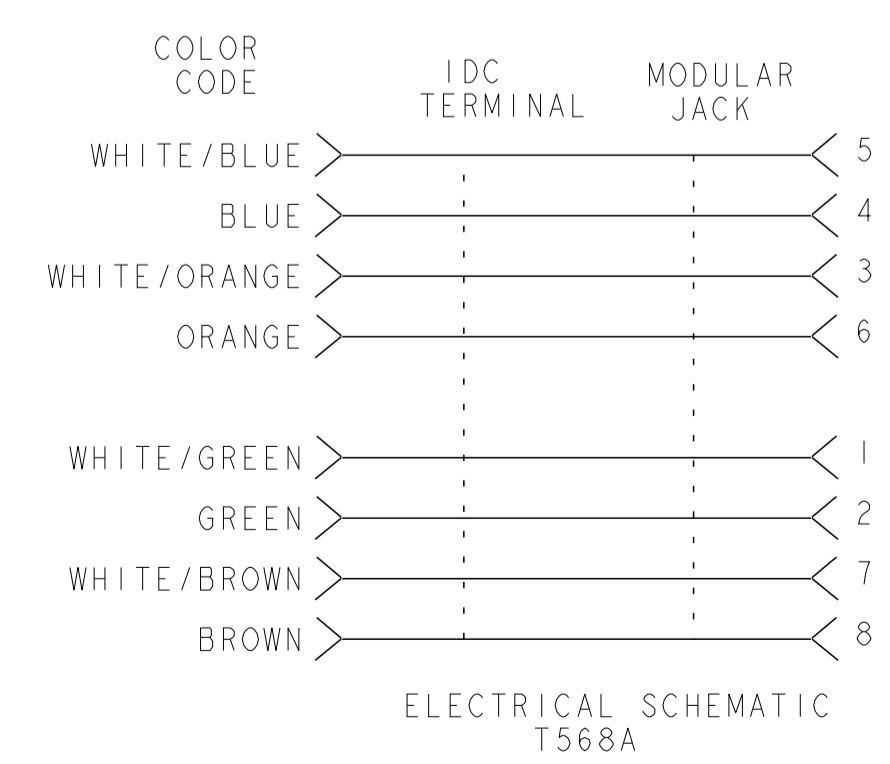

PACKAGE	HOUSING COLOR	PART NUMBER
ALPINE WHITE		1-1499632-3
ELECTRIC IVORY		1-1499632-1
VIOLET		1-1499632-0
GREEN		1499632-9
YELLOW		1499632-8
RED		1499632-7
BLUE		1499632-6
ORANGE		1499632-5
NEMA GRAY		1499632-4
WHITE		1499632-3
BLACK		1499632-2
LIGHT ALMOND		1499632-1

THIS DRAWING IS A CONTROLLED DOCUMENT.

DMN: L. SMITH 01JUL2005
CHK: C. DOOLEY 06JUL2005
APVD: C. DOOLEY 06JUL2005

TE Connectivity

ASSY, CAT 5E, UTP, KL SERIES JACK

SIZE: A100779 C=1499632

Customer Drawing

SCALE: 4:1 SHEET 1 OF 1 REV F1