

MODEL NUMBER
ADT-2594-MM-SMA-02

NOTES:

1.0 MATERIALS:

- 1.1 HOUSING & NUTS: STAINLESS STEEL PER ASTM-A582, TYPE 303.
- 1.2 CENTER CONTACT: BERYLLIUM COPPER ROD ALLOY C172, PER ASTM-B196.
- 1.3 DIELECTRIC: PTFE FLUOROCARBON PER ASTM-D1457.

2.0 PLATING:

- 2.1 HOUSING & NUTS: PASSIVATED PER MIL-F-14072 AND QQ-P-35
- 2.2 CENTER CONTACT: GOLD PER MIL-G-45204, TYPE II, CLASS 2.

3.0 ELECTRICAL SPECIFICATIONS:

- 3.1 FREQUENCY RANGE: DC to 18.0 GHz
- 3.2 VSWR: 1.05 + .005f(GHz)
- 3.3 IMPEDANCE: 50 OHMS

4.0 DIMENSIONS IN PARENTHESIS ARE IN MILLIMETERS.

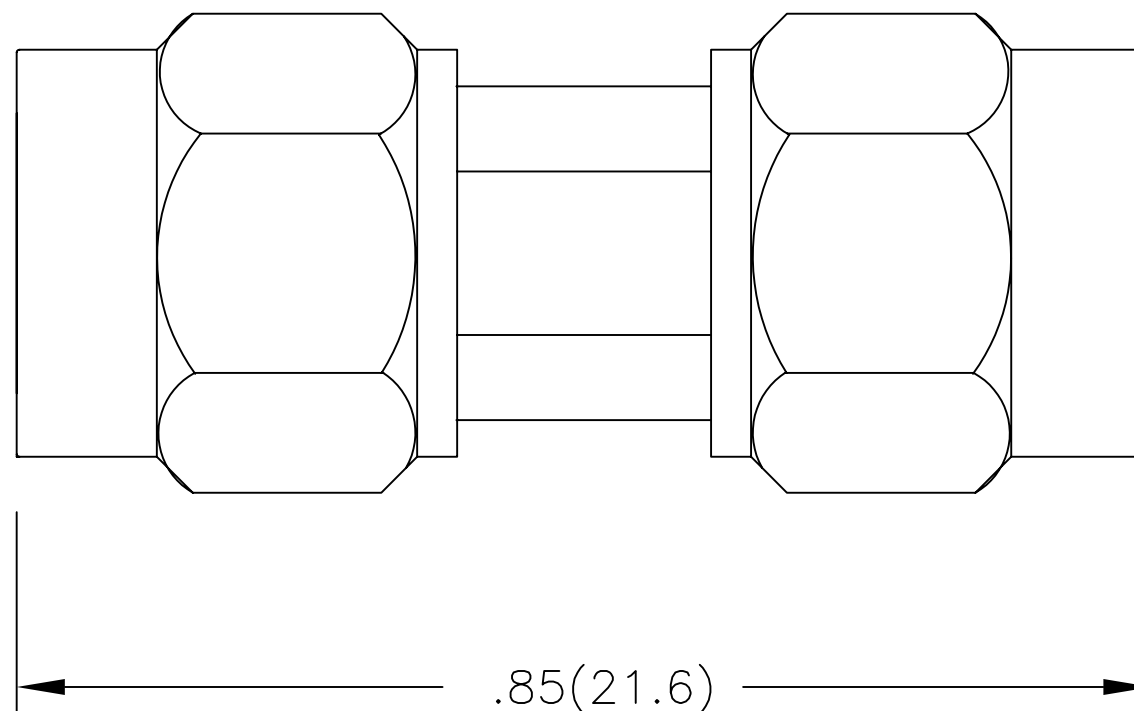

SMA PLUG
PER MIL-C-39012
(BOTH ENDS)

DWG NO. WAS: 02757-01-00

REV.	DESCRIPTION	DATE
-	RELEASED	11/20/92
A	ECR 6545	6/30/89
B	ECR 6933	4/4/90
B1	MODEL NO. 001- TO 000	5/24/90
B2	UPDATE MOD. NO	2/21/91
C	REDRAW ON CAD	11/16/92
C1	ADDED TITLEBLOCK	3/10/05

NOTICE: The information contained in this drawing is proprietary and must not be used without the permission of Emerson Network Power. UNLESS OTHERWISE NOTED DIMENSIONS ARE IN INCHES AND TOLERANCES ARE: 3 PLACE DECIMALS ±.005 2 PLACE DECIMALS ±.02 FRACTIONS ±1/64 PARALLELITY: T.I.R. _____ FLATNESS: T.I.R. _____ CONCENTRICITY: T.I.R. _____ ANGLES AND PERPENDICULARITY: ±1'	CAGE CODE 34078	MIDWEST MICROWAVE	
			TITLE ADAPTER SMA PLUG TO SMA PLUG OUTLINE DRAWING
DRAWN/DATE A.BEATTY 11/16/92	ENG./DATE A.OSGA 11/19/92	DRAWING NUMBER ADT-2594-MM-SMA-02-01	REV. C1
CHECKED/DATE M.HOLLMAN 11/18/92	APPROVED/DATE	SCALE: 5=1	SHEET 1 of 1