

Technical specification:

Rated voltage: 30 V
IEC 61076-2-101

Current rating: 1,5 A at 40°C
IEC 61076-2-101

Insulation resistance: >=100 MΩ
IEC 60512

Pollution degree: 3/2
IEC 60664-1

Degree of protection: IP 67, in mated condition
IEC 60529

Temperature range: -30°C ... +85°C
EN 60512-11-10
-40°C ... +85°C
EN 60512-11-4

Mating cycles: >=100
IEC 60512-9a

Materials:

Contact: CuZn, Ni b / Au 0,2 gal.

Contact carrier: PA, UL 94 V-0

Sealing: FPM

Socket housing: CuZn, nickel plated

Shroud: CuSn6 / Sn

Installation specification:

Recommended torque: 0,8-1 Nm

Conec installation tool: Torque wrench: 36-000200
Insert across flats 15: 36-000320

Installation hole: see fig.1 43K1A1791

Part no:	Description:	Pos	Note:
43-02640	SAL - 12 - FKW12	12	
43-02641	SAL - 12S - FKW12	12	with shroud

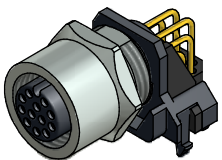

DO NOT ALTER CAD DRAWING BY HAND

RoHS & REACH compliant

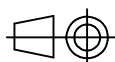

dim. in mm

	date	name
drawn	07.08.15	Böckeler
appd.	07.08.15	Franz



title:

Female socket M12x1 ngled, frontmounting, dip solder

dwg no:

43K1A3062

part no:

see table

general tolerance: 0 ± 0,50mm
0,0 ± 0,25mm
0,00 ± 0,10mm
+ ± 5°

THIS DRAWING MAY NOT BE COPIED OR REPRODUCED IN ANY WAY, AND MAY NOT BE PASSED ON TO A THIRD PARTY WITHOUT WRITTEN PERMISSION. OWNERSHIP AND COPYRIGHT OF CONEC GmbH