

DO NOT SCALE FROM THIS PRINT

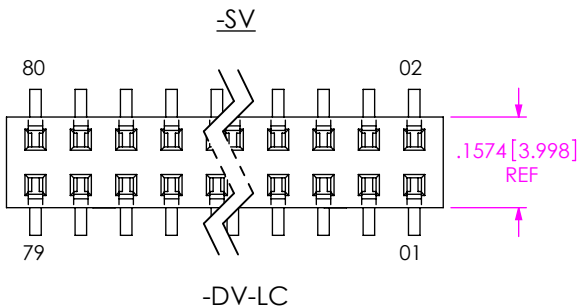
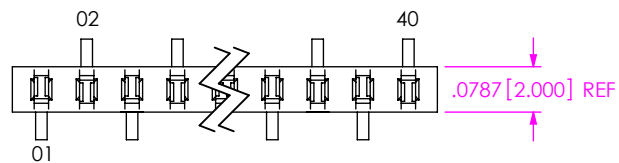

NO OF POSITIONS

-02 THRU -40
(PER ROW)

LEAD STYLE

-02: SURFACE MOUNT

PLATING SPECIFICATION

- S: 30µ" SELECTIVE GOLD IN CONTACT AREA, MATTE TIN TAIL
- L: 10µ" SELECTIVE GOLD IN CONTACT AREA, MATTE TIN TAIL
- F: 3µ" SELECTIVE GOLD IN CONTACT AREA, MATTE TIN TAIL
- ** -T: MATTE TIN OVER ENTIRE CONTACT
- LT: 10µ" SELECTIVE GOLD IN CONTACT AREA, TIN LEAD (90/10 ±5%) TAIL
- SM: 30µ" SELECTIVE GOLD IN CONTACT AREA, MATTE TIN TAIL
- LM: 10µ" SELECTIVE GOLD IN CONTACT AREA, MATTE TIN TAIL
- FM: 3µ" SELECTIVE GOLD IN CONTACT AREA, MATTE TIN TAIL
- ** -TM: MATTE TIN OVER ENTIRE CONTACT
- H: 30µ" GOLD IN CONTACT AREA, 3µ" GOLD ON TAIL

PACKAGING

- BLANK: TUBES (SEE NOTE 13)
- TR: TAPE & REEL (SEE NOTES 14 & 15) (SEE FIG 8, SHT 4) (AVAILABLE ON 2-36 POS ONLY)
- FR: FULL REEL QTY TAPE & REEL (SEE NOTES 14 & 15) (SEE FIG 8, SHT 4) (AVAILABLE ON 2-36 POS ONLY)

PICK & PLACE PAD

- P: PICK & PLACE PAD (ONLY AVAILABLE ON -SV & -DV, 4 POS MIN) (-SV: USE PPP-09; -DV: USE PPP-03; SEE FIG 5, SHT 3)
- M: METAL PICK & PLACE PAD (ONLY AVAILABLE ON -DV) (USE LMP-03, SEE FIG 7, SHT 3)
- K: POLYIMIDE FILM PAD (AVAILABLE ON 3 POS MIN, FOR -SV USE K-DOT-.118-.219-.005, FOR -DV USE K-DOT-.217-.313-.005) (SEE FIG 6, SHT 3)

POLARIZING OPTION

-XX INDICATES POSITION No (USE PK-02-N)

OPTION

- LC: LOCKING CLIP (NOT AVAILABLE ON -SV) (USE LC-06-TM, SEE FIG 1, FIG 2 & 3, SHT 2 & NOTES 6 & 7)
- A: MOLDED ALIGNMENT PIN (AVAILABLE ON -DV ONLY) (USE MMS-XX-D-VXX, SEE FIG 4, SHT 3)

ENTRY/ROW SPECIFICATION

- SH: SINGLE ROW, HORIZONTAL ENTRY
- DH: DOUBLE ROW, HORIZONTAL ENTRY
- SV: SINGLE ROW, VERTICAL (TOP) ENTRY
- DV: DOUBLE ROW, VERTICAL (TOP) ENTRY

** = AVAILABLE TO EXISTING CUSTOMERS ONLY

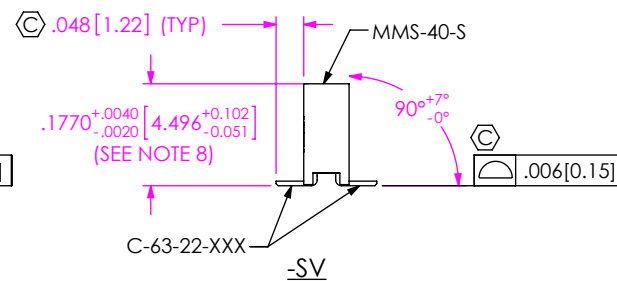
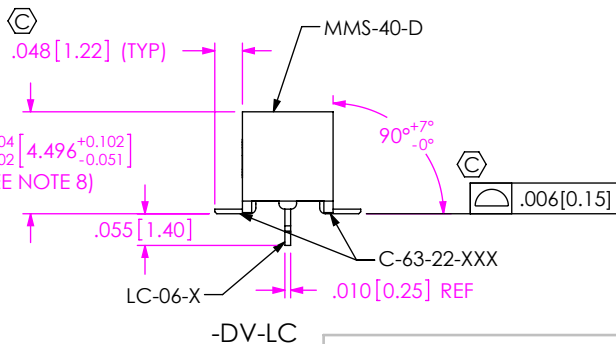
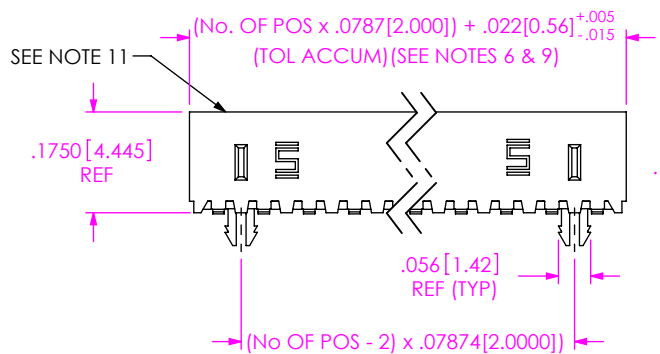
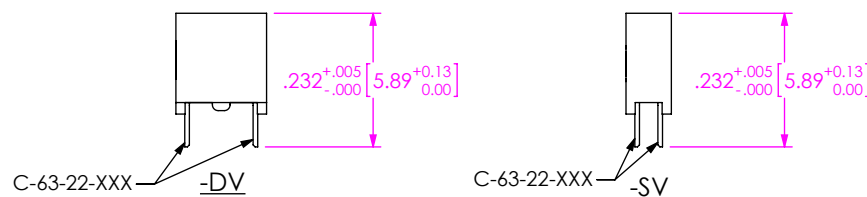

FIG 1
MMS-140-02-XXX-XV-LC SHOWN

NOTES:

1. Ⓢ REPRESENTS A CRITICAL DIMENSION.
2. MAXIMUM ALLOWABLE SWAY: 2° IN EITHER DIRECTION
3. MAXIMUM BURR ALLOWANCE: .003 [0.08]
4. MAXIMUM CUT FLASH: .020, NO FLASH CAN EXTEND BELOW SOLDER TAILS.
5. MINIMUM RETENTION FORCE: SINGLE ROW: .5 LB, DOUBLE ROW: 1 LB
6. CUT BODIES FROM MMS-40-D OR MMS-40-S FOR ALL STYLES EXCEPT -LC. FOR -LC, USE POSITIONALIZED BODIES. 3 POSITION -DV-LC PARTS WILL HAVE 1 LOCKING CLIP.
7. DUE TO THE HIGH AMOUNT OF INSERTION FORCE NEEDED, THE -LC OPTION IS NOT COMPATIBLE WITH AUTO PLACEMENT. SAMTEC RECOMMENDS MANUAL PLACEMENT FOR ALL ASSEMBLIES WITH THE -LC OPTION.
8. THIS DIMENSION TO BE MEASURED AT BEND.
9. FOR -SV LEAD STYLE, EVEN POSITION CUTS LOSE 2 POSITIONS PER CUT; ODD POSITION CUTS LOSE 1 POSITION PER CUT.
10. LEAD STYLE -02-SH, POSITIONS 2 THRU 4 TO BE PACKAGED IN BOXES. ALL OTHER ROW SPECIFICATIONS SHOULD BE TUBED ACCORDING TO TABLE 2, REGARDLESS OF POSITION.
11. PK-02-N TO BE INSERTED FROM THIS SIDE.
12. 4 POSITION PART WITH -P OPTION MUST SHIP IN -TR PACKAGING.
13. TUBES ARE STANDARD PACKAGING.
14. ORDERS WILL BE PACKAGED ACCORDING TO THE SAMTEC PACKAGING EFFICIENCY STANDARDS (SPES) FOUND ON WWW.SAMTEC.COM
15. ATTACH LABEL TO EACH REEL



IN-PROCESS

UNLESS OTHERWISE SPECIFIED, DIMENSIONS ARE IN INCHES.

TOLERANCES ARE:
DECIMALS ANGLES
.XX: ±.01 [0.3] 2°
.XXX: ±.005 [0.13]
.XXXX: ±.0020 [0.051]

PROPRIETARY NOTE

THIS DOCUMENT CONTAINS CONFIDENTIAL AND PROPRIETARY INFORMATION AND ALL DESIGN, MANUFACTURING, REPRODUCTION, USE, PATENT RIGHTS AND SALES RIGHTS ARE EXPRESSLY RESERVED BY SAMTEC, INC. THIS DOCUMENT SHALL NOT BE DISCLOSED, IN WHOLE OR PART, TO ANY UNAUTHORIZED PERSON OR ENTITY NOR REPRODUCED, TRANSFERRED OR INCORPORATED IN ANY OTHER PROJECT IN ANY MANNER WITHOUT THE EXPRESS WRITTEN CONSENT OF SAMTEC, INC.



520 PARK EAST BLVD, NEW ALBANY, IN 47150
PHONE: 812-944-6733 FAX: 812-948-5047
e-Mail: info@SAMTEC.com code 55322

MATERIAL: DO NOT SCALE DRAWING SHEET SCALE: 3:1

INSULATOR: VECTRA E130I, COLOR: BLACK
CONTACT: PHOS BRONZE

DESCRIPTION: 2mm SURFACE MOUNT BOX CONNECTOR STRIP ASM

DWG. NO. MMS-1XX-02-XXX-XX-XX-XX-X-XX

BY: BRATCHER 04/01/1994 SHEET 1 OF 4

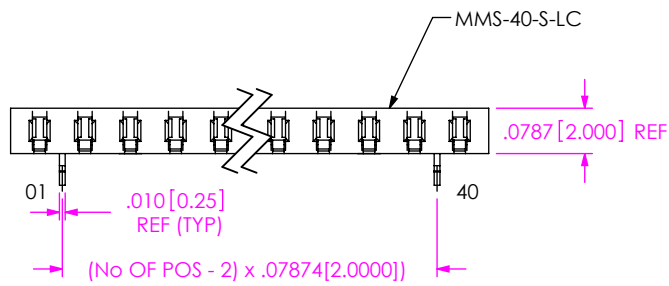

FIG 2
MMS-140-02-XXX-SH-LC SHOWN

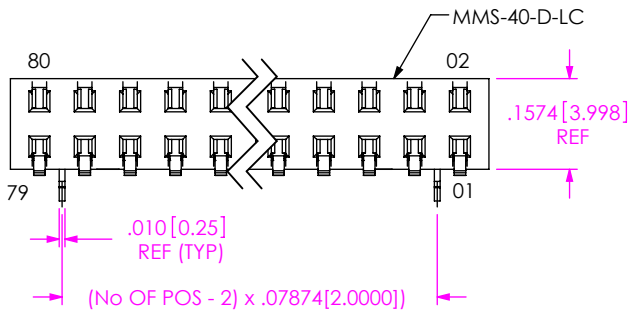
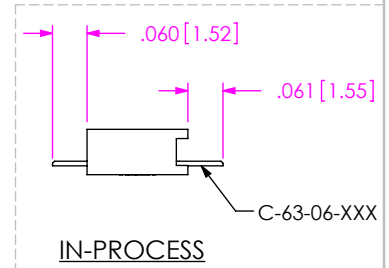
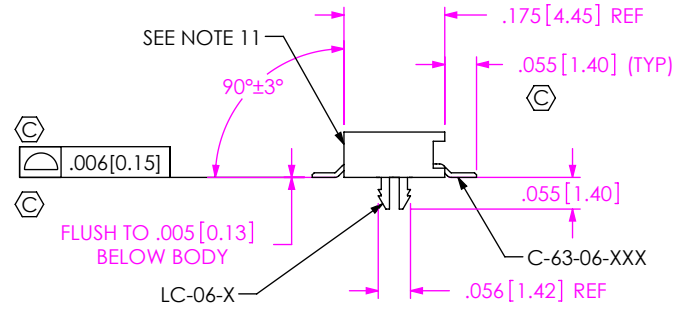
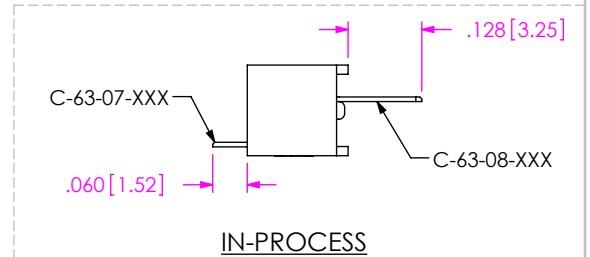
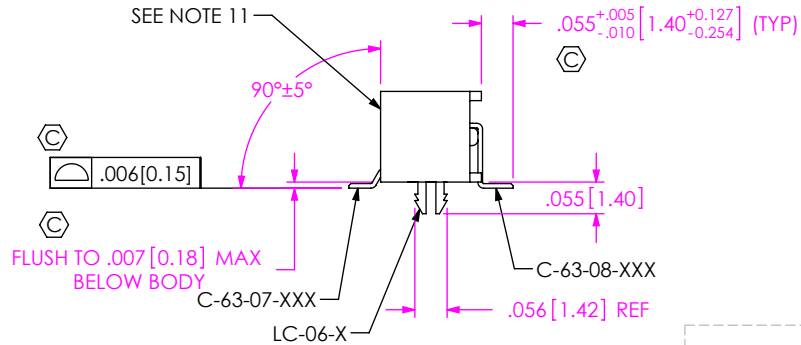

FIG 3
MMS-140-02-XXX-DH-LC SHOWN



PROPRIETARY NOTE
 THIS DOCUMENT CONTAINS CONFIDENTIAL AND PROPRIETARY INFORMATION AND ALL DESIGN, MANUFACTURING, REPRODUCTION, USE, PATENT RIGHTS AND SALES RIGHTS ARE EXPRESSLY RESERVED BY SAMTEC, INC. THIS DOCUMENT SHALL NOT BE DISCLOSED, IN WHOLE OR PART, TO ANY UNAUTHORIZED PERSON OR ENTITY NOR REPRODUCED, TRANSFERRED OR INCORPORATED IN ANY OTHER PROJECT IN ANY MANNER WITHOUT THE EXPRESS WRITTEN CONSENT OF SAMTEC, INC.



520 PARK EAST BLVD, NEW ALBANY, IN 47150
 PHONE: 812-944-6733 FAX: 812-948-5047
 e-Mail info@SAMTEC.com code 55322

DO NOT SCALE DRAWING
 SHEET SCALE: 3:1

DESCRIPTION:
 2mm SURFACE MOUNT BOX CONNECTOR STRIP ASM
 DWG. NO.
MMS-1XX-02-XXX-XX-XX-XX-X-XX
 BY: BRATCHER 04/01/1994 SHEET 2 OF 4

"R" = USED MEASURED DIMENSION
 "S" = ("R" - .118[3.00]) / 2

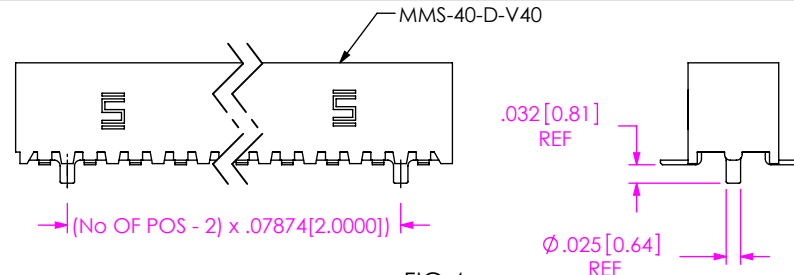
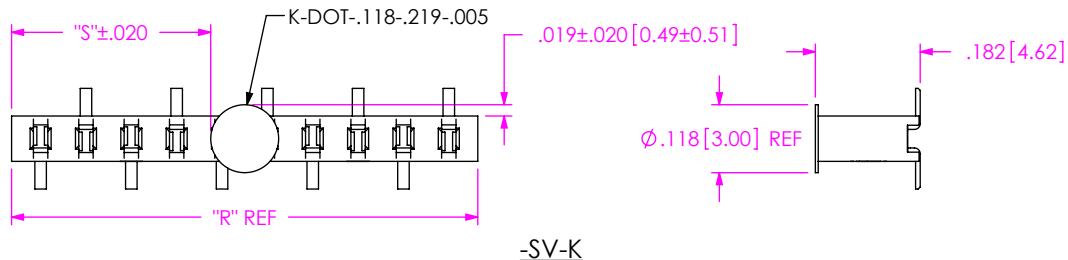

FIG 4
 -A: MOLDED ALIGNMENT PIN
 ONLY AVAILABLE ON -DV
 (MMS-140-02-XXX-DV-A SHOWN)
 (DIFFERENT AS SHOWN, OTHERWISE SAME AS FIG 1)

"M" = USED MEASURED DIMENSION
 "P" = ("M" - .2165[5.50]) / 2

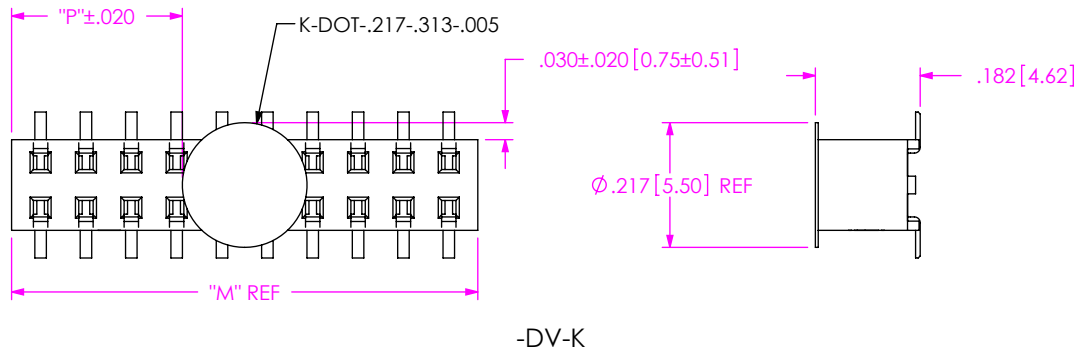

FIG 6
 -K: POLYIMIDE FILM PAD
 ONLY AVAILABLE ON -SV & -DV
 (MMS-140-02-XXX-XV-K SHOWN)
 (DIFFERENT AS SHOWN, OTHERWISE SAME AS FIG 1)

"L" = (No OF POSITIONS x .07874[2.0000]) + .022[0.56]

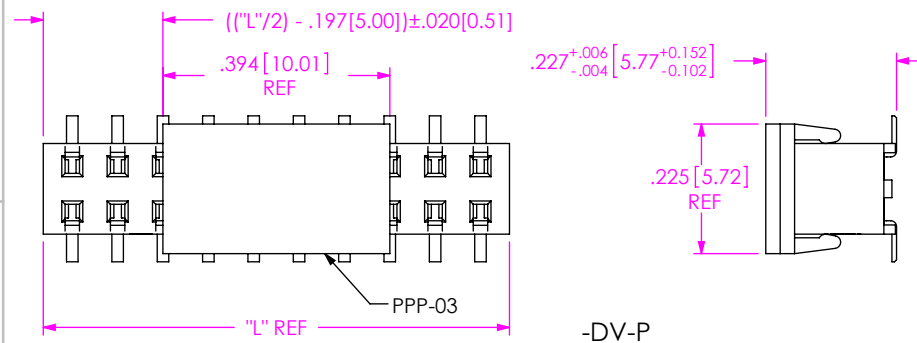
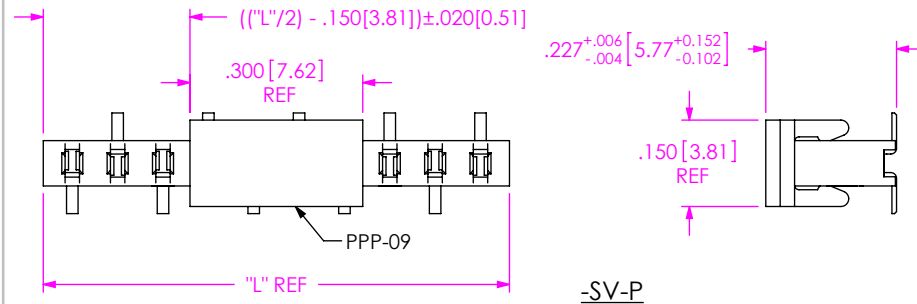

FIG 5
 -P: PICK & PLACE PAD
 ONLY AVAILABLE ON -SV & -DV
 (MMS-140-02-XXX-XV-P SHOWN)
 (DIFFERENT AS SHOWN, OTHERWISE SAME AS FIG 1)

"L" = (No OF POSITIONS x .07874[2.0000]) + .022[0.56]

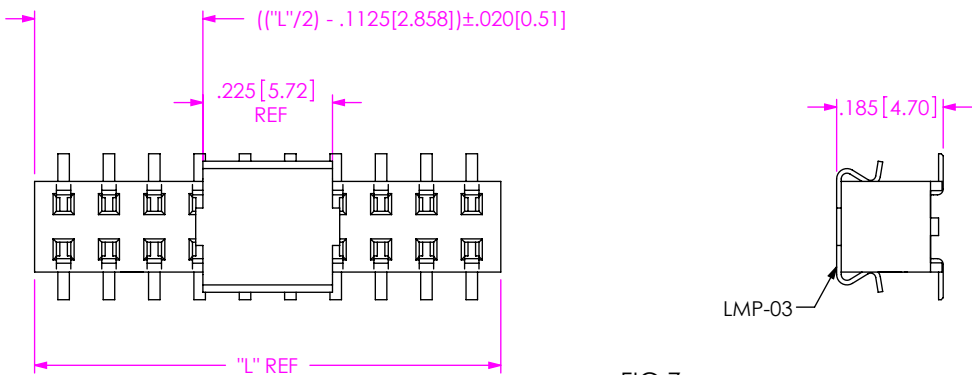

FIG 7
 -M: METAL PICK & PLACE PAD
 ONLY AVAILABLE ON -DV
 (MMS-140-02-XXX-DV-M SHOWN)
 (DIFFERENT AS SHOWN, OTHERWISE SAME AS FIG 1)

PROPRIETARY NOTE
 THIS DOCUMENT CONTAINS CONFIDENTIAL AND PROPRIETARY INFORMATION AND ALL DESIGN, MANUFACTURING, REPRODUCTION, USE, PATENT RIGHTS AND SALES RIGHTS ARE EXPRESSLY RESERVED BY SAMTEC, INC. THIS DOCUMENT SHALL NOT BE DISCLOSED, IN WHOLE OR PART, TO ANY UNAUTHORIZED PERSON OR ENTITY NOR REPRODUCED, TRANSFERRED OR INCORPORATED IN ANY OTHER PROJECT IN ANY MANNER WITHOUT THE EXPRESS WRITTEN CONSENT OF SAMTEC, INC.

samtec
 520 PARK EAST BLVD, NEW ALBANY, IN 47150
 PHONE: 812-944-6733 FAX: 812-948-5047
 e-Mail info@SAMTEC.com code 55322

DO NOT SCALE DRAWING

SHEET SCALE: 3:1

DESCRIPTION:
 2mm SURFACE MOUNT BOX CONNECTOR STRIP ASM

DWG. NO.
MMS-1XX-02-XXX-XX-XX-XX-X-XX

BY: BRATCHER 04/01/1994 SHEET 3 OF 4

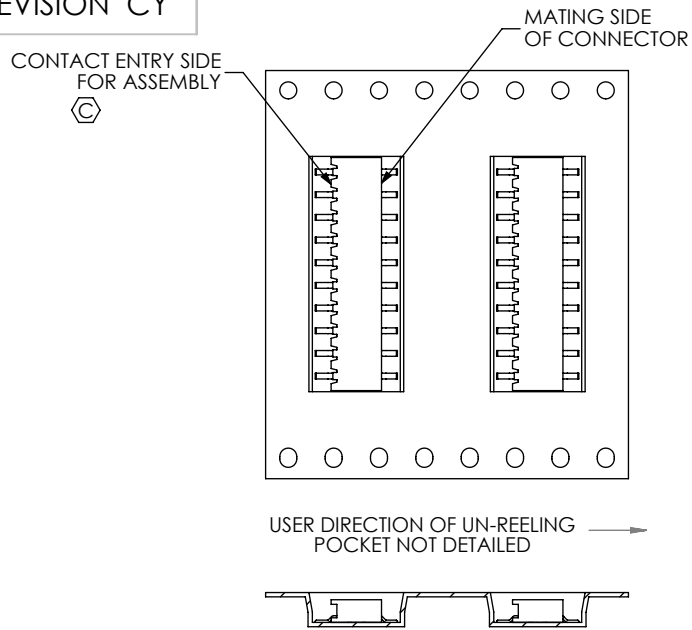

MMS-110-02-XXX-SH SHOWN FOR ORIENTATION OF -SH & -DH STYLES
(MMS-103-02-X-LC, POS 1 TO FACE ROUND HOLES)

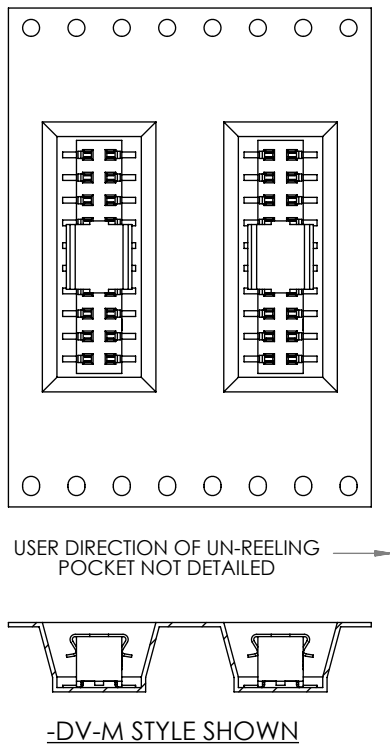

FIG 8
-TR: TAPE & REEL PACKAGING

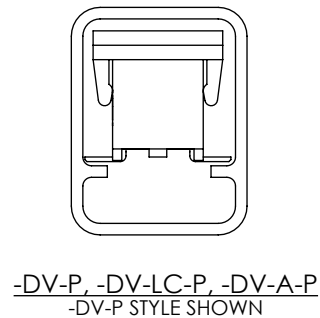
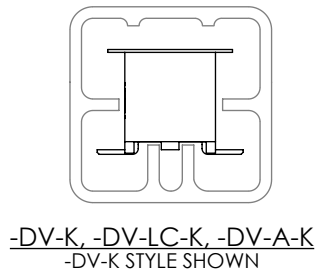
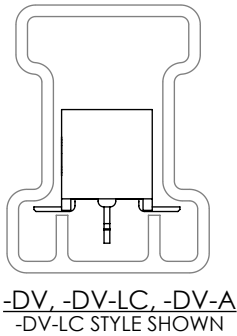
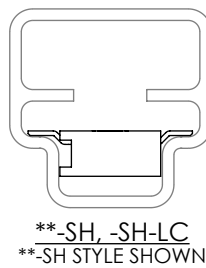
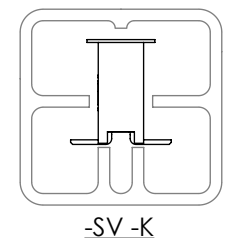
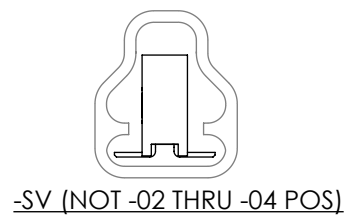
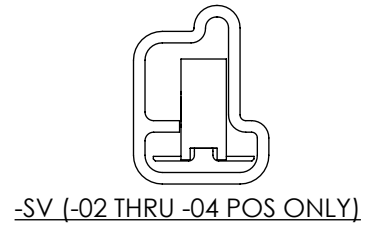
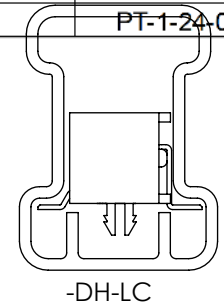

FIG 9
TUBE PACKAGING OPTIONS

| TABLE 2 (#1 POSITION TO BE TUBED IN DIRECTION C) | |
|--|----------------|
| LEAD STYLE | PACKAGING TUBE |
| -DV, -DV-LC, -DV-A | PT-1-24-02-17 |
| -DV-M, -DV-LC-M, -DV-A-M | PT-1-24-01-63 |
| -DV-K, -DV-LC-K, -DV-A-K | PT-1-24-02-63 |
| ***-DV-P, ***-DV-LC-P, ***-DV-A-P | PT-BKT001 |
| *-SH, -SH-LC | PT-1-24-02-16 |
| -DH | PT-1-24-02-17 |
| ***-DH-P, -DH-K | PT-1-24-06-17 |
| -DH-LC | PT-1-24-02-17 |
| -SV (NOT -02 THRU -04 POS) | PT-1-24-01-16 |
| -SV (-02 THRU -04 POS ONLY) | PT-1-24-01-68 |
| ***-SV-P NOTE 12 | PT-1-24-13-09 |
| -SV-K | PT-1-24-03-63 |



| | | |
|---|---|---|
| <p>DO NOT SCALE DRAWING</p> <p>SHEET SCALE: 3:1</p> | <p>PROPRIETARY NOTE</p> <p>THIS DOCUMENT CONTAINS CONFIDENTIAL AND PROPRIETARY INFORMATION AND ALL DESIGN, MANUFACTURING, REPRODUCTION, USE, PATENT RIGHTS AND SALES RIGHTS ARE EXPRESSLY RESERVED BY SAMTEC, INC. THIS DOCUMENT SHALL NOT BE DISCLOSED, IN WHOLE OR PART, TO ANY UNAUTHORIZED PERSON OR ENTITY NOR REPRODUCED, TRANSFERRED OR INCORPORATED IN ANY OTHER PROJECT IN ANY MANNER WITHOUT THE EXPRESS WRITTEN CONSENT OF SAMTEC, INC.</p> | <p>samtec</p> <p>520 PARK EAST BLVD, NEW ALBANY, IN 47150 PHONE: 812-944-6733 FAX: 812-948-5047 e-Mail: info@SAMTEC.com code 55322</p> |
| | <p>DESCRIPTION: 2mm SURFACE MOUNT BOX CONNECTOR STRIP ASM</p> | |
| | <p>DWG. NO. MMS-1XX-02-XXX-XX-XX-XX-X-XX</p> | |
| <p>BY: BRATCHER 04/01/1994</p> | | <p>SHEET 4 OF 4</p> |