

SCALE 1:1

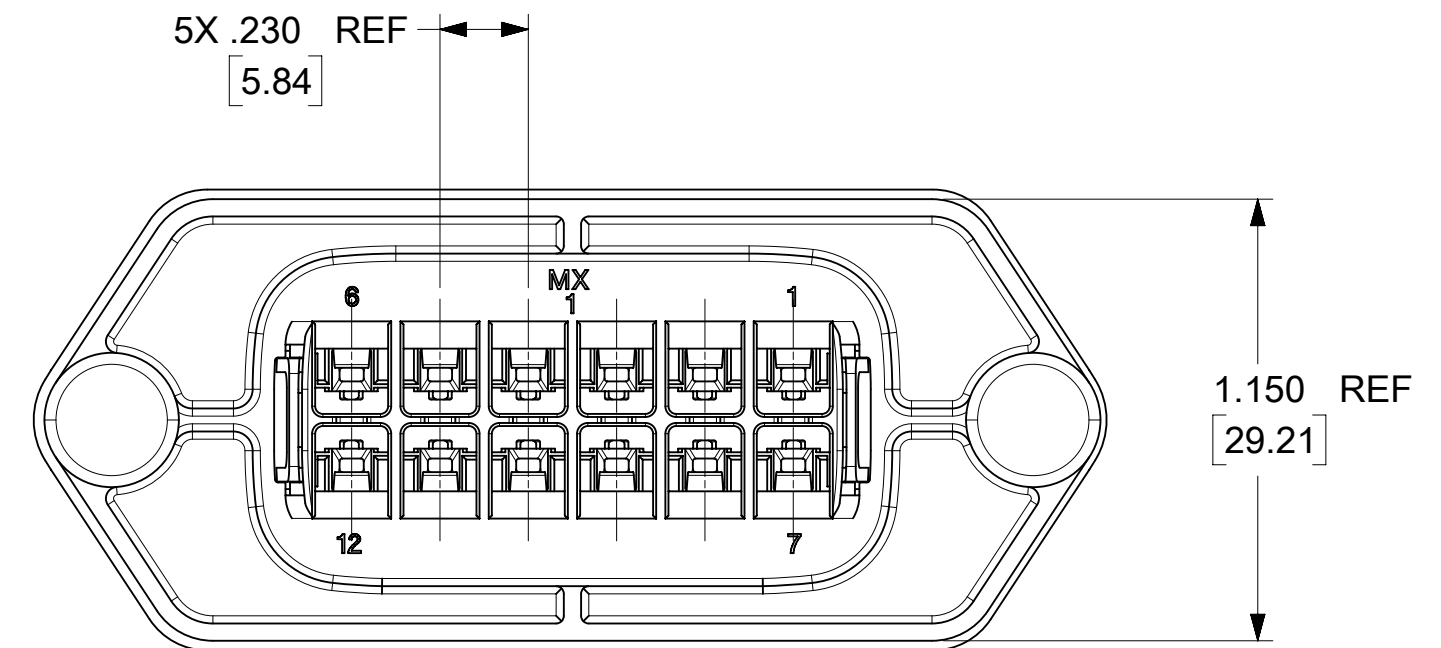
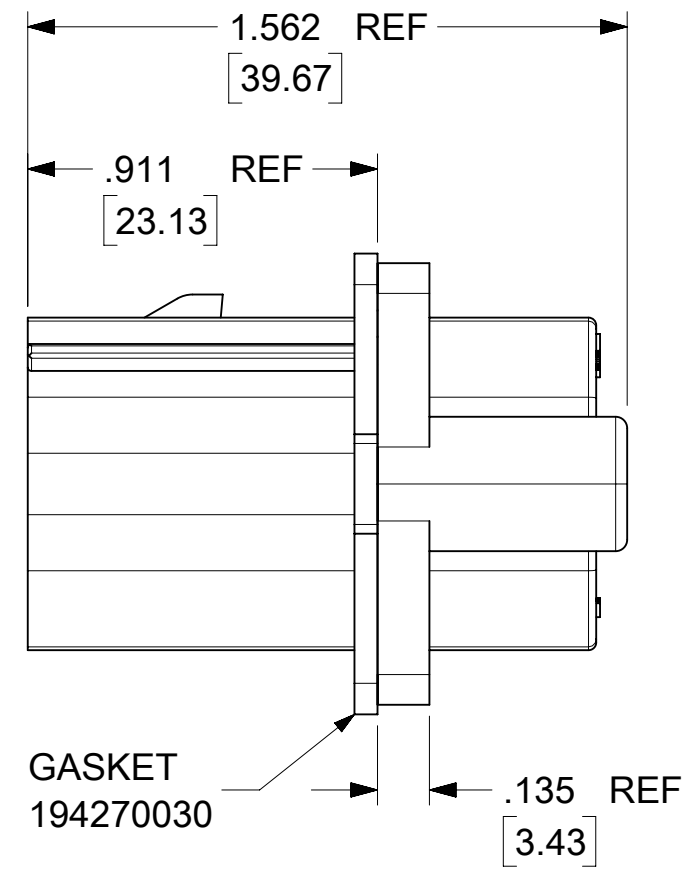
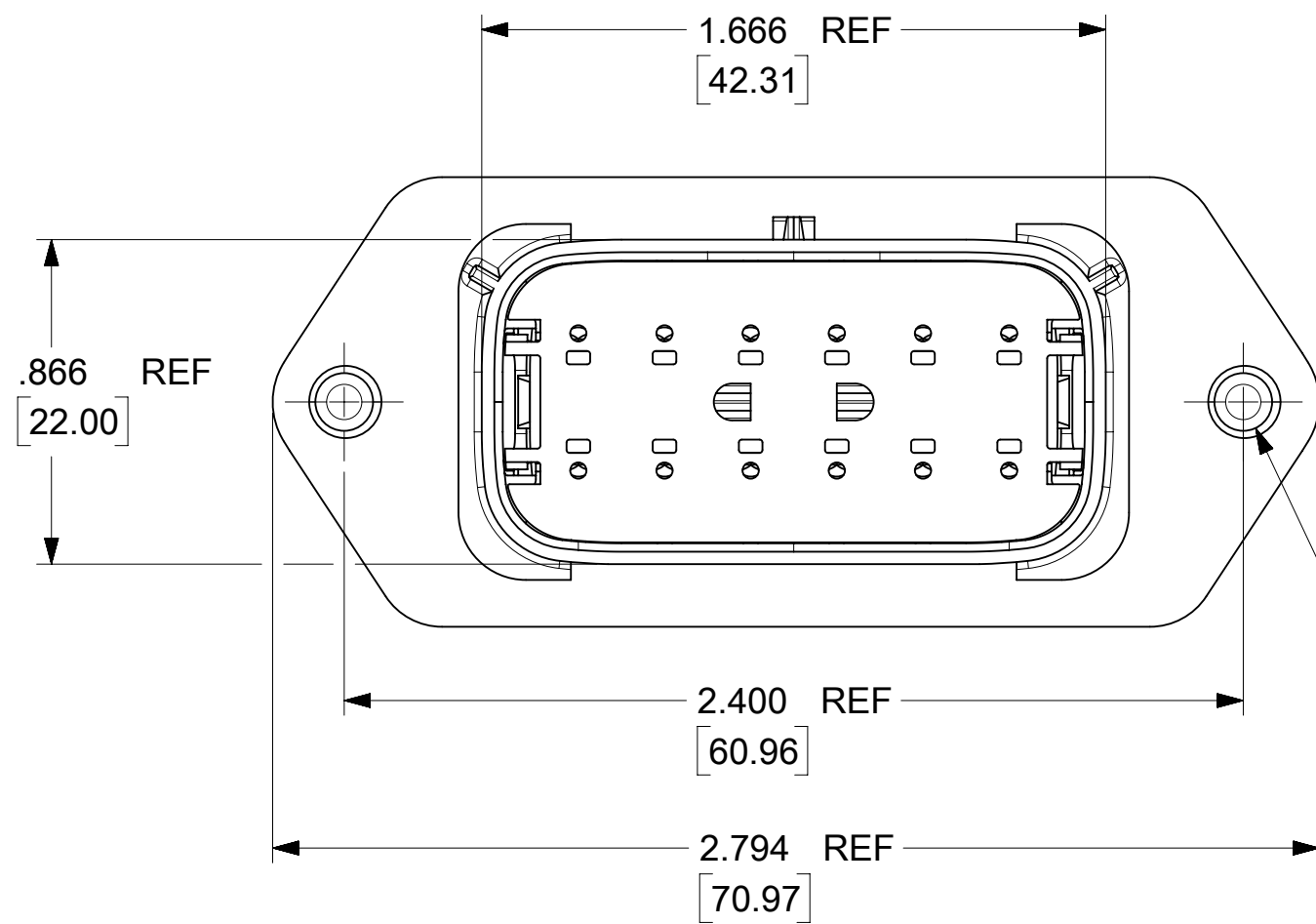

2X Ø .154 X .030 X 45° CHAM REF [3.91]

194290039	YES
194290015	NO
MATERIAL NUMBER	GASKET

- NOTES:
- MATERIALS: <sup>ⓔ</sup>  
HOUSING: SYNDIOTACTIC POLYSTYRENE (SPS), GLASS FILLED, UL94 V-0, COLOR: BLACK  
GASKET: EPDM RUBBER
  - PRODUCT SPECIFICATION: PS-19417-001.
  - PACKAGING SPECIFICATION: PK-19429-001.  
GASKETS, IF REQUIRED FOR THE ASSEMBLIES, ARE BULK PACKAGED IN A SEPARATE BAG.
  - MATES WITH: 19418 SERIES RECEPTACLE ASSEMBLIES.
  - USE CONNECTOR WITH MALE CRIMP TERMINAL: SERIES 19417.
  - RECOMMENDED MOUNTING HARDWARE: (2)#10 X .62/15.8 LONG PLASTIC THREAD CUTTING SCREWS. RECOMMENDED TORQUE 15-17 IN-LBS. SUGGESTED SOURCE: ITW SHAKEPROOF INDUSTRIAL BOSSCREW OR EQUIVALENT.
  - ASSEMBLY IS ROHS COMPLIANT.

FUNCTIONAL SYMBOLS FA = 0 FC = 0 FP = 0	THIS DRAWING CONTAINS INFORMATION THAT IS PROPRIETARY TO MOLEX ELECTRONIC TECHNOLOGIES, LLC AND SHOULD NOT BE USED WITHOUT WRITTEN PERMISSION		CURRENT REV DESC: REDRAWN IN NX & HSG MATERIAL UPDATED		
	DIMENSION UNITS	SCALE	EC NO: 690910		
	in/[mm]	2:1	DRWN: RMV02	2021/12/21	
	GENERAL TOLERANCES (UNLESS SPECIFIED)		CHK'D: DMYRICK	2022/01/05	
	MM INCH	APPR: JMACNEIL	2022/01/06		
4 PLACES ±	±	INITIAL REVISION:			
3 PLACES ±	± 0.015	DRWN: DMYRICK		03/12/08	
2 PLACES ±	± 0.38	APPR: DTITUS		2010/10/18	
1 PLACE ±	±	THIRD ANGLE PROJECTION			
0 PLACES ±	±	DRAWING	SERIES		DOCUMENT NUMBER
ANGULAR TOL ± 1.0°		DRAWING		SERIES	DOC TYPE
DRAFT WHERE APPLICABLE MUST REMAIN WITHIN DIMENSIONS		C-SIZE		19429	DOC PART
				SEE CHART	REVISION
				GENERAL MARKET	SD-19429-007
				1 OF 1	PSD 001 E

DOCUMENT STATUS	P1	RELEASE DATE	2022/01/06	14:54:32
-----------------	----	--------------	------------	----------