

LOC		DIST		ZONE		LTR		REVISIONS	
CM	53	P	F					A1	REVISED PER ECR-21-117185
									DATE: 22OCT2021
									APPD: PJ VS

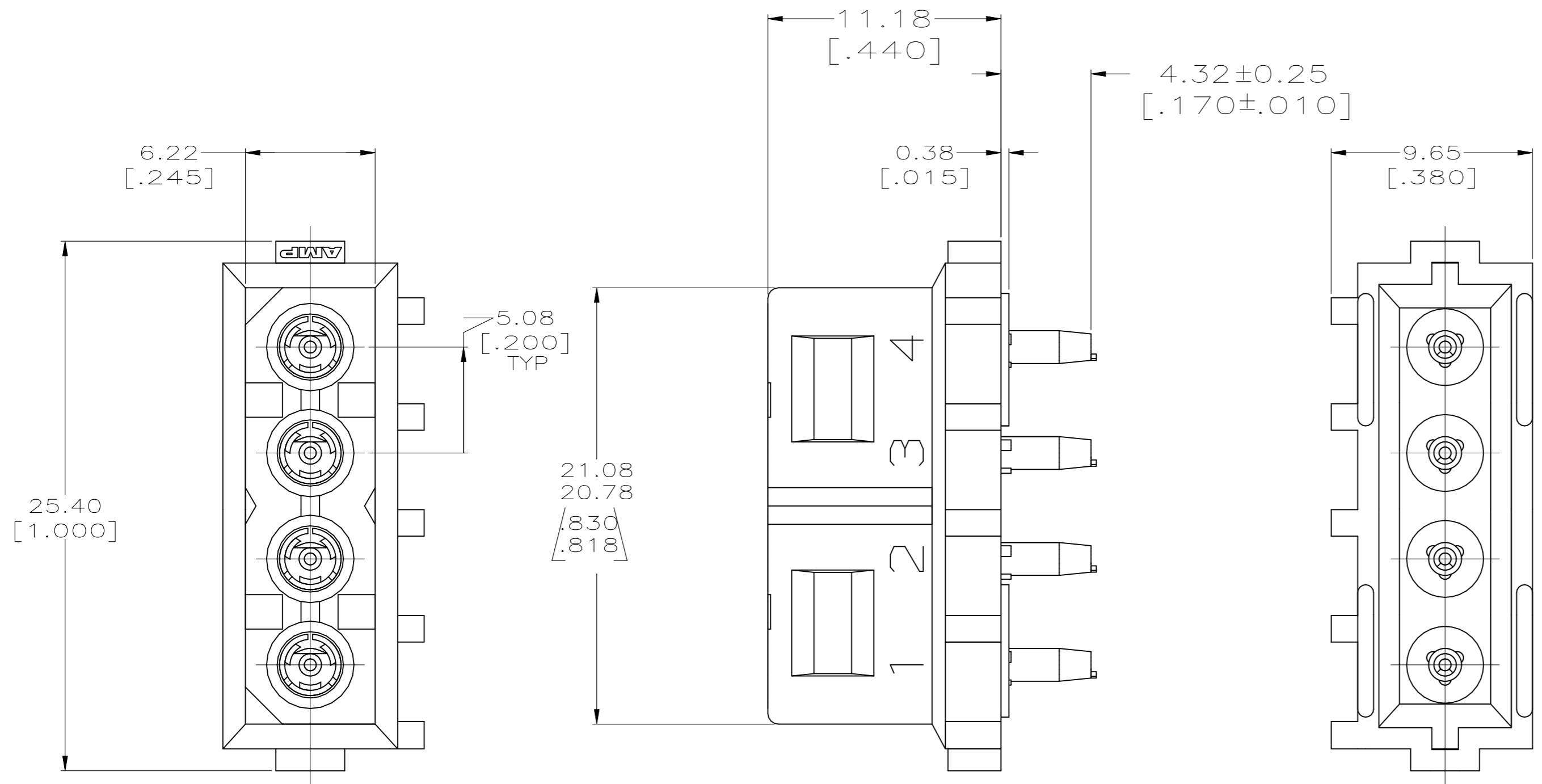

- PARTS COMPLY WITH AMP SOLDERABILITY SPEC. 109-11-5.
- DIMENSIONS IN BRACKETS ARE IN INCHES.
- DIMENSION SHOWN REPRESENT PRODUCT IN DRY CONDITION. ADDITIONAL 2% GROWTH DUE TO END USE LOCATION MOISTURE ABSORPTION MAY OCCUR AND SHOULD BE ACCOUNTED FOR.

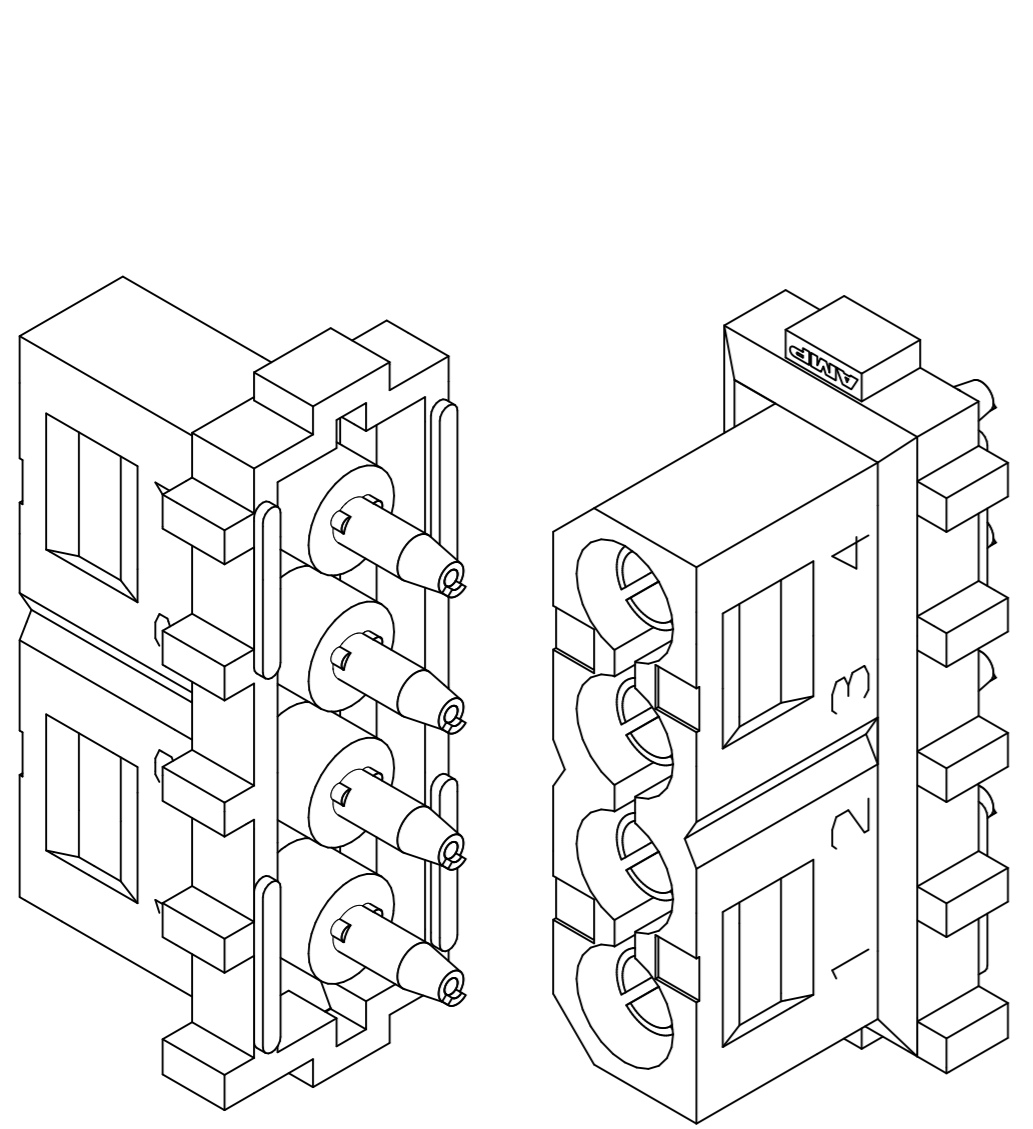

3-DIMENSIONAL MODEL NTS

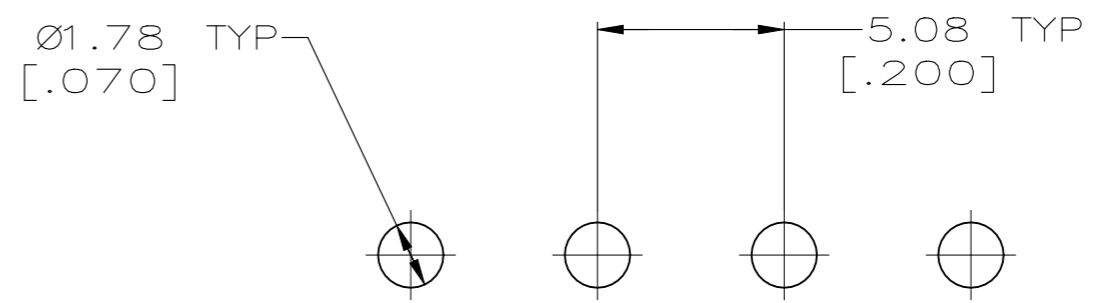
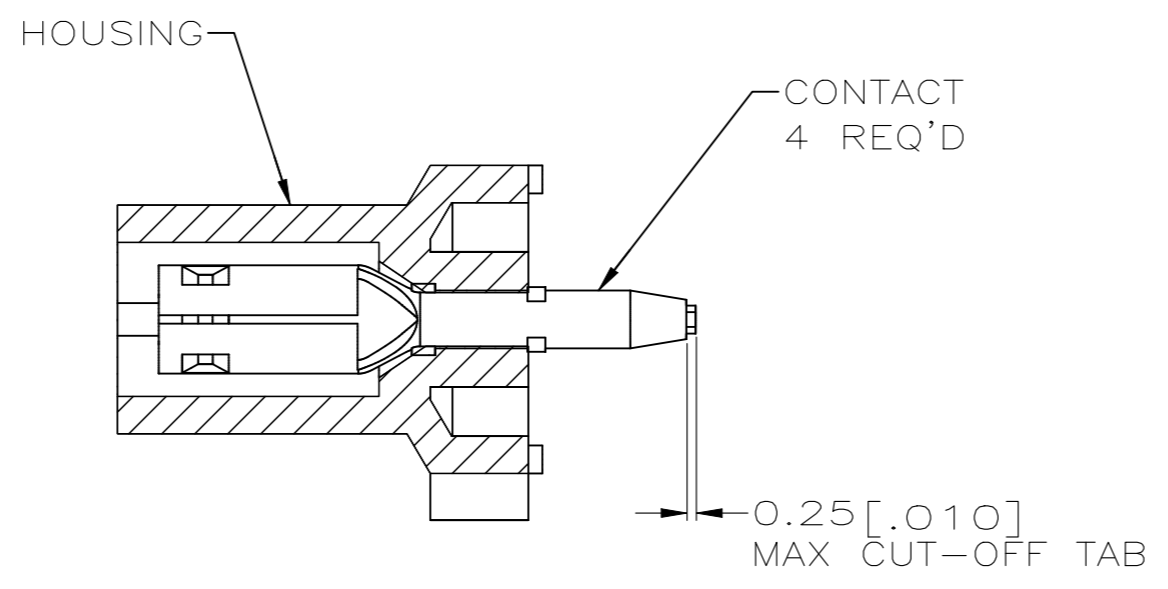

RECOMMENDED MOUNTING HOLE PATTERN FOR 1.57 [.062] THICK P.C. BOARD

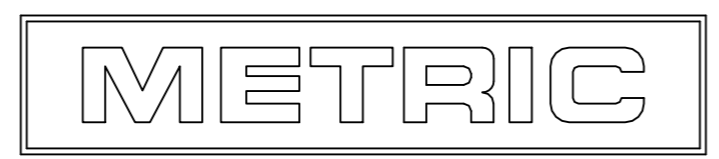

THIS DRAWING IS A CONTROLLED DOCUMENT FOR AMP INCORPORATED. IT IS SUBJECT TO CHANGE AND THE CONTROLLING ENGINEERING ORGANIZATION SHOULD BE CONTACTED FOR THE LATEST REVISION.

0.251 [.0099] THK PH BRZ, PRE-TIN		NYLON UL94V-2, NATURAL		794285-1	
CONTACT MATERIAL & FINISH		HOUSING MATERIAL & COLOR		PART NO	
DO NOT SCALE PRINT. UNLESS SPECIFIED DIMENSIONS IN mm [INCHES] TOLERANCES ON : 2 PLC DEC ± - 3 PLC DEC ± 0.13 [.005] ANGLES ± 0'30'		DR 3-06-97 B. LEWIS CHK 3-06-97 R. SWING APPD 3-06-97 C. MARTIN APPD 3-06-97 C. MARTIN		AMP AMP Incorporated Harrisburg, PA 17105-3608	
MATERIAL		PRODUCT SPEC		NAME	
SEE TABLE		-		SOCKET HEADER ASSEMBLY, 4 CIRCUIT, COMMERCIAL MATE-N-LOK™	
FINISH		APPLICATION SPEC		SIZE	
SEE TABLE		-		CAGE CODE	
				DRAWING NO	
				C-794285	
		WEIGHT		SCALE	
		-		5:1	
				SHEET	
				10F 1	