

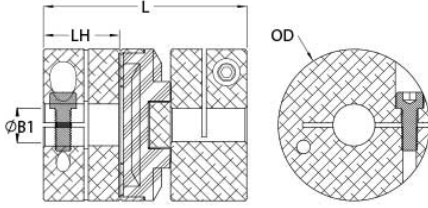

## MOCT19-7-SS

Ruland MOCT19-7-SS, 7mm Oldham Coupling Hub, 303 Stainless Steel, Clamp Style, 19.1mm OD, 9.7mm Length



### Description

Ruland MOCT19-7-SS is a clamp oldham coupling hub with a 7mm bore, 19.1mm OD, and 9.7mm length. It is a component of a three-piece design consisting of two stainless steel hubs press fit onto a center disk. This three-piece design allows for a highly customizable coupling that easily combines clamp or set screw hubs with inch, metric, keyed, and keyless bores. Disks are available in three materials allowing the user to tailor coupling performance to their application. MOCT19-7-SS can accommodate all forms of misalignment and is especially useful in applications with high parallel misalignment (up to 10% of the OD). It operates with low bearing loads protecting sensitive system components such as bearings and has a balanced design for reduced vibration at speeds up to 6,000 RPM. Hardware is metric and tests beyond DIN 912 12.9 standards for maximum torque capabilities. MOCT19-7-SS is machined from bar stock that is sourced exclusively from North American mills and is RoHS3 and REACH compliant. It is manufactured in our Marlborough, MA factory under strict controls using proprietary processes.

### Product Specifications

<b>Bore (B1)</b>	7 mm	<b>Outer Diameter (OD)</b>	19.1 mm
<b>B1 Max Shaft Penetration</b>	9.7 mm	<b>Bore Tolerance</b>	+0.03 mm / -0.00 mm
<b>Hub Width (LH)</b>	9.65 mm	<b>Length (L)</b>	25.4 mm
<b>Recommended Shaft Tolerance</b>	+0.000 mm / -0.013 mm	<b>Forged Clamp Screw</b>	M2.5
<b>Number of Screws</b>	1 ea	<b>Screw Material</b>	18-8 300 Series Stainless Steel
<b>Screw Finish</b>	Bright	<b>Seating Torque</b>	0.73 Nm
<b>Hex Wrench Size</b>	2.0 mm	<b>Torque Specifications</b>	Torque ratings vary with insert selection
<b>Angular Misalignment</b>	0.5°	<b>Parallel Misalignment</b>	0.008 in (0.20 mm)
<b>Max Parallel Misalignment</b>	0.075 in (1.91 mm)	<b>Axial Motion</b>	0.004 in (0.10 mm)
<b>Moment of Inertia</b>	9.678 x 10 <sup>-7</sup> kg-m <sup>2</sup>	<b>Maximum Speed</b>	4,500 RPM
<b>Recommended Inserts</b>	<a href="#">OD12/19-AT</a> , <a href="#">OD12/19-NL</a> , <a href="#">OD12/19-PEK</a>	<b>Full Bearing Support Required?</b>	Yes
<b>Zero-Backlash?</b>	Yes	<b>Balanced Design</b>	Yes
<b>Mechanical Fuse?</b>	Yes	<b>UPC</b>	634529238776
<b>Country of Origin</b>	USA	<b>Material Specification</b>	Type 303 Austenitic, Non-Magnetic Bar
<b>Finish</b>	Bright	<b>Finish Specification</b>	Bright, No Plating
<b>Manufacturer</b>	Ruland Manufacturing	<b>Temperature</b>	Acetal Disk -10°F to 150°F (-23°C to 65°) Nylon Disk -10°F to 130°F (-23°C to 54°C) PEEK Disk -10°F to 300°F (-23°C to 148°C)
<b>Weight (lbs)</b>	0.041700	<b>Tariff Code</b>	8483.60.8000
<b>UNSPC</b>	31163015		
<b>Note 1</b>	"Performance ratings are for guidance only. The user must determine suitability for a particular application."		
<b>Note 2</b>	"Torque ratings for the couplings are based on the physical limitations/failure point of the torque disks. Under normal/typical conditions the hubs are capable of holding up to the rated torque of the disks. In some cases` especially when the smallest standard bores are used or where shafts are undersized` slippage on the shaft is possible below the rated torque of the disks. Keyways are available to provide additional torque capacity in the shaft/hub connection when required. Please consult technical support for more assistance."		

---

**Installation Instructions**

1. Align the bores of the MOCT19-7-SS oldham coupling hubs on the shafts that are to be joined and determine if the misalignment parameters are within the limits of the coupling. (*Angular Misalignment: 0.5° Parallel Misalignment: 0.008 in (0.20 mm), Axial Motion: 0.004 in (0.10 mm)*)
  2. Rotate the hubs on the shaft so the drive tenons are located 90° from each other.
  3. Place a torque disk so one groove fits over the drive tenons of a hub and center the disk by hand.
  4. Insert a shim with the thickness of the coupling's axial motion rating into the groove of the torque disk.
  5. Slide the tenons of the second hub into the mating groove in the disk until it touches the shim stock.
  6. Fully tighten the M2.5 screw(s) on each hub to the recommended seating torque of 0.73 Nm using a 2.0 mm hex torque wrench.
  7. Remove the shim stock to leave a small gap between the top of the drive tenons and the torque disk to allow for axial movement.
-