

PART NUMBER	REV	FIRST USED
1385014-1	A	122500-1
1385014-2	A	565435-5
1385014-3	A	354500-1

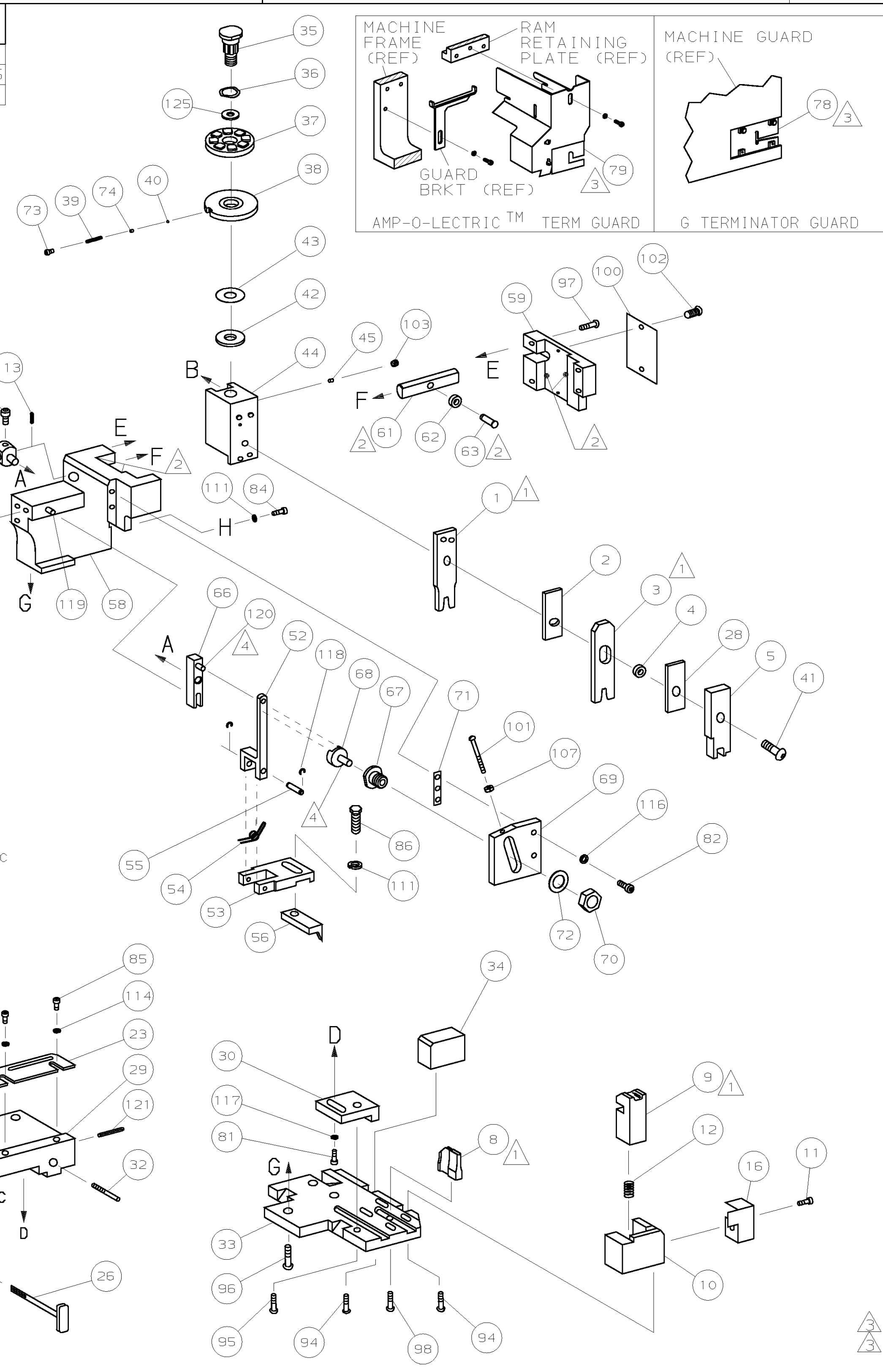

AMP P/N	MFG P/N	CRIMP DATA (NON-AMP TERMINAL-AMP SPEC)		
286845-1	V23540-M5400-Y50	PAD LTR	CRIMP HEIGHT	WIRE SIZE
		A	.039 ±.002 [0.99 ±0.05mm]	20
		B	NOT	USED
		C	NOT	USED
		D	NOT	USED
		CRIMP WIRE	SIZE	TYPE
			.070 [1.78mm]	F
		INSUL	.090 [2.29mm]	0

WIRE STRIP LENGTH	TERM APPL SPEC	FEED	APPL INSTRUCTION	SET UP GAGE	LAYOUT
.156-.172	NONE	.237	408-8040	458637-1	L2325

QTY	REF	PART NO	DESCRIPTION	ITEM NO	
				129	
				128	
				127	
2		5-354779-0	PIN, WIRE DISC (.3240)A	126	
1	1	1	- A 986950-1	WASHER, FLAT PRECISION	125
1	1	1	- A 217238-1	GENERAL INSTRUCTION PACKAGE	124
1	1	1	- 4088040	SF APPL INST 408-8040	123
				122	
1	1	1	- A 4-21028-0	PIN, SLT SPR (φ.093x.75) ST GDE PL	121
REF	REF	REF	- A 1-21030-1	PIN, DOWEL (φ.187x.50) LEVER	120
REF	REF	REF	- A 1-21030-6	PIN, DOWEL (φ.187x1.25) HOUSING	119
REF	REF	REF	- A 21045-3	RING, RET "C" (φ.187) FD FING PIN	118
1	1	1	- A 21024-5	WASHER, LOCK (#10) ADJ BLOCK	117
REF	REF	REF	- A 21024-5	WASHER, LOCK (#10) ADJ PLATE	116
REF	REF	REF	- A 21024-5	WASHER, LOCK (#10) FEED GDE ROD	115
2	2	2	- A 21024-2	WASHER, LOCK (#4) FRONT STP GUIDE	114
REF	REF	REF	- A 5-21028-1	PIN, SLT SPR (φ.125x.50) ADJ ROD	113
				112	
2	2	2	- A 21024-4	WASHER, LOCK (#8) STRIPPER	111
REF	REF	REF	- A 21899-4	WASHER, FLAT (φ5/16) SCREW ADJ	110
				109	
				108	
REF	REF	REF	- A 21068-5	NUT, HEX (6-32) FEED ADJ	107
				106	
				105	
1	1	-	- A 992031-1	PIN, CLEVIS	104
1	1	1	- A 21009-2	SCR, SKT 5ET (1/4-20x.25 LW) RAM	103
2	2	2	- A 21017-2	SCR, DRIVE (#2x.19) ID PLATE	102
REF	REF	REF	- A 6-23715-5	SCR, PAN HD (6-32x1.50) FEED ADJ	101
1	1	1	- B 461264-1	PLATE, IDENTIFICATION	100
2	2	2	- A 3-21002-0	SCR, BHC (10-32x.88) DRAG	99
1	1	1	- A 22733-8	SCR, BHC (8-32x.38 LW) ANVIL	98
REF	REF	REF	- A 2-21002-9	SCR, BHC (10-32x.75) CAP	97
REF	REF	REF	- A 2-22733-8	SCR, BHC (1/4-20x.62) HOUSING	96
REF	REF	REF	- A 2-21002-7	SCR, BHC (10-32x.50) 56 ADJ BLOCK	95
4	4	4	- A 2-21002-2	SCR, BHC (8-32x.50) TERM H DWN	94
				93	
				92	
1	1	1	- A 1-21002-7	SCR, BHC (6-32x.38) CAM	91
				90	
1	1	-	- A 7-21000-9	SCR, SHC (4-40x.19) STRIPPER	89
				88	
				87	
1	1	1	- A 2-22603-0	SCR, HEX HD (8-32x.31) FEED FINGER	86
2	2	2	- A 1-21000-3	SCR, SHC (4-40x.25) F ST GUIDE	85
1	1	1	- A 2-21000-7	SCR, SHC (8-32x.50) STRIPPER	84
REF	REF	REF	- A 3-21000-7	SCR, SHC (10-32x.75) FEED ROD GD	83
REF	REF	REF	- A 3-21000-6	SCR, SHC (10-32x.62) FD ADJ BLK	82
1	1	1	- A 3-21000-4	SCR, SHC (10-32x.38) 56 ADJ BL	81
REF	REF	REF	- A 3-21000-4	SCR, SHC (10-32x.38) PIVOT BLK	80
-	REF	-	- B 455749-1	GUARD, WINDOW	79
REF	-	-	- B 679532-1	INSERT, GUARD	78
				77	
				76	
				75	
1	1	1	- A 690603-1	SPRING, ASSIST	74
1	1	1	- A 23030-1	SCR, SHC (6-32x.25 SL) INS DISC	73
REF	REF	REF	- A 458109-1	WASHER, SPECIAL	72
REF	REF	REF	- A 690517-1	SPACER	71
-3	-2	-1	U/M DWG SIZE	PART NO DESCRIPTION	ITEM NO

QTY	REF	PART NO	DESCRIPTION	ITEM NO	
				18	
				17	
1	1	1	- B 318563-1	GUARD, CHIP, FRONT	16
				15	
				14	
				13	
1	1	1	- A 5-22280-0	SPRING, SHEAR	12
1	1	1	- B 690461-1	STOP, SHEAR	11
1	1	1	- C 690459-1	HOLDER, SHEAR (FRONT)	10
1	1	1	- C 1-454276-9	SHEAR, FLOAT (FRONT)	9
1	1	1	- C 3-662185-3	ANVIL	8
				7	
				6	
1	1	1	- C 1-455889-4	DEPRESSOR, SHEAR (FRONT)	5
1	1	1	- B 2-238011-2	SPACER, BLOCK CRIMPER	4
1	1	1	- C 1-904741-6	CRIMPER, INSULATION	3
1	1	1	- C 455888-4	SPACER, CRIMPER	2
1	1	1	- C 3-456404-5	CRIMPER, WIRE	1
-3	-2	-1	U/M DWG SIZE	PART NO DESCRIPTION	ITEM NO

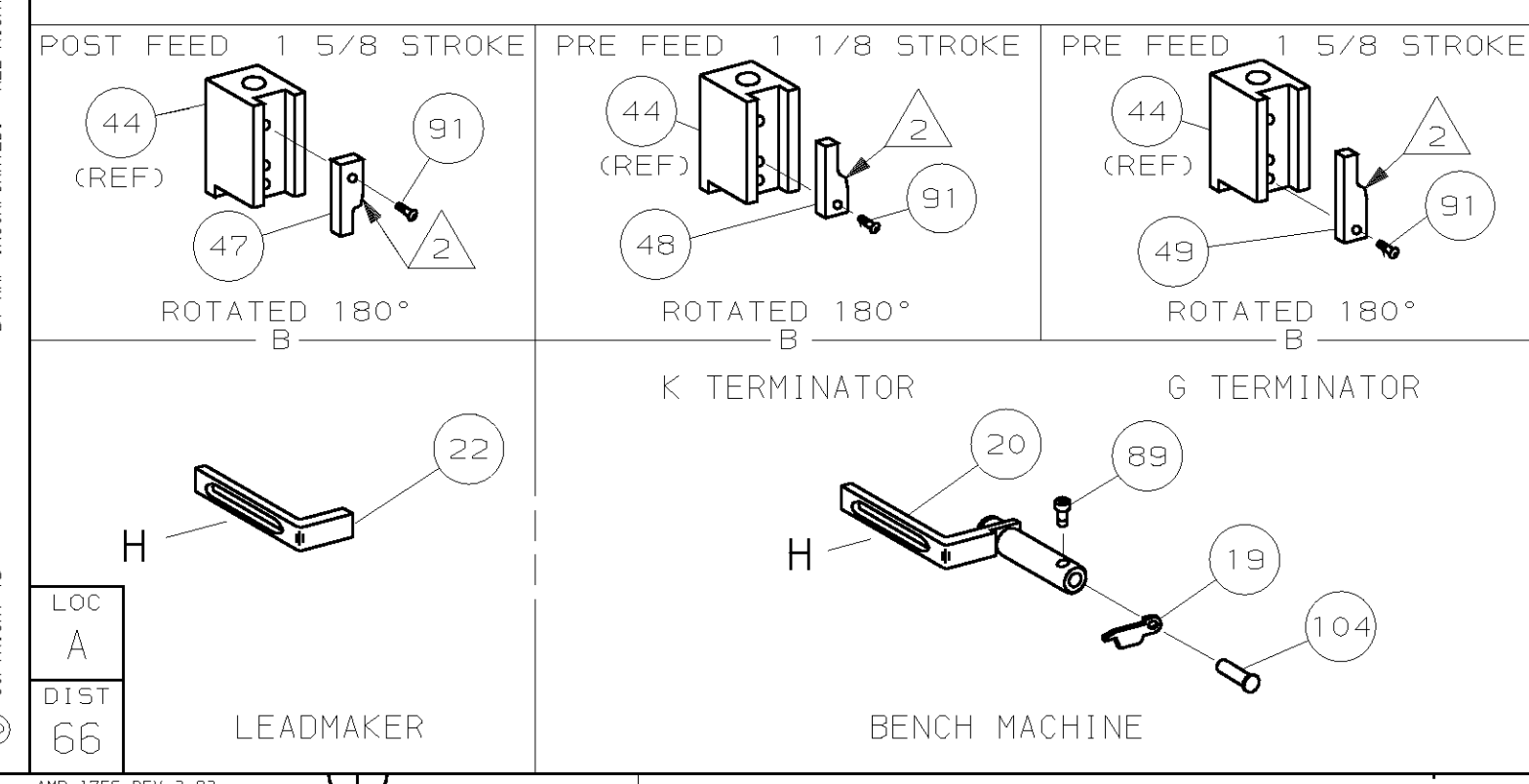

- ① RECOMMENDED SPARE PARTS.
- ② GREASE LIGHTLY.
- ③ GUARD MUST BE IN PLACE WHEN OPERATING APPLICATOR IN A BENCH MACHINE.
- ④ LUBRICATE DAILY USING NO. 20 MACHINE OIL.
- 5. ITEMS WITH QTY OF REF SPECIFIED (EXCEPT ITEMS 78 AND 79) ARE USED ON ITEM 46.

THIS DRAWING IS A CONTROLLED DOCUMENT.

THIS DRAWING IS UNRELEASABLE. RELEASE FOR PUBLICATION BY AMP INCORPORATED. ALL RIGHTS RESERVED. 19 66

1385014

DIMENSIONS IN INCHES. DO NOT SCALE PRINT. TOLERANCES UNLESS OTHERWISE SPECIFIED:	MATL	HT TR	FIN
2 PLC DEC ± - 3 PLC DEC ± - 4 PLC DEC ± -	DR T.K.INT CHK 24JAN00	APP T.ELBIN REL -	AMP Incorporated Harrisburg, PA 17105-3608
ANGLES ± - SURF TEXTURE: ✓ REMOVE BURRS, BREAK SHARP EDGES R.015 MAX	NAME SIDE FEED HDM APPLICATOR		MACHINE REF MINI APPL
CASE CODE 00779	CUSTOMER AND ASSEMBLY DRAWING		SHEET 1 OF 1 REV A1