

SC24M1\* / SC24M1\*REV

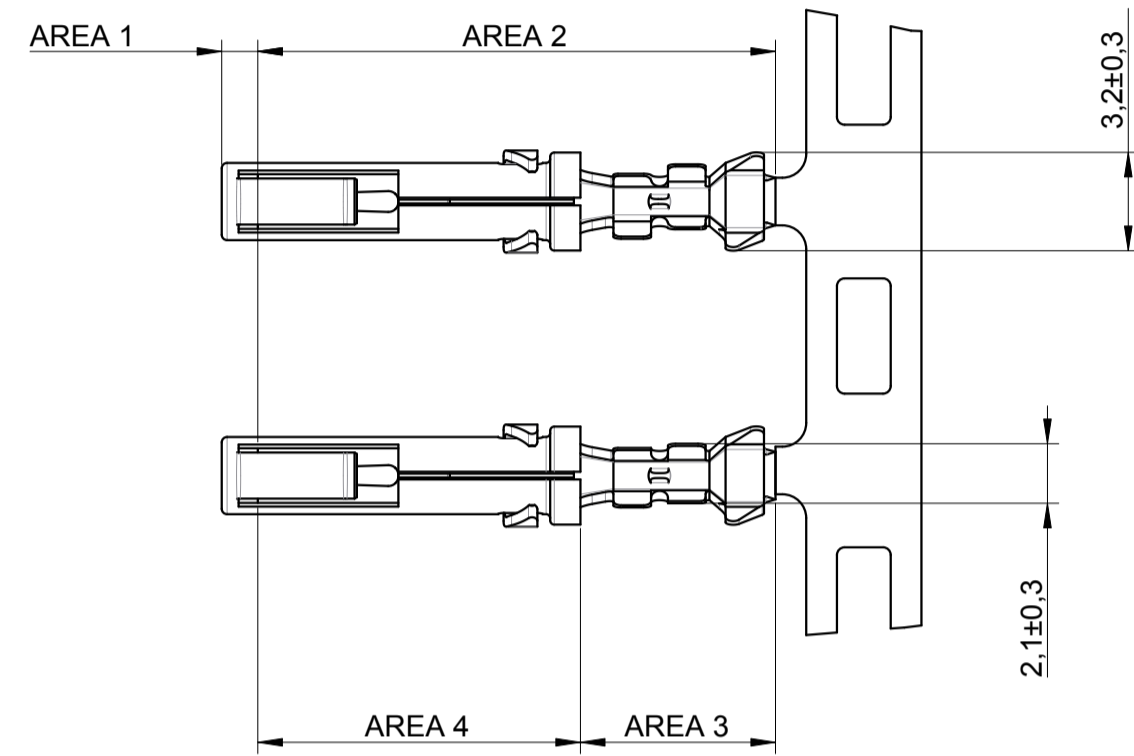

SC20M1\* / SC20M1\*REV

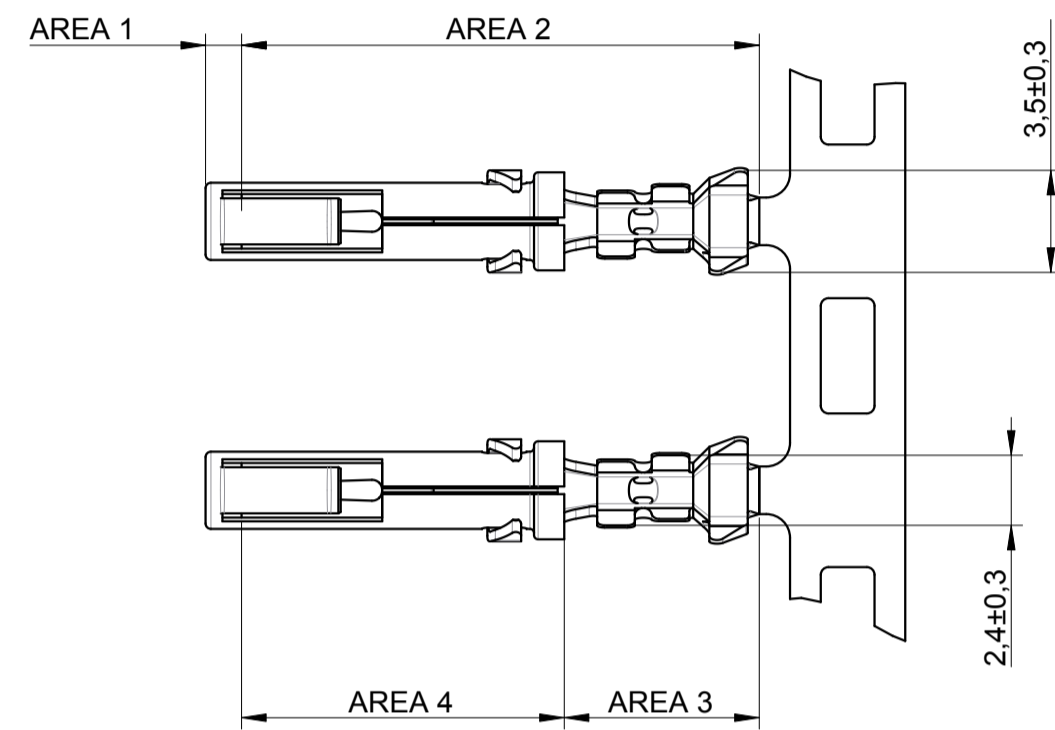

SC16M11\* / SC16M11\*REV

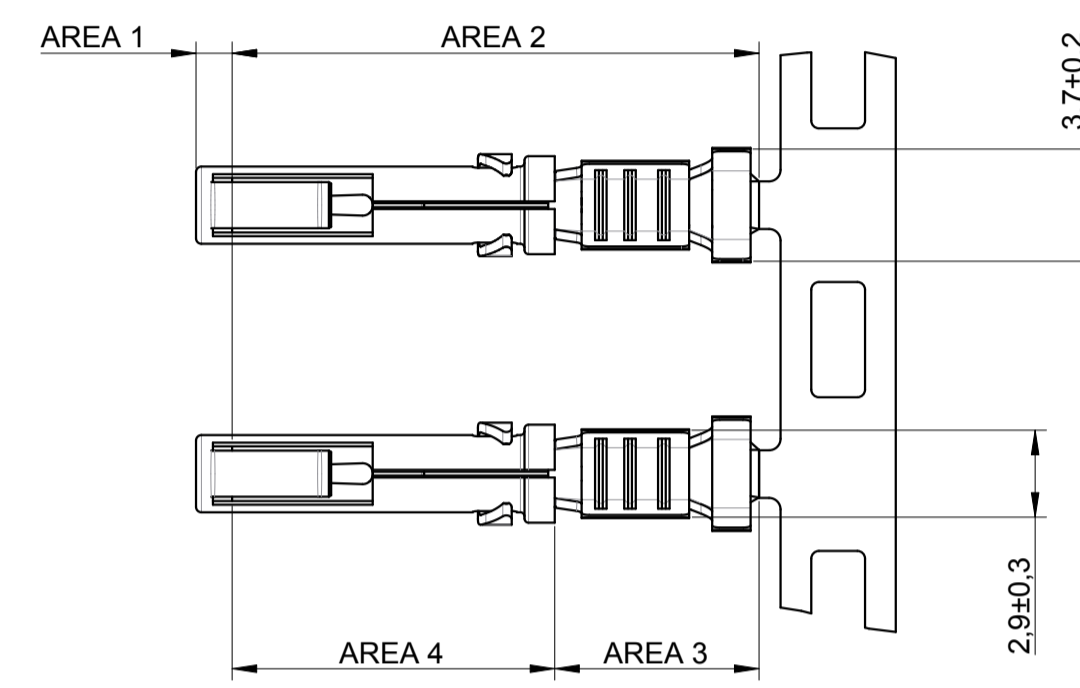

SC16M1\* / SC16M1\*REV

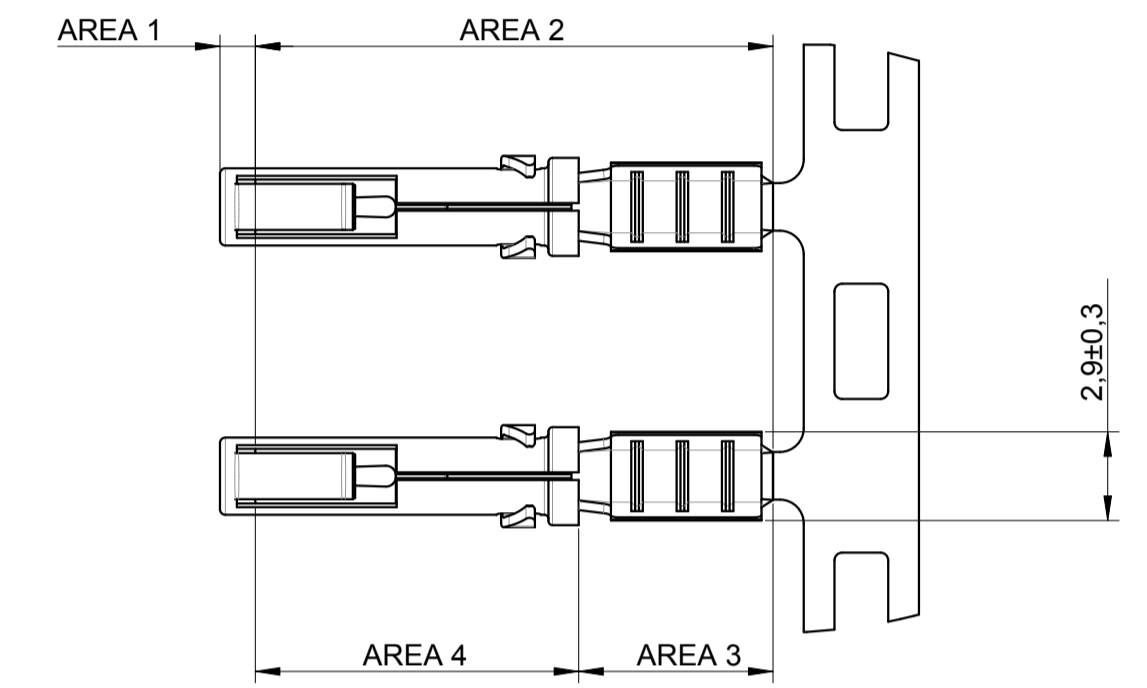

SC14ML1\*

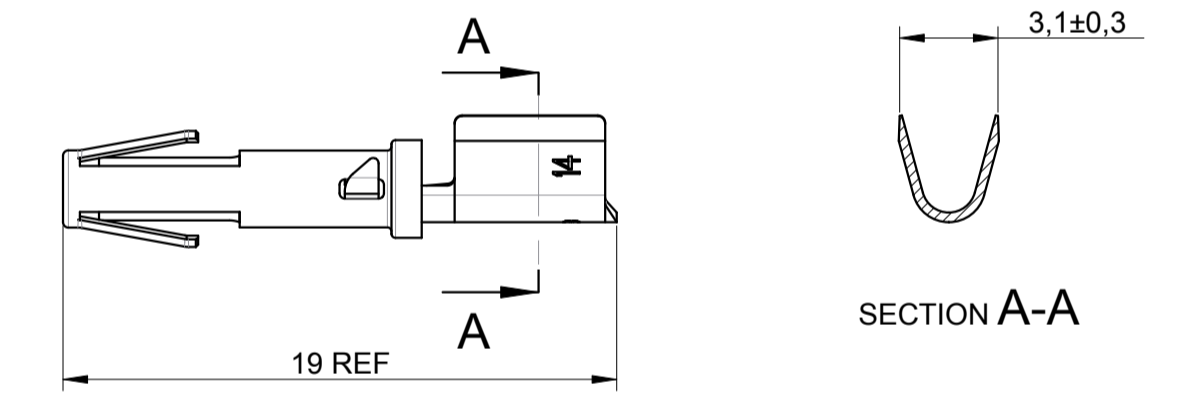

SC14M1\* / SC14M1\*REV

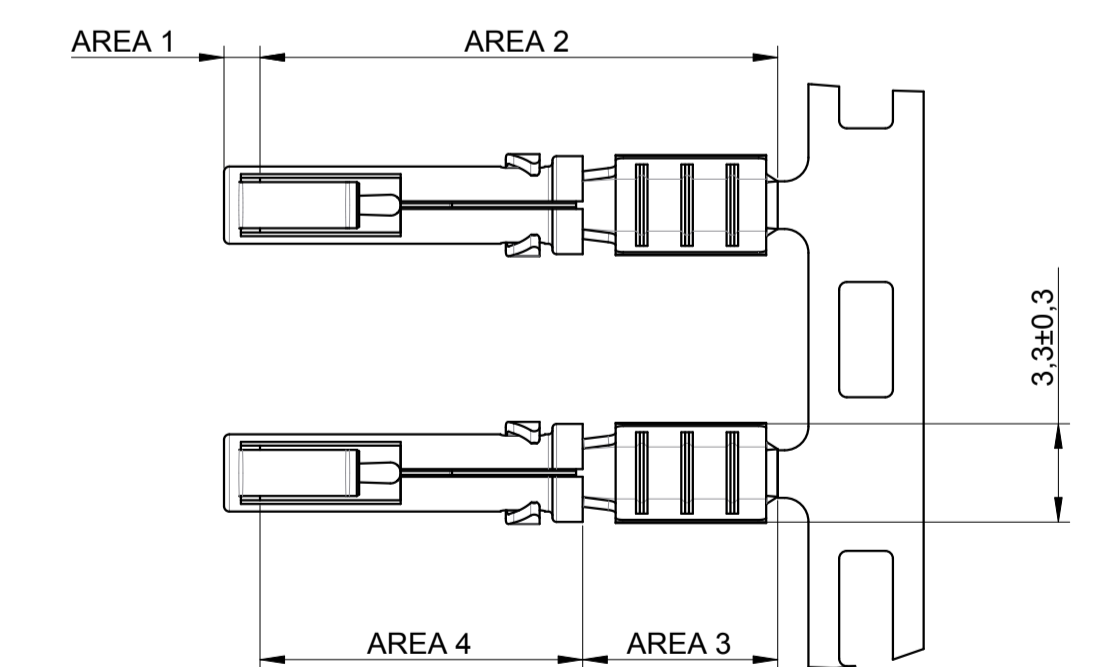

| FEMALE CONTACT CAT. N° | Packaging                    | WIRE SIZE |           | WIRE INSUL. DIAM. IN MM. | WIRE STRIP LENGTH IN MM. | HAND CRIMP TOOLING |                          | EXTRACTION TOOL |
|------------------------|------------------------------|-----------|-----------|--------------------------|--------------------------|--------------------|--------------------------|-----------------|
|                        |                              | AWG       | MM²       |                          |                          | DIE SET            | HANDTOOL FOR LOOSE PIECE |                 |
| SC24ML1*               | Loose contacts in platic bag | 26/24     | 0.12/0.25 | 0.90/1.60                | 4.0                      | S16SCM20           | SHANDLES                 | RX2025GE1       |
| SC24M1* / SC24M1*REV   | Strip contacts on reel       |           |           |                          |                          |                    |                          |                 |
| SC20ML1*               | Loose contacts in platic bag | 22/20     | 0.32/0.50 | 1.20/2.10                | 4.0                      | S16SCM20           | SHANDLES                 |                 |
| SC20M1* / SC20M1*REV   | Strip contacts on reel       |           |           |                          |                          |                    |                          |                 |
| SC16ML11*              | Loose contacts in platic bag | 18/16     | 0.82/1.50 | 3.0 Max                  | 4.65                     | S16SCML11          | SHANDLES                 |                 |
| SC16M11* / SC16M11*REV | Strip contacts on reel       |           |           |                          |                          |                    |                          |                 |
| SC16ML1*               | Loose contacts in platic bag | 18/16     | 0.82/1.50 | 3.2 Max                  | 6.35                     | S16SCML1           | SHANDLES                 |                 |
| SC16M1* / SC16M1*REV   | Strip contacts on reel       |           |           |                          |                          |                    |                          |                 |
| SC14ML1*               | Loose contacts in platic bag | 14        | 2.10/2.50 | 3.2 Max                  | 6.35                     | S16SCML1           | SHANDLES                 |                 |
| SC14M1* / SC14M1*REV   | Strip contacts on reel       |           |           |                          |                          |                    |                          |                 |

**\* PLATING**

|  |                                  |                           |          |
|--|----------------------------------|---------------------------|----------|
| - S6 = 0.75µ GOLD MIN. OVER Ni<br>GOLD FLASH OVER Ni                       | (AREA 1)<br>(AREA 2)             | For standard winding      | See View |
| - D70 = 0.13µ GOLD MIN. OVER Ni<br>GOLD FLASH OVER Ni                      | (AREA 1)<br>(AREA 2)             |                           |          |
| - TK6 = 0.5-2.5µ Sn PRE-PLATED   | (AREA 1+2)                       |                           |          |
| - S18 = 0.75µ GOLD MIN OVER Ni<br>1.3µ MINI Sn OVER Ni<br>1.3µ MINI Ni     | (AREA 1)<br>(AREA 3)<br>(AREA 4) | For standard winding only | See View |
| - S31 = GOLD FLASH OVER Ni<br>1.3µ MINI Sn OVER Ni<br>1.3µ MINI Ni         | (AREA 1)<br>(AREA 3)<br>(AREA 4) |                           |          |
| - D70REV = 0.13µ GOLD MIN. OVER Ni<br>1.3µ MINI Sn OVER Ni<br>1.3µ MINI Ni | (AREA 1)<br>(AREA 3)<br>(AREA 4) | For reverse winding only  |          |

**CONSTRUCTION :**

CONTACT BODY : HIGH CONDUCTIVITY COPPER ALLOY.  
OUTER SPRING : STAINLESS STEEL.  
PACKING CONTACTS ON STANDARD STRIP : 3000 PCS. PER REEL, E.G. SC16M11\*  
PACKING CONTACTS ON REVERSE STRIP : 3000 PCS. PER REEL, E.G. SC16M11\*REV  
FOR WINDING DIRECTION ON REEL (STANDARD OR REVERSE) : SEE BS.C.200178.004  
PACKING LOOSE PIECE CONTACTS : 100 PCS PER STD. PACKING E.G. SC16ML11\*

**CONNECTOR ACCOMMODATION**

THESE CONTACTS CAN BE USED IN ANY CONTACT POSITION IN ANY CONNECTOR IN THE TRIM TRIO INTERCONNECTION SYSTEM : MSM - MSG - MB RECTANGULAR CONN. , SMS QIKMATE CONN. , UTO - UTS - UTL - UTG AND UTP - MBG CIRCULAR CONN.

**PERFORMANCE CHARACTERISTICS**

CURRENT RATING : 13 A CONTACT RETENTION IN BODY : 65 N MIN.  
CONTACT RESISTANCE : <= 6m Ohm INDIVIDUAL INSERTION FORCE : 3.5 N MAX.  
OPERATING VOLTAGE : 750 V RMS INDIVIDUAL WITHDRAWAL FORCE : 0.55 N MIN.

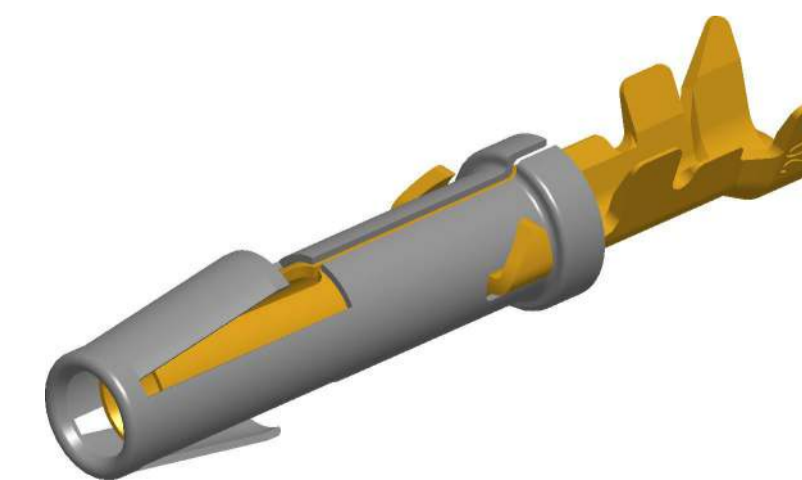

ECHELLE 7/1

SOURIAU shall not be liable for any non-conformity or damage due to a use of the Products which does not comply with the Specifications issued by either of the Parties or by a third party (professional recommendation, technical notice.)

|                                 |             |  |                 |  |
|---------------------------------|-------------|--|-----------------|--|
| B                               | 05/08/2019  | Update of the dimensions for the "U" shape |                 |  |
| ISS                             | DATE        | Update drawing                             |                 | MOD N°   |
| Designed by:                    | COURTOIS L. | Date:                                      | 03/04/2019      | CUSTOMER DRAWING   |
| TITLE                           |             |  |                 |  |
| FEMALE FORMED TWO PIECE CONTACT |             |  |                 |  |
| SC-M--                          |             |  |                 |  |
| Scale                           | 4/1         | Dimensions in mm                           | NPRDS / PROJECT |  |
|                                 |             | General linear                             | TRIM TRIO       |  |
|                                 |             | Tolerances:                                |                 |  |
|                                 |             | ±  |                 |  |
| SOURIAU                         |             | www.esterline-connection-technologies.com  |                 | This document is the property of SOURIAU                     |
| FORMAT                          |             | SOURIAU DRG N°                             |                 | It must not be reproduced or communicated without permission |
| A1                              |             | BS-C-200178-002                            |                 | SHEET  |
|                                 |             |  |                 | 1 / 1  |