

SSS RELAIS 60V/230V 1AAC

Weidmüller Interface GmbH & Co. KG

Klingenbergstraße 16

D-32758 Detmold

Germany

Fon: +49 5231 14-0

Fax: +49 5231 14-292083

www.weidmueller.com



TERMSERIES accessories include:

- Spare relay
- Base
- Partition plates
- Cross-connections
- Power-feed modules

General ordering data

Order No.	4061220000
Type	SSS RELAIS 60V/230V 1AAC
Version	Solid-state relay, Rated control voltage: 52 V DC... 60 V DC... 72 V DC , Rated switching voltage: 24...240 V AC, Rated switching current: 1 A, Plug-in connection
GTIN (EAN)	4032248777624
Qty.	20 pc(s).

SSS RELAIS 60V/230V 1AAC**Weidmüller Interface GmbH & Co. KG**

Klingenbergstraße 16

D-32758 Detmold

Germany

Fon: +49 5231 14-0

Fax: +49 5231 14-292083

www.weidmueller.com

Technical data**Dimensions and weights**

Width	5 mm	Height	28 mm
Depth	15 mm	Weight	3.65 g
Net weight	3.53 g		

Temperatures

Humidity	40 °C / 93 % rel. humidity, no condensation	Operating temperature	-20 °C...+60 °C
Storage temperature	-40 °C...+70 °C		

control side

Rated control voltage	52 V DC...60 V DC...72 V DC	Nominal control current	3 mA DC (±10 %)
Power rating	180 mW		

Load side

Solid-state type	Triac (zero-cross switch)	Rated switching voltage	24...240 V AC
Continuous current	1 A	Rated switching current	1 A
Switch-on delay	< 11 ms	Switch-off delay	< 11 ms
Leakage current	< 10 µA	Voltage drop at max. load	≤ 1 V
Load side status indicator	No	Short-circuit-proof	No

General data

Solid-state type	Triac (zero-cross switch)	No. of poles	1
Wire connection method	Plug-in connection	Humidity	40 °C / 93 % rel. humidity, no condensation

Insulation coordination

Clearance and creepage distances for control side - load side	≥ 5.5 mm	Dielectric strength for control side - load side	3.75 KV _{eff} / 1 min.
---	----------	--	---------------------------------

Connection data

Wire connection method	Plug-in connection
------------------------	--------------------

Classifications

ETIM 3.0	EC001504	UNSPSC	30-21-18-01
eClass 4.1	27-27-09-00	eClass 5.1	27-27-09-90
eClass 6.2	27-37-16-01	eClass 7.1	27-37-16-01

Approvals

Approvals



ROHS

Conform

SSS RELAIS 60V/230V 1AAC**Weidmüller Interface GmbH & Co. KG**

Klingenbergstraße 16

D-32758 Detmold

Germany

Fon: +49 5231 14-0

Fax: +49 5231 14-292083

www.weidmueller.com

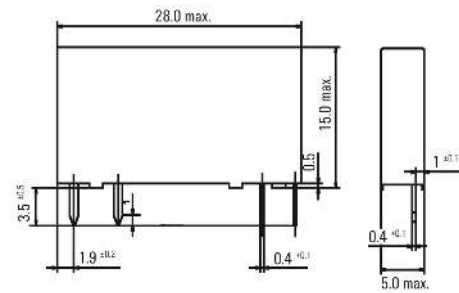
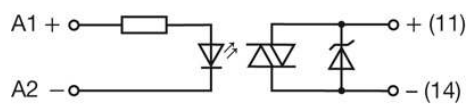
Drawings

SSS RELAIS 60V/230V 1AAC

Weidmüller Interface GmbH & Co. KG

Klingenbergstraße 16

D-32758 Detmold

Germany

Fon: +49 5231 14-0

Fax: +49 5231 14-292083

www.weidmueller.com

Mating connector (fully pluggable)

Tension clamp connection



TERMSERIES accessories include:

- Spare relay
- Base
- Partition plates
- Cross-connections
- Power-feed modules

General ordering data

Order No.	Type	Version	GTIN (EAN)	Qty.
1123440000	TRZ 230VAC RC 1CO EMPTY	TERMSERIES, Relay base, Rated control voltage: 230 V AC $\pm 10\%$, Continuous current: 10 A, Tension clamp connection	4032248905171	10 pc(s).
1123410000	TRZ 120VUC 1CO EMPTY	TERMSERIES, Relay base, Rated control voltage: 120 V UC $\pm 10\%$, Continuous current: 10 A, Tension clamp connection	4032248905690	10 pc(s).
1123430000	TRZ 120VAC RC 1CO EMPTY	TERMSERIES, Relay base, Rated control voltage: 120 V AC $\pm 10\%$, Continuous current: 10 A, Tension clamp connection	4032248905188	10 pc(s).
1123420000	TRZ 230VUC 1CO EMPTY	TERMSERIES, Relay base, Rated control voltage: 230 V UC $\pm 10\%$, Continuous current: 10 A, Tension clamp connection	4032248905683	10 pc(s).
1123400000	TRZ 60VUC 1CO EMPTY	TERMSERIES, Relay base, Rated control voltage: 60 V UC $\pm 10\%$, Continuous current: 10 A, Tension clamp connection	4032248905546	10 pc(s).

SSS RELAIS 60V/230V 1AAC

Weidmüller Interface GmbH & Co. KG

Klingenbergstraße 16

D-32758 Detmold

Germany

Fon: +49 5231 14-0

Fax: +49 5231 14-292083

www.weidmueller.com

Mating connector (fully pluggable)

Screw connection



TERMSERIES accessories include:

- Spare relay
- Base
- Partition plates
- Cross-connections
- Power-feed modules

General ordering data

Order No.	Type	Version	GTIN (EAN)	Qty.
1123300000	TRS 230VUC 1CO EMPTY	TERMSERIES, Relay base, Rated control voltage: 230 V UC ±10%, Continuous current: 10 A, Screw connection	4032248905515	10 pc(s).
1123310000	TRS 120VAC RC 1CO EMPTY	TERMSERIES, Relay base, Rated control voltage: 120 V AC ±10 %, Continuous current: 10 A, Screw connection	4032248905317	10 pc(s).
1123280000	TRS 60VUC 1CO EMPTY	TERMSERIES, Relay base, Rated control voltage: 60 V UC ±10 %, Continuous current: 10 A, Screw connection	4032248905270	10 pc(s).
1123290000	TRS 120VUC 1CO EMPTY	TERMSERIES, Relay base, Rated control voltage: 120 V UC ±10 %, Continuous current: 10 A, Screw connection	4032248905461	10 pc(s).
1123320000	TRS 230VAC RC 1CO EMPTY	TERMSERIES, Relay base, Rated control voltage: 230 V AC ±10 %, Continuous current: 10 A, Screw connection	4032248905522	10 pc(s).