

THIS DRAWING IS UNPUBLISHED. RELEASED FOR PUBLICATION .19  
 BY AMP INCORPORATED. ALL RIGHTS RESERVED.

| LOC | DIST | REVISIONS   |                         |           |      |
|-----|------|-------------|-------------------------|-----------|------|
| P   | LTR  | DESCRIPTION | DATE                    | DWN       | APVD |
| AD  | 39   | H           | REV PER EC 001B-0047-01 | 12 MAR 01 | -    |

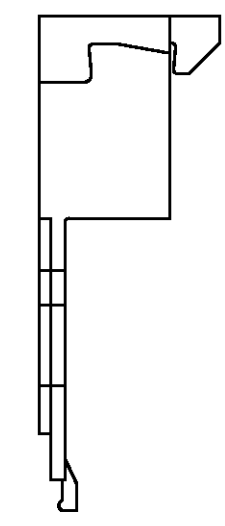
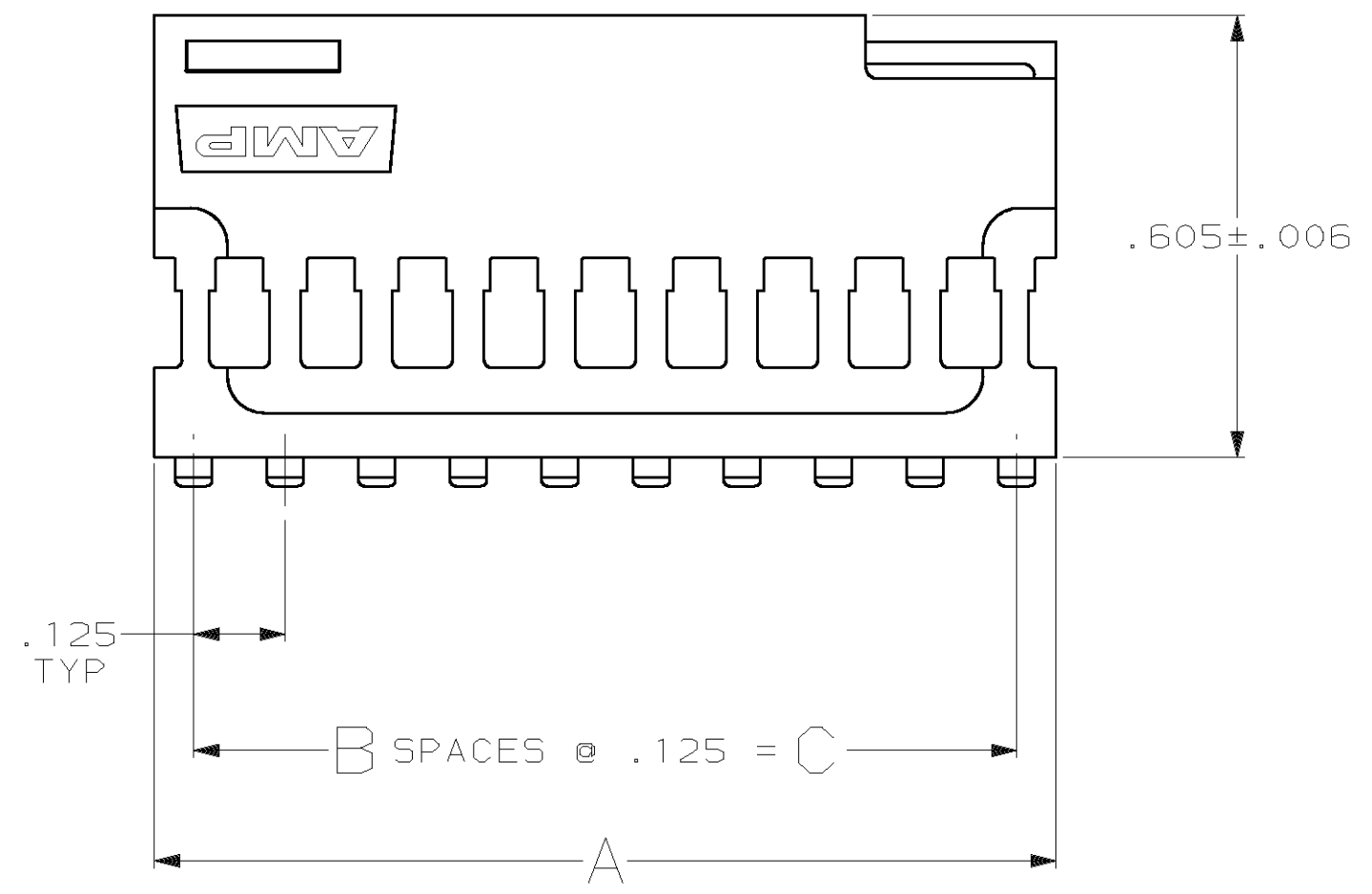
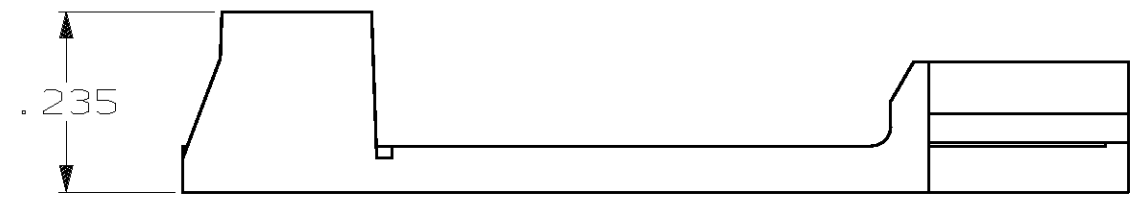

|       |    |       |    |   |   |            |
|-------|----|-------|----|---|---|------------|
| 3.625 | 29 | 3.741 | 60 | 2 | 3 | 2-103056-8 |
| 3.500 | 28 | 3.616 | 58 | 2 | 3 | 2-103056-7 |
| 3.375 | 27 | 3.441 | 56 | 2 | 3 | 2-103056-6 |
| 3.250 | 26 | 3.366 | 54 | 2 | 3 | 2-103056-5 |
| 3.125 | 25 | 3.241 | 52 | 2 | 3 | 2-103056-4 |
| 3.000 | 24 | 3.116 | 50 | 2 | 3 | 2-103056-3 |
| 2.857 | 23 | 2.991 | 48 | 2 | 3 | 2-103056-2 |
| 2.750 | 22 | 2.866 | 46 | 2 | 3 | 2-103056-1 |
| 2.625 | 21 | 2.741 | 44 | 2 | 3 | 2-103056-0 |
| 2.500 | 20 | 2.616 | 42 | 2 | 3 | 1-103056-9 |
| 2.375 | 19 | 2.491 | 40 | 2 | 3 | 1-103056-8 |
| 2.250 | 18 | 2.366 | 38 | 2 | 3 | 1-103056-7 |
| 2.125 | 17 | 2.241 | 36 | 2 | 3 | 1-103056-6 |
| 2.000 | 16 | 2.116 | 34 | 2 | 3 | 1-103056-5 |
| 1.875 | 15 | 1.991 | 32 | 2 | 3 | 1-103056-4 |
| 1.750 | 14 | 1.866 | 30 | 2 | 3 | 1-103056-3 |
| 1.625 | 13 | 1.741 | 28 | 2 | 3 | 1-103056-2 |
| 1.500 | 12 | 1.616 | 26 | 2 | 3 | 1-103056-1 |
| 1.375 | 11 | 1.491 | 24 | 2 | 3 | 1-103056-0 |
| 1.250 | 10 | 1.366 | 22 | 2 | 3 | 103056-9   |
| 1.125 | 9  | 1.241 | 20 | 2 | 3 | 103056-8   |
| 1.000 | 8  | 1.116 | 18 | 2 | 3 | 103056-7   |
| .875  | 7  | .991  | 16 | 2 | 3 | 103056-6   |
| .750  | 6  | .866  | 14 | 2 | 3 | 103056-5   |
| .625  | 5  | .741  | 12 | 2 | 3 | 103056-4   |
| .500  | 4  | .616  | 10 | 2 | 3 | 103056-3   |
| .375  | 3  | .491  | 8  | 2 | 3 | 103056-2   |
| .250  | 2  | .366  | 6  | 2 | 3 | 103056-1   |

- 1 THIS COVER IS TO BE USED WITH A DOUBLE ROW HOUSING. NUMBER OF POSITIONS INDICATED PERTAINS TO THE HOUSING.
- 2 "NON-STANDARD SIZE, MINIMUM ORDER QUANTITY MAY BE REQUIRED".
- 3 OBSOLETE PART NUMBER.

| C                | B | A | NUMBER OF POSN | PART NUMBER |
|------------------|---|---|----------------|-------------|
| COVER DIMENSIONS |   |   | 1              |             |

|  |  |                           |   |           |
|--|--|---------------------------|---|-----------|
| THIS DRAWING IS A CONTROLLED DOCUMENT. |  | DWN<br>D.B.<br>17 JAN 83  | AMP Incorporated<br>Harrisburg, PA 17105-3608 |           |
| DIMENSIONS: INCHES                     |  | CHK<br>J.S.<br>03 FEB 83  | NAME  |           |
| TOLERANCES UNLESS OTHERWISE SPECIFIED: |  | APVD<br>J.S.<br>03 FEB 83 | COVER, LEVEL 5, .125 $\phi$<br>COLOR-BLACK    |           |
| 0 PLC $\pm$                            |  | PRODUCT SPEC              | SIZE  | CAGE CODE |
| 1 PLC $\pm$                            |  | APPLICATION SPEC          | A2  | 00779     |
| 2 PLC $\pm .005$                       |  | WEIGHT                    | C-  | 103056    |
| 3 PLC $\pm$                            |  | CUSTOMER DRAWING          | SCALE   | 4:1       |
| 4 PLC $\pm$                            |  | RESTRICTED TO             | SHEET   | 1 OF 1    |
| ANGLES $\pm$                           |  |                           | REV   | H         |
| FINISH -                               |  |                           |   |           |