

THIS PRODUCT MANUFACTURED WITH LEAD-FREE PROCESSING

DESIGNED & DIMENSIONED IN MILLIMETERS [INCHES]

DO NOT SCALE FROM THIS PRINT

RFX8T-XXXXX-XXXXXX-XXXX

CABLE CALLOUT
B8T: BELDEN 1855A CABLE (CCA-1855A)
C8T: BELDEN 4855R CABLE (CCA-4855R)

OVERALL ASSEMBLY LENGTH (OAL)
XXXX (MILLIMETERS) (0300 MIN)
(SEE NOTE 8)

END 1 CONNECTOR
(SEE TABLE 3, SHT 2)

END 2 CONNECTOR OR PREPARATION
(SEE TABLE 3, SHT 2)

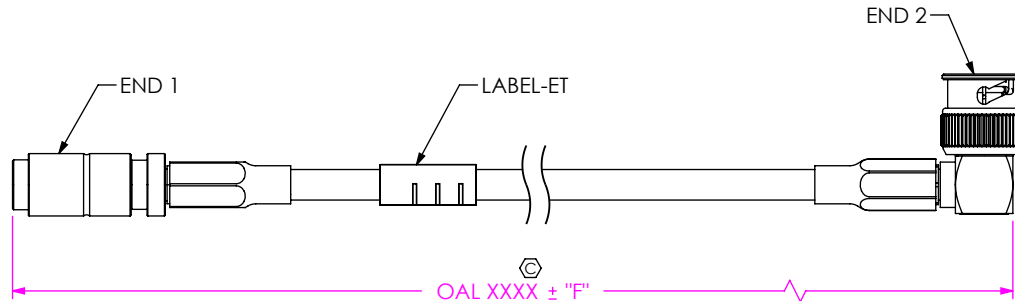

FIG 1
RF8T-78SPX-79RPX-XXXX SHOWN

TABLE 2: FINAL ASSEMBLY LENGTH TOLERANCE	
LENGTH	"F"
0300-0500 [11.81-19.69]	+5.0 [.20]/-0.0 [.00]
0501-1100 [19.72-43.30]	+10.0 [.40]/-0.0 [.00]
> 1100 [43.30]	± 1%

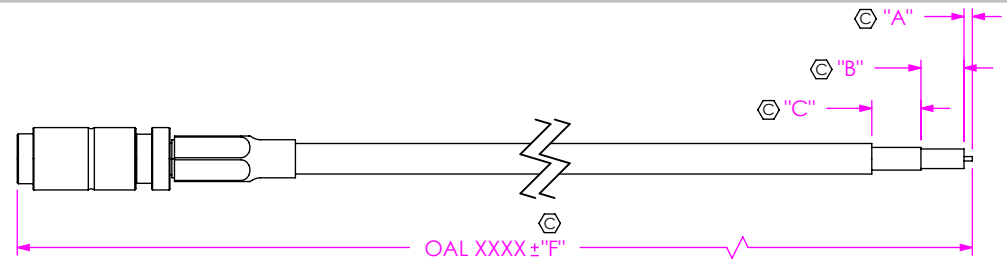

FIG 2
RF8T-78SPX-172849-XXXX SHOWN (SEE NOTES 5 & 7)

"C" FORMAT: X.X mm
"B" FORMAT: X.X mm
"A" FORMAT: X.X mm

DO NOT LEAVE ANY SPACE BLANK,
EACH MUST CONTAIN A
NUMERIC CHARACTER 0 THRU 9.

NOTES:

1. C REPRESENTS A CRITICAL DIMENSION
2. ASSEMBLY TO BE 100% TESTED FOR OPENS, SHORTS & HI-POT TESTED (PER TABLE 1, AC OR DC), THE HI-POT VOLTAGE FOR THE ASSEMBLY SHOULD BE SET TO THE END OPTION WITH THE LOWEST TEST VOLTAGE RATING.
3. AFTER FINAL ELECTRICAL TEST, LABEL EACH CABLE ASSEMBLY WITH 1 LABEL-ET.
4. FINISHED ASSEMBLIES TO BE PACKAGED PER PACKAGING STANDARD CO-RF-WI-3040-M. ASSEMBLIES WITH LOCKWASHERS, NUTS, AND GASKETS TO BE SHIPPED KITTED AS ONE ASSEMBLY PER BAG, UNASSEMBLED.
5. DIM "A", "B", AND "C" HAVE A MINIMUM VALUE OF 0.0mm & A MAXIMUM VALUE OF 9.9mm.
6. CONNECTORS TO BE ORIENTED ACCORDING TO CO-RF-WI-3048-M.
7. FOR STRIPPED AND TINNED OPTION, ONLY THE CENTER CONDUCTOR IS TINNED.
8. CABLE LENGTHS LONGER THAN 1000 MILLIMETERS ARE NOT SUPPORTED BY S.I. TEST DATA.

c:\enterprise\vauf\DWG\MISC\MKTG\RFX8T-XXXXX-XXXXXX-XXXX-MKT.SLDRW

UNLESS OTHERWISE SPECIFIED,
DIMENSIONS ARE IN
MILLIMETERS [INCHES].
TOLERANCES ARE:
DECIMALS ANGLES
.X: ±0.3 [.01] 2°
.XX: ±0.13 [.005]
.XXX: ±0.051 [.0020]

PROPRIETARY NOTE
THIS DOCUMENT CONTAINS CONFIDENTIAL AND PROPRIETARY INFORMATION AND ALL DESIGN, MANUFACTURING, REPRODUCTION, USE, PATENT RIGHTS AND SALES RIGHTS ARE EXPRESSLY RESERVED BY SAMTEC, INC. THIS DOCUMENT SHALL NOT BE DISCLOSED, IN WHOLE OR PART, TO ANY UNAUTHORIZED PERSON OR ENTITY NOR REPRODUCED, TRANSFERRED OR INCORPORATED IN ANY OTHER PRODUCT IN ANY MANNER WITHOUT THE EXPRESS WRITTEN CONSENT OF SAMTEC, INC.

MATERIAL: DO NOT SCALE DRAWING SHEET SCALE: 2:1

DIELECTRIC: PTFE
GASKET: SILICONE
SPRING: STAINLESS STEEL
ALL OTHER: BRASS



520 PARK EAST BLVD., NEW ALBANY, IN 47150
PHONE: 812-944-6733 FAX: 812-948-5047
e-Mail info@SAMTEC.com code 55322

DESCRIPTION:
TRUE 75 OHM, RF8T CABLE ASSEMBLY
DWG. NO.
RFX8T-XXXXX-XXXXXX-XXXX
BYJ. BROWNING 05/13/2010 SHEET 1 OF 6

TABLE 3

END OPTION	SERIES	GENDER	CONFIGURATION	PLATING			FIGURE
				CENTER CONTACT	OUTER CONTACT	OTHER COMPONENTS	
-78SP4	75 OHM DIN 1.0/2.3	PLUG	STRAIGHT	10µ" GOLD	3µ" GOLD	100µ" NICKEL	SHT 3, FIG 3
-78SP5	75 OHM DIN 1.0/2.3	PLUG	STRAIGHT	10µ" GOLD	10µ" GOLD	100µ" NICKEL	
-78SP6	75 OHM DIN 1.0/2.3	PLUG	STRAIGHT	30µ" GOLD	30µ" GOLD	100µ" NICKEL	
-78SP8	75 OHM DIN 1.0/2.3	PLUG	STRAIGHT	30µ" GOLD	3µ" GOLD	100µ" NICKEL	
** -79SP2	75 OHM MINI BNC	PLUG	STRAIGHT	30µ" GOLD	100µ" NICKEL	100µ" NICKEL	SHT 3, FIG 4
** -79SP3	75 OHM MINI BNC	PLUG	STRAIGHT	10µ" GOLD	100µ" NICKEL	100µ" NICKEL	
** -79RP2	75 OHM MINI BNC	PLUG	RIGHT ANGLE	30µ" GOLD	100µ" NICKEL	100µ" NICKEL	SHT 4, FIG 5
** -79RP3	75 OHM MINI BNC	PLUG	RIGHT ANGLE	10µ" GOLD	100µ" NICKEL	100µ" NICKEL	
-H4SP2	75 OHM HIGH DENSITY BNC	PLUG	STRAIGHT	30µ" GOLD	100µ" NICKEL	100µ" NICKEL	SHT 4, FIG 6
-H4SP3	75 OHM HIGH DENSITY BNC	PLUG	STRAIGHT	10µ" GOLD	100µ" NICKEL	100µ" NICKEL	
-H4SP4	75 OHM HIGH DENSITY BNC	PLUG	STRAIGHT	10µ" GOLD	3µ" GOLD	100µ" NICKEL	
-H4SP8	75 OHM HIGH DENSITY BNC	PLUG	STRAIGHT	30µ" GOLD	3µ" GOLD	100µ" NICKEL	
*-SING	SINGLE ENDED	-	-	-	-	-	-
*-XXXXX	STRIPPED & TINNED	-	-	-	-	-	SHT 1, FIG 2

* = END 2 OPTION ONLY

** = FOR EXISTING CUSTOMERS ONLY

TABLE 1

END OPTION	SUBTRACTOR	STRIP DIMENSIONS			HI POT	
		"Y"	"A"	"D"	"E"	"DC"
-78SP4	15.7 [0.62]	2.6 [0.10]	5.0 [0.20]	12.3 [0.48]	1000	300
-78SP5						
-78SP6						
-78SP8						
** -79SP2	8.6 [0.34]	2.5 [0.10]	4.9 [0.19]	10.7 [0.42]	1000	300
** -79SP3						
** -79RP2	5.3 [0.21]	1.1 [0.04]	6.8 [0.27]	13.3 [0.52]	1000	300
** -79RP3						
-H4SP2	13.3 [0.52]	2.6 [0.10]	4.4 [0.17]	11.2 [0.44]	1000	300
-H4SP3						
-H4SP4						
-H4SP8						
*-SING	0.0 [0.00]	-	-	-	1000	N/A
*-XXXXX	0.0 [0.00]	"A"	"A" + "B"	"A" + "B" + "C"	1000	N/A

* = END 2 OPTION ONLY

** = FOR EXISTING CUSTOMERS ONLY

PROPRIETARY NOTE
 THIS DOCUMENT CONTAINS CONFIDENTIAL AND PROPRIETARY INFORMATION AND ALL DESIGN, MANUFACTURING, REPRODUCTION, USE, PATENT RIGHTS AND SALES RIGHTS ARE EXPRESSLY RESERVED BY SAMTEC, INC. THIS DOCUMENT SHALL NOT BE DISCLOSED, IN WHOLE OR PART, TO ANY UNAUTHORIZED PERSON OR ENTITY NOR REPRODUCED, TRANSFERRED OR INCORPORATED IN ANY OTHER PROJECT IN ANY MANNER WITHOUT THE EXPRESS WRITTEN CONSENT OF SAMTEC, INC.



520 PARK EAST BLVD, NEW ALBANY, IN 47150
 PHONE: 812-944-6733 FAX: 812-948-5047
 e-Mail: info@SAMTEC.com code 55322

DO NOT SCALE DRAWING

SHEET SCALE: 2:1

DESCRIPTION:
 TRUE 75 OHM, RF8T CABLE ASSEMBLY

DWG. NO.
RFX8T-XXXXX-XXXXXX-XXXX

BY: J. BROWNING 05/13/2010 SHEET 2 OF 6

FIG 3
-78SPX SHOWN

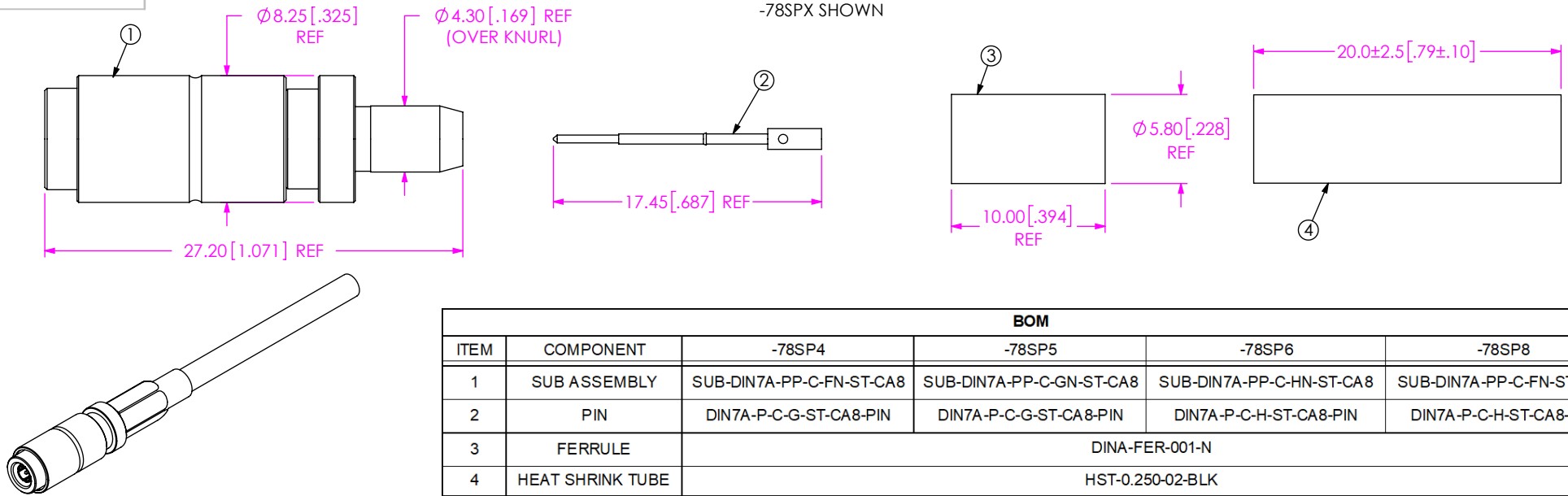
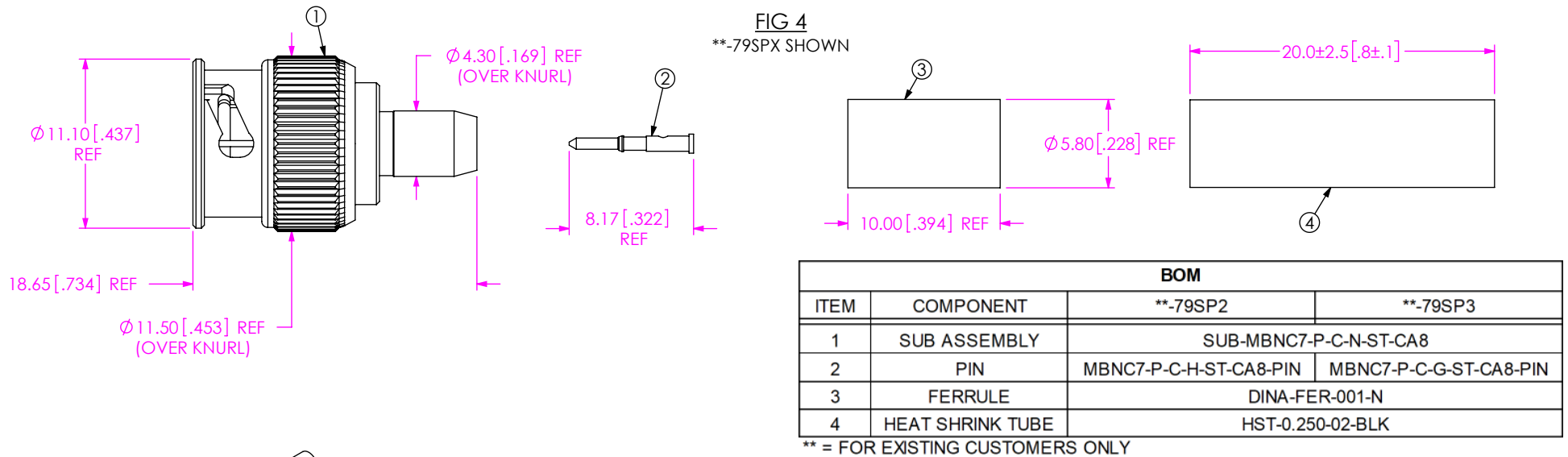

FIG 4
**-79SPX SHOWN



PROPRIETARY NOTE
THIS DOCUMENT CONTAINS CONFIDENTIAL AND PROPRIETARY INFORMATION AND ALL DESIGN, MANUFACTURING, REPRODUCTION, USE, PATENT RIGHTS AND SALES RIGHTS ARE EXPRESSLY RESERVED BY SAMTEC, INC. THIS DOCUMENT SHALL NOT BE DISCLOSED, IN WHOLE OR PART, TO ANY UNAUTHORIZED PERSON OR ENTITY NOR REPRODUCED, TRANSFERRED OR INCORPORATED IN ANY OTHER PROJECT IN ANY MANNER WITHOUT THE EXPRESS WRITTEN CONSENT OF SAMTEC, INC.



520 PARK EAST BLVD. NEW ALBANY, IN 47150
PHONE: 812-944-6733 FAX: 812-948-5047
e-Mail info@SAMTEC.com code 55322

DO NOT SCALE DRAWING

SHEET SCALE: 2.5:1

DESCRIPTION:
TRUE 75 OHM, RF8T CABLE ASSEMBLY

DWG. NO.
RFX8T-XXXXXX-XXXXXX-XXXX

BY: J. BROWNING 05/13/2010 SHEET 3 OF 6

FIG 5
**-79RPX SHOWN

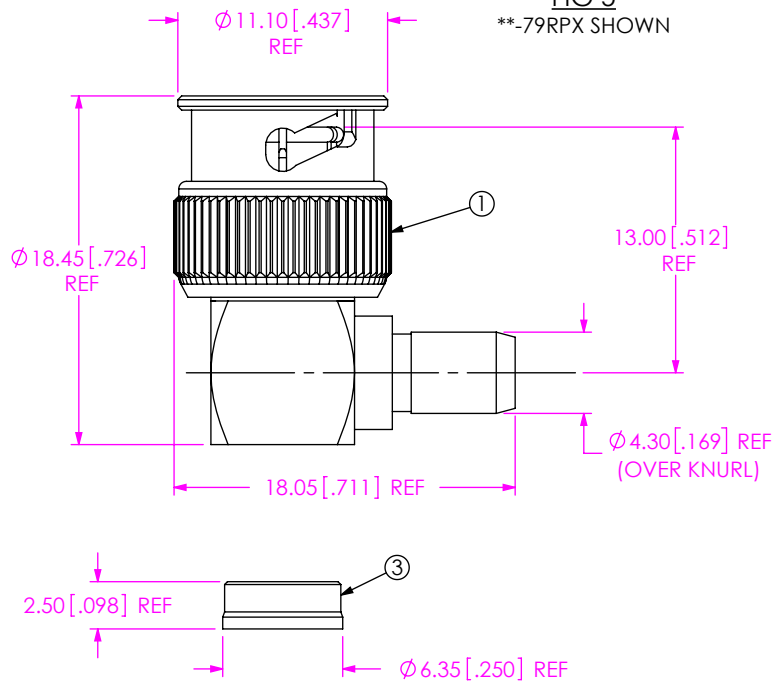

BOM			
ITEM	COMPONENT	** -79RP2	** -79RP3
1	SUB ASSEMBLY	SUB-MBNC7-P-C-HN-RA-CA8	SUB-MBNC7-P-C-GN-RA-CA8
2	FERRULE	DINA-FER-001-N	
3	CAP	MBNC7-P-C-N-RA-CAP	
4	HEAT SHRINK TUBE	HST-0.250-02-BLK	

** = FOR EXISTING CUSTOMERS ONLY

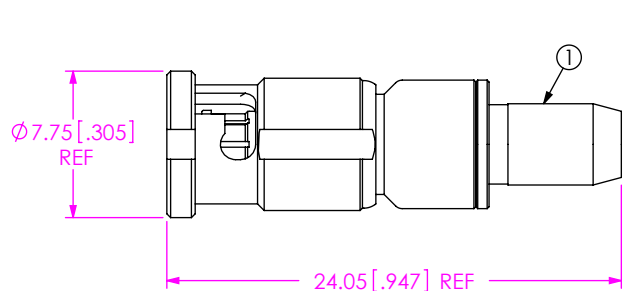
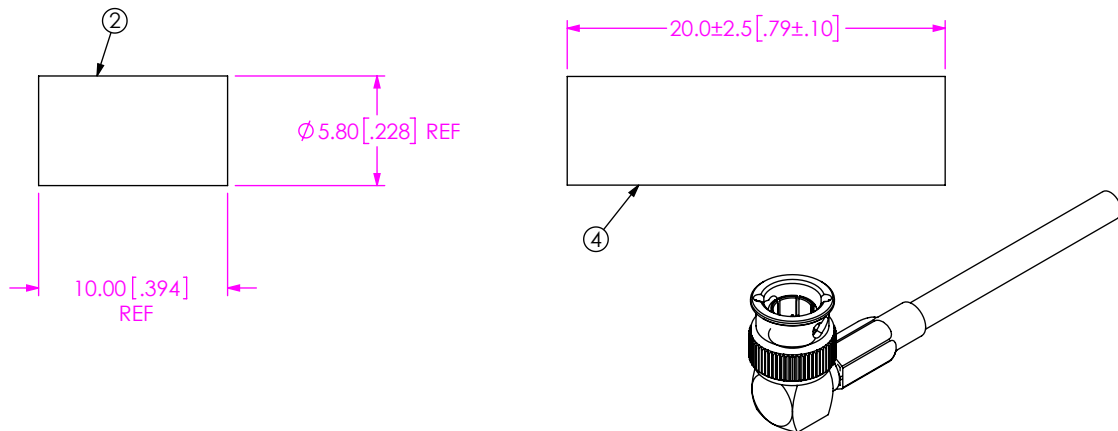
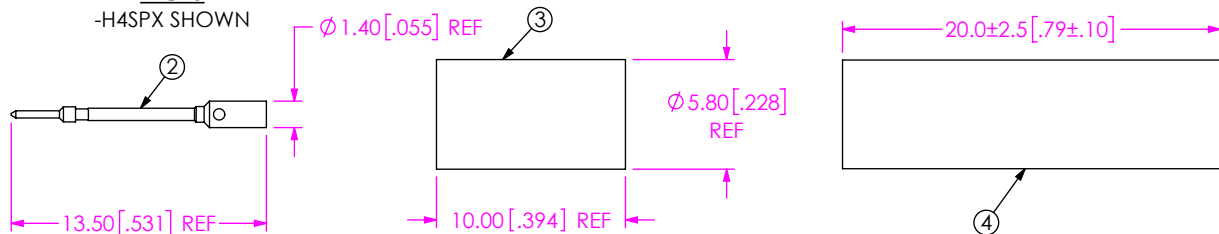
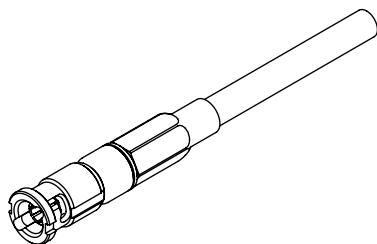

FIG 6
-H4SPX SHOWN



BOM					
ITEM	COMPONENT	-H4SP2	-H4SP3	-H4SP4	-H4SP8
1	SUB ASSEMBLY	SUB-HDBNC-P-C-NN-ST-CA8	SUB-HDBNC-P-C-NN-ST-CA8	SUB-HDBNC-P-C-FN-ST-CA8	SUB-HDBNC-P-C-FN-ST-CA8
2	PIN	HDBNC-P-C-H-ST-CA8-PIN	HDBNC-P-C-G-ST-CA8-PIN	HDBNC-P-C-G-ST-CA8-PIN	HDBNC-P-C-H-ST-CA8-PIN-X
3	FERRULE	DINA-FER-001-N			
4	HEAT SHRINK TUBE	HST-0.250-02-BLK			



PROPRIETARY NOTE
THIS DOCUMENT CONTAINS CONFIDENTIAL AND PROPRIETARY INFORMATION AND ALL DESIGN, MANUFACTURING, REPRODUCTION, USE, PATENT RIGHTS AND SALES RIGHTS ARE EXPRESSLY RESERVED BY SAMTEC, INC. THIS DOCUMENT SHALL NOT BE DISCLOSED, IN WHOLE OR PART, TO ANY UNAUTHORIZED PERSON OR ENTITY NOR REPRODUCED, TRANSFERRED OR INCORPORATED IN ANY OTHER PROJECT IN ANY MANNER WITHOUT THE EXPRESS WRITTEN CONSENT OF SAMTEC, INC.

samtec
520 PARK EAST BLVD, NEW ALBANY, IN 47150
PHONE: 812-944-6733 FAX: 812-948-5047
e-Mail info@SAMTEC.com code 55322

DO NOT SCALE DRAWING
SHEET SCALE: 2.5:1

DESCRIPTION:
TRUE 75 OHM, RF8T CABLE ASSEMBLY
DWG. NO.
RFX8T-XXXXX-XXXXXX-XXXX
BY: J. BROWNING 05/13/2010 SHEET 4 OF 6

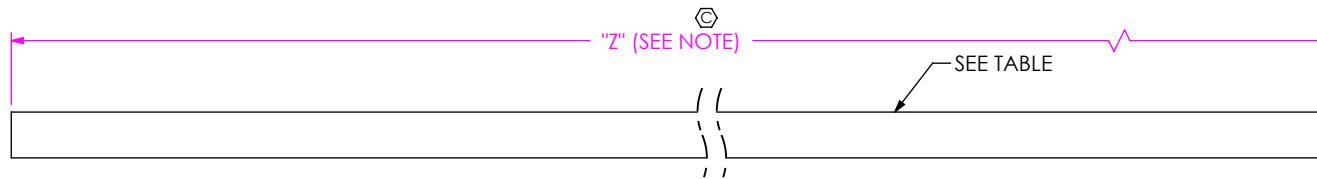
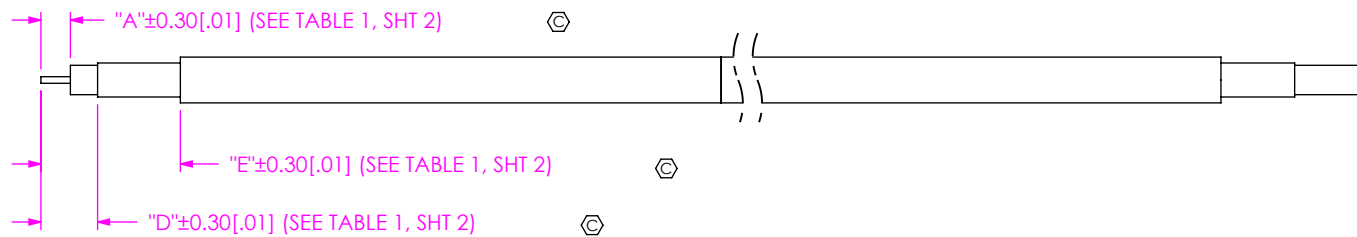

TABLE	
CABLE CALLOUT	PART NUMBER
RFB8T	CCA-1855A
RFC8T	CCA-4855R

NOTE: "Z" = 2*OAL - 2*"Y"(END 1) (FOR -SING OR -XXXXX OPTIONS)
 "Z" = OAL - "Y"(END 1) - "Y"(END 2) (FOR DOUBLE ENDED OPTIONS)

IN PROCESS 1
 CUT CABLE TO LENGTH



IN PROCESS 2
 STRIP AND TIN INNER CONDUCTOR

STRAIGHT
 IN PROCESS 3
 ADD FERRULE & HEAT SHRINK TUBE,
 SOLDER SIGNAL PIN
 OR CRIMP (IF APPLICABLE)

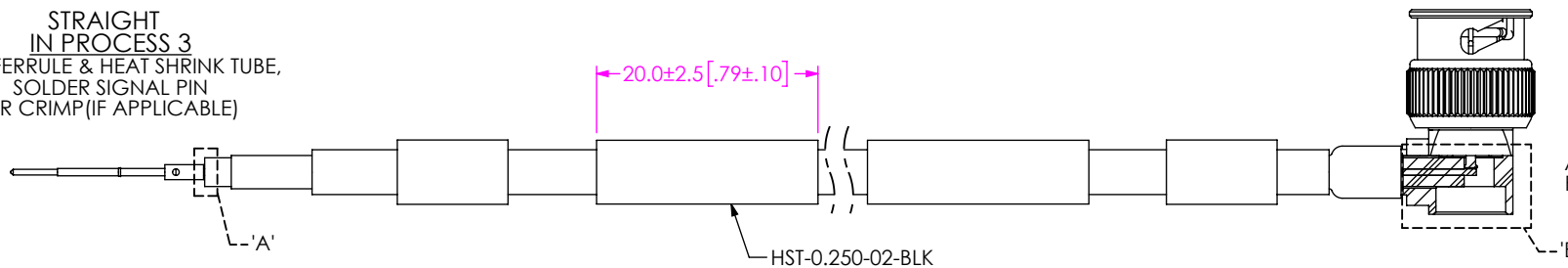

RIGHT ANGLE
 IN PROCESS 3
 ADD FERRULE & HEAT SHRINK TUBE,
 FLARE SHIELD, ADD SUB ASSEMBLY,
 AND SOLDER SIGNAL PIN
 (SEE NOTE 6)

STRAIGHT
 IN PROCESS 4
 FLARE SHIELD,
 ADD SUB ASSEMBLY
 (SEE NOTE 6)

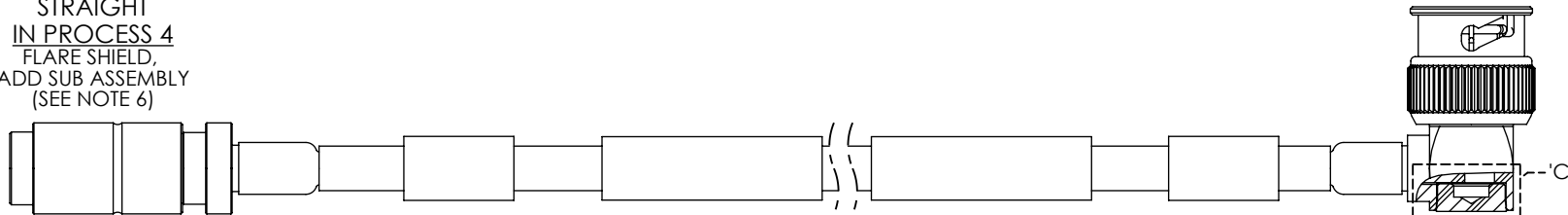

RIGHT ANGLE
 IN-PROCESS 4
 INSERT CAP

0.10[.004] MAX

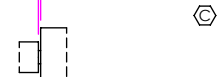

DETAIL 'A'
 SCALE 3 : 1

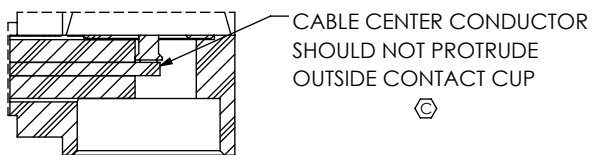

DETAIL 'B'
 SCALE 3 : 1

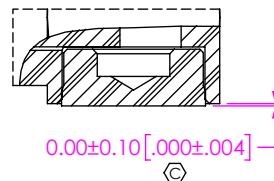

DETAIL 'C'
 SCALE 3 : 1

PROPRIETARY NOTE
 THIS DOCUMENT CONTAINS CONFIDENTIAL AND
 PROPRIETARY INFORMATION AND ALL DESIGN,
 MANUFACTURING, REPRODUCTION, USE, PATENT RIGHTS
 AND SALES RIGHTS ARE EXPRESSLY RESERVED BY SAMTEC,
 INC. THIS DOCUMENT SHALL NOT BE DISCLOSED, IN WHOLE
 OR PART, TO ANY UNAUTHORIZED PERSON OR ENTITY NOR
 REPRODUCED, TRANSFERRED OR INCORPORATED IN ANY
 OTHER PROJECT IN ANY MANNER WITHOUT THE EXPRESS
 WRITTEN CONSENT OF SAMTEC, INC.

DO NOT SCALE DRAWING
 SHEET SCALE: 1.5:1



520 PARK EAST BLVD, NEW ALBANY, IN 47150
 PHONE: 812-944-6733 FAX: 812-948-5047
 e-Mail info@SAMTEC.com code 55322

DESCRIPTION:
 TRUE 75 OHM, RF8T CABLE ASSEMBLY
 DWG. NO.
 RFX8T-XXXXX-XXXXXX-XXXX
 BY: J. BROWNING 05/13/2010 SHEET 5 OF 6

STRAIGHT
IN-PROCESS 5
CRIMP FERRULE

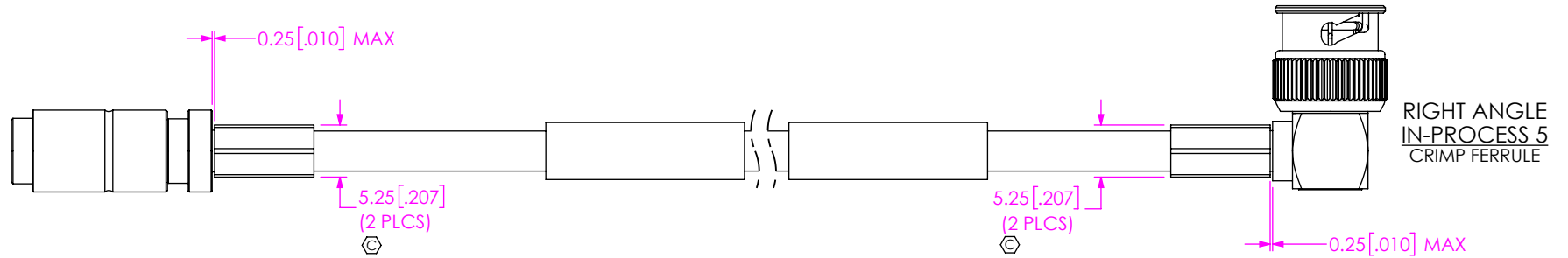

RIGHT ANGLE
IN-PROCESS 5
CRIMP FERRULE

STRAIGHT
IN PROCESS 6
ACTIVATE HEAT SHRINK

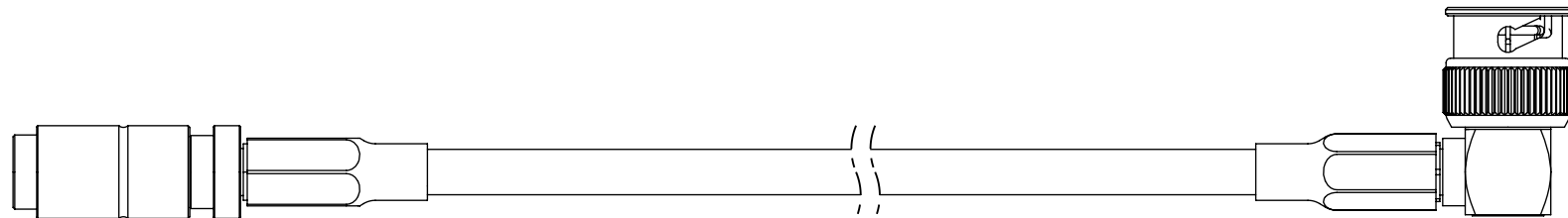

RIGHT ANGLE
IN-PROCESS 6
ACTIVATE HEAT SHRINK

c:\enterprisevault\DWG\MISC\MKTG\RF8T-XXXX-XXXX-XXXX-MKT.SLDDRW

PROPRIETARY NOTE
THIS DOCUMENT CONTAINS CONFIDENTIAL AND PROPRIETARY INFORMATION AND ALL DESIGN, MANUFACTURING, REPRODUCTION, USE, PATENT RIGHTS AND SALES RIGHTS ARE EXPRESSLY RESERVED BY SAMTEC, INC. THIS DOCUMENT SHALL NOT BE DISCLOSED, IN WHOLE OR PART, TO ANY UNAUTHORIZED PERSON OR ENTITY NOR REPRODUCED, TRANSFERRED OR INCORPORATED IN ANY OTHER PROJECT IN ANY MANNER WITHOUT THE EXPRESS WRITTEN CONSENT OF SAMTEC, INC.



520 PARK EAST BLVD, NEW ALBANY, IN 47150
PHONE: 812-944-6733 FAX: 812-948-5047
e-Mail info@SAMTEC.com code 55322

DO NOT SCALE DRAWING

SHEET SCALE: 1.5:1

DESCRIPTION:
TRUE 75 OHM, RF8T CABLE ASSEMBLY

DWG. NO.
RF8T-XXXX-XXXX-XXXX

BY: J. BROWNING 05/13/2010 SHEET 6 OF 6