

SST41 Series 40A TRIACs

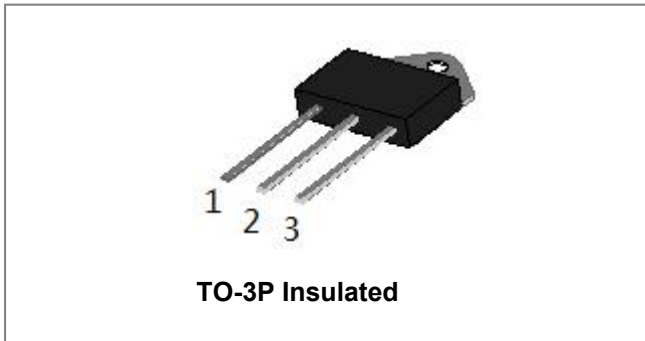

Circuit Diagram

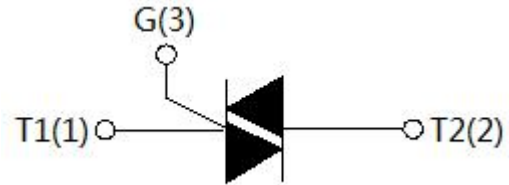

Description

With high ability to withstand the shock loading of large current, SST41 series triacs provide high dv/dt rate with strong resistance to electromagnetic interference. With high commutation performances, 3 quadrant products especially recommended for use on inductive load. From all three terminals to external heatsink, SST41Z provides a rated insulation voltage of 2500 V_{RMS}.

Maximum Ratings:

Characteristics	Symbol	Condition	Max.	Units
Storage junction temperature range	T _J	-	-40 to +125	°C
Operating junction temperature range	T _{stg}	-	-40 to +150	°C
Repetitive peak off-state voltage	V _{DRM}	-	600/800/1200/1600	V
Repetitive peak reverse voltage	V _{RRM}	-	600/800/1200/1600	V
Non repetitive peak off-state voltage	V _{DSM}	-	V _{DRM} + 100	V
Non repetitive peak reverse voltage	V _{RSM}	-	V _{RRM} + 100	V
RMS on-state current	I _(TRMS)	TO-3P(Ins)(T _C =80°C)	40	A
Non repetitive surge peak on-state current (full cycle, F=50Hz)	I _{TSM}	-	400	A
I ² t value for fusing (tp=10ms)	I ² t	-	880	A ² s
Critical rate of rise of on-state current (I _G = 2 × I _{GT})	di/dt	-	50	A/us
Peak gate current	I _{GM}	-	4	A
Average gate power dissipation	P _{GM}	-	1	W
Peak gate power	P _{G(AV)}	-	10	W

Electrical Characteristics (T_j=25°C unless otherwise specified)

3 Quadrants

Symbol	Test Condition	Quadrant		Value	Unit
I _{GT}	V _D = 12V R _L = 33Ω	I - II - III	MAX	50	mA
V _{GT}		I - II - III	MAX	1.3	V
V _{GD}	V _D = V _{DRM} T _j = 125°C R _L = 3.3KΩ	I - II - III	MIN	0.2	V
I _L	I _G = 1.2I _{GT}	I - III	MAX	80	mA
		II		100	
I _H	I _T = 100mA		MAX	60	mA
dV/dt	V _D = 2/3V _{DRM} Gate Open T _j = 125°C		MIN	1500	V/μs

4 Quadrants

Symbol	Test Condition	Quadrant		Value	Unit
I _{GT}	V _D = 12V R _L = 33Ω	I - II - III	MAX	50	mA
		IV		70	
V _{GT}		ALL	MAX	1.3	V
V _{GD}	V _D = V _{DRM} T _j = 125°C, R _L = 3.3KΩ	ALL	MIN	0.2	V
I _L	I _G = 1.2I _{GT}	I - III - IV	MAX	90	mA
		II		100	
I _H	I _T = 100mA		MAX	80	mA
dV/dt	V _D = 2/3V _{DRM} Gate Open T _j = 125°C		MIN	1000	V/μs

Static Characteristics

Symbol	Condition	Max.	Units
V _{TM}	I _T = 60A t _p = 380μs, T _j = 25°C	1.5	V
I _{DRM}	V _D = V _{DRM} V _R = V _{RRM} , T _j = 25°C	10	μA
I _{RRM}	V _D = V _{DRM} V _R = V _{RRM} , T _j = 125°C	5	mA

Thermal Resistances

Symbol	Condition		Value	Units
R _{th(j-c)}	Junction to case(AC)	TO-3P(Ins)	1.1	°C/W

Ordering Information

<p>S ST 41 Z -600 BW</p> <p>SMC Diode Solutions — S</p> <p>Triacs — ST</p> <p>$I_{T(RMS)}:40A$ — 41</p> <p>Z:TO-3P(Ins) — Z</p>	<p>-600 BW</p> <p>BW: $I_{GT1-3} \leq 50mA$</p> <p>B: $I_{GT1-3} \leq 50mA$ $I_{GT4} \leq 70mA$</p> <p>600: $V_{DRM}/V_{RRM} \geq 600V$</p> <p>800: $V_{DRM}/V_{RRM} \geq 800V$</p> <p>1200: $V_{DRM}/V_{RRM} \geq 1200V$</p> <p>1600: $V_{DRM}/V_{RRM} \geq 1600V$</p>
---	---

Device	Package	Shipping
SST41Z-600B/SST41Z-800B SST41Z-600BW/SST41Z-800BW SST41Z-1200BW/SST41Z-1600BW	TO-3P	30pcs/ Tube

Marking Diagram

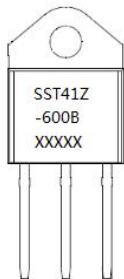

Where XXXXX is YYWWL

SST41Z-600B = Part name
YY = Year
WW = Week
L = Lot Number

Mechanical Dimensions TO-3P

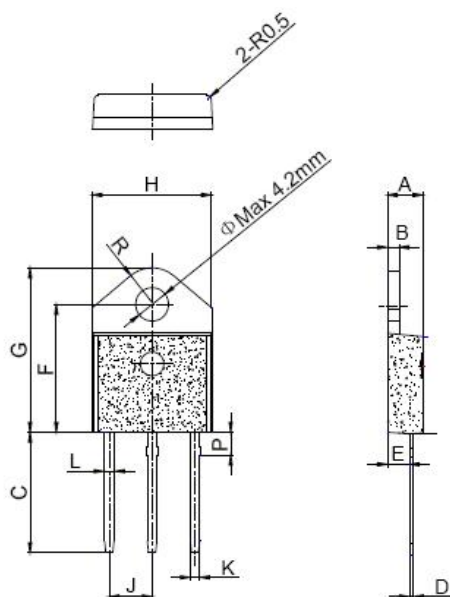

SYMBOL	Millimeters			Inches		
	Min.	Typ.	Max.	Min.	Typ.	Max.
A	4.40		4.60	0.173		0.181
B	1.45		1.55	0.057		0.061
C	14.35		15.60	0.565		0.614
D	0.50		0.70	0.020		0.028
E	2.70		2.90	0.106		0.114
F	15.80		16.50	0.622		0.650
G	20.40		21.10	0.803		0.831
H	15.10		15.50	0.594		0.610
J	5.40		5.65	0.213		0.222
K	1.10		1.40	0.043		0.055
L	1.35		1.50	0.053		0.059
P	2.80		3.00	0.110		0.118
R		4.35			0.171	

Ratings and Characteristics Curves

FIG.1 Maximum power dissipation versus RMS on-state current

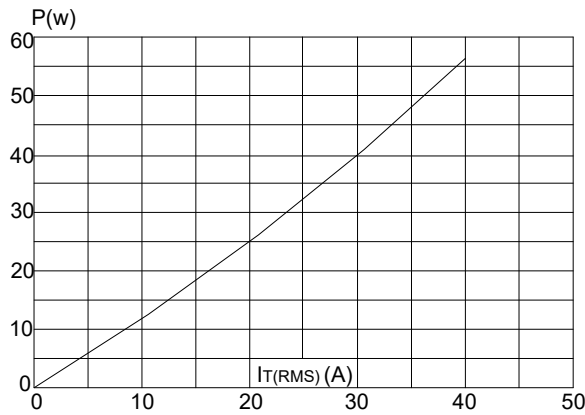

FIG.2: RMS on-state current versus case temperature

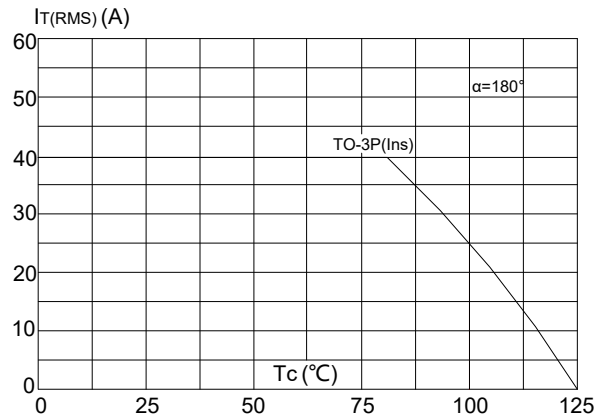

FIG.3: Surge peak on-state current versus number of cycles

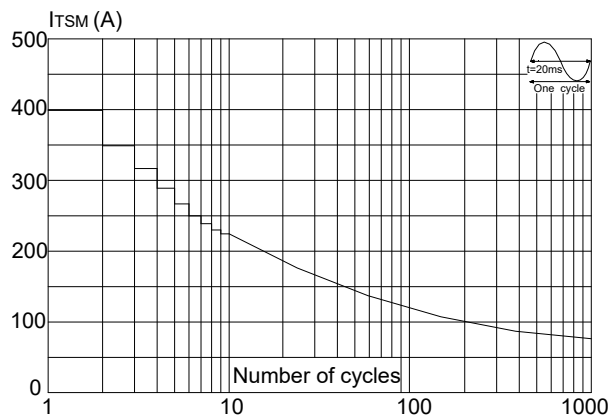

FIG.4: On-state characteristics (maximum values)

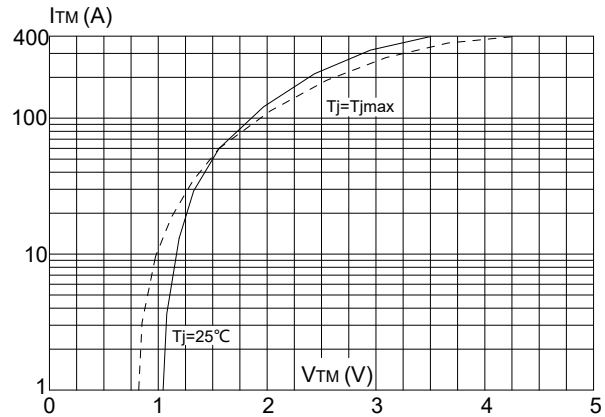

FIG.5: Non-repetitive surge peak on-state current for a sinusoidal pulse with width $t_p < 20ms$, and corresponding value of $I^2 t$ ($di/dt < 50A/\mu s$)

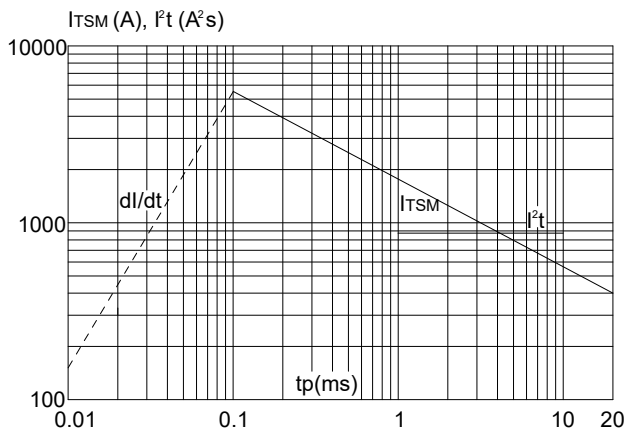
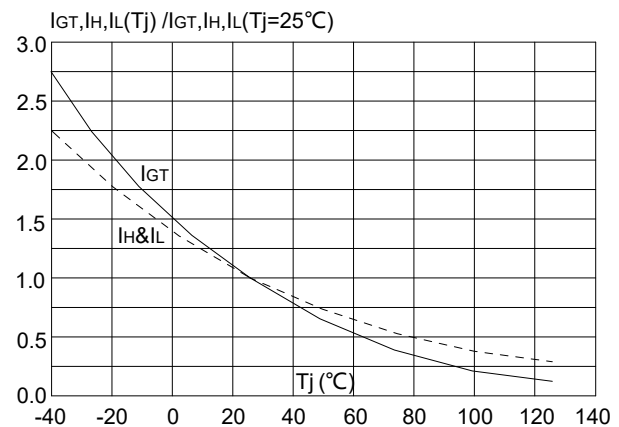

FIG.6: Relative variations of gate trigger current, holding current and latching current versus junction temperature



Technical Data
Data Sheet N2034, Rev.-



DISCLAIMER:

- 1- The information given herein, including the specifications and dimensions, is subject to change without prior notice to improve product characteristics. Before ordering, purchasers are advised to contact the SMC Diode Solutions sales department for the latest version of the datasheet(s).
- 2- In cases where extremely high reliability is required (such as use in nuclear power control, aerospace and aviation, traffic equipment, medical equipment, and safety equipment), safety should be ensured by using semiconductor devices that feature assured safety or by means of users' fail-safe precautions or other arrangement.
- 3- In no event shall SMC Diode Solutions be liable for any damages that may result from an accident or any other cause during operation of the user's units according to the datasheet(s). SMC Diode Solution assumes no responsibility for any intellectual property claims or any other problems that may result from applications of information, products or circuits described in the datasheets.
- 4- In no event shall SMC Diode Solutions be liable for any failure in a semiconductor device or any secondary damage resulting from use at a value exceeding the absolute maximum rating.
- 5- No license is granted by the datasheet(s) under any patents or other rights of any third party or SMC Diode Solutions.
- 6- The datasheet(s) may not be reproduced or duplicated, in any form, in whole or part, without the expressed written permission of SMC Diode Solutions.
- 7- The products (technologies) described in the datasheet(s) are not to be provided to any party whose purpose in their application will hinder maintenance of international peace and safety nor are they to be applied to that purpose by their direct purchasers or any third party. When exporting these products (technologies), the necessary procedures are to be taken in accordance with related laws and regulations..