

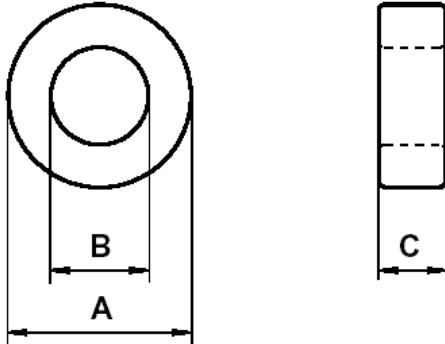

Specification for:
ZW43813TC

110 Delta Drive
Pittsburgh, PA 15238
Phone: 412/696-1333
Fax: 412/696-0333
Email:magnetics@spang.com

DIMENSIONS



(mm)	Uncoated Nominal:	Coated Min:	Coated Max:
O.D. (A)	38.1	37.07	39.63
I.D. (B)	19	17.52	19.98
Ht. (C)	12.6	12.53	13.47

Eff. Parameters		
A _e mm ²	l _e mm	V _e mm ³
116	82.8	9576

INDUCTANCE

AL value (nH/T ²)	Test conditions
16700 ± 30%	10 kHz, 0.5 mT (For N = 5, use 0.41 mA), 25°C

ELECTRICAL LOSSES

tan δ / μ _i	Production lot limit Average	Test conditions	
≤ 4.1 · 10 ⁻⁶	≤ 3.5 · 10 ⁻⁶	10 kHz	0.5 mT, 25°C
≤ 60 · 10 ⁻⁶	≤ 50 · 10 ⁻⁶	100 kHz	

COATING

Epoxy rated for 200°C continuous operation.
Voltage breakdown rating 2,000 V Min Wire-to-Wire.

NOTE

Spec. Modifications	Previous	Revised
2005.12.16	Bare Nom HT = 12.7 Breakdown voltage > 1,000 V LF: General W material	Bare Nom HT = 12.6 Breakdown voltage > 2,000 V LF: Detail as indicated