

ALL DIMENSIONS ARE REFERENCE ONLY.

PART NO.		<b>RFT-1202-B-WB</b>		
REV	DESCRIPTION	DWN	DATE	APPROVED
-	ENGINEERING RELEASE	JDM	7/9/14	J. BENZ

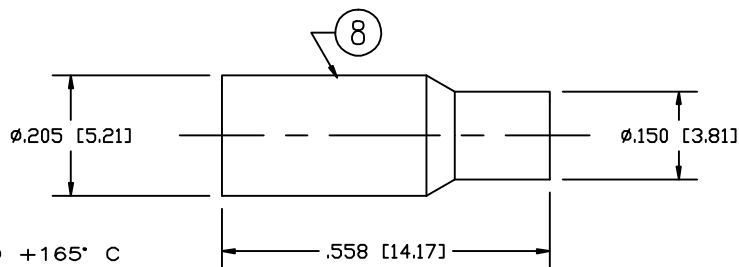
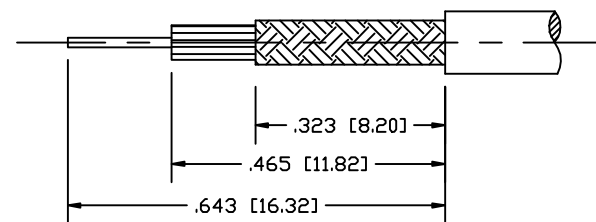
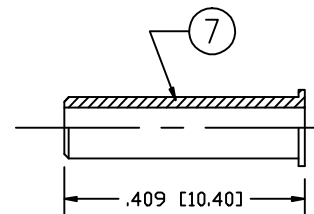
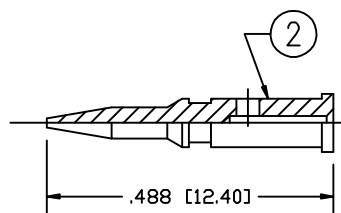
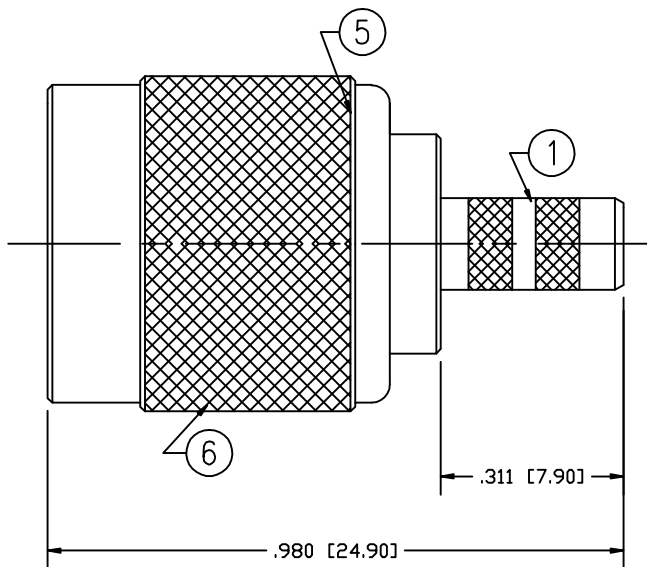

**SPECIFICATIONS:**

IMPEDANCE: 50 OHMS  
 TEMPERATURE RANGE: -65° C TO +165° C  
 WORKING VOLTAGE: 500 VRMS @ SEA LEVEL  
 FREQUENCY RANGE: 0-7 GHz  
 INSERTION LOSS: <math><- .2\text{dB}</math> @ 3 GHz  
 VSWR MAX: 1.3:1 @ 3 GHz

SUGGESTED STRIPPING INSTRUCTIONS

SUGGESTED CRIMP DIES .068 / .130 / .178

NOTE: ITEM 7 IS PLACED OVER CABLE INSULATION BEFORE PIN IS SOLDERED/CRIMPED.

1	BODY	1	BRASS	W. BRNZ, 100Micro
2	PIN	1	BRASS	GOLD, 30 Micro
3	INSULATOR	1	PTFE	----
4	GASKET	1	RUBBER	----
5	GRND RING	1	BRASS	W. BRNZ, 100Micro
6	COUPLING NUT	1	BRASS	W. BRNZ, 100Micro
7	INSERT	1	BRASS	W. BRNZ, 100Micro
8	FERRULE	1	BRASS	W. BRNZ, 100Micro
9	SPLIT LOCK WASH	1	BRASS	W. BRNZ, 100Micro
10				
11				
12				
13				
14				
#	DESCRIPTION	QTY	MATRL.	FINISH

DRAWN	D. McREYNOLDS	7/9/14
CHECKED		
ORJ DRAWN	JDMc	12/7/00
APPROVALS		DATE

UNLESS OTHERWISE SPECIFIED:  
 1. REMOVE ALL BURRS  
 2. BREAK ALL CORNERS & EDGES .005 R. MAX.  
 3. CHAMFER 1ST & LAST THREADS 45°  
 4. SURFACE ROUGHNESS 63 FINISH MIL-STD-10  
 5. DIAMETERS ON COMMON CENTERS TO BE CONCENTRIC WITHIN .002 T.I.R.  
 6. ALL DIMENSIONS ARE AFTER PLATING.

DIMENSIONS ARE IN INCHES AND [MILLIMETERS]	
UNLESS OTHERWISE NOTED TOLERANCES ARE:	
DECIMALS	DIAMETER
.XXX±.003 [.08]	.XXX±.001 [.03]
.XX±.005 [.13]	.XX±.003 [.08]

**RFconnectors**  
 DIVISION OF RF INDUSTRIES, LTD.  
 7610 MIRAMAR RD  
 SAN DIEGO, CA 92126  
 (858)549-6340  
 (858)549-6345 FAX

**TNC PLUG**

CRIMP, (FOR RG-174, RG-188, RG-316/U)

SIZE	CABLE GROUP	DWG NO.	REV
A	B	RFT-1202-B-WB	-
SCALE: NTS		CAD FILE OUTLINE	SHEET 1 OF 1