

PART NO 91364-0002
 DWG. NO. SD-91364-002

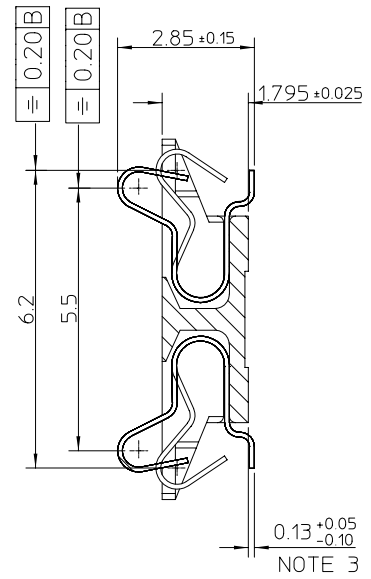
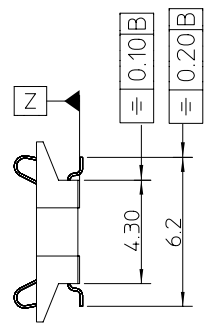
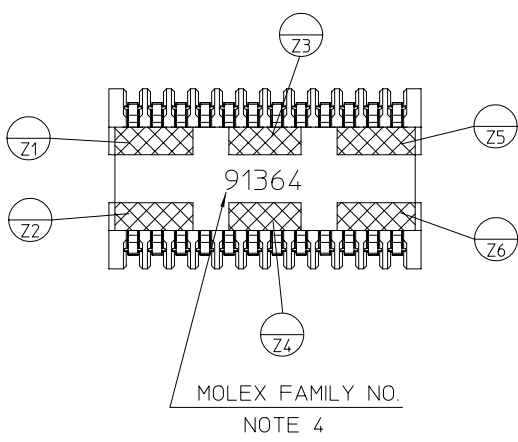
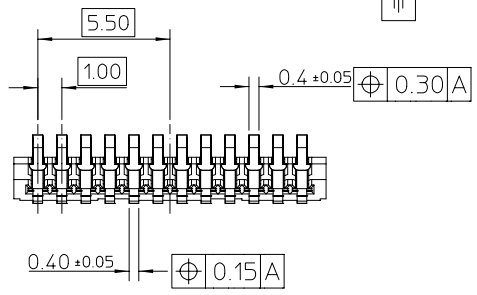
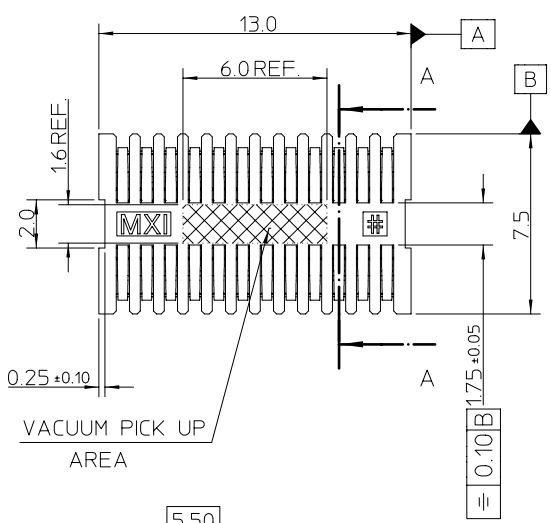

A-A
SCALE 10:1

NOTES:

- MATERIALS:
HOUSING: NYLON 46, 45% GLASS FILL. COLOUR BLACK
CONTACT: BERYLLIUM COPPER 0.10 REF THK.
- PLATING: 1.27um MIN NICKEL UNDERCOAT OVERALL
CONTACT AREA: 0.25um Au MIN OVER NICKEL UNDERCOAT
SMT TAIL AREA: 0.10-0.20um Au OVER NICKEL UNDERCOAT
- ALL SMT TAILS ARE TO LIE WITHIN A 0.10 TOLERANCE BAND FROM EACH OTHER
- MOLEX FAMILY NUMBER AND CAVITY I.D. (MXI #)
TEXT CHARACTER SIZE TO BE 0.8 HIGH. TEXT TO BE RECESSED INTO HOUSING IN LOCATIONS AS SHOWN.
- DATUM Z= Z1+Z2+Z3+Z4+Z5+Z6.
- CLEARANCE FROM EDGE OF SOLDER-MASK
- FOR PRODUCT SPECIFICATION SEE PS-91364-006

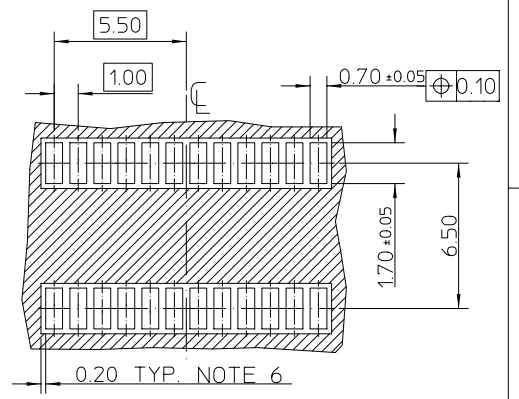

RECOMMENDED PCB LAYOUT
(MATING BOARD)
VIEW FROM MATING SIDE

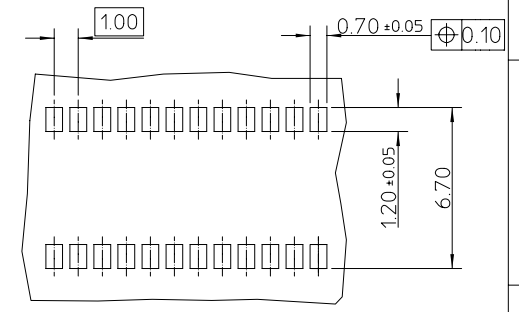

RECOMMENDED PCB LAYOUT
(MAIN BOARD)
VIEW FROM SURFACE MOUNT SIDE

HOUSING MODS: EC NO: E2000-0052 DRWN: EK 99.07.15 CHK: APPR:	QUALITY SYMBOLS MAJOR CRITICAL	GENERAL TOLERANCES: (UNLESS SPECIFIED)		SCALE 5:1	DESIGN UNITS <input checked="" type="checkbox"/> mm <input type="checkbox"/> INCH	THIRD ANGLE PROJECTION	DIMENSIONS: <input type="checkbox"/> mm <input type="checkbox"/> INCH <input checked="" type="checkbox"/> mm ONLY	SHT	REV			
		4 PLACES ±---	3 PLACES ±---	2 PLACES ±0.10	1 PLACE ±0.20	ANGULAR: ± 1/2°	DRAWN BY & DATE ekelly 99.04.07	CHECKED BY & DATE MKEANE 99.04.07	APPROVED BY & DATE MWILHITE 99.04.09	CAD FILENAME	TITLE 24CCT BOARD TO BOARD CONNECTOR	MATERIAL NO. 91364-0002
B	REV	DRAFT WHERE APPLICABLE MUST REMAIN WITHIN DIMENSIONS			THIS DRAWING CONTAINS INFORMATION THAT IS PROPRIETARY TO MOLEX INCORPORATED AND SHOULD NOT BE USED WITHOUT WRITTEN PERMISSION.				SIZE B			

PART NO. 91364-0002
 DWG. NO. SD-91364-002

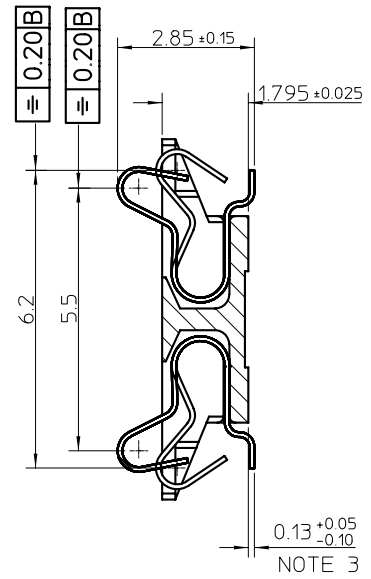
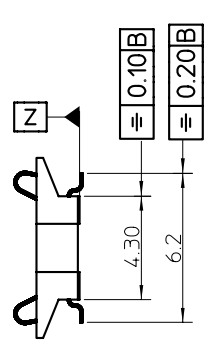
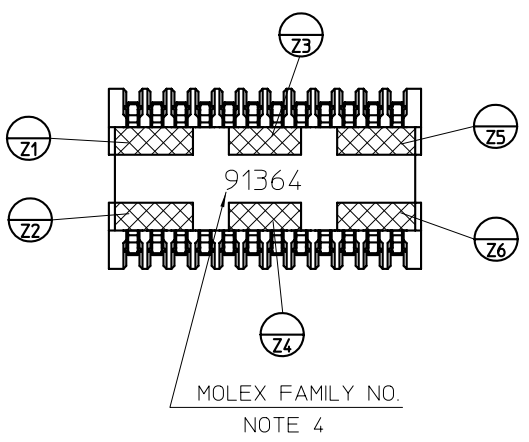
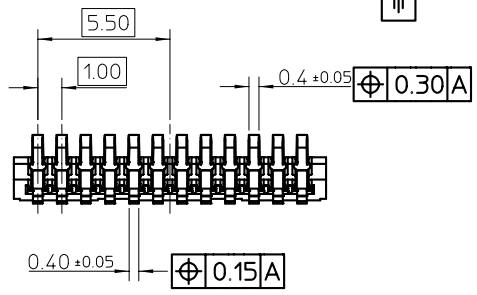
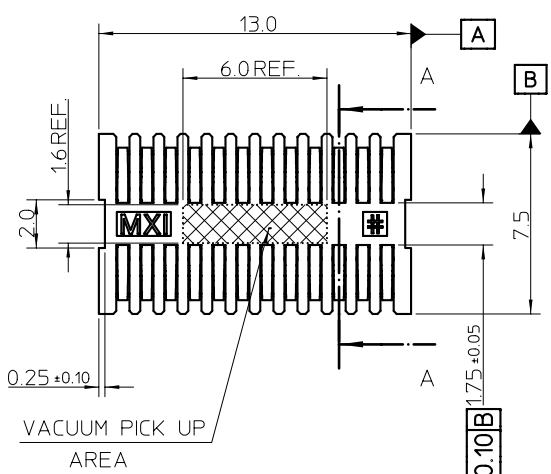

A-A
 SCALE 10:1

NOTES:

- MATERIALS:
 HOUSING: NYLON 46, 45% GLASS FILL. COLOUR BLACK
 CONTACT: BERYLLIUM COPPER 0.10 REF THK.
- PLATING: 1.27um MIN NICKEL UNDERCOAT OVERALL
 CONTACT AREA: 0.25um Au MIN OVER NICKEL UNDERCOAT
 SMT TAIL AREA: 0.10-0.20um Au OVER NICKEL UNDERCOAT
- ALL SMT TAILS ARE TO LIE WITHIN A 0.10 TOLERANCE BAND FROM EACH OTHER
- MOLEX FAMILY NUMBER AND CAVITY I.D. (MXI #)
 TEXT CHARACTER SIZE TO BE 0.8 HIGH. TEXT TO BE RECESSED INTO HOUSING IN LOCATIONS AS SHOWN.
- DATUM Z= Z1+Z2+Z3+Z4+Z5+Z6.
- CLEARANCE FROM EDGE OF SOLDER-MASK
- FOR PRODUCT SPECIFICATION SEE PS-91364-006

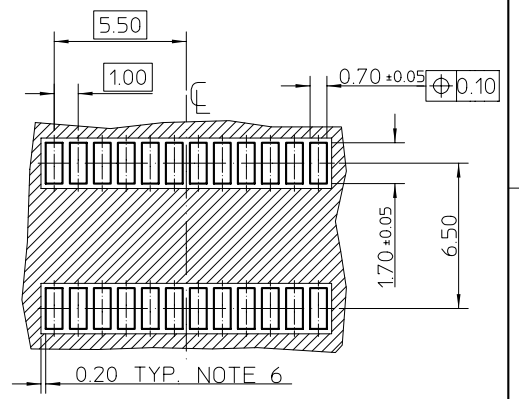

RECOMMENDED PCB LAYOUT
 (MATING BOARD)
 VIEW FROM MATING SIDE

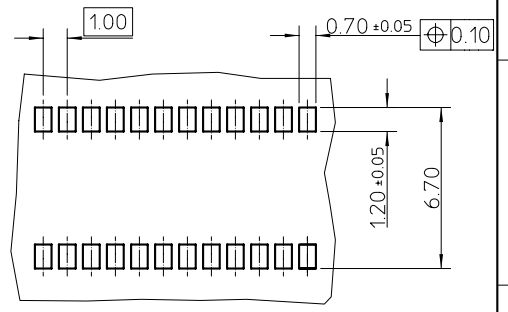

RECOMMENDED PCB LAYOUT
 (MAIN BOARD)
 VIEW FROM SURFACE MOUNT SIDE

HOUSING MODS:
 EC NO. E2000-0052
 DRWN: EK 99.07.15
 CHK:
 APPR:

DESCRIPTION
 MAJOR
 CRITICAL

	GENERAL TOLERANCES: (UNLESS SPECIFIED)	
	mm	INCH
4 PLACES	±---	±---
3 PLACES	±---	±---
2 PLACES	±0.10	±---
1 PLACE	±0.20	±---
ANGULAR: ± 1/2°		

SCALE 5:1
 DESIGN UNITS mm INCH
 DRAWN BY & DATE
 ekelly 99.04.07
 CHECKED BY & DATE
 MKEANE 99.04.07
 APPROVED BY & DATE
 MWILHITE 99.04.09
 CAD FILENAME

DIMENSIONS: <input type="checkbox"/> mm <input type="checkbox"/> INCH <input checked="" type="checkbox"/> mm <input type="checkbox"/> INCH <input type="checkbox"/> mm ONLY		SHT	REV
TITLE 24CCT BOARD TO BOARD CONNECTOR		REVISE ON CAD ONLY	
Molex INCORPORATED			
MATERIAL NO. 91364-0002	DRAWING NO. SD-91364-002	SHEET NO. 11 of 1	
DRAFT WHERE APPLICABLE MUST REMAIN WITHIN DIMENSIONS			SIZE B
THIS DRAWING CONTAINS INFORMATION THAT IS PROPRIETARY TO MOLEX INCORPORATED AND SHOULD NOT BE USED WITHOUT WRITTEN PERMISSION			

COMPONENT PICK UP DETAIL

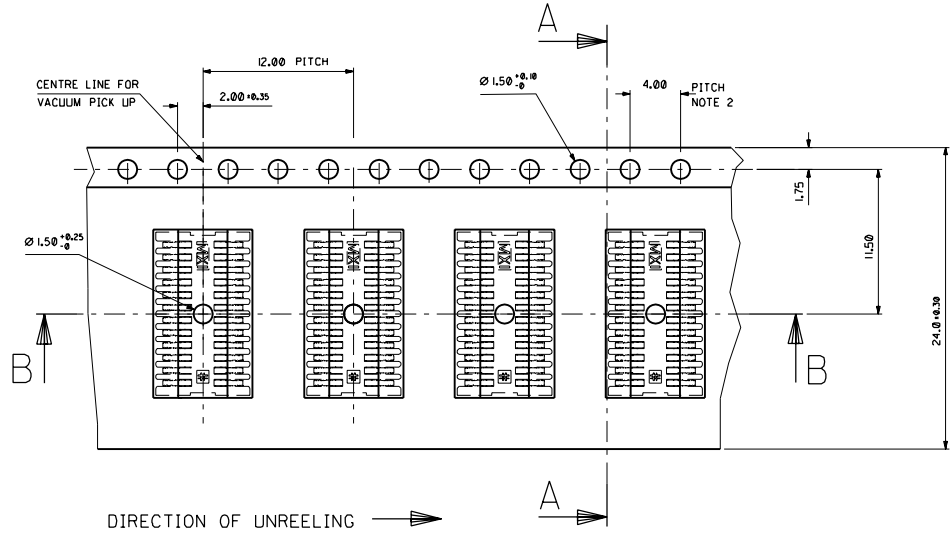
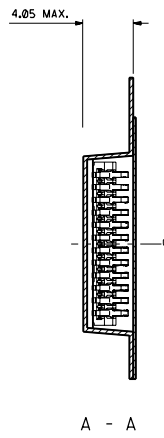
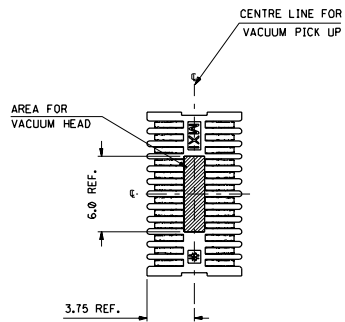

REFERENCE ONLY

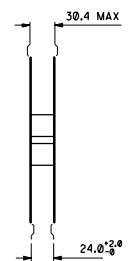
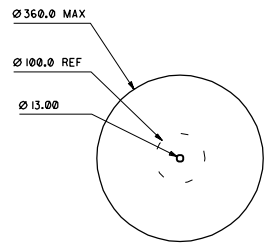

REEL DIMENSIONS
DO NOT SCALE

- (1600) PIECES / REEL - SUBJECT TO CHANGE
- (5) REELS / CARDBOARD BOX
- (8000) PIECES / CARDBOARD BOX

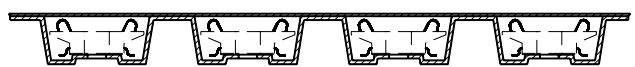

B - B

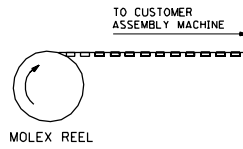

NOTES:

- MATERIAL :
CARRIER TAPE : VOLUME CONDUCTIVE POLYSTYRENE , 0.40 REF THICK , BLACK
COVER TAPE : COLD SEAL POLYESTER , 0.06 REF THICK , TRANSPARENT
- PITCH TOLERANCE OVER ANY 10 PITCHES ± 0.20
- PEEL FORCE OF THE COVER TAPE IS 0.1N TO 1.0N AT A MAXIMUM PEEL SPEED OF 300/min. ± 10%
- PACKAGING SPEC. TBA.
- REFERENCE TO IEC 286-3 EXCEPT WHERE NOTED

ORIGINAL RELEASE EC No. E90420 DRW: ROC 99/04/21 CHK: / / APP: / /	QUALITY SYMBOLS MAJOR CRITICAL C	GENERAL TOLERANCES: (UNLESS SPECIFIED)		SCALE	DESIGN UNITS	THIRD ANGLE PROJECTION	DIMENSIONS:	SHT	REV
		mm	INCH	5 : 1	mm <input checked="" type="checkbox"/> INCH <input type="checkbox"/>	mm <input type="checkbox"/> INCH <input type="checkbox"/>	mm <input checked="" type="checkbox"/> ONLY	REVISE ON CAD ONLY	
REV: A	DESCRIPTION	4 PLACES	± 0.	±.	DRAWN BY & DATE ROCONNOR 99/04/15	TITLE: BLISTER PACKAGING FOR 24 CCT B/B CONNECTOR	MATERIAL NO. S91364X.LDGN	DRAWING NO. SD-91364-004	SHEET NO. 1 OF 1
		3 PLACES	± 0.	±.	CHECKED BY & DATE MKEANE 99/04/16				
		2 PLACES	± 0.10	±.	APPROVED BY & DATE MWILHITE 99/04/19				
		1 PLACE	± 0.20	±.	ANGULAR: ± 1/2 °				
DRAFT WHERE APPLICABLE MUST REMAIN WITHIN DIMENSIONS		THIS DRAWING CONTAINS INFORMATION THAT IS PROPRIETARY TO MOLEX INCORPORATED AND SHOULD NOT BE USED WITHOUT WRITTEN PERMISSION.							