

基板取付穴推奨寸法
RECOMMENDED P.C. BOARD HOLE DIM.

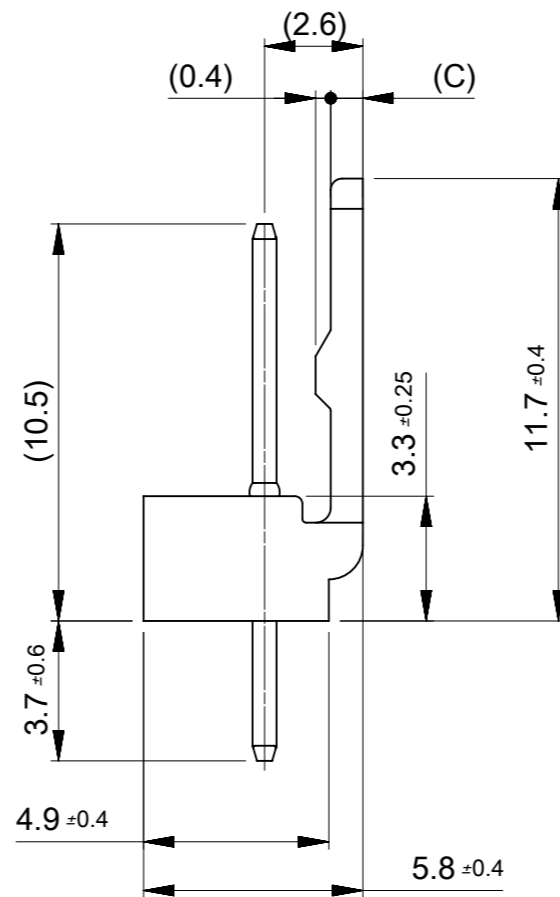

NOTES

1. MATERIAL
 WAFER : 66NYLON, UL94V-0 (COLOR : IVORY)
 PIN : 黄銅 BLASS, □0.635
 PLATING : 錫めっき (5µm以上) 、銅下地 (2.5µm以上)
 TIN PLATING (5µm MIN.), COPPER UNDER PLATING (2.5µm MIN.)
2. 6極以上に適用。
 TO BE APPLIED FOR 6CKT. AND MORE THAN 6CKT.
3. 5極以下はロック部スリットなし。
 NO SLIT IS PROVIDED FOR 5CKT. AND LESS THAN 5CKT.

0.85	7.5	7.5	22044045	5045-04F	4
1	5	5	22044035	5045-03F	3
1	2.5	2.5	22044025	5045-02F	2
(C)	B	(A)	ORDER No.	PARTS No.	CKT.

QUALITY SYMBOLS ▽A = 0 ▽E = 0 ▽F = 0 ▼ = 0 ▽C = 0 ⊗ = 0 ■ = 0 ▽ = 0	THIS DRAWING CONTAINS INFORMATION THAT IS PROPRIETARY TO MOLEX ELECTRONIC TECHNOLOGIES, LLC AND SHOULD NOT BE USED WITHOUT WRITTEN PERMISSION				DIMENSION UNITS: MM SCALE: 5:1			
	EC NO: 116805 DRWN: SOBARA01 CHK'D: AIDA APPR: TKANEKO	2017/04/25 2017/05/24 2017/05/24	GENERAL TOLERANCES (UNLESS SPECIFIED) ANGULAR TOL ± 3.0 °		DRWN BY: SOBARA01 DATE: 2017/04/25	CHK'D BY: AIDA DATE: 2017/05/24		MINI-LATCH 2.5 HEADER ASSY FLANGE PIN TYPE TIN PLATING
	DRAFT WHERE APPLICABLE MUST REMAIN WITHIN DIMENSIONS		4 PLACES ± 3 PLACES ± 2 PLACES ± 0.2 1 PLACE ± 0.2 0 PLACES ± 0.2	APPR BY: TKANEKO DATE: 2017/05/24	PRODUCT CUSTOMER DRAWING			
	A3 THIRD ANGLE PROJECTION				SERIES: 5045 MATERIAL NUMBER: SEE CHART CUSTOMER: GENERAL			
RELEASE STATUS: P1 RELEASE DATE: 24.05.2017 06:43:36			DOCUMENT NUMBER: 50450000 DOC TYPE: PSD DOC PART: 000 SHEET NUMBER: 1 OF 1					