

DO NOT SCALE FROM THIS PRINT

QFS-XXX-XX.XX-X-D-DP-XX-XXX-X-XX

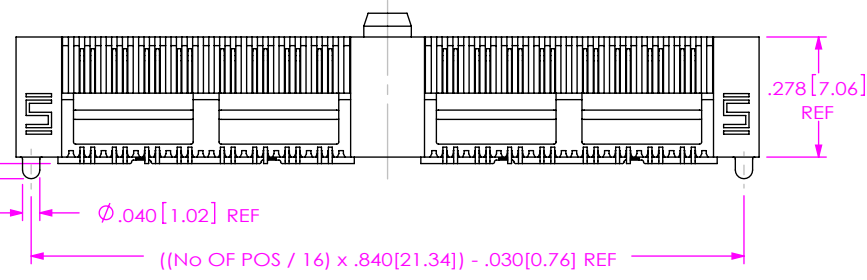
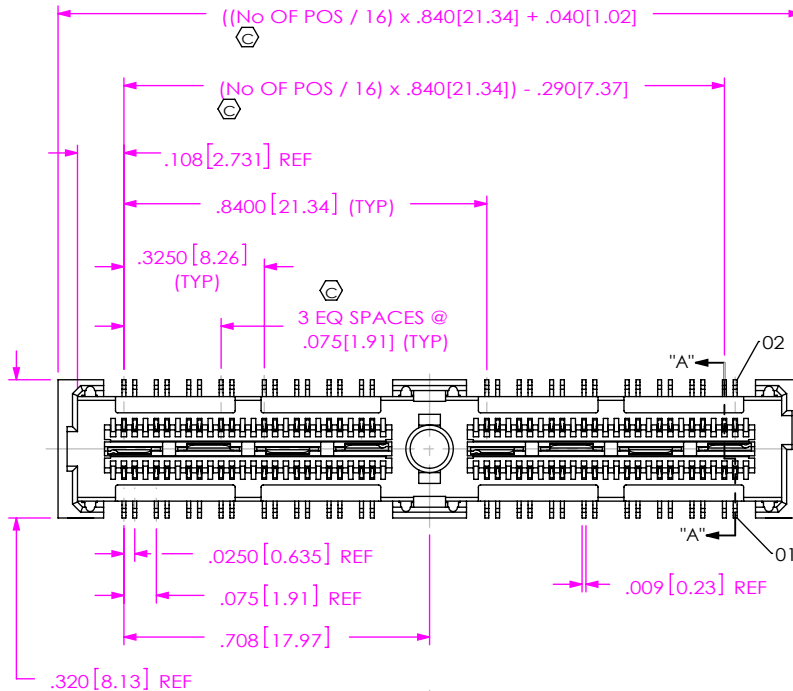

FIG 1  
QFS-032-04.25-X-D-DP-A SHOWN

| TABLE 1         |             |             |
|-----------------|-------------|-------------|
| No OF POSITIONS | No OF BANKS | COPLANARITY |
| -016 THRU -048  | 1 THRU 3    | .004[.10]   |
| -064 AND -080   | 4 AND 5     | .006[.15]   |

No OF POSITIONS

-016, -032, -048, -064, \* -080 (PER ROW)

LEAD STYLE

-04.25 (SEE NOTE 9)

PLATING SPECIFICATION

-L: LIGHT GOLD (USE C-181-04.25-L)  
 -H: HEAVY GOLD (USE C-181-04.25-H)  
 -S: SELECTIVE GOLD (USE C-181-04.25-S)  
 -SL: LIGHT SELECTIVE GOLD (USE C-181-04.25-SL)  
 (ALL PLATING STYLES USE T-1G20-04.25-L)

ROW SPECIFICATION

-D: DOUBLE  
 -DP: DIFFERENTIAL PAIRS

OPTION

-A: ALIGNMENT PIN (NOT AVAILABLE WITH -PXX OR -RFX)  
 -GP: GUIDE HOLES (SEE FIG 2, SHEET 2) (NOT AVAILABLE WITH -PXX, -RFX, OR -RT1)

\* = NOT TOOLED

PACKAGING

BLANK: TRAY (SEE NOTES 8 & 10)  
 -TR: TAPE & REEL (SEE NOTES 10 & 11)  
 -FR: FULL REEL QTY TAPE & REEL (SEE NOTES 10 & 11)  
 (-TR & -FR PACKAGING AVAILABLE FOR: -016 THRU -048 WITH NO OPTIONS; -016 & -032 WITH -GP, -PXX, -RF1, RT1; -016 WITH RF2)

PICK & PLACE OPTION

-P: PICK & PLACE PAD (USE PPP-51, SEE FIG 7, SHT 2)

END OPTIONS

-PC4: 4 POWER POS PER END (.062" THICK BOARD) (SEE FIG 3, SHEET 3)  
 -PC8: 8 POWER POS PER END (.062" THICK BOARD) (SEE FIG 3, SHEET 3)  
 -PT4: 4 POWER POS PER END (.093" THICK BOARD) (SEE FIG 3, SHEET 3)  
 -PT8: 8 POWER POS PER END (.093" THICK BOARD) (SEE FIG 3, SHEET 3)  
 -RF1: 1 RF POS PER END (SEE FIG 4, SHEET 4)  
 -RF2: 2 RF POS PER END (SEE FIG 5, SHEET 4)  
 -RT1: 1 RT POS PER END (SEE FIG 6, SHEET 5)

[PXX NOT AVAILABLE IN COMBINATION WITH -A OR -GP]  
 [PXX AVAILABLE ON POSITIONS -016, -032 & -048 ONLY]

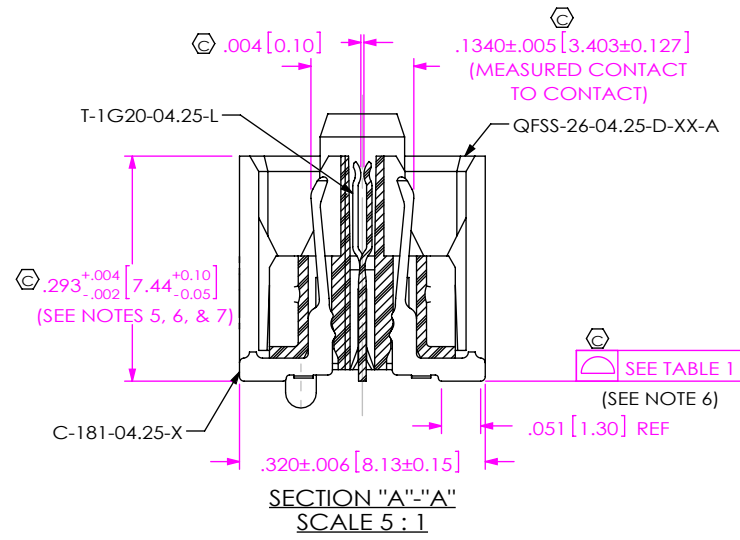

NOTES:

1.  $\Phi$  REPRESENTS A CRITICAL DIMENSION.
2. MAXIMUM BURR ALLOWANCE: .0015[0.038].
3. MINIMUM PUSHOUT FORCE: SIGNAL: .5 LB, GROUND: 1 LB, POWER: .5 LB, RF: .5 LB.
4. CONTACTS WILL BE SHEARED FOR ALL POSITIONS & ALL STYLES FOR THE QFS.
5. MAXIMUM VARIANCE OF .002[0.05].
6. DIMENSION APPLIES TO CONTACTS & GROUND PLANE.
7. GROUND PLANE PRESS HEIGHT MUST BE .003 [.08] LESS THAN THE MAX HEIGHT OR .001 [.03] GREATER THAN THE MINIMUM HEIGHT OF THE TERMINAL.
8. TRAYS ARE STANDARD PACKAGING.
9. LEADSTYLE -01 MAY BE SUBSTITUTED IN PART CALLOUT FOR -04.25 FOR EXISTING CUSTOMERS ONLY.
10. ORDERS WILL BE PACKAGED ACCORDING TO THE SAMTEC PACKAGING EFFICIENCY STANDARDS (SPES) FOUND ON WWW.SAMTEC.COM.
11. ATTACH LABEL TO EACH REEL.

UNLESS OTHERWISE SPECIFIED, DIMENSIONS ARE IN INCHES.

TOLERANCES ARE:  
 DECIMALS ANGLES  
 .XX:  $\pm .01$  [.3] 2°  
 .XXX:  $\pm .005$  [.13]  
 .XXXX:  $\pm .0020$  [.051]

PROPRIETARY NOTE

THIS DOCUMENT CONTAINS CONFIDENTIAL AND PROPRIETARY INFORMATION AND ALL DESIGN, MANUFACTURING, REPRODUCTION, USE, PATENT RIGHTS AND SALES RIGHTS ARE EXPRESSLY RESERVED BY SAMTEC, INC. THIS DOCUMENT SHALL NOT BE DISCLOSED, IN WHOLE OR PART, TO ANY UNAUTHORIZED PERSON OR ENTITY NOR REPRODUCED, TRANSFERRED OR INCORPORATED IN ANY OTHER PROJECT IN ANY MANNER WITHOUT THE EXPRESS WRITTEN CONSENT OF SAMTEC, INC.

MATERIAL: DO NOT SCALE DRAWING SHEET SCALE: 2.25:1  
 INSULATOR: VECTRA E130, COLOR: BLACK  
 CONTACTS & GROUND PLANE: PHOS BRONZE



520 PARK EAST BLVD, NEW ALBANY, IN 47150  
 PHONE: 812-944-6733 FAX: 812-948-5047  
 e-Mail: info@SAMTEC.com code: 55322

DESCRIPTION:  
 .635mm DIFFERENTIAL PAIRS TERMINAL STRIP  
 DWG. NO.  
 QFS-XXX-XX.XX-X-D-DP-XX-XXX-X-XX  
 BY: BRATCHER 08/08/2003 SHEET 1 OF 5

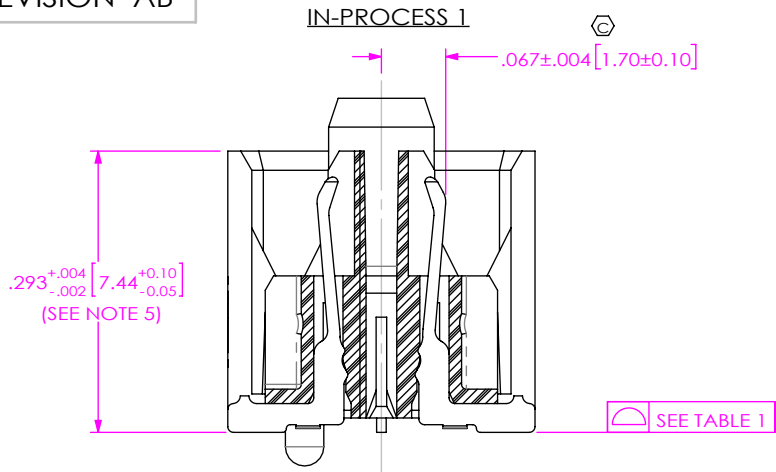

**CONTACT DETAILS**  
SEE NOTE  
(ALL CONTACTS SHEARED FOR QFS)

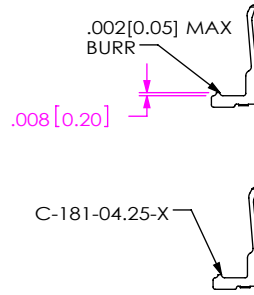
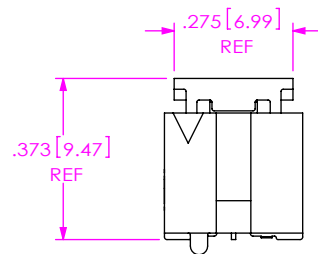
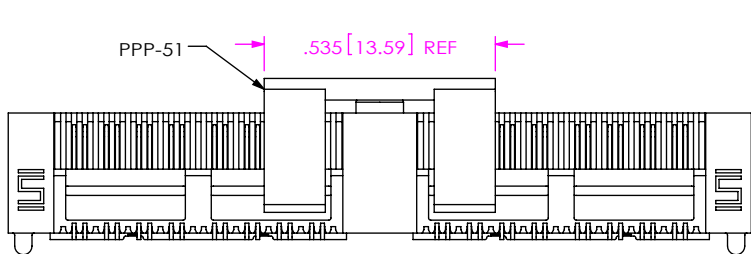
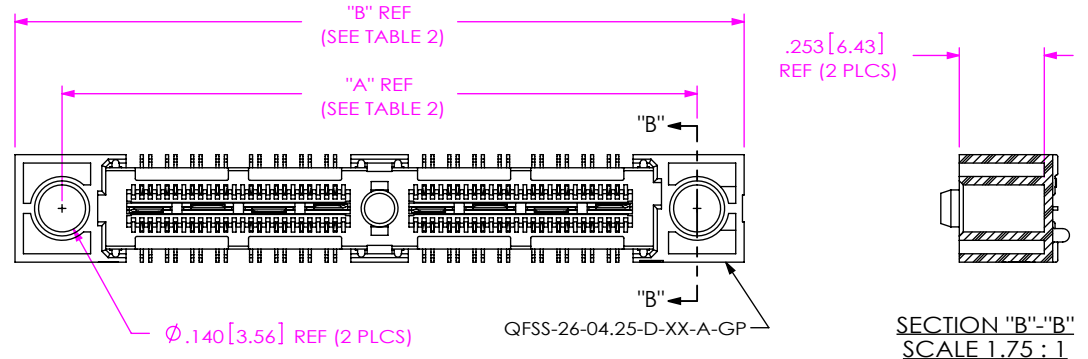
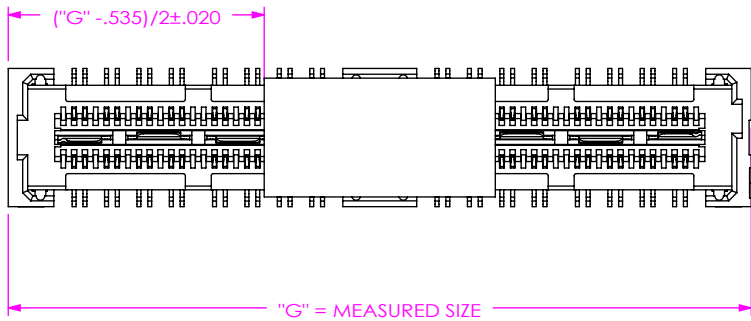

**TABLE 2**

| ASSEMBLY                  | "A"           | "B"           |
|---------------------------|---------------|---------------|
| QFS-016-04.25-X-D-DP-A-GP | 1.050[26.67]  | 1.330[33.78]  |
| QFS-032-04.25-X-D-DP-A-GP | 1.890[48.00]  | 2.170[55.12]  |
| QFS-048-04.25-X-D-DP-A-GP | 2.730[69.34]  | 3.010[76.45]  |
| QFS-064-04.25-X-D-DP-A-GP | 3.570[90.68]  | 3.850[97.79]  |
| QFS-080-04.25-X-D-DP-A-GP | 4.410[112.01] | 4.690[119.13] |

**FIG 2**  
-GP: GUIDE HOLE OPTION  
(QFS-032-04.25-X-D-DP-A-GP SHOWN)  
(NOT AVAILABLE WITH -PXX, RFX, OR -RT1 OPTIONS)

**FIG 7**  
-P: PICK & PLACE PAD OPTION



**PROPRIETARY NOTE**  
THIS DOCUMENT CONTAINS CONFIDENTIAL AND PROPRIETARY INFORMATION AND ALL DESIGN, MANUFACTURING, REPRODUCTION, USE, PATENT RIGHTS AND SALES RIGHTS ARE EXPRESSLY RESERVED BY SAMTEC, INC. THIS DOCUMENT SHALL NOT BE DISCLOSED, IN WHOLE OR PART, TO ANY UNAUTHORIZED PERSON OR ENTITY NOR REPRODUCED, TRANSFERRED OR INCORPORATED IN ANY OTHER PROJECT IN ANY MANNER WITHOUT THE EXPRESS WRITTEN CONSENT OF SAMTEC, INC.  
DO NOT SCALE DRAWING  
SHEET SCALE: 2.5:1

**samtec**  
520 PARK EAST BLVD, NEW ALBANY, IN 47150  
PHONE: 812-944-6733 FAX: 812-948-5047  
e-Mail: info@SAMTEC.com code: 55322

DESCRIPTION:  
.635mm DIFFERENTIAL PAIRS TERMINAL STRIP  
DWG. NO.  
QFS-XXX-XX.XX-X-D-DP-XX-XXX-X-XX  
BY: BRATCHER 08/08/2003 SHEET 2 OF 5

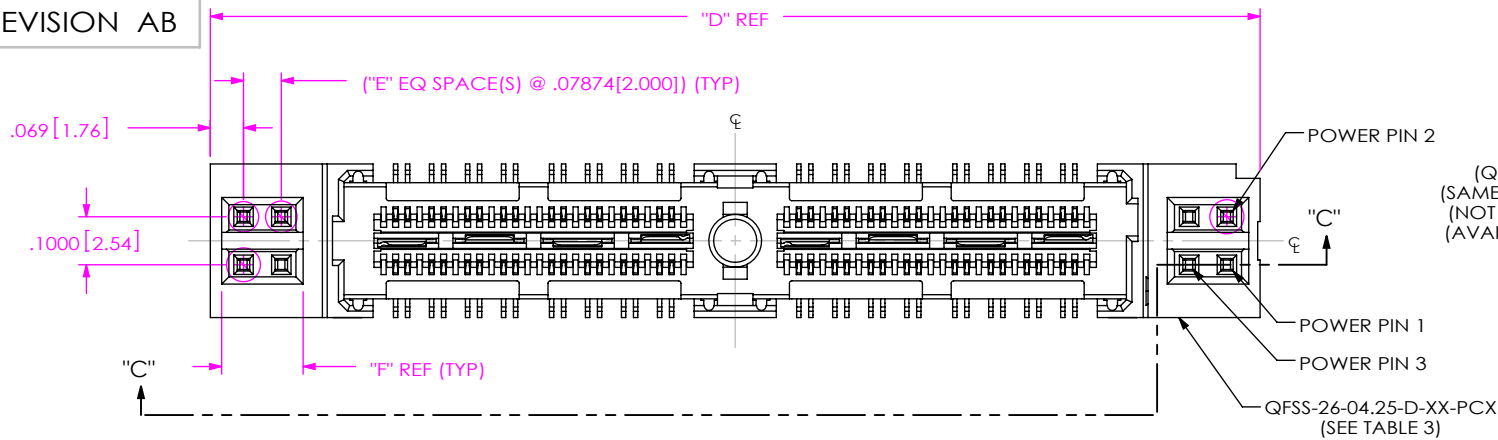

**FIG 3**  
 POWER COMBO OPTIONS  
 (QFS-032-04.25-X-D-DP-PC4 SHOWN)  
 (SAME AS FIG 1, UNLESS OTHERWISE STATED)  
 (NOT AVAILABLE WITH -A OR -GP OPTION)  
 (AVAILABLE ON POS -016, -032, -048 ONLY)

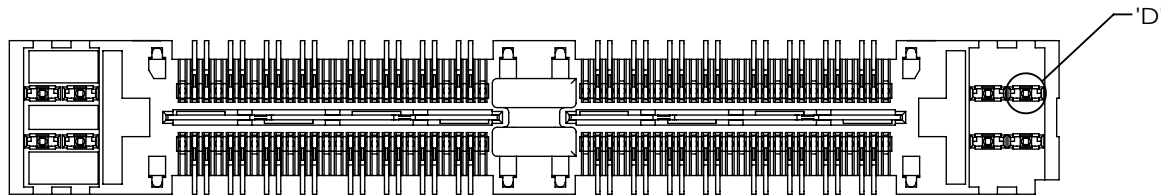
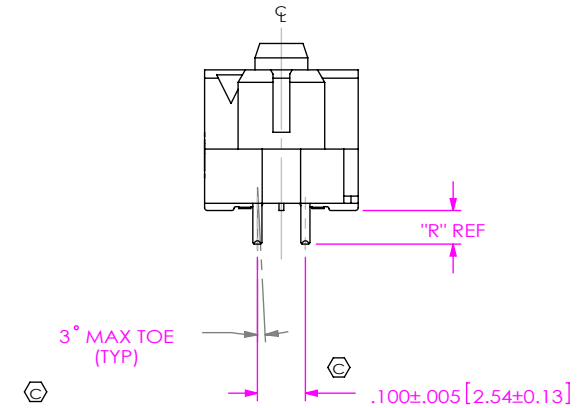
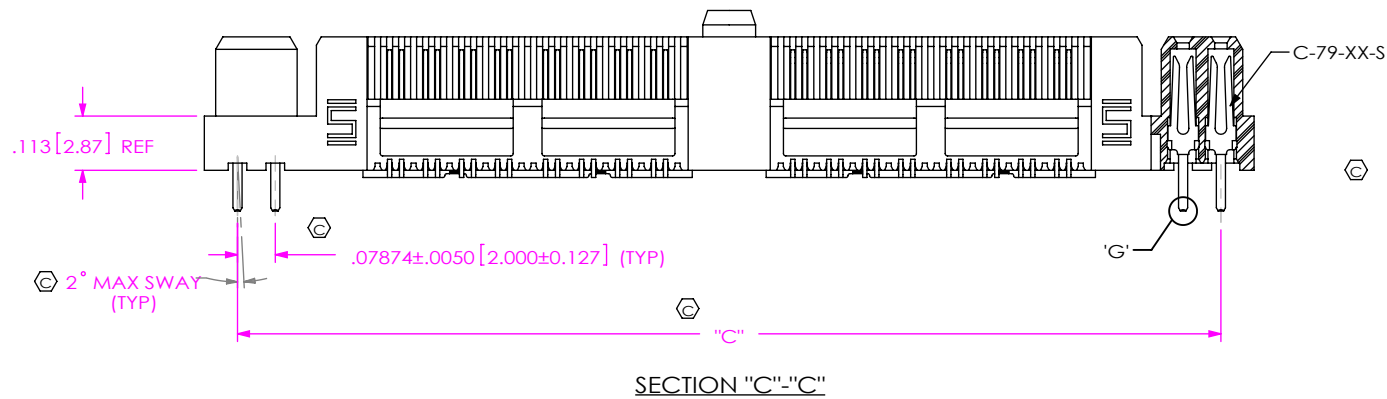

**DETAIL 'D'**  
 SCALE 8 : 1

.005 MAX BURR  
 THIS DIRECTION  
 ONLY, OTHERWISE  
 SEE NOTE 2

**DETAIL 'G'**  
 SCALE 10 : 1

| POWER OPTION | CONTACT   | "Q"        | "R"        |
|--------------|-----------|------------|------------|
| PC4/PC8      | C-79-06-S | .085[2.16] | .070[1.78] |
| PT4/PT8      | C-79-09-S | .125[3.18] | .110[2.79] |

| ASSEMBLY                   | QFSS-26-04.25-D-XX-PCX | "C"          | "D"          | "E" | "F"        |
|----------------------------|------------------------|--------------|--------------|-----|------------|
| QFS-016-04.25-X-D-DP-X-PX4 | QFSS-26-04.25-D-01-PC4 | 1.209[30.70] | 1.347[34.21] | 1   | .170[4.31] |
| QFS-016-04.25-X-D-DP-X-PX8 | QFSS-26-04.25-D-01-PC8 | 1.524[38.70] | 1.662[42.21] | 3   | .327[8.31] |
| QFS-032-04.25-X-D-DP-X-PX4 | QFSS-26-04.25-D-02-PC4 | 2.049[52.04] | 2.187[55.55] | 1   | .170[4.31] |
| QFS-032-04.25-X-D-DP-X-PX8 | QFSS-26-04.25-D-02-PC8 | 2.364[60.04] | 2.502[63.55] | 3   | .327[8.31] |
| QFS-048-04.25-X-D-DP-X-PX4 | QFSS-26-04.25-D-03-PC4 | 2.889[73.37] | 3.027[76.89] | 1   | .170[4.31] |
| QFS-048-04.25-X-D-DP-X-PX8 | QFSS-26-04.25-D-03-PC8 | 3.204[81.37] | 3.342[84.89] | 3   | .327[8.31] |

**PROPRIETARY NOTE**  
 THIS DOCUMENT CONTAINS CONFIDENTIAL AND PROPRIETARY INFORMATION AND ALL DESIGN, MANUFACTURING, REPRODUCTION, USE, PATENT RIGHTS AND SALES RIGHTS ARE EXPRESSLY RESERVED BY SAMTEC, INC. THIS DOCUMENT SHALL NOT BE DISCLOSED, IN WHOLE OR PART, TO ANY UNAUTHORIZED PERSON OR ENTITY NOR REPRODUCED, TRANSFERRED OR INCORPORATED IN ANY OTHER PROJECT IN ANY MANNER WITHOUT THE EXPRESS WRITTEN CONSENT OF SAMTEC, INC.

DO NOT SCALE DRAWING

SHEET SCALE: 2.5:1



520 PARK EAST BLVD, NEW ALBANY, IN 47150  
 PHONE: 812-944-6733 FAX: 812-948-5047  
 e-Mail: info@SAMTEC.com code: 55322

DESCRIPTION:  
 .635mm DIFFERENTIAL PAIRS TERMINAL STRIP

DWG. NO.  
 QFS-XXX-XX.XX-X-D-DP-XX-XXX-X-XX

BY: BRATCHER 08/08/2003 SHEET 3 OF 5

**FIG 4**  
 -RF1 OPTION  
 (QFS-032-04.25-X-D-DP-RF1 SHOWN)  
 (SAME AS FIG 3, UNLESS OTHERWISE STATED)  
 (NOT AVAILABLE WITH -A OR -GP OPTIONS)  
 (AVAILABLE ON POSITIONS -016, -032, & -048 ONLY)

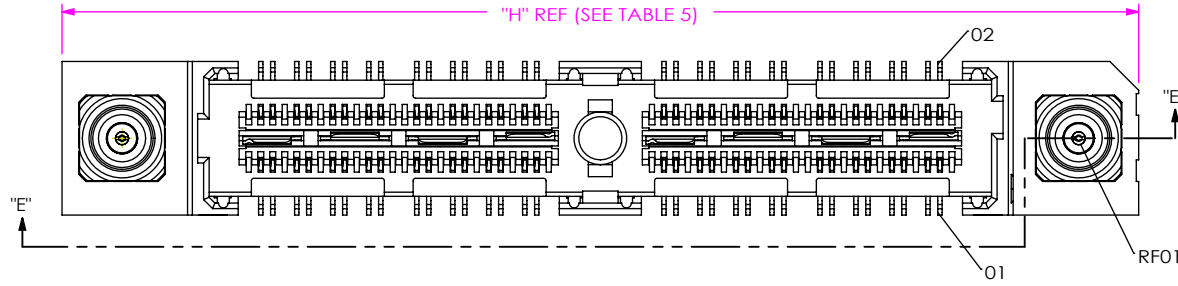

| TABLE 5                  |                        |              |              |
|--------------------------|------------------------|--------------|--------------|
| ASSEMBLY                 | QFSS-26-04.25-D-XX-RFX | "H"          | "J"          |
| QFS-016-04.25-X-D-DP-RF1 | QFSS-26-04.25-D-01-RF1 | 1.403[35.64] | 1.153[29.29] |
| QFS-016-04.25-X-D-DP-RF2 | QFSS-26-04.25-D-01-RF2 | 1.903[48.34] | 1.653[41.99] |
| QFS-032-04.25-X-D-DP-RF1 | QFSS-26-04.25-D-02-RF1 | 2.243[56.97] | 1.993[50.62] |
| QFS-032-04.25-X-D-DP-RF2 | QFSS-26-04.25-D-02-RF2 | 2.743[69.67] | 2.493[63.32] |
| QFS-048-04.25-X-D-DP-RF1 | QFSS-26-04.25-D-03-RF1 | 3.083[78.31] | 2.833[71.96] |
| QFS-048-04.25-X-D-DP-RF2 | QFSS-26-04.25-D-03-RF2 | 3.583[91.01] | 3.333[84.66] |

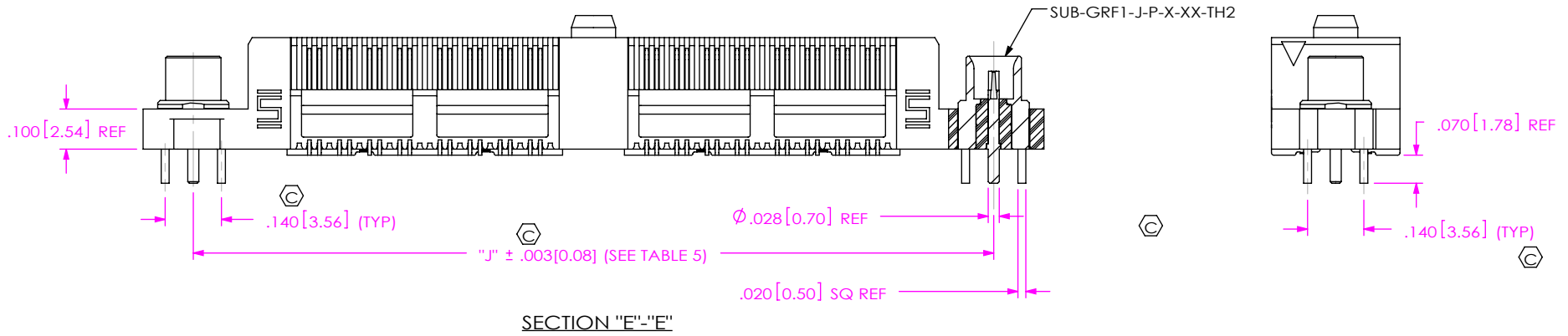

SECTION "E"-"E"

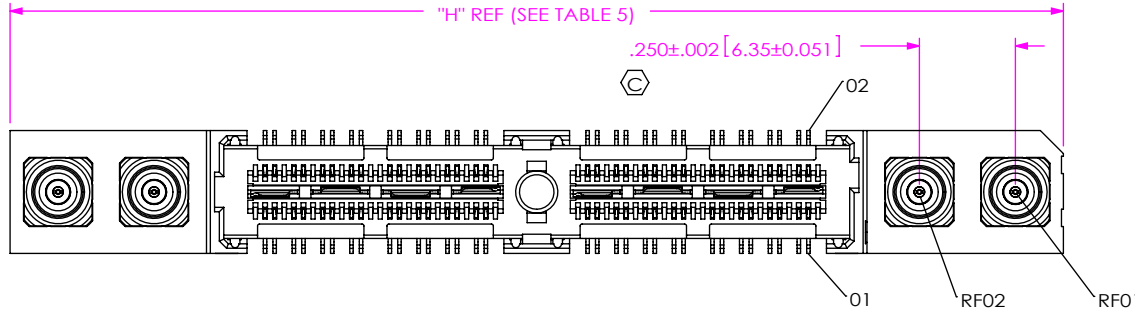

**FIG 5**  
 -RF2 OPTION  
 (QFS-032-04.25-X-D-DP-RF2 SHOWN)  
 (SAME AS FIG 4, UNLESS OTHERWISE STATED)  
 (NOT AVAILABLE WITH -A OR -GP OPTIONS)  
 (AVAILABLE ON POSITIONS -016, -032, & -048 ONLY)

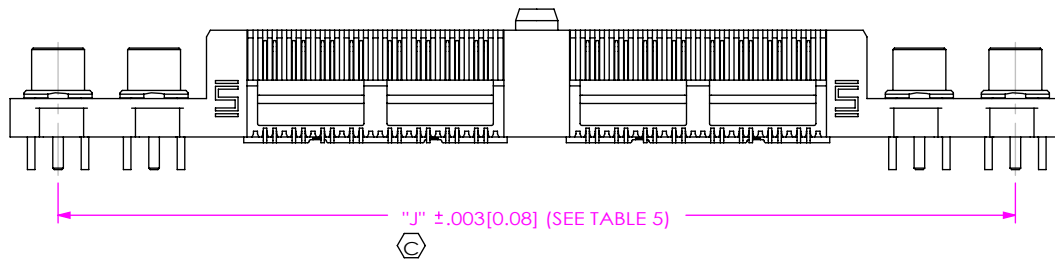

**PROPRIETARY NOTE**  
 THIS DOCUMENT CONTAINS CONFIDENTIAL AND PROPRIETARY INFORMATION AND ALL DESIGN, MANUFACTURING, REPRODUCTION, USE, PATENT RIGHTS AND SALES RIGHTS ARE EXPRESSLY RESERVED BY SAMTEC, INC. THIS DOCUMENT SHALL NOT BE DISCLOSED, IN WHOLE OR PART, TO ANY UNAUTHORIZED PERSON OR ENTITY NOR REPRODUCED, TRANSFERRED OR INCORPORATED IN ANY OTHER PROJECT IN ANY MANNER WITHOUT THE EXPRESS WRITTEN CONSENT OF SAMTEC, INC.

DO NOT SCALE DRAWING

SHEET SCALE: 2.5:1



520 PARK EAST BLVD, NEW ALBANY, IN 47150  
 PHONE: 812-944-6733 FAX: 812-948-5047  
 e-Mail: info@SAMTEC.com code: 55322

DESCRIPTION:  
 .635mm DIFFERENTIAL PAIRS TERMINAL STRIP

DWG. NO.  
 QFS-XXX-XX.XX-X-D-DP-XX-XXX-X-XX

BY: BRATCHER 08/08/2003 SHEET 4 OF 5

FIG 6

-RT1 OPTION  
 (QFS-032-04.25-X-D-DP-A-RT1 SHOWN)  
 (SAME AS FIG 3, UNLESS OTHERWISE STATED)  
 (NOT AVAILABLE WITH -GP OR -RFX OPTIONS)  
 (AVAILABLE ON POSITIONS -016 & -032 WITH -A OPTION ONLY)

| ASSEMBLY                   | TABLE 6                  |              |              |
|----------------------------|--------------------------|--------------|--------------|
|                            | BODY                     | "K"          | "L"          |
| QFS-016-04.25-X-D-DP-A-RT1 | QFSS-26-04.25-D-01-A-RT1 | 1.403[35.64] | 1.153[29.29] |
| QFS-032-04.25-X-D-DP-A-RT1 | QFSS-26-04.25-D-02-A-RT1 | 2.243[56.97] | 1.993[50.62] |
| QFS-048-04.25-X-D-DP-A-RT1 | QFSS-26-04.25-D-03-A-RT1 | 3.083[78.31] | 2.833[71.96] |
| QFS-064-04.25-X-D-DP-A-RT1 | QFSS-26-04.25-D-04-A-RT1 | 3.923[99.64] | 3.673[93.29] |

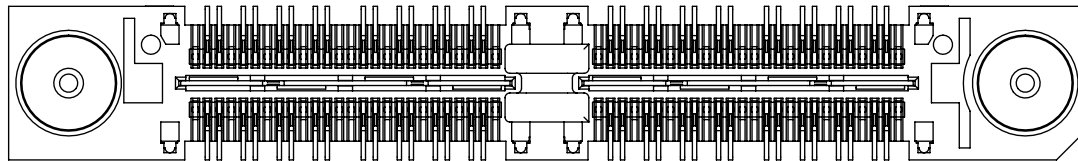
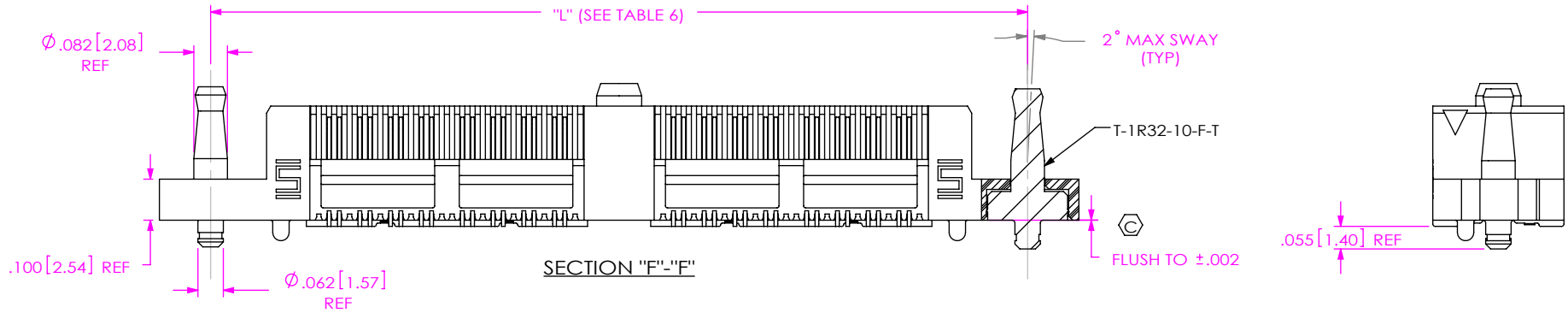
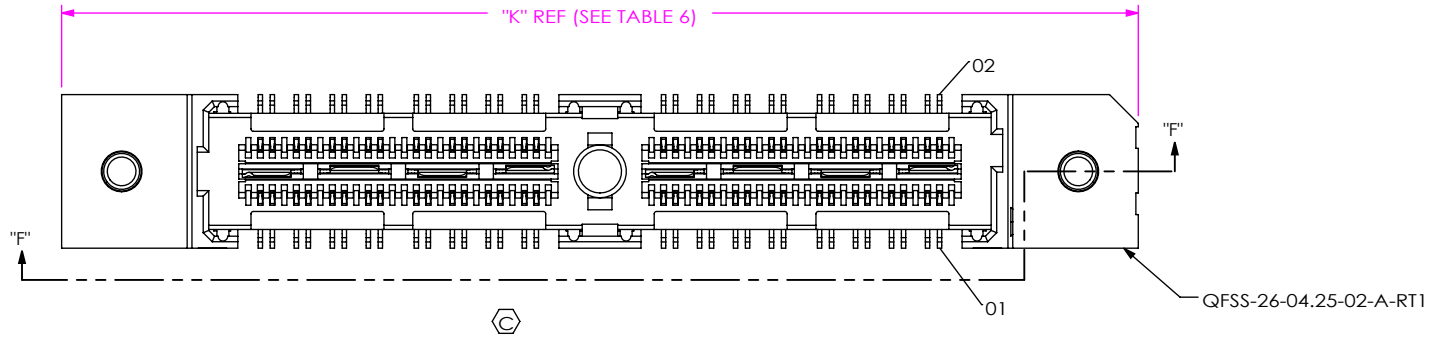

**PROPRIETARY NOTE**  
 THIS DOCUMENT CONTAINS CONFIDENTIAL AND PROPRIETARY INFORMATION AND ALL DESIGN, MANUFACTURING, REPRODUCTION, USE, PATENT RIGHTS AND SALES RIGHTS ARE EXPRESSLY RESERVED BY SAMTEC, INC. THIS DOCUMENT SHALL NOT BE DISCLOSED, IN WHOLE OR PART, TO ANY UNAUTHORIZED PERSON OR ENTITY NOR REPRODUCED, TRANSFERRED OR INCORPORATED IN ANY OTHER PROJECT IN ANY MANNER WITHOUT THE EXPRESS WRITTEN CONSENT OF SAMTEC, INC.

DO NOT SCALE DRAWING

SHEET SCALE: 2.5:1



520 PARK EAST BLVD, NEW ALBANY, IN 47150  
 PHONE: 812-944-6733 FAX: 812-948-5047  
 e-Mail: info@SAMTEC.com code: 55322

DESCRIPTION:  
 .635mm DIFFERENTIAL PAIRS TERMINAL STRIP  
 DWG. NO.  
 QFS-XXX-XX.XX-X-D-DP-XX-XXX-X-XX  
 BY: BRATCHER 08/08/2003 SHEET 5 OF 5