

A

B

C

D

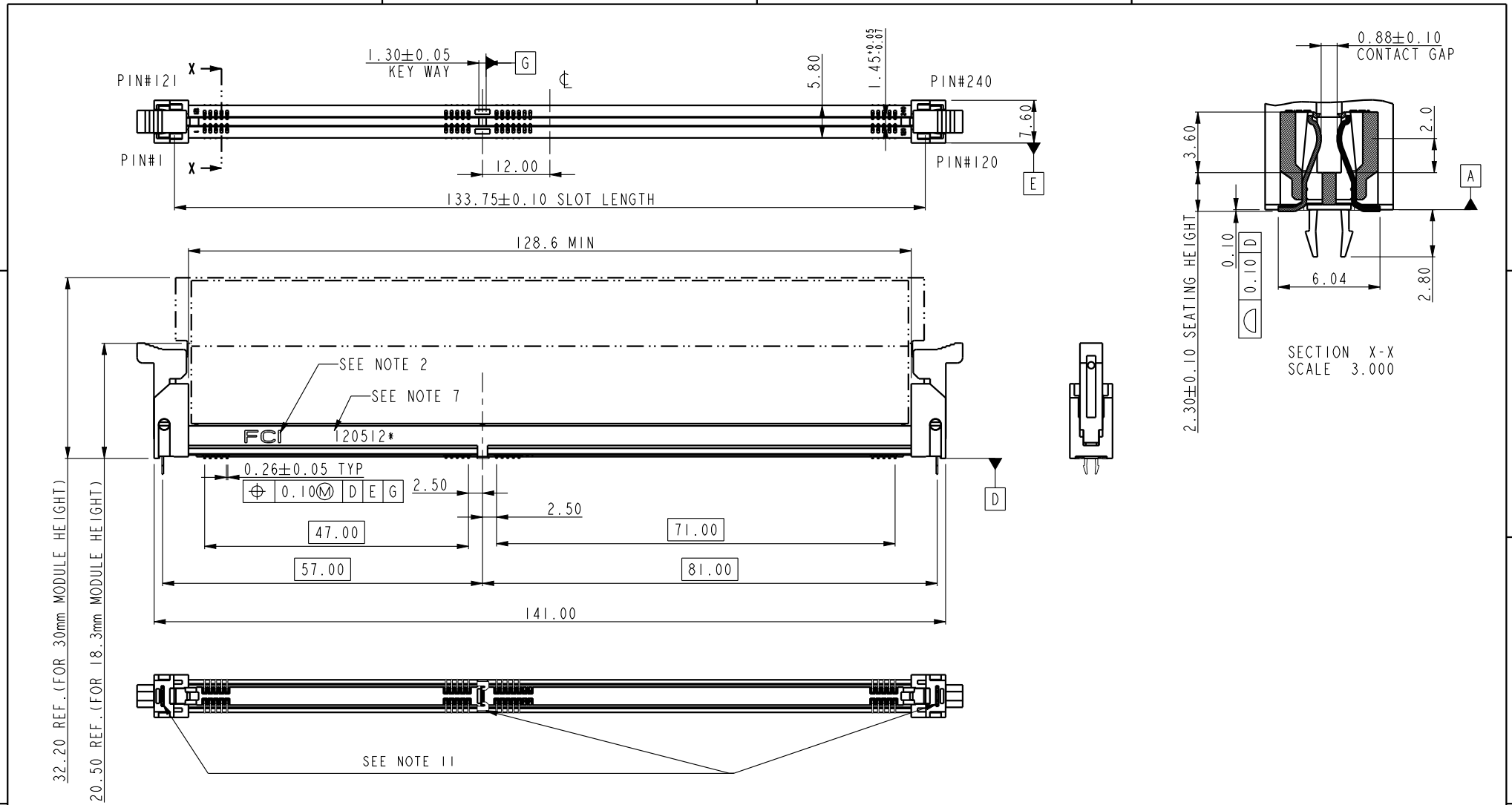

spec ref	*	dr	Rick Bian	2010/07/04	projection	MM	size	A4	scale	1.000										
tolerance std	TOLERANCES UNLESS OTHERWISE SPECIFIED	eng	Jeny Ren	2017/12/28		←→	ecn no	ELX-DG-28885-1												
		chr	-	-			rel level	Released												
surface	<table border="1"> <tr> <td>linear</td> <td>0.X</td> <td>± 0.5</td> </tr> <tr> <td></td> <td>0.XX</td> <td>± 0.30</td> </tr> <tr> <td></td> <td>0.XXX</td> <td>± 0.15</td> </tr> <tr> <td>angular</td> <td>0°</td> <td>$\pm 2^\circ$</td> </tr> </table>	linear	0.X	± 0.5		0.XX	± 0.30		0.XXX	± 0.15	angular	0°	$\pm 2^\circ$	appr	Nickor Zuo	2018/02/09	product family			
linear	0.X	± 0.5																		
	0.XX	± 0.30																		
	0.XXX	± 0.15																		
angular	0°	$\pm 2^\circ$																		
		Amphenol FCI		title	DDR III SMT SOCKET ASS'Y (WITH LCP HOUSING)			dwg no	10104389											
		www.fci.com	cat. no.	*	Product - Customer Drw			rev	F											
					sheet 1 of 4															

A

B

C

D

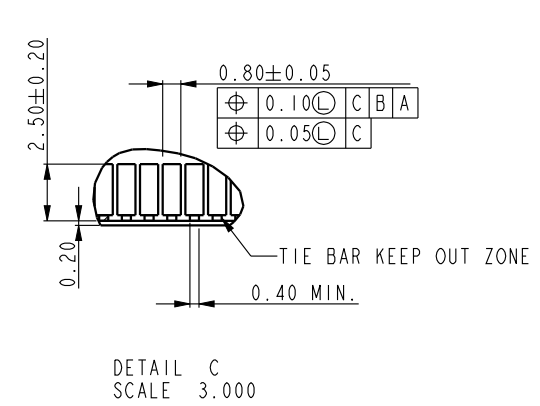
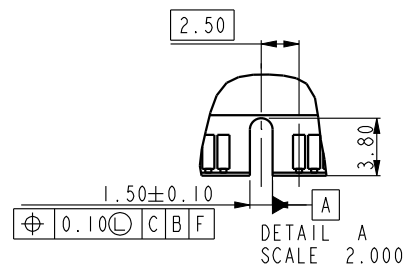
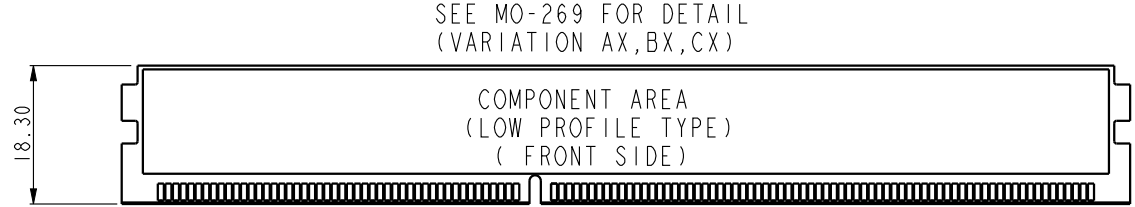
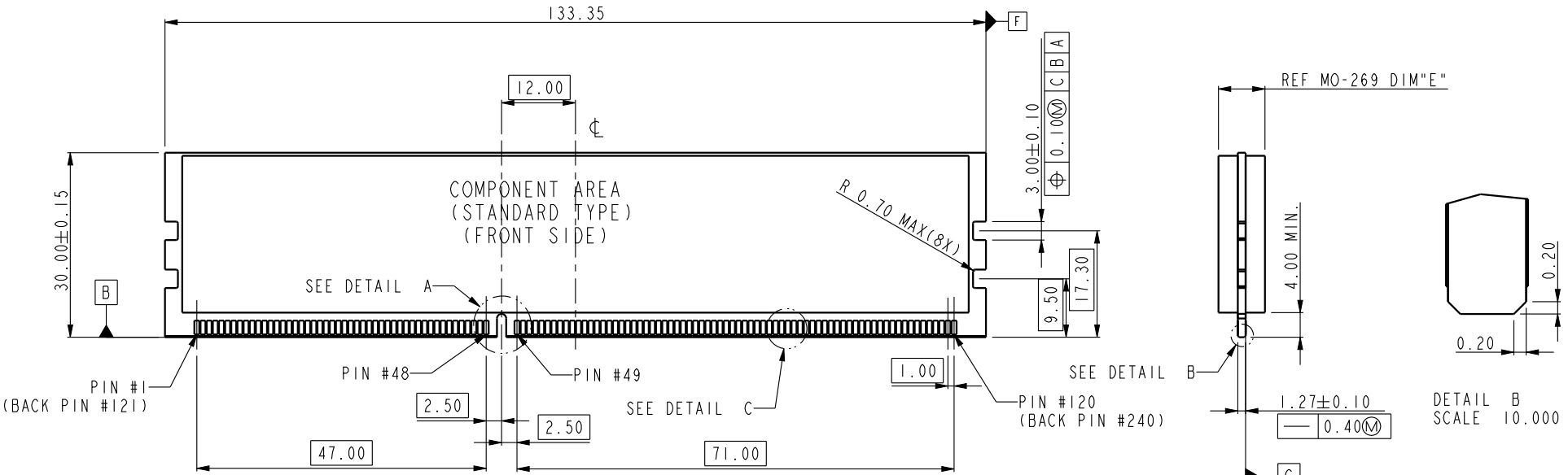

dr	Rick Bian	2010/07/04	projection	MM	size	A4	scale	1.000
eng	Jeny Ren	2017/12/28			ecn no	ELX-DG-28885-1		
chr	-	-			rel level	Released		
appr	Nickor Zuo	2018/02/09	product family					
Amphenol FCI	title			DDR III SMT SOCKET ASS'Y		dwg no		10104389
				(WITH LCP HOUSING)				rev
								F
www.fci.com	cat. no.			Product - Customer Drw			sheet 2 of 4	



A

B

C

D

A

B

C

D

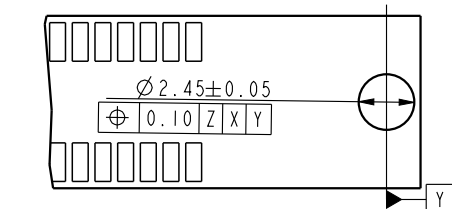
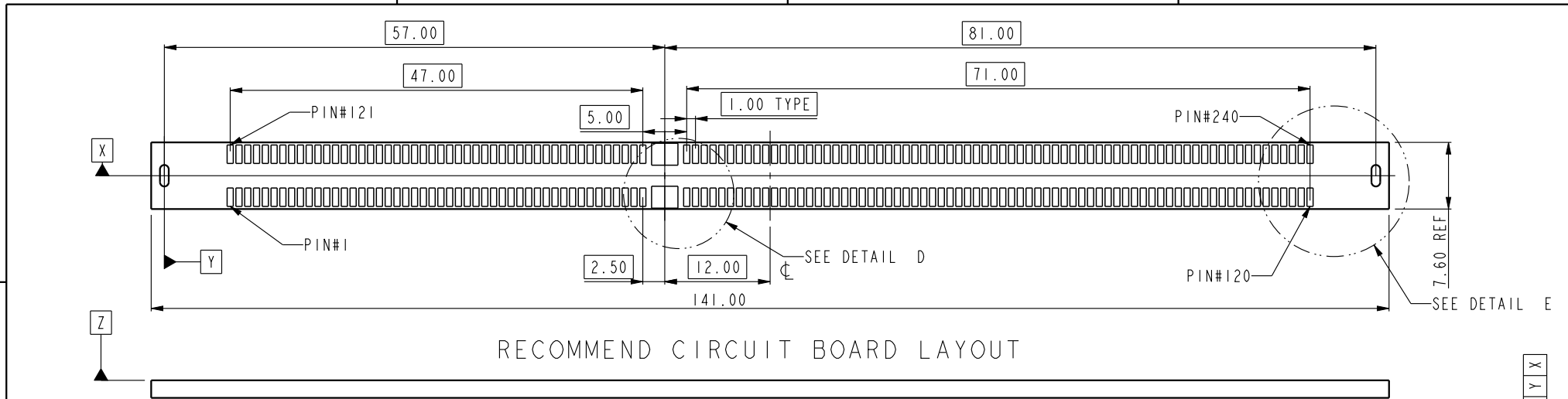

DETAIL E
SCALE 3.000
Standard hole for hold-down clips

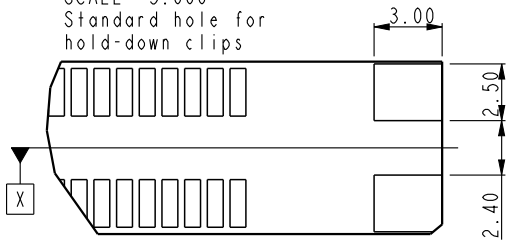

DETAIL E
SCALE 3.000
For smt holddown type

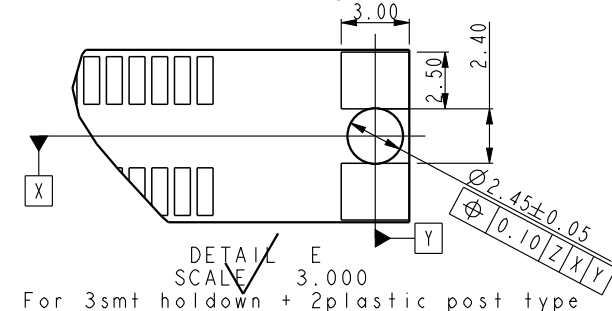

DETAIL E
SCALE 3.000
For 3smt holddown + 2plastic post type

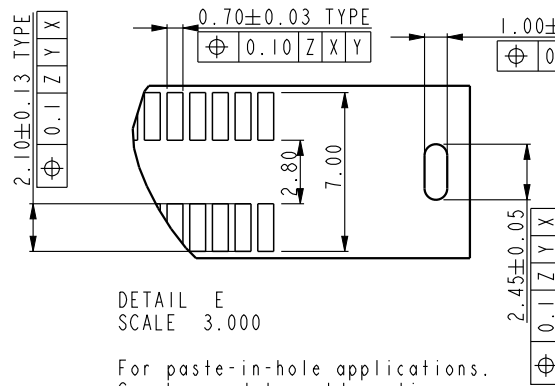

DETAIL E
SCALE 3.000

For paste-in-hole applications.
Can be used to solder clips during reflow operation.

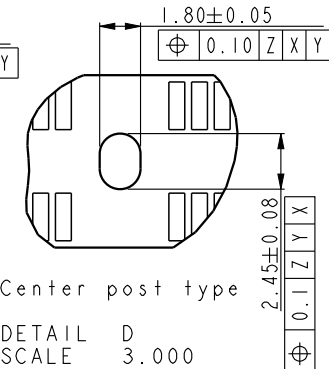

Center post type

DETAIL D
SCALE 3.000

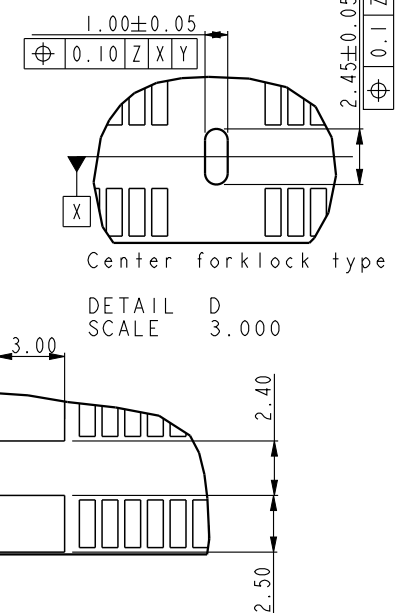

DETAIL D
SCALE 3.000

Center smt holddown type

DETAIL D
SCALE 3.000

dr	Rick Bian	2010/07/04	projection 	MM 	size	A4	scale	1.000
eng	Jeny Ren	2017/12/28			ecn no	ELX-DG-28885-1		
chr	-	-			rel level	Released		
appr	Nickor Zuo	2018/02/09	product family		rev			
Amphenol FCI		title			DDR III SMT SOCKET ASS'Y (WITH LCP HOUSING)		dwg no	10104389
www.fci.com		cat. no.		Product - Customer Drw			sheet 3 of 4	F

A

B

C

D

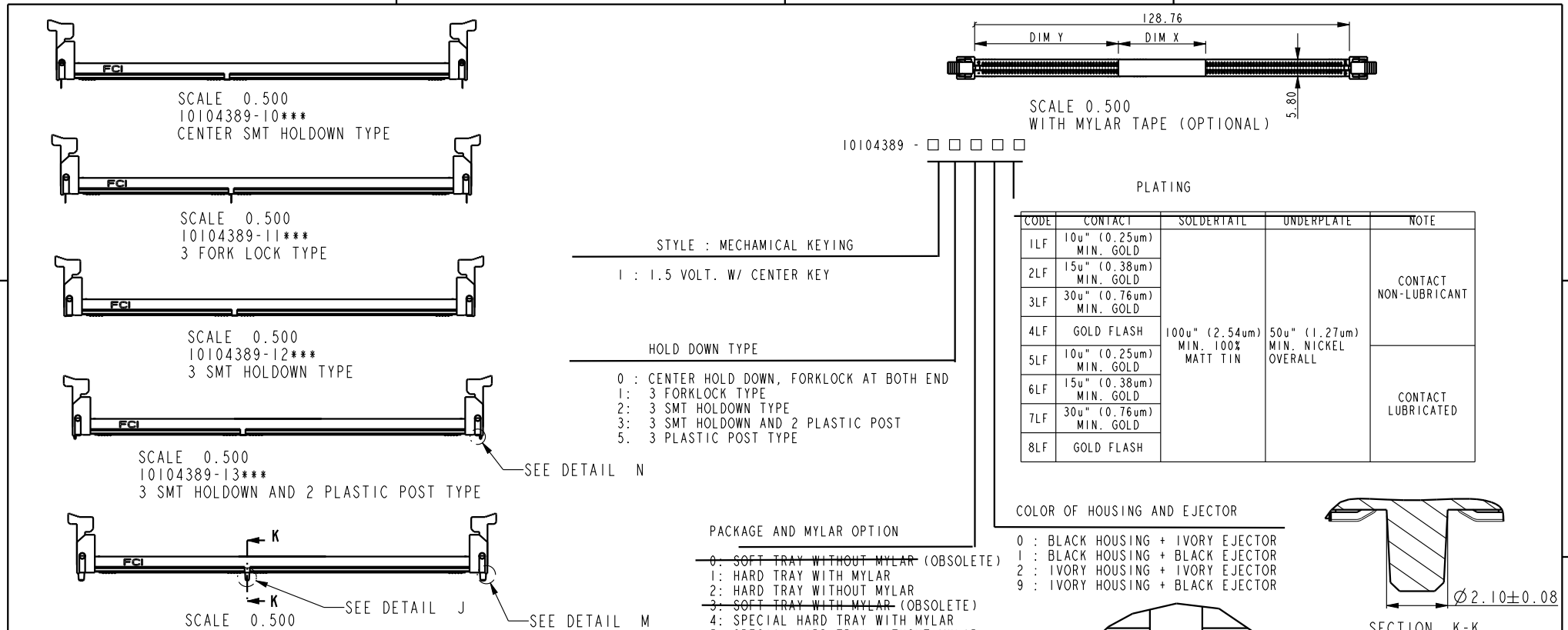

- NOTES:
- MATERIAL:
HOUSING: HIGH PERFORMANCE RESINS, GLASS FILLED UL94V-0 RATED.
EJECTOR: HIGH PERFORMANCE RESINS, GLASS FILLED UL94V-0 RATED.
TERMINAL: HIGH PERFORMANCE COPPER ALLOY
METAL CLIP: COPPER ALLOY.
 - FCI LOGO TO BE APPROXIMATELY LOCATED AS SHOWN ON PRINT.
 - PRODUCT SPECIFICATION: GS-12-486.
 - PACKAGING SPECIFICATION: GS-14-899.
 - RECOMMENDED STENCIL THICKNESS NO LESS THAN 0.15 mm.
 - FOR OPTIMUM PERFORMANCE. THE TIE BAR IS TO BE ON AN INTERNAL LAYER SO THAT THE REMNANT CANNOT CAUSE CONTACT DAMAGE.
 - THE DATE CODE IS SHOWN "MMDDYY*.". "*" MEANS PRODUCTION LINE.
 - THIS PRODUCT MEETS EUROPEAN UNION DIRECTIVES AND OTHER COUNTRY REGULATIONS AS DESCRIBED IN GS-22-008.
 - THE HOUSING WILL WITH STAND EXPOSURE TO 260°C PEAK TEMPERATURE FOR 10 SECONDS IN AN IR REFLOW SOLDERING APPLICATION.
 - PRODUCT APPLICATION SPEC GS-20-089.
 - THE HOLDOWN TYPES ARE OPTION FOR HOLDOWN OR FORKLOCK.

- PACKAGE AND MYLAR OPTION
- 0: SOFT TRAY WITHOUT MYLAR (OBSOLETE)
1: HARD TRAY WITH MYLAR
2: HARD TRAY WITHOUT MYLAR
3: SOFT TRAY WITH MYLAR (OBSOLETE)
4: SPECIAL HARD TRAY WITH MYLAR
5: SPECIAL HARD TRAY WITHOUT MYLAR
6: SPECIAL HARD TRAY WITH MYLAR(24PCS/TRAY)

dr	Rick Bian	2010/07/04	projection	MM	size	A4	scale	1.000
eng	Jeny Ren	2017/12/28			ecn no ELX-DG-28885-1			
chr	-	-			rel level Released			
appr	Nickor Zuo	2018/02/09	product family		rev F			
Amphenol FCI		title			dwg no		rev	
www.fci.com		DDR III SMT SOCKET ASS'Y (WITH LCP HOUSING)			10104389		F	
cat. no.		Product - Customer Drw			sheet 4 of 4			