

IE-XR-RJ45/RJ45-2**Weidmüller Interface GmbH & Co. KG**

Klingenbergstraße 26

D-32758 Detmold

Germany

www.weidmueller.com



IE plug-in connectors, IP20, for copper and fibre optic cables

General ordering data

Version	Mounting flange, Cat.6 _A / Class E _A (ISO/IEC 11801 2010), IP20
Order No.	8952950000
Type	IE-XR-RJ45/RJ45-2
GTIN (EAN)	4032248744329
Qty.	24 pc(s).

IE-XR-RJ45/RJ45-2

Weidmüller Interface GmbH & Co. KG
Klingenbergstraße 26
D-32758 Detmold
Germany

www.weidmueller.com

Technical data

Dimensions and weights

Net weight 21.333 g

Temperatures

Operating temperature -40 °C...70 °C Operating temperature, min. -40 °C
Operating temperature, max. 70 °C

General data

Category	Cat.6 _A / Class E _A (ISO/IEC 11801 2010)	Shielding	360° shield contact
Protection degree	IP20	Insertion force	≤ 30 N

Electrical properties

Contact resistance	≤ 20 mΩ	Current-carrying capacity at 50 °C	1 A
Dielectric strength, contact / contact	≥ 1000 V DC	Dielectric strength, contact / shield	≤ 1500 V DC
PoE / PoE+	conforming to IEEE 802.3at		

General standards

Connector standard IEC 60603-7-5

Classifications

ETIM 6.0	EC001121	ETIM 7.0	EC001121
ETIM 8.0	EC001121	ECLASS 9.0	27-44-03-90
ECLASS 9.1	27-44-03-90	ECLASS 10.0	27-44-03-90
ECLASS 11.0	27-44-03-90	ECLASS 12.0	27-44-03-90

Approvals

Approvals



ROHS Conform

Downloads

Engineering Data	CAD data – STEP
User Documentation	MAN IE GUIDE DE MAN IE GUIDE EN
Catalogues	Catalogues in PDF-format
Brochures	FL FIELDWIRING EN PI PROFINET CABLING EN PI PROFINET CABLING EN

IE-XR-RJ45/RJ45-2

Weidmüller Interface GmbH & Co. KG
Klingenbergstraße 26
D-32758 Detmold
Germany

www.weidmueller.com

Drawings

Dimensioned drawing

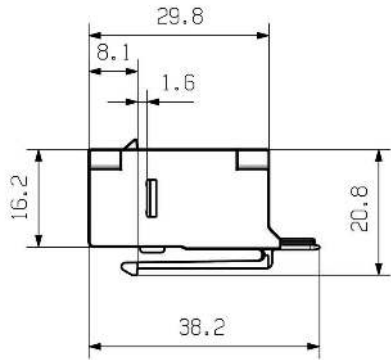

Dimensioned drawing

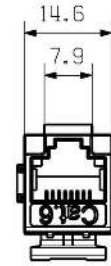

Installation cut-out

