

REVISIONS				
REV	DATE	BY	CHK	APPV
D	26JULY2019	RR	SH	

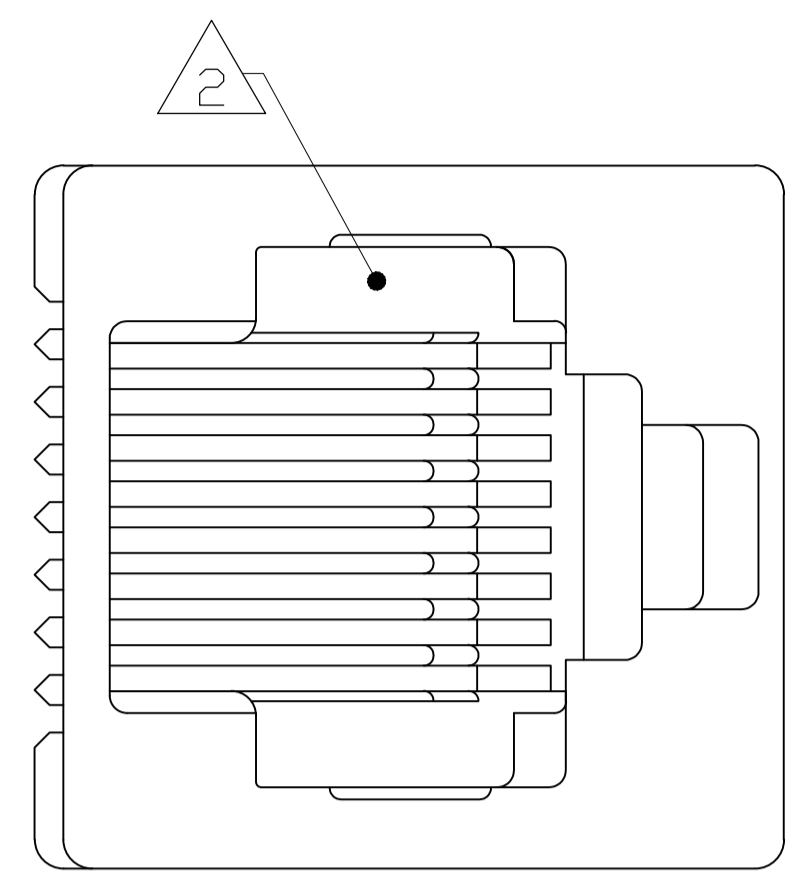

- MATERIAL: HOUSING- PBT POLYESTER, BLACK.  
TERMINAL- 0.36[.014] THICK PHOS BRONZE PLATED WITH 1.27μm[.000050] MINIMUM THICK HARD GOLD LOCALIZED GOLD PLATE AREA AND 3.81μm[.000150] MINIMUM THICK MATTE TIN IN SOLDER AREA OVER 1.27μm[.000050] MINIMUM THICK NICKEL UNDERPLATE.
- CAVITY CONFORMS TO FCC RULES AND REGULATIONS PART 68 AND REA BULLETIN 345-81, PE-76 SPECIFICATION FOR MODULAR TELEPHONE HARDWARE.
- ALL DIMENSIONS SHOWN ARE MAXIMUM UNLESS OTHERWISE SPECIFIED.
- BULK PACKAGED IN A TRAY.
- PACKAGED 30 PER TUBE.

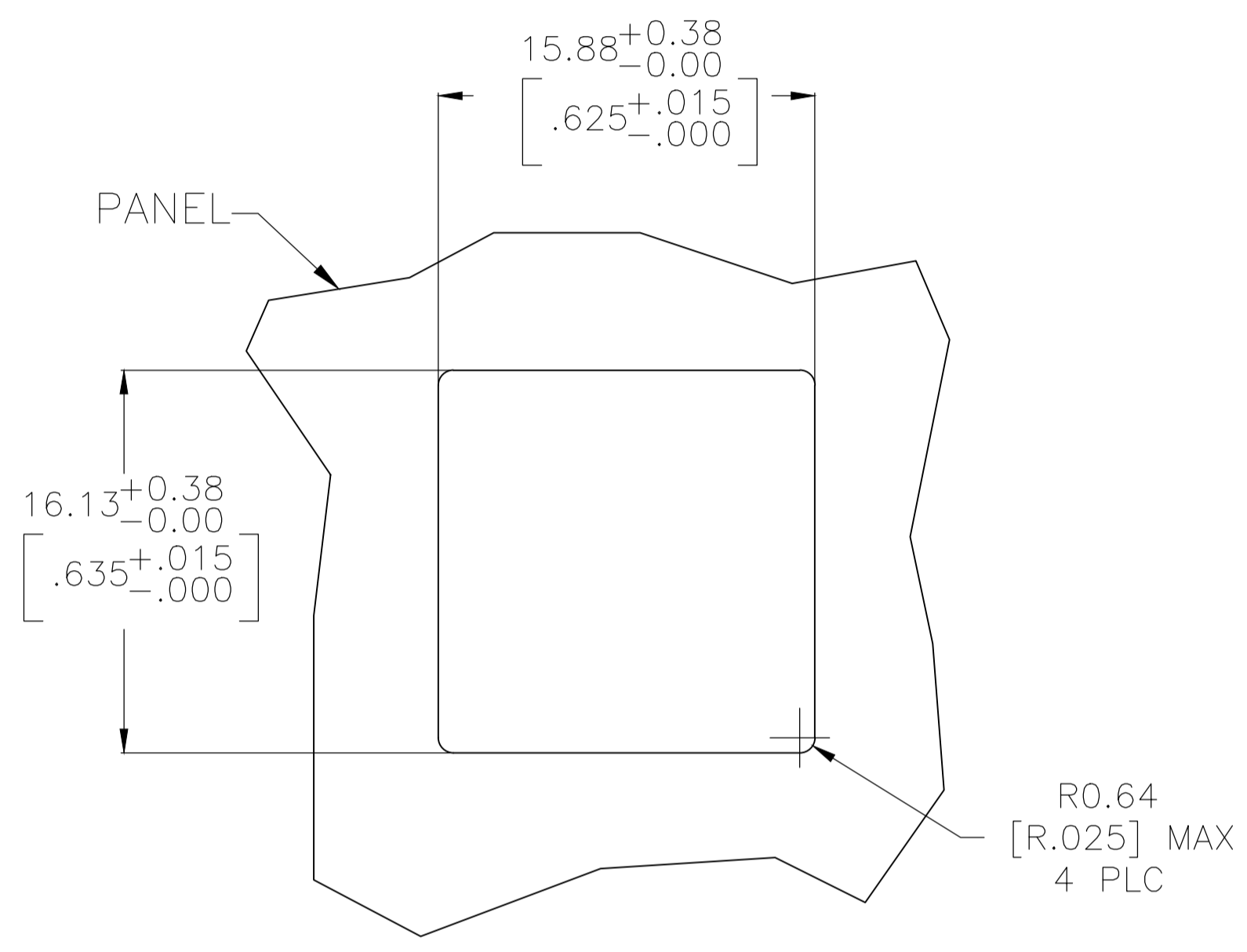
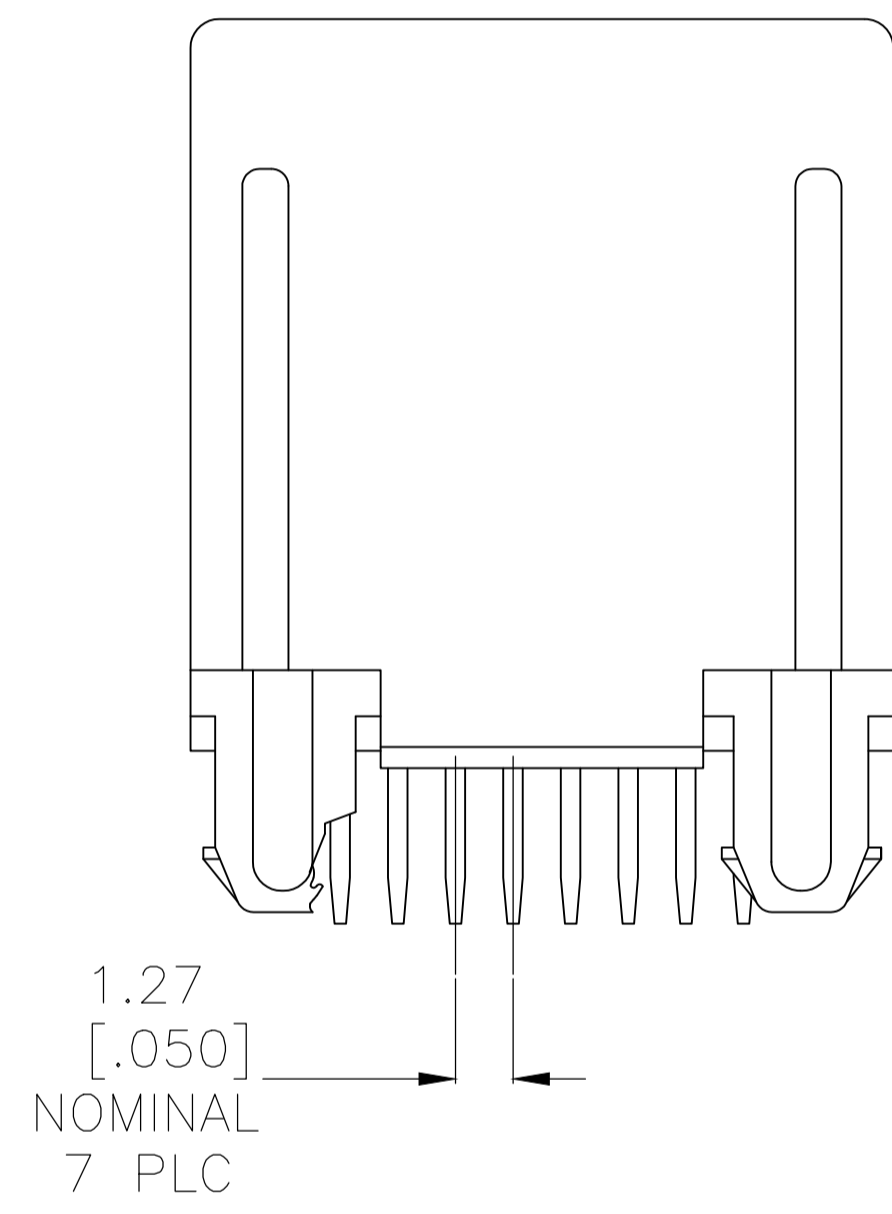
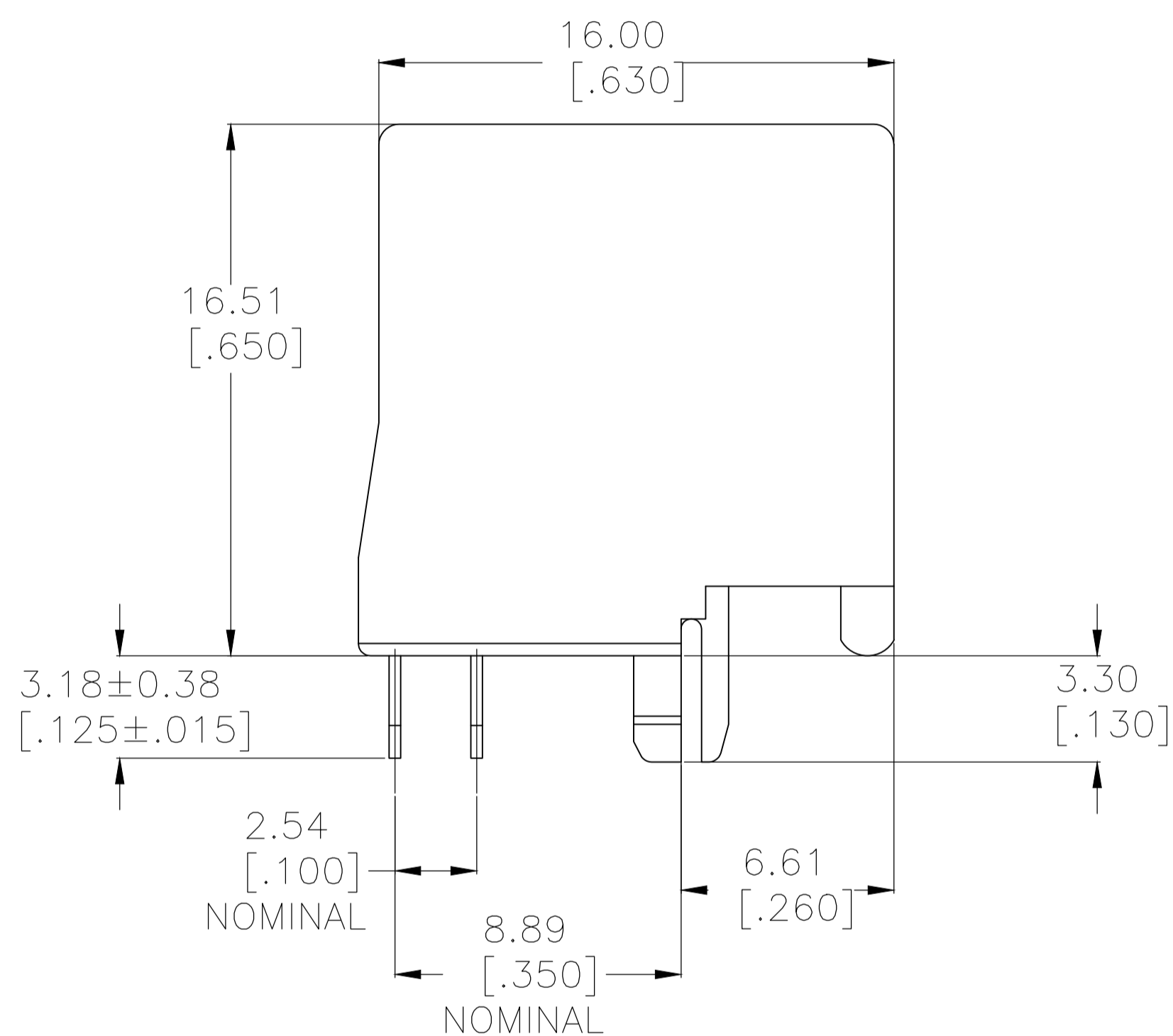

RECOMMENDED PANEL CUTOUT  
SCALE 4:1

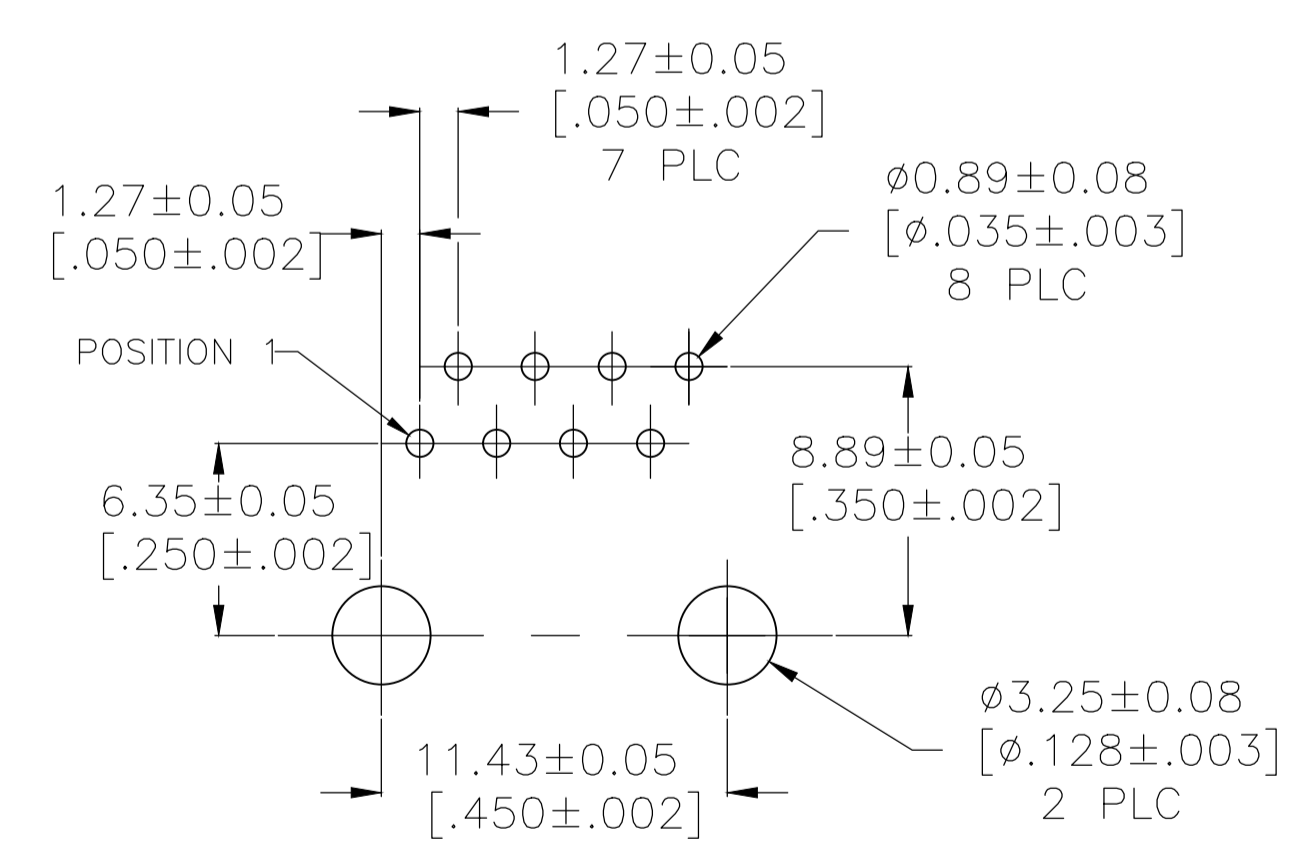
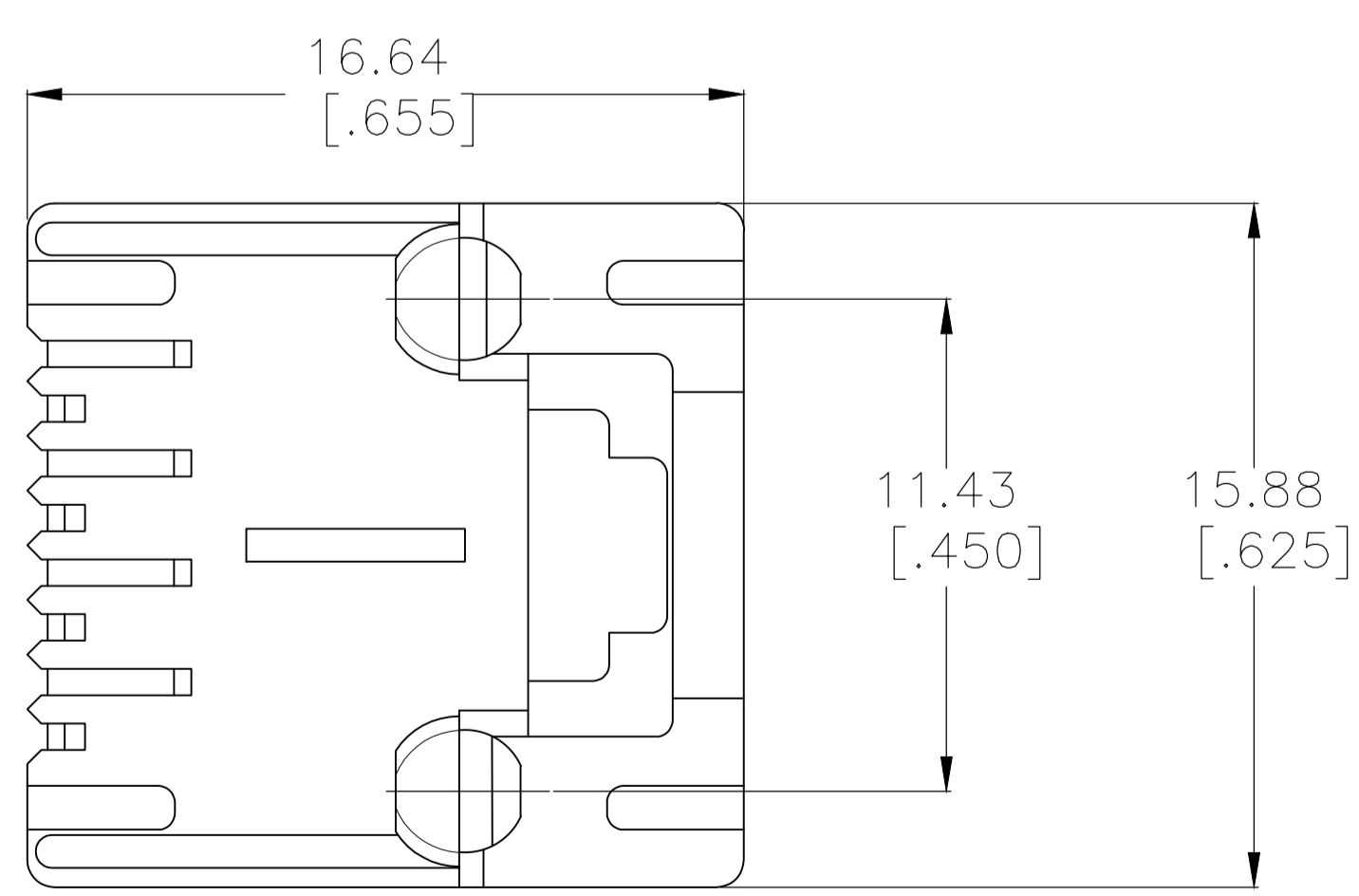

RECOMMENDED PRINTED CIRCUIT BOARD LAYOUT  
COMPONENT SIDE  
SCALE 4:1

OBSOLETE	5	5556416-2
	4	5556416-1
	PACKAGED	PART NO

THIS DRAWING IS A CONTROLLED DOCUMENT.		DIN E. LATTUCA 12SEPT05	TE Connectivity	
DIMENSIONS: mm [INCHES]		CHK J. WESTMAN 12SEPT05	NAME S. FLICKINGER 12SEPT05	
TOLERANCES UNLESS OTHERWISE SPECIFIED:		PRODUCT SPEC 108-1163		
0 PLC ± -		APPLICATION SPEC 114-2048		
1 PLC ± -		SIZE A1		
2 PLC ± -		SCALE 6:1		
3 PLC ± -		SHEET 1 OF 1		
4 PLC ± -		REV D		
ANGLES ± -		CUSTOMER DRAWING		
MATERIAL SEE NOTE 1	FINISH SEE NOTE 1	WEIGHT 0.000000	00779	5556416