

WAS 97-52159-005

LOC	DIST	REV	LTN	REVISIONS ÄNDERUNGEN	DESCRIPTION BESCHREIBUNG	DATE	DWN	APVD
A1	-	B3	-	REVISED PER ECO-11-005027		23MAR2011	RK	HMR
		C	-	REVISED PER ECO-13-005564		18APR2013	RD	JG
		D	-	REVISED PER PCN-22-143834		13JUN2022	HH	AW

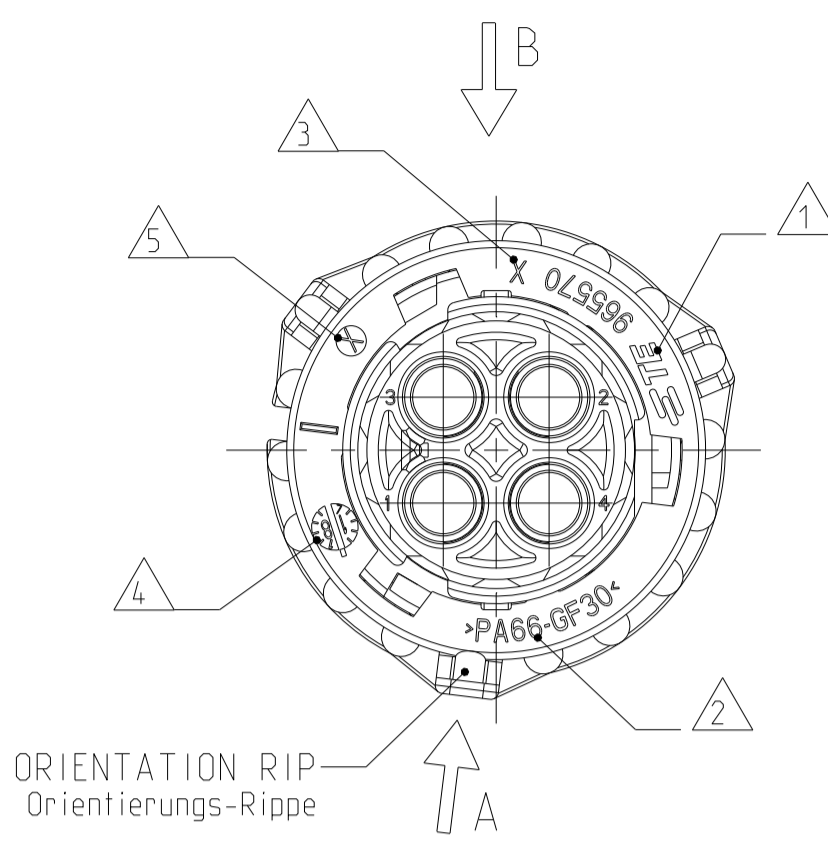

COUPLING RING IN PRE-LOCKED POSITION  
 (FITTING POSITION WITH PIN HOUSING)  
 Kupplungsring in Vorraststellung  
 (Fuegeposition mit Stiftgehäuse)

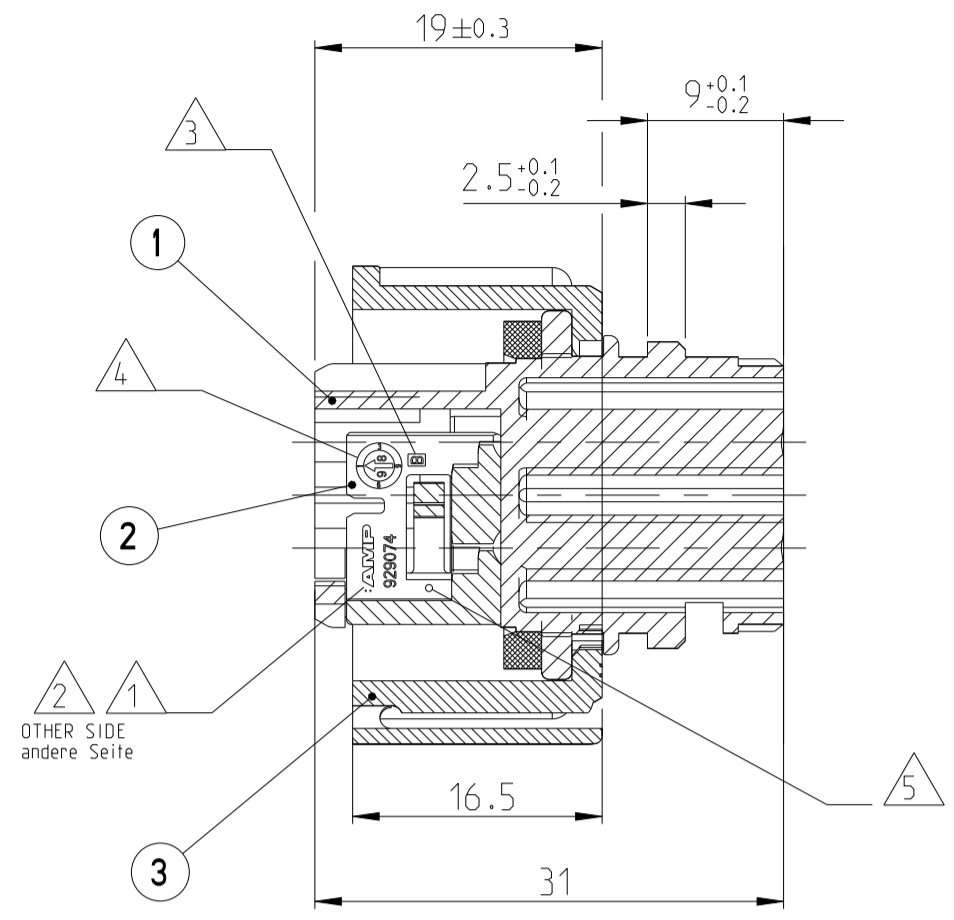

SECOND LOCKING DEVICE  
 IN PRE-LOCKED POSITION  
 Zweite Kontaktsicherung  
 in Vorraststellung

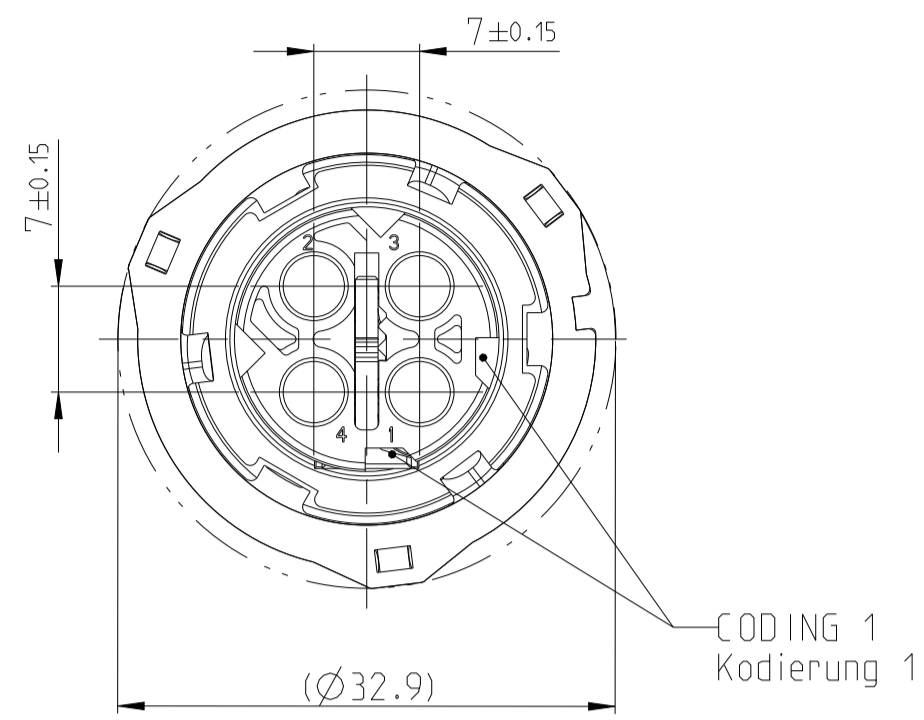

CODING 1  
 Kodierung 1

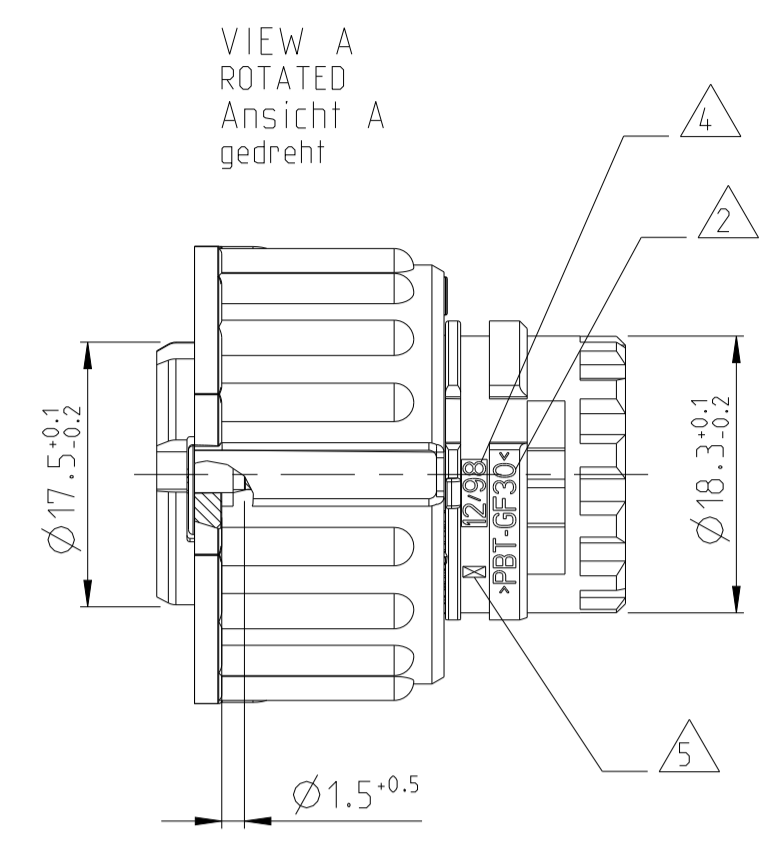

VIEW A  
 ROTATED  
 Ansicht A  
 gedreht

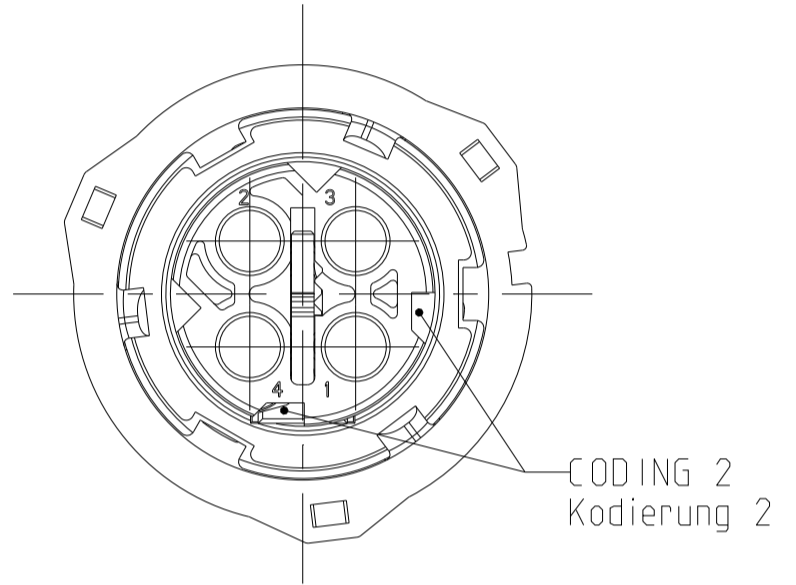

CODING 2  
 Kodierung 2

SECOND LOCKING DEVICE  
 IN LOCKED POSITION  
 Zweite Kontaktsicherung  
 in Endraststellung

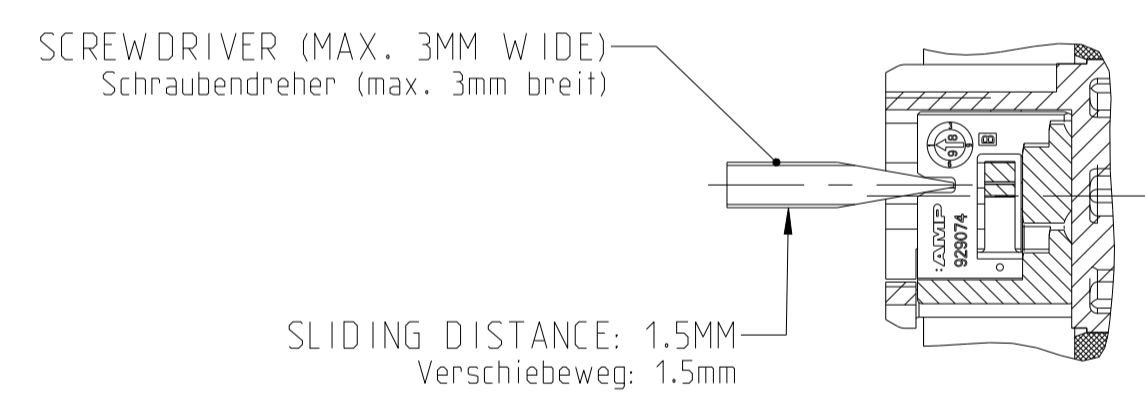

CLOSED CAVITIES OF THE  
 2POS./3POS. SOCKET HOUSING  
 Geschlossene Kammern des  
 2pol./3pol. Buchsengehäuses

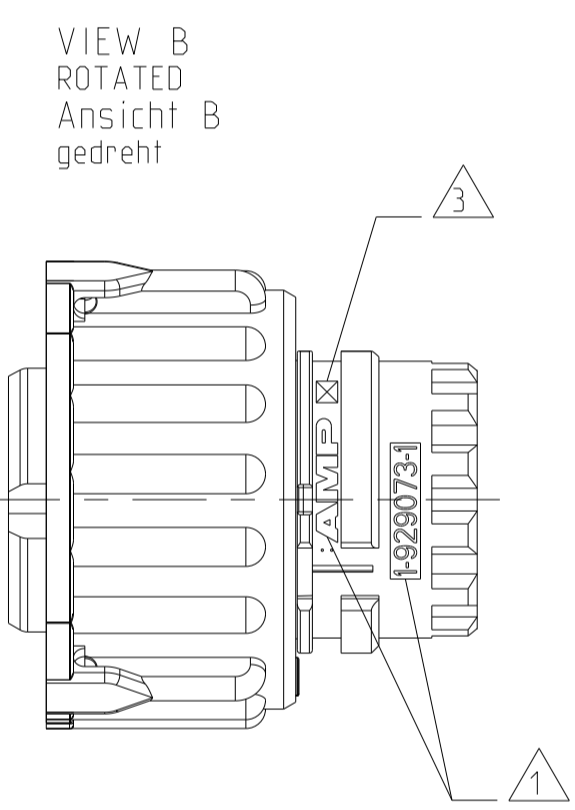
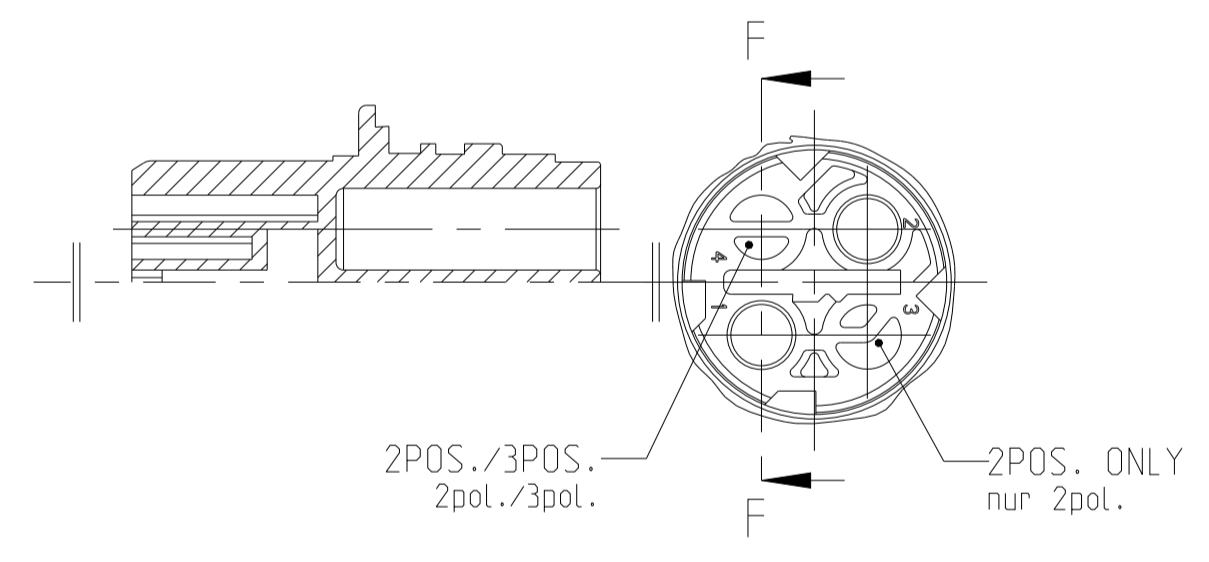

VIEW B  
 ROTATED  
 Ansicht B  
 gedreht

CODING / Kodierung								ACC. TO / nach DIN 72585 / ISO 15170	
4 BLUE blau	3 GREEN gruen	2 GREY grau	1 BLACK schwarz						
-	-	-	-	2-968968-3	0	1-968968-3	0	2	1,2 (2POS.)
-	-	-	-	-	-	1-968968-2	0	3	1-3 (3POS.)
-	-	-	-	-	-	1-968968-1	0	4	1-4 (4POS.)
ORDER-NO. Bestell-Nr.	REV.	ORDER-NO. Bestell-Nr.	REV.	ORDER-NO. Bestell-Nr.	REV.	ORDER-NO. Bestell-Nr.	REV.	NO. OF POSITIONS Polzahl	USABLE CONTACT-CAVITIES (DIM/ISO-NAME) bestueckbare Kontaktkammern (DIM/ISO-Bez.)
								POS.	QTY Stueck
									MATERIAL
									COLOUR Farbe
									DESCRIPTION OF SINGLE PARTS Beschreibung der Einzelteil

THIS DRAWING IS A CONTROLLED DOCUMENT.  
 DIESE ZEICHNUNG IST EIN KONTROLLIERTES DOKUMENT.

DIMENSIONS: MASSENMAEßEN: mm

TOLERANCES UNLESS OTHERWISE SPECIFIED: ALLER TOLERANZEN (ZU ISO 808)

FINISH SURFACE: FINISCH-OBERFLÄCHE: FARBE SEE TABLE

WEIGHT: GEWICHT: 11.42g

CUSTOMER DRAWING: /KUNDENZEICHNUNG

SCALE: MASSSTAB: 2:1

SHEET: BLATT: 1 OF 2

REV: D

DATE: 16AUG1997  
 CHK: J. Grandow  
 J. Hass

DATE: 20MAR1998  
 CHK: Eberwein

DATE: 25APR2008  
 CHK: Eberwein

NAME: 2.5MM SOCKET CONNECTOR, 2-4POS. WITH SECONDARY LOCKING  
 2.5mm Buchsenstecker, 2-4 pol. mit zweiter kontaktsicherung

PRODUCT SPEC: 108-18621  
 APPLICATION SPEC: 114-18255

SIZE: CAGE CODE: DRAWING NO: 00779  
 DIL/FRING-NR.: 968968

RESTRICTED TO: NUR FÜR

LOC		DIST		REVISIONS			
P	LTN	DESCRIPTION		DATE	DWN	APVD	
		SEE SHEET 1					

⬡ ASSEMBLY USING PA66 COUPLING RING

⬡ ASSEMBLY USING PBT COUPLING RING

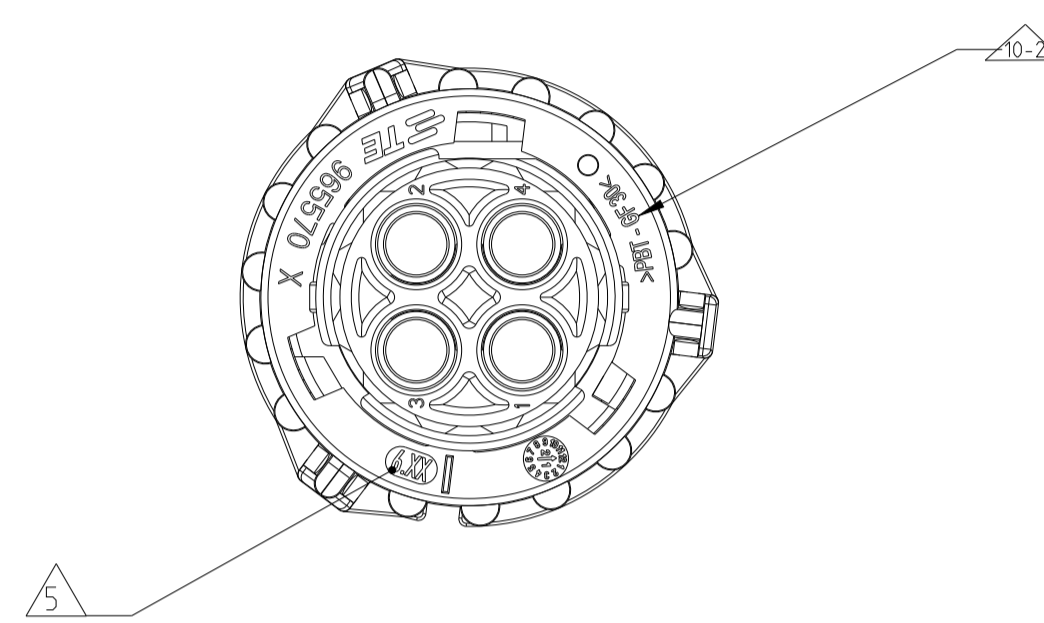
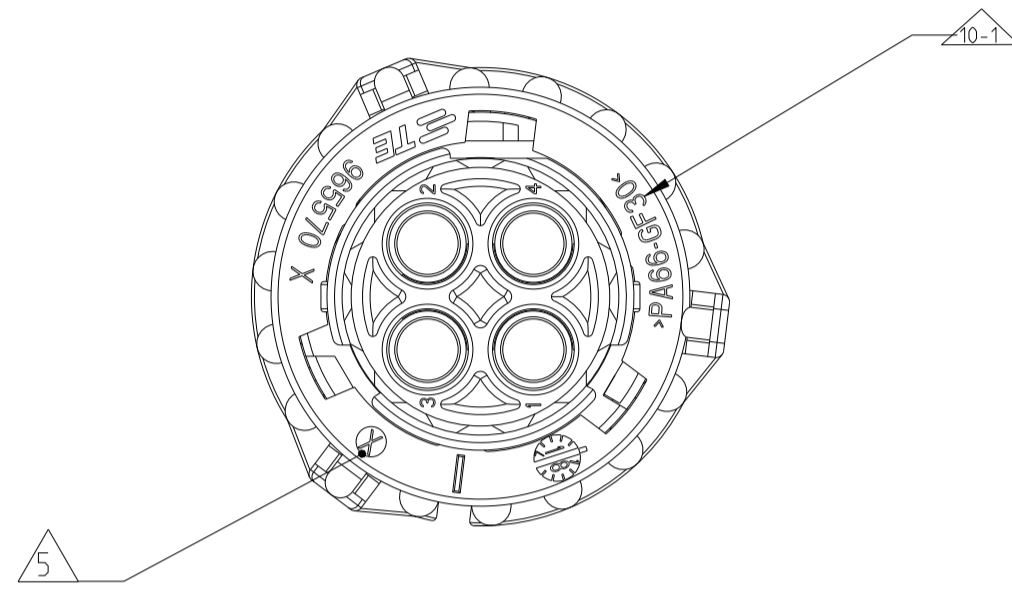

NOTES:

Bemerkungen:

- 1 TE LOGO AND TE CONNECTIVITY NUMBER OF SINGLE PART  
TE-Logo und TE CONNECTIVITY-Nummer des Einzelteils
- 2 MATERIAL MARKING  
Werkstoffkennzeichnung
- 3 REVISION OF THE MOLD  
Werkzeugaenderungsindex
- 4 PRODUCTION DATE  
Produktionsdatum
- 5 CAVITY MARKING  
Nestmarkierung
- 6 FITS TO CONNECTORS ACC. TO  
DIN 72585/ISO 15170 FORM A AND B AND  
PIN HOUSING 2-4POS. TE CONNECTIVITY-NO. 967402  
Passend zu Steckverbindern nach  
DIN 72585/ISO 15170 FORM A und B und  
Stiftgehäuse 2-4pol. TE-Nr. 967402
- 7 FOR SUITABLE CONTACTS SEE DRAWING:  
Zu verwendende Kontakte siehe Tabellenzeichnung:  
  
TE CONNECTIVITY-NR.: 1355065  
  
MAX. WIRE THICKNESS: 2.5mm<sup>2</sup>  
max. Drahtgroesse: 2.5mm<sup>2</sup>
- 8 BULK PACKAGING IN CARDBOARD BOX  
Schuetfgut im Karton
- 9 COLOUR OF SOCKET HOUSING ACC. TO CODING.  
COLOUR OF SEALING ORANGE.  
Farbe des Buchsengehäuses gemaeass der Kodierung.  
Farbe der Dichtung orange.
- 10 DIFFERENT COUPLING RING COMPONENT USED ACCORDING TO ASSEMBLY REGION:

	REGION	COUPLING RING MATERIAL	CAVITY MARKING
⬡-1	SOUTH AMERICA - BRAZIL	PA66-GF30	X
⬡-2	EMEA	PBT-GF30	6.XX

THIS DRAWING IS A CONTROLLED DOCUMENT.		DWN			
DIMENSIONS:		CHK			
 0 PLC ± 1 PLC ± 2 PLC ± 3 PLC ± 4 PLC ± ANGLES ± FINISH	TOLERANCES UNLESS OTHERWISE SPECIFIED:		APVD	NAME	
			PRODUCT SPEC		
			APPLICATION SPEC	SIZE	CAGE CODE
	MATERIAL		WEIGHT	DRAWING NO	RESTRICTED TO
			A 1	SCALE	
				SHEET	
				OF	
				REV	