

IV1D1201002 – 1200V 10A SiC Schottky Diode

Features:

- Max Junction Temperature 175°C
- High Surge Current Capacity
- Zero Reverse Recovery Current
- Zero Forward Recovery Voltage
- High-Frequency Operation
- Temperature independent switching behavior
- Positive Temperature Coefficient on V_F

Package

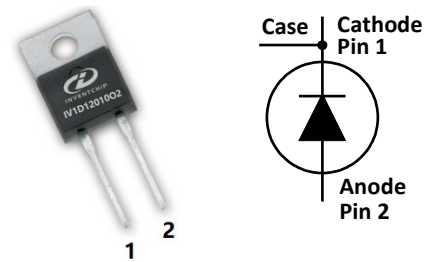

Applications:

- Solar Power Boost
- Inverter Free Wheeling Diodes
- Vienna 3-Phase PFC
- AC/DC Converters
- Switch Mode Power Supplies

Part Number	Package
IV1D1201002	TO220-2

Absolute Maximum Ratings (Tc=25°C unless otherwise specified)

Symbol	Parameter	Value	Unit
V_{RRM}	Reverse voltage (repetitive peak)	1200	V
V_{DC}	DC blocking voltage	1200	V
I_F	Forward current (continuous) @Tc=25°C	28	A
	Forward current (continuous) @Tc=150°C	10.5	A
I_{FSM}	Surge non-repetitive forward current sine halfwave @Tc=25°C tp=10ms	55	A
P_{tot}	Total power dissipation @ Tc=25°C	153	W
	Total power dissipation @ Tc=150°C	25	
$\int i^2 dt$	I^2t value @Tc=25°C tp=10ms	15	A ² S
Tstg	Storage temperature range	-55 to 175	°C
Tj	Operating junction temperature range	-55 to 175	°C

Stresses exceeding those listed in the Maximum Ratings table may damage the device. If any of these limits are exceeded, device functionality should not be assumed, damage may occur and reliability may be affected.

Electrical Characteristics

Symbol	Parameter	Typ.	Max.	Unit	Test Conditions	Note
V_F	Forward Voltage	1.56 2.2	1.8 3	V	$I_F = 10\text{ A } T_J = 25^\circ\text{C}$ $I_F = 10\text{ A } T_J = 175^\circ\text{C}$	Fig. 1
I_R	Reverse Current	2.5 12.5	50 175	μA	$V_R = 1200\text{ V } T_J = 25^\circ\text{C}$ $V_R = 1200\text{ V } T_J = 175^\circ\text{C}$	Fig. 2
C	Total Capacitance	575		pF	$V_R = 1\text{ V}, T_J = 25^\circ\text{C}, f = 1\text{ MHz}$	Fig. 3
		59			$V_R = 400\text{ V}, T_J = 25^\circ\text{C}, f = 1\text{ MHz}$	
		42.5			$V_R = 800\text{ V}, T_J = 25^\circ\text{C}, f = 1\text{ MHz}$	
Q_C	Total Capacitive Charge	62		nC	$V_R = 800\text{ V}, T_J = 25^\circ\text{C},$ $Q_C = \int_0^{V_R} C(V)dV$	Fig. 4

Thermal Characteristics

Symbol	Parameter	Typ.	Unit	Note
$R_{th(j-c)}$	Thermal Resistance from Junction to Case	0.98	$^\circ\text{C/W}$	Fig.7

Typical Performance

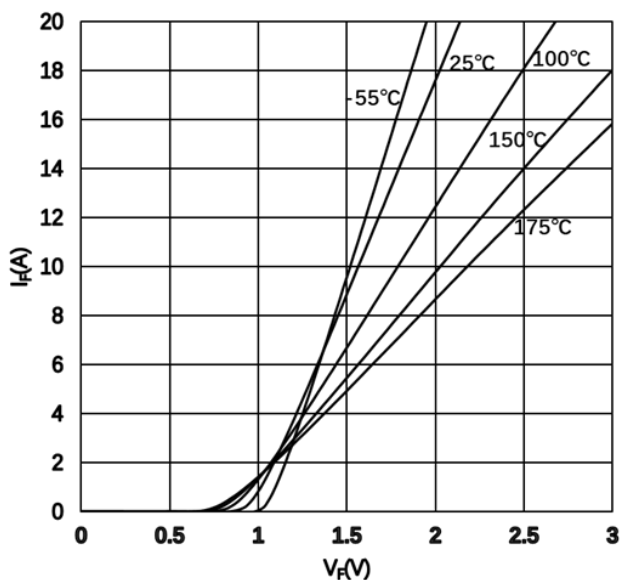

Figure 1. Typical Forward Characteristics

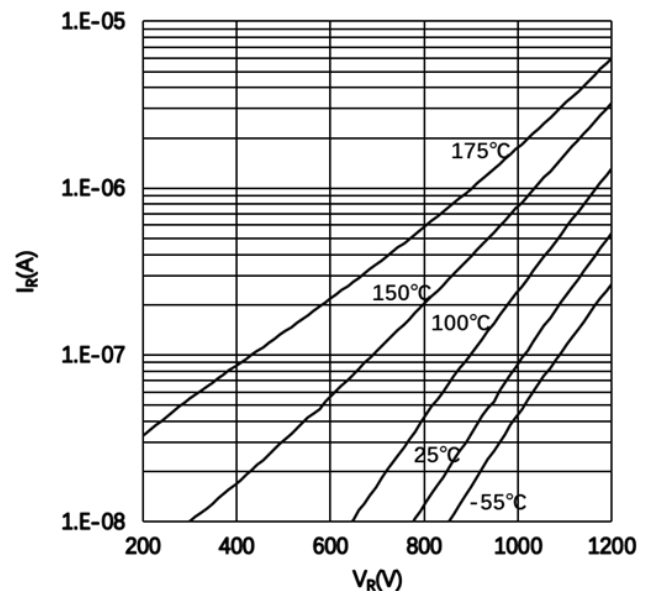

Figure 2. Typical Reverse Characteristics

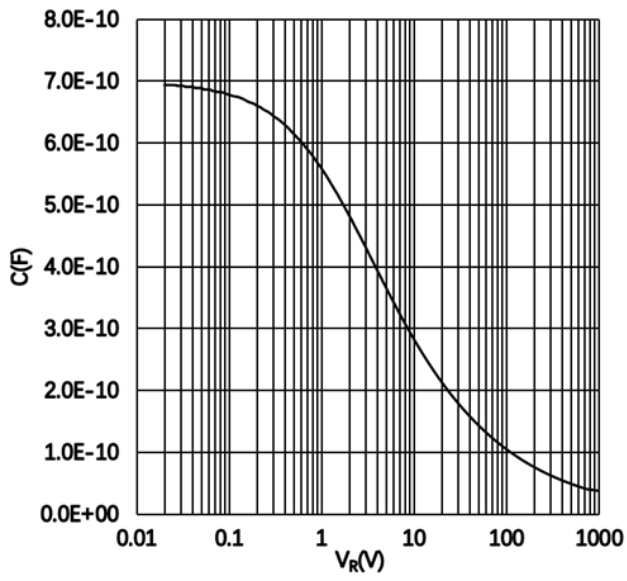

Figure 3. Capacitance vs. Reverse Voltage

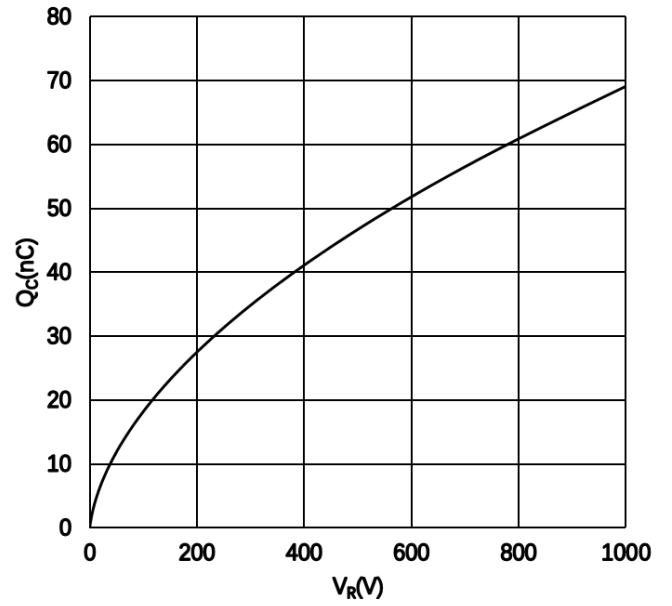

Figure 4. Recovery Charge vs. Reverse Voltage

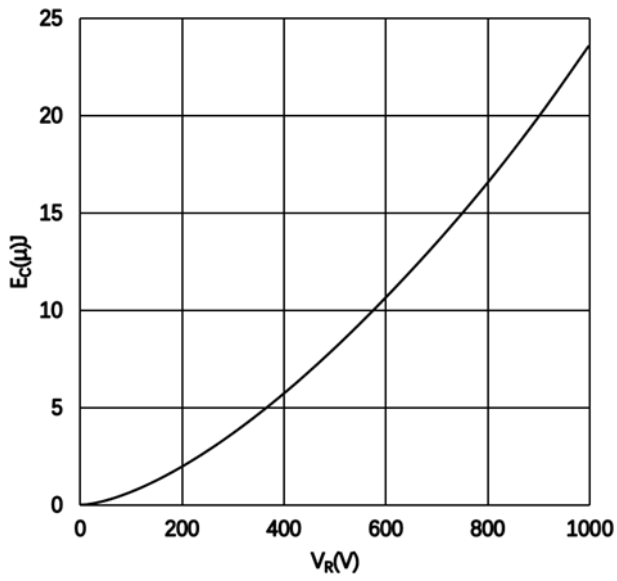

Figure 5. Capacitance Stored Energy

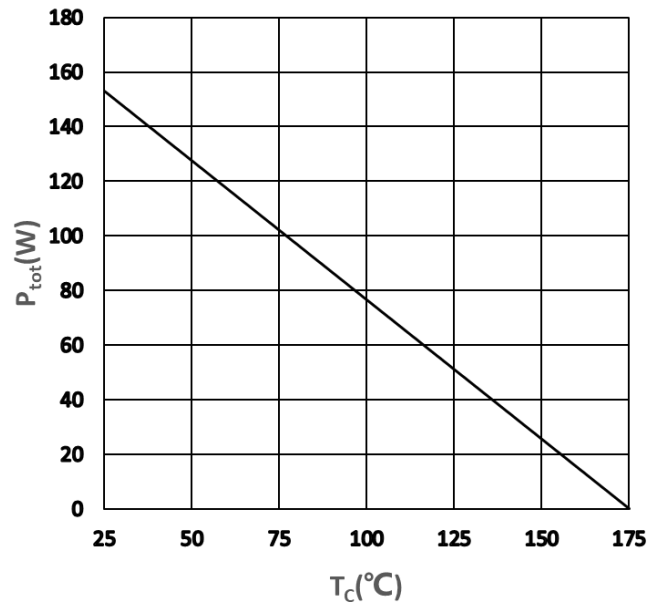

Figure 6. Power Derating

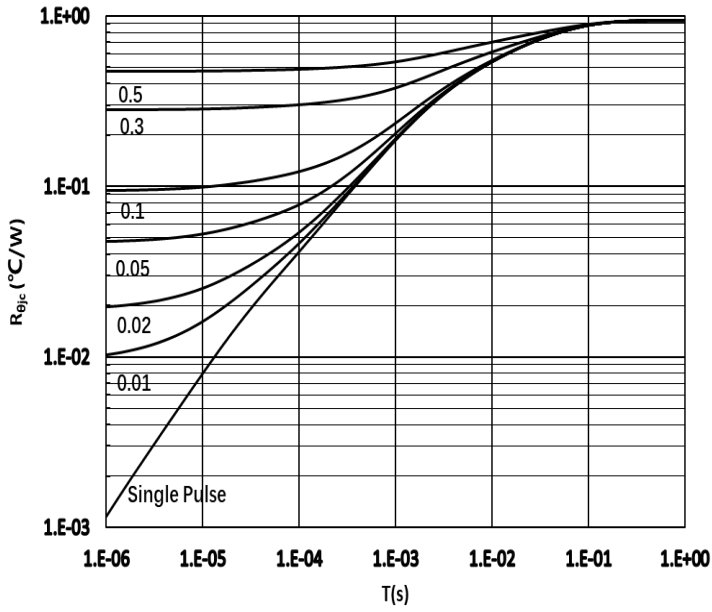

Figure 7. Transient Thermal Impedance

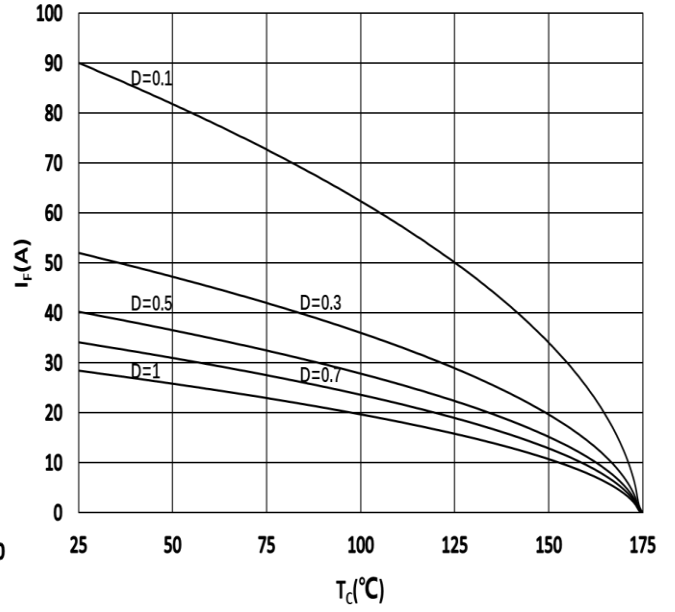
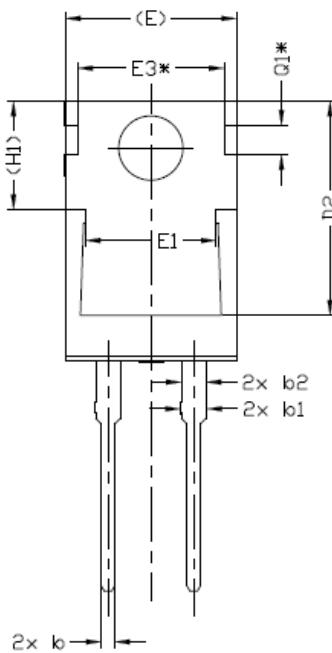
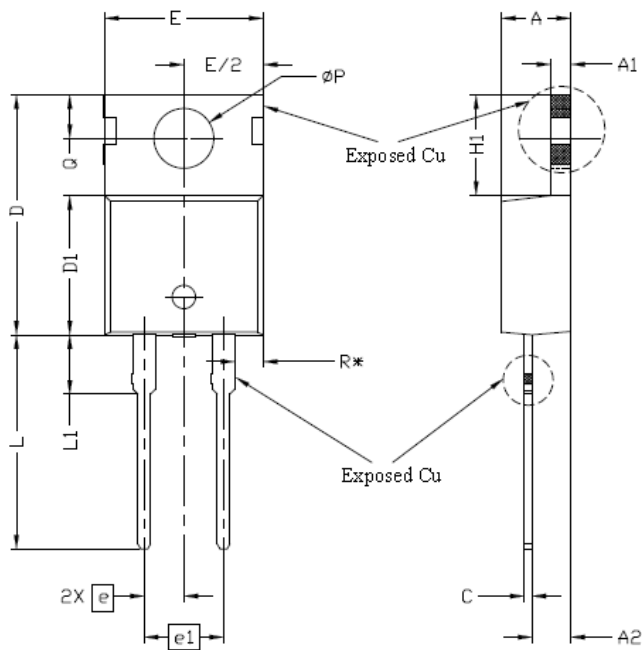

Figure 8. Forward Current as a Function of Temp.

Package Dimensions



SYMBOL	DIMENSIONS			NOTES
	MIN.	NOM.	MAX.	
A	4.24	4.44	4.64	
A1	1.15	1.27	1.40	
A2	2.30	2.48	2.70	
b	0.70	0.80	0.90	
b1	1.20	1.55	1.75	
b2	1.20	1.45	1.70	
c	0.40	0.50	0.60	
D	14.70	15.37	16.00	4
D1	8.82	8.92	9.02	
D2	12.63	12.73	12.83	5
E	9.96	10.16	10.36	4,5
E1	6.86	7.77	8.89	5
E3*	8.70REF.			
e	2.54BSC			
e1	5.08BSC			
H1	6.30	6.45	6.60	5,6
L	13.47	13.72	13.97	
L1	3.60	3.80	4.00	
$\varnothing P$	3.75	3.84	3.93	
Q	2.60	2.80	3.00	
Q1*	1.73REF.			
R*	1.82REF.			

Note:

1. Package Reference: JEDEC TO220, Variation AB
2. All Dimensions Are In mm
3. Slot Required, Notch May Be Rounded
4. Dimension D&E Do Not Include Mold Flash

Notes

For further information please contact IVCT' Office.

Copyright©2020 InventChip Technology Co., Ltd. All rights reserved.

Related Links

<http://www.inventchip.com.cn>

