

THIS DRAWING IS UNPUBLISHED. RELEASED FOR PUBLICATION

© COPYRIGHT - By - ALL RIGHTS RESERVED.

LOC	DIST	REVISIONS					
FT	0	P	LTR	DESCRIPTION	DATE	DWN	APVD
			B	REVISED PER ECO-11-023039	18FEB12	KH	MS

MATERIAL:
 HOUSING: NYLON, UL94V-0, BLACK.
 TERMINALS: BRASS, BRIGHT TIN PLATED.
 SCREWS: 6-32, STEEL, ZINC CHROMATE FINISH
 UNLESS OTHERWISE NOTED.

ELECTRICAL:
 MAXIMUM CURRENT: 20A
 OPERATING VOLTAGE: 600V
 WIRE RANGE: 12-22 AWG

ENVIRONMENT:
 OPERATING TEMP.: -60°C TO 105°C

- 1 SCREWS ARE NICKEL PLATED, BRASS.
- 2 ALL SCREWS BOTTOMED, TORQUE 2 TO 4 IN-LBS

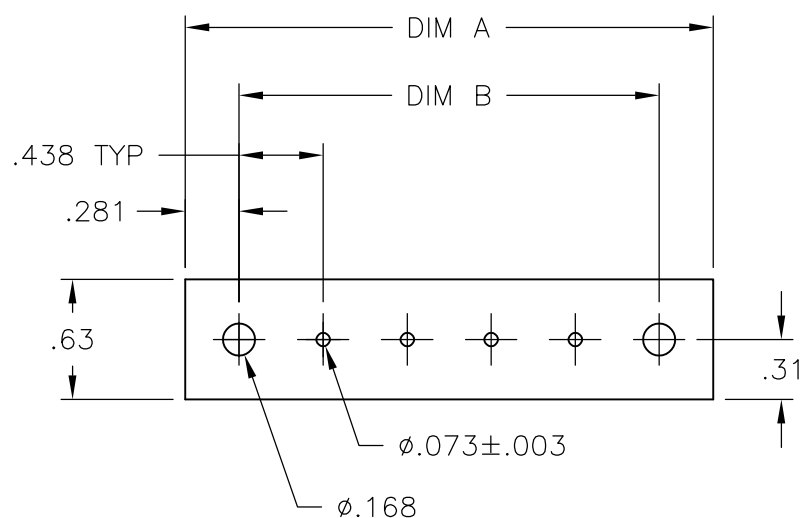
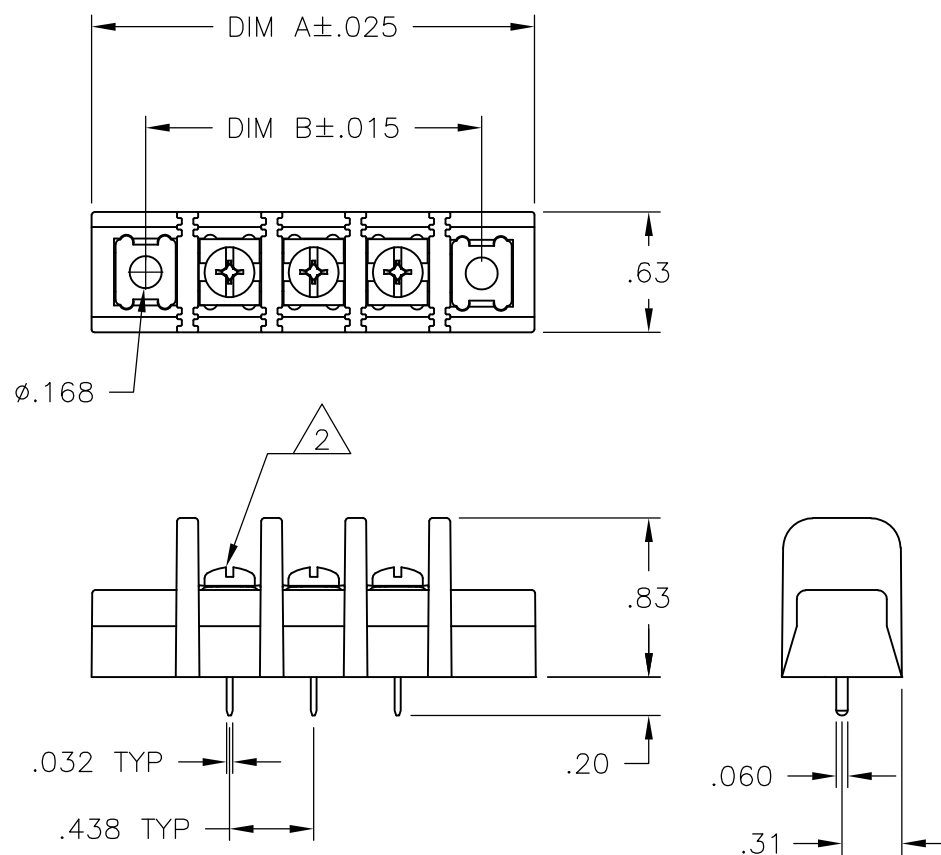

RECOMMENDED PCB LAYOUT

11.375	11.937	25	SSB7FG250201	2-1986017-5
10.937	11.500	24	SSB7FG240201	2-1986017-4
10.500	11.062	23	SSB7FG230201	2-1986017-3
10.062	10.625	22	SSB7FG220201	2-1986017-2
9.625	10.187	21	SSB7FG210201	2-1986017-1
9.187	9.750	20	SSB7FG200201	2-1986017-0
8.750	9.312	19	SSB7FG190201	1-1986017-9
8.312	8.875	18	SSB7FG180201	1-1986017-8
7.875	8.437	17	SSB7FG170201	1-1986017-7
7.437	8.000	16	SSB7FG160201	1-1986017-6
7.000	7.562	15	SSB7FG150201	1-1986017-5
6.562	7.125	14	SSB7FG140201	1-1986017-4
6.125	6.687	13	SSB7FG130201	1-1986017-3
5.687	6.250	12	SSB7FG120201	1-1986017-2
5.250	5.812	11	SSB7FG110201	1-1986017-1
4.812	5.375	10	SSB7FG100201	1-1986017-0
4.375	4.937	9	SSB7FG090201	1986017-9
3.937	4.500	8	SSB7FG080201	1986017-8
3.500	4.062	7	SSB7FG070201	1986017-7
3.062	3.625	6	SSB7FG060201	1986017-6
2.625	3.187	5	SSB7FG050204	2-1986017-6
2.625	3.187	5	SSB7FG050201	1986017-5
2.187	2.750	4	SSB7FG040201	1986017-4
1.750	2.312	3	SSB7FG030201	1986017-3
1.312	1.875	2	SSB7FG020201	1986017-2
.875	1.437	1	SSB7FG010201	1986017-1
DIM B	DIM A	NO. OF POS.	CATALOG NUMBER	PART NUMBER

THIS DRAWING IS A CONTROLLED DOCUMENT.		DWN S SCHL GEL 1/29/07	STE TE Connectivity	
DIMENSIONS: INCHES		CHK S YODER 1/29/07		
TOLERANCES UNLESS OTHERWISE SPECIFIED:		APVD S YODER 1/29/07	NAME	
0 PLC ± -		PRODUCT SPEC	SSB7FGXX0201	
1 PLC ± -		APPLICATION SPEC	RESTRICTED TO	
2 PLC ± .02		SIZE	CAGE CODE	DRAWING NO
3 PLC ± .010		—	A3	00779
4 PLC ± -		WEIGHT	G-1986017	
ANGLES ± 1°		CUSTOMER DRAWING		
FINISH		SCALE	SHEET	REV
-		NTS	1 OF 1	B