

REVISIONS					
REV	ECO	DESCRIPTION	DATE	BY	APPR
A1	-	RELEASE NUMBER	13MAR20	BROOK	TOMMY

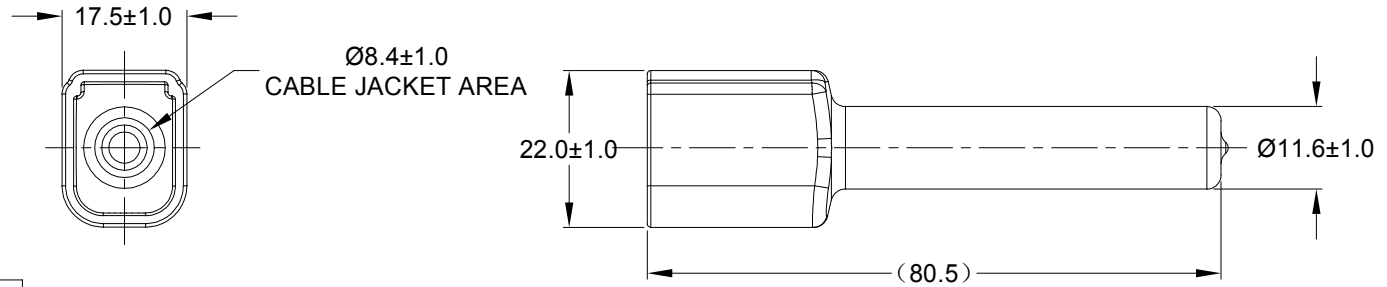
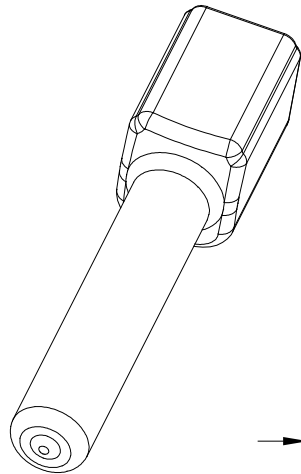

PART NUMBER CHART	
COLOR	PART NUMBER
GREY	ATM6P-BT
BLACK	ATM6P-BT-BK
YELLOW	ATM6P-BT-YW

- NOTES: UNLESS OTHERWISE SPECIFIED
- THIS PART IS USED ON ATM04-6P RECEPTACLE ANY MODIFICATION DOES NOT INCLUDE AN END CAP.
 - TEMPERATURE RATING : -29°C TO +100°C [-20°F TO +212°F]
 - ALL DIMENSIONS ARE FOR REFERENCE USE ONLY.

SEE PART NUMBER CHART		REF: DTM6P-BT, DTM6P-BT-BK, DTM6P-BT-YW									
PART NUMBER		DESCRIPTION									
QUANTITY	MATERIALS LIST			ITEM							
UNLESS OTHERWISE SPECIFIED 1) All dimensions are in metric(mm). 2) Tolerances are as follows: 1 PL DEC ±0.30 Fractions ±1/64 2 PL DEC ±0.15 Angles ±1° 3 PL DEC ±0.08 3) Note reference =		SIGNATURES DATE DRAWN: BROOK.DING 13MAR20 CHECKED: ORION.LI 16MAR20 ENGINEER: APPROVAL: TOMMY.XIE 17MAR20 CUSTOMER:		<h1 style="text-align: center;">Amphenol</h1> <p style="text-align: center;">Sine Systems - www.amphenol-sine.com 44724 Morley Drive Clinton Township, MI 48036</p>							
MATERIAL SPECIFICATIONS: <p style="text-align: center;">PVC</p>		THIS DRAWING IS SUPPLIED FOR INFORMATION ONLY. DESIGN FEATURES, SPECIFICATIONS AND PERFORMANCE DATA SHOWN HEREON ARE THE PROPERTY OF THE AMPHENOL CORPORATION. NO RIGHTS OF REPRODUCTION ARE IMPLIED. ALL DIMENSIONS ARE SUBJECT TO NORMAL MANUFACTURING VARIATIONS.									
PROCESS SPECIFICATIONS:		<table border="1"> <tr> <th>SIZE</th> <th>TYPE</th> <th>DWG NO:</th> <th>REVISION</th> </tr> <tr> <td>A</td> <td>C-</td> <td>ATM6P-BT-XX</td> <td>A1</td> </tr> </table>		SIZE	TYPE	DWG NO:	REVISION	A	C-	ATM6P-BT-XX	A1
SIZE	TYPE	DWG NO:	REVISION								
A	C-	ATM6P-BT-XX	A1								
NEXT ASSY:		SCALE: NONE SHEET 1 OF 1									