

DETAIL SHOWN NOT TO SCALE

**MOUNTING DETAILS**

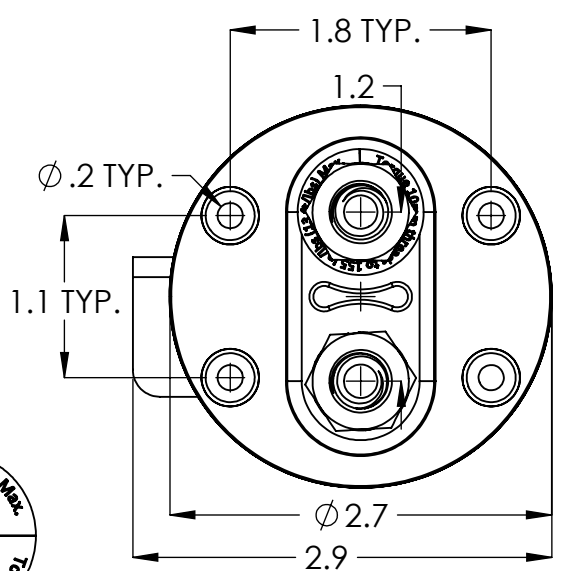
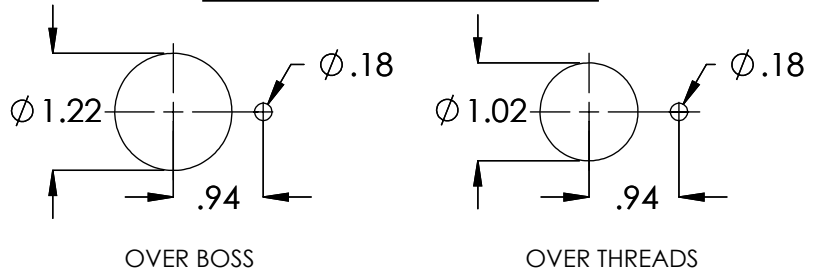

TORQUE TAG

**Technical data:**

Handle Material:	Red GF Nylon 6
Upper Housing Material:	Zinc Diecast
Lower Housing Material:	GP Phenolic
Min. Insulation Resistance:	100 Mohm
Dielectric Withstanding Voltage:	1,100V -1min
Voltage Drop Max.:	0.175 mV
Voltage:	48 VDC
Continuous Rating:	300 A
Overload:	1,100 A - 240sec. 1,500 A - 90sec. 2,000 A - 30sec
Sealing:	IP67
Vibration:	4G / 50-2KHz
Shock:	6G / 11ms
Temperature Range:	-40C to +85C
Terminal Torque:	155 in.lb
Mounting Torque:	18 ft.lb

**PROPRIETARY AND CONFIDENTIAL**  
 This document contains proprietary data for products designed by Shallco, Inc., of Smithfield, NC. No disclosure; reproduction, or use of any part thereof may be made except by written permission.

	NAME	DATE
DRAWN	JRT	4-15-15
CHECKED		
ENG APPR.	RMF	4-15-15
MFG APPR.		
Q.A.		

DIMENSIONS ARE IN INCHES  
 TOLERANCES:  
 FRACTIONAL ±1/32  
 ANGULAR: MACH ± BEND ±  
 TWO PLACE DECIMAL ±.010  
 THREE PLACE DECIMAL ±.005

**SHALLCO**  
 308 COMPONENTS DRIVE, SMITHFIELD, NC 27577 USA  
 DO NOT SCALE DRAWING

TITLE:  
**LOCKOUT BATTERY SWITCH  
 48VDC-300AMPS**

BLANK WEIGHT: - PART WEIGHT: 0.8LBS

SIZE **A** DWG. NO. **500SL-300** REV. **B**  
 SCALE:1:2 FILENAME: 500SL-300 SHEET 1 OF 1

REV.	DESCRIPTION	DATE	APP'D

DWG NO: 500SL-300